

(Do Not Modify) Modified On	Approval ID	Approval Type	Status Reason	Contract ID	Department	Approved By	Modified By	Modified On
1/14/2026 20:09	APPR-016985	Contract For Execution	Approved As Drafted	CONT-006998	PW- Public Works	Irby, Katherine L	Katherine Irby	1/14/2026 20:09
12/9/2025 12:43	APPR-016986	Contract For Execution	Approved As Drafted	CONT-006998	PW- Public Works	Steve Varvel	Steven Varvel	12/9/2025 12:43
1/15/2026 15:12	APPR-016987	Contract For Execution	Approved As Drafted	CONT-006998	PW- Public Works	Sheri Manning	Sheri Manning	1/15/2026 15:12

Date: 12/1/25

CITY OF GAINESVILLE PROJECT TRANSMITTAL FORM

This form is required for all contracts regardless of project amount.

Type of Action Requested: New Amendment (or Extension) Change Order

Project Amount: \$Revenue Anticipated Start Date:

Department Name: Public Works

Project Manager: Phil Mann Phone Number: 5010

Account No.: 1340 1/2 Infrastructure Surtax

Funding Source: City Funds Other (state source): _____

Subcontractor Opportunities: Yes No

Contractor/Vendor: Alachua County

Project Description: Surtax Partnership Grant Agreement with Alachua County for N.E. 9th Street

Signed by:

PROJECT APPROVED FOR PROCESSING

Philip R. Mann 1/15/2026

Project Manager ID: 17432E06766C46A... Date

Gail L Mowry 1/15/2026

Department Head ID: 9B2CE69A11D34B2... Date

Signed by:

Brian Singleton 1/15/2026

Executive Team or Charter Officer ID: 7CBB8B844BE44D3... Date

Andrew Persons 1/15/2026

City Manager ID: 21261519EC144B9... Date

REVIEWER APPROVALS

	<u>Reviewing Office</u>	<u>Signature</u>	<u>Date</u>
<u>X</u>	City Attorney (As to form and legality)	<u>Approved As Drafted/ K. Irby</u>	<u>1/14/26</u>
<u>X</u>	Risk Manager (Risk/Insurance Coverage)	<u>Approved As Drafted/ S. Varvel</u>	<u>12/9/25</u>
_____	Grants (If grant)	_____	_____
_____	Revenue (If revenue)	_____	_____
<u>X</u>	Procurement (If procurement)	<u>Approved As Drafted/ S. Manning</u>	<u>1/15/26</u>
_____		_____	_____

City Commission Approval: (\$100,000 and above)

Yes Date Approved: 8/21/2025

No City Commission approval is not required

Enter Procurement Policy exception section number (i.e. Sec 7.1(c): _____

Procurement Policy 7.1: Every purchase of an item of supplies, materials, equipment, contractual services, or extension(s) to existing contracts costing in excess of \$1000,000 shall require the approval of the City Commission, except for the following... (see Procurement Policy for exceptions).

PROJECT APPROVED FOR EXECUTION:

Katherine Irby 1/15/2026

City Attorney ID: 493272F34EE8416... Date

Signed by:

Andrew Persons 1/15/2026

City Manager ID: 21261519EC144B9... Date

**GRANT FUNDING AGREEMENT
BETWEEN ALACHUA COUNTY AND THE CITY OF GAINESVILLE
FOR AWARD AND DISTRIBUTION OF LOCAL
GOVERNMENT INFRASTRUCTURE SURTAX,
NO. 14725**

THIS GRANT FUNDING AGREEMENT (this "Agreement") is entered into this between Alachua County, a charter county and a political subdivision of the State of Florida, by and through its Board of County Commissioners (hereinafter referred to as the "County"), and the City of Gainesville, a municipal corporation of the State of Florida, by and through its governing board, (hereinafter referred to as the "Municipality")(as used herein, the County and the Municipality shall be referred to collectively as the "Parties").

WITNESSETH:

WHEREAS, Subsection 212.055(2), Florida Statutes, provides the County the authority to levy, in addition to other taxes allowed by law, a local government infrastructure sales surtax pursuant to ordinance enacted by a majority of the members of the Board of County Commissioners and approved by a majority of the electors of the County; and

WHEREAS, the local government infrastructure surtax may be used to fund the various types of programs that are enumerated in subsection 212.055(2), Florida Statutes; and

WHEREAS, on March 22, 2022, the Board of County Commissioners of Alachua County, Florida ("**Board**") adopted Ordinance 2022-08 to levy a 1.0 percent local government infrastructure surtax (the "**Surtax Ordinance**"); and

WHEREAS, the Surtax Ordinance provides that the proceeds of the surtax must be divided in two equal parts, with 50% of the proceeds to be used only for "**Wild Spaces Public Places Uses**" and 50% of the proceeds to be used only for "**Other Infrastructure Uses**"; and

WHEREAS, the Surtax Ordinance provides that the **Wild Spaced Public Places Uses** allocation may be used only to acquire any interest in land for public recreation, conservation, or protection of natural resources, to improve conservation lands, or to create, improve, maintain and operate the parks and recreational programs and facilities established with the proceeds of the surtax within Alachua County (hereinafter, "**Wild Spaces Public Places Uses**" or "**WSPP Uses**"); and

WHEREAS, the Surtax Ordinance provides that the **Other Infrastructure Uses** allocation may only be used to for the following: land acquisition, land improvement, design, engineering costs, and all other professional and related costs to finance, plan, construct,

reconstruct or improve public facilities that have a life expectancy of 5 years or more; land acquisition expenditures for a residential housing project in which at least 30 percent of the units are affordable to individuals or families whose total annual household income does not exceed 120 percent of the area median income adjusted for household size, if the land is owned by a local government or by a special district that enters into a written agreement with the local government to provide such housing; and up to 15 percent of the surtax may be allocated for funding economic development projects having a general public purpose of improving local economies, including the funding of operational costs and incentives related to economic development (collectively, “**Other Infrastructure Uses**”); and

WHEREAS, the surtax was approved by a majority of the electors voting in the referendum held on November 8, 2022, became effective on January 1, 2023, and is scheduled to expire on December 31, 2032; and

WHEREAS, the Surtax Ordinance created four Municipal Partnership Grant Programs from the County’s statutory formula share of the surtax proceeds, whereby the County will award matching grant funds for qualifying municipal grant projects on a cost reimbursement basis; and

WHEREAS, the four Municipal Partnership Grant Programs created by the Surtax Ordinance are: (1) \$3,000,000 for the City of Gainesville for WSPP Uses (the “**Gainesville WSPP Grant Program**”); (2) \$3,000,000 to be allocated amount all nine Alachua County municipalities for WSPP Uses (the “**Municipalities WSPP Grant Program**”); (3) \$3,000,000 for the City of Gainesville for Other Infrastructure Uses (the “**Gainesville Other Infrastructure Grant Program**”); and (4) \$3,000,000 to be allocated amount all nine Alachua County municipalities for Other Infrastructure Uses (the “**Municipalities Other Infrastructure Grant Program**”); and

WHEREAS, on May 23, 2023, the Board determined that the \$3,000,000 grant funding to be allocated to among all nine Alachua County municipalities under the **Municipalities WSPP Grant Program** and the \$3,000,000 grant funding to be allocated among to all nine Alachua County municipalities under the **Municipalities Other Infrastructure Grant Program**, be divided equally among the nine municipalities, so that each municipality will receive up to \$333,333.33 under each of the two grant programs; and

WHEREAS, on May 15, 2025, the Municipality submitted an application to the County for funding under the Joint Infrastructure Surtax, a copy of the application is attached hereto as **Exhibit 1** (the “Project”); and

WHEREAS, the Municipality represents and warrants to the County that any and all grant funding provided to it by the County under this Agreement shall be used in strict accordance with the Surtax Ordinance and §212.055(2), Florida Statutes; and

WHEREAS, the Board finds, based on the Municipality’s application, representations and warranties; that the Project qualifies for grant funding under the Surtax Ordinance; and

WHEREAS, the Parties desire to enter into this Agreement to award and implement the grant.

NOW, THEREFORE, pursuant to the Surtax Ordinance and consideration of the mutual covenants contained herein, the Parties hereto agree as follows:

1. Recitals. The Parties agree that all of the recitals set forth above are true, correct, and are hereby incorporated into and made part of this Agreement.

2. Term. This Agreement shall take effect on the day and year that it has been executed by the last party and shall continue until the Municipality has completed the Project and the County has reimbursed the Municipality for the County’s portion of the Project cost, as required herein.

3. Project Construction and Funding. The County award to the Municipality grant funding in an amount that shall not exceed \$2,333,333.00 (the “Grant Funding”) for completion of the Project. The Project shall consist of the construction of the modification and reconfiguration of NE 9th Street as more particularly described in **Exhibit 1** and depicted in **Exhibit 2**. The following elements of the Project constitute allowable costs for which the Municipality shall be reimbursed as provided in this Agreement: for the modification and reconfiguration of a 1.5 mile section of NE 9th Street between East University Avenue and N.E. 23rd Avenue. The project will eliminate the parking bay and add protected bike lanes along the corridor. This will improve the street as a multi-modal corridor. The Municipality shall begin construction of the Project not later than April 2026 and proceed diligently to final completion. The Municipality shall achieve final completion of the Project, by no later than April 2027. Upon achieving final completion of the Project, the Municipality shall submit a written invoice to the County in an amount that shall not exceed 50% of the allowable Project costs incurred and paid by the Municipality for the Project, along with documentation sufficient to demonstrate the total cost of the Project and a written statement from the Municipality’s Public Works, Parks manger, or Project Consultant certifying to the County that the Project has been completed. The County shall reimburse up to fifty percent (50%) of the amount expended by the Municipality for such Project within 60 days of the County’s receipt of an invoice that includes all receipts, statements, or other records as the County or the Clerk of Court may reasonably require to substantiate the cost of the Project and the amount requested by the Municipality. Notwithstanding anything in this Agreement to the contrary, the Parties acknowledge and agree that maximum amount payable by the County to the Municipality for the Project is \$2,333,333.00.

4. Use of Project by County Residents. Upon completion of the Project: (a) the

Project shall be open and available to all County residents at the same fee or fee structure, if any, that is applicable to Municipal residents; and (b) the Municipality shall erect and maintain on-site signage, as provided by the County, recognizing the contributions of the Alachua County Citizens towards to construction of the Project.

5. Notices. All notices from either party to the other party must be in writing and sent by certified mail, return receipt requested, or by personal delivery with receipt. For purposes of all notices, the representatives of the County and Municipality are:

County: County Manager
12 S.E. 1st Street
Gainesville, FL 32601

Municipality: City Manager
200 E University Ave,
Gainesville, FL 32601

6. Default and Termination. The failure of either party to comply with any provision of this Agreement will place that party in default. The party claiming default will notify the other party in writing. This notification will make specific reference to the provision which gave rise to the default. The defaulting party will have (7) days to cure the default or to submit a plan to cure acceptable to the other party. The County Manager is authorized to provide written notice of default on behalf of the County, and if the default situation is not corrected within the allotted time, the County Manager shall refer the matter to the Board for authorization to terminate this Agreement and, if grant funding has been received by the Municipality, seek reimbursement of grant funding from the Municipality. The City Mayor is authorized to provide written notice of default on behalf of the Municipality, and if the default situation is not corrected within the allotted time, the City Mayor shall refer the matter to the City Commissioner.

7. Repayment. The Municipality agrees to return to the County, within sixty (60) calendar days' of written demand from the County, all Grant Funding, or any portion thereof, paid to the Municipality under the terms of this Agreement upon the County finding that the Municipality has violated any term of this Agreement, the Surtax Ordinance, or §212.055(2), Florida Statutes. This provision shall survive the expiration or termination of this Agreement.

8. Laws & Regulations. The Municipality shall comply with all federal, state, and local laws, ordinances, regulations, rules and code requirements applicable to the Project and the grant funding awarded pursuant to this Agreement.

9. Sovereign Immunity. Each Parties fully retains all sovereign immunity protections afforded to it as a municipal corporation of the State of Florida, and a charter county and a political subdivision of the State of Florida, respectively. Without in any way waiving, limiting or restricting any defenses of sovereign immunity, each party shall be solely responsible for its own negligent acts or omissions, as well as those of its own employees. This Agreement is not intended, and shall not be interpreted to constitute, a waiver of sovereign immunity, an authorization of claims by third parties, a waiver of the limits of liability as established by §768.28, Florida Statutes, or to waive any other provision of §768.28, Florida Statutes. Nothing in this Agreement is intended to inure to the benefit of any third party for the purposes of allowing any claim that would otherwise be barred under the doctrine of sovereign immunity or by operation of law.

10. Auditing Rights and Information. County reserves the right to require the Municipality to submit to an audit, by any auditor of the County's choosing. The Municipality shall provide access to all of its records, which relate directly or indirectly to the Project or this Agreement, at its city hall during regular business hours. The Municipality shall retain all records pertaining to the Project or this Agreement and upon request make them available to County for inspection, copying and auditing for a period of five (5) complete calendar years following expiration or termination of this Agreement. The Municipality agrees to provide such assistance as may be necessary to facilitate the review or audit by the County to ensure compliance with applicable accounting and financial standards. If an audit inspection or examination pursuant to this section discloses overpricing, overcharges, or disallowed cost of any nature by the Municipality to the County (the "Overcharged Amount"), the Municipality agrees to pay the Overcharged Amount to the County within 60 calendar days of demand from the County. The access, inspection, copying and auditing rights shall survive the expiration or termination of this Agreement.

11. Exhibits. All exhibits and attachments attached to this Agreement are incorporated into and made part of this Agreement by reference.

12. Amendment and Assignment. The Parties may only modify or amend this Agreement by a mutual written agreement that is executed by both Parties. Neither party will assign or transfer any interest in this Agreement without prior written consent of the other party.

13. Third Party Beneficiaries. This Agreement does not create any relationship with, or any rights in favor of, any third party.

14. Governing Law and Venue. This Agreement shall be governed and construed in accordance with the laws of the State of Florida. Sole and exclusive venue for all actions arising from or related to this Agreement shall be in Alachua County, Florida.

15. Construction. This Agreement shall not be construed more strictly against one party than against the other merely by virtue of the fact that it may have been prepared by one of the Parties. It is recognized that both Parties have substantially contributed to the preparation of this Agreement.

16. Counterparts. This Agreement may be executed in any number of and by the different Parties hereto on separate counterparts, each of which when so executed shall be deemed to be an original, and such counterparts shall together constitute but one and the same instrument. Receipt via email with pdf attachment by a party or its designated legal counsel of an executed counterpart of this Amendment shall constitute valid and sufficient delivery in order to complete execution and delivery of this Amendment and bind the Parties to the terms hereof.

17. Electronic Signatures. The Parties agree that an electronic version of this Agreement shall have the same legal effect and enforceability as a paper version. The Parties further agree that this Agreement, regardless of whether in electronic or paper form, may be executed by use of electronic signatures. Electronic signatures shall have the same legal effect and enforceability as manually written signatures. Delivery of this Agreement or any other document contemplated hereby bearing an manually written or electronic signature, by electronic mail in "portable document format" (".pdf") form, or by any other electronic means intended to preserve the original graphic and pictorial appearance of a document, will have the same effect as physical delivery of the paper document bearing an original or electronic signature.

18. Entire Agreement. This Agreement constitutes the entire agreement between the Parties regarding the Project and the Grant Funding, and supersedes all prior written or oral agreements, understandings, or representations of the Parties regarding same.

IN WITNESS WHEREOF, the Parties hereto have caused this Agreement to be approved and executed by their duly authorized officials.

ALACHUA COUNTY, FLORIDA

By: _____
Ken Cornell, Chair
Board of County Commissioners

Date: _____

ATTEST:

APPROVED AS TO FORM

Jesse K. Irby, II, Clerk
(SEAL)

Alachua County Attorney

CITY OF Gainesville

Signed by:
Andrew Persons
By: _____
Andrew Persons, City Manager

Date: 1/15/2026

ATTEST:

Approved as to Form & Legality

Signed by:
Kristen J. Bryant

Clerk — D07162CC56624FE...
(SEAL) *Kst JB*

Signed by:
Katherine Irby

Katherine Irby, Attorney II
1/15/2026

Exhibit 1: Project Application



For staff use only

Date Received: _____

Date Approved: _____

Joint Infrastructure Surtax Projects Application

Please complete one form for each proposed project. Please check one:

Wild Spaces & Public Places (not to exceed \$333,333)

Infrastructure (not to exceed \$333,333)

Municipality: City of Gainesville

Primary Contact First/Last Name: Phil Mann

Primary Contact Daytime Phone Number: 352-393-8603

Primary Contact Email Address: mannpr@cityofgainesville.org

Name of Project: NE 9th Street

Project Address/Location: NE 9th Street from East Univ Ave to NE 23rd Ave

Estimated Project Cost: \$ 5,200,000 (\$2,333,333 grant request).

Estimated Start Date: _____ Estimated Completion Date: _____

Who will benefit from the project:

Resident in northeast Gainesville will benefit from this project. The proposed project will modify the configuration of the street between East University Avenue and N.E. 23rd Avenue. The project will eliminate the parking bay and add protected bike lanes along the corridor. This will improve the street as a multi-modal corridor.

Local Significance of Project to your Municipality:

This project will be part of the City's Vision Zero Program. It will provide protected bike lanes along the corridor to enhance multi-modal transportation safety. The final approved design is the result of various community meeting and City Commission presentations. Additional local significance of this project is that N.E. 9th Street serves Westwood Middle School directly as well as indirect access to Metcalfe Elementary School.

County-Wide Significance of Project (optional – attach plans/drawings/maps):

This street serves as a north/south collector road between N.E. 23rd Avenue and East University Avenue. It is a link N.E. 23rd Avenue (FDOT Roadway), N.E. 16th Avenue (County Roadway) East University Avenue (FDOT Roadway) - all arterial roadways. This project also includes reconstruction of the Alachua County owned traffic signal at N.E. 16th Avenue & 9th Street.

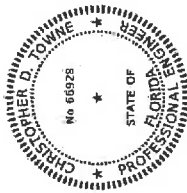

THESE ITEMS HAVE BEEN DIGITALLY SIGNED AND SEALED BY CHRISTOPHER D. TOWNE IN ACCORDANCE WITH RULE 61G15-23.004, F.A.C. THE SIGNATURE MUST BE VERIFIED ON ANY ELECTRONIC COPIES.

KIMLEY-HORN AND ASSOCIATES, INC.
 8201 PETERS RD., SUITE 2200
 GAINESVILLE, FLORIDA 32601
 REGISTRY 35108
 CHRISTOPHER D. TOWNE, P.E. 66928

THE ABOVE NAMED PROFESSIONAL ENGINEER SHALL BE RESPONSIBLE FOR THE FOLLOWING SHEETS IN ACCORDANCE WITH RULE 61G15-23.004, F.A.C.

SHEET NO.	SHEET TITLE
01	COVER SHEET AND INDEX
02	SIGNATURE SHEET
03	GENERAL NOTES
04-08	TYPICAL SECTIONS
07	DETAIL SHEET
09-25	PLAN SHEETS
	PROPOSED LAYOUT AND HORIZONTAL CONTROL
X-01-X-48	CROSS SECTIONS
UT-01-UT-11	UTILITY ADJUSTMENT PLANS
SP-01	SIGNING AND PAVEMENT MARKINGS AND NOTES
SP-02-SP-17	SIGNING AND PAVEMENT MARKINGS

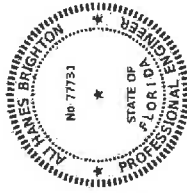

THESE ITEMS HAVE BEEN DIGITALLY SIGNED AND SEALED BY JAMES BRIGHTON IN ACCORDANCE WITH RULE 61G15-23.004, F.A.C. THE SIGNATURE MUST BE VERIFIED ON ANY ELECTRONIC COPIES.

KIMLEY-HORN AND ASSOCIATES, INC.
 8201 PETERS RD., SUITE 2200
 GAINESVILLE, FLORIDA 32601
 REGISTRY 20108
 JAMES BRIGHTON, P.E. 77733

THE ABOVE NAMED PROFESSIONAL ENGINEER SHALL BE RESPONSIBLE FOR THE FOLLOWING SHEETS IN ACCORDANCE WITH RULE 61G15-23.004, F.A.C.

SHEET NO.	SHEET TITLE
02	SIGNATURE SHEET
11	SIGNAL NOTES AND QUANTITIES
12	SIGNALIZATION PLAN AT NE 9TH ST AND NE 16TH AVE
13	SIGNALIZATION PLAN AT NE 9TH ST AND NE 22RD AVE
14	SPAN TABULATION
15	SPAN SCHEDULE
16	GUIDES ON WORKSHEET
18	SPECIAL DETAILS

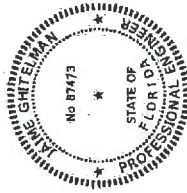

THESE ITEMS HAVE BEEN DIGITALLY SIGNED AND SEALED BY JAIME GHITELMAN ON THE DATE ADJACENT TO THE SEAL. THE SIGNATURE MUST BE VERIFIED ON ANY ELECTRONIC COPIES.

KIMLEY-HORN AND ASSOCIATES, INC.
 8201 PETERS RD., SUITE 2200
 PLANTATION, FLORIDA 33324
 REGISTRY 35108
 JAIME GHITELMAN, P.E. 87473

THE ABOVE NAMED PROFESSIONAL ENGINEER SHALL BE RESPONSIBLE FOR THE FOLLOWING SHEETS IN ACCORDANCE WITH RULE 61G15-23.004, F.A.C.

SHEET NO.	SHEET TITLE
02	SIGNATURE SHEET
13	STRAY POLE SCHEDULE
17	INSTALLATION ASSEMBLIES DESIGN TABLE

NO.	DATE	BY	DESCRIPTION



PROJECT NO. 14C107050
 PROJECT TITLE: STRAY POLE DESIGN
 CLIENT: ALACHUA

CITY OF GAINESVILLE
 NE 9TH STREET DESIGN

SHEET NO. 02

SIGNATURE SHEET

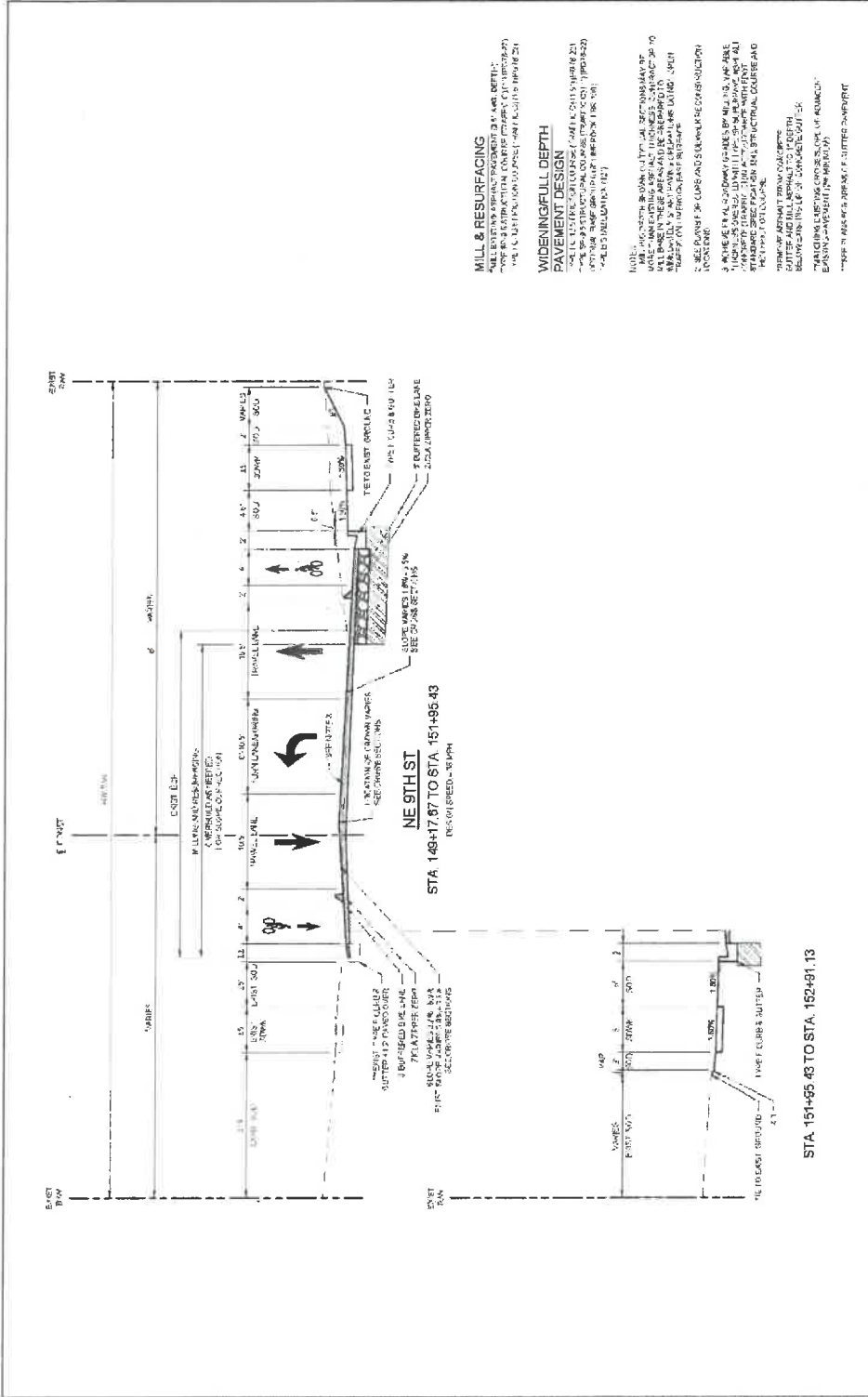

REVISIONS		DATE		BY		APP'D		SCALE		PROJECT		SHEET							
<p>Kimley Horn</p> <p>CONSULTANTS</p> <p>1401 WEST BROADWAY, SUITE 200, ALABAMA CITY, AL 35009</p> <p>PH: 205-442-1100 FAX: 205-442-1101</p>										<p>CITY OF GAINESVILLE</p> <p>NE 9TH STREET DESIGN</p>		<p>PROJECT</p> <p>ALABAMA</p> <p>14810780</p>		<p>DATE</p> <p>11/11/17</p>		<p>SCALE</p> <p>AS SHOWN</p>		<p>SHEET</p> <p>05</p>	

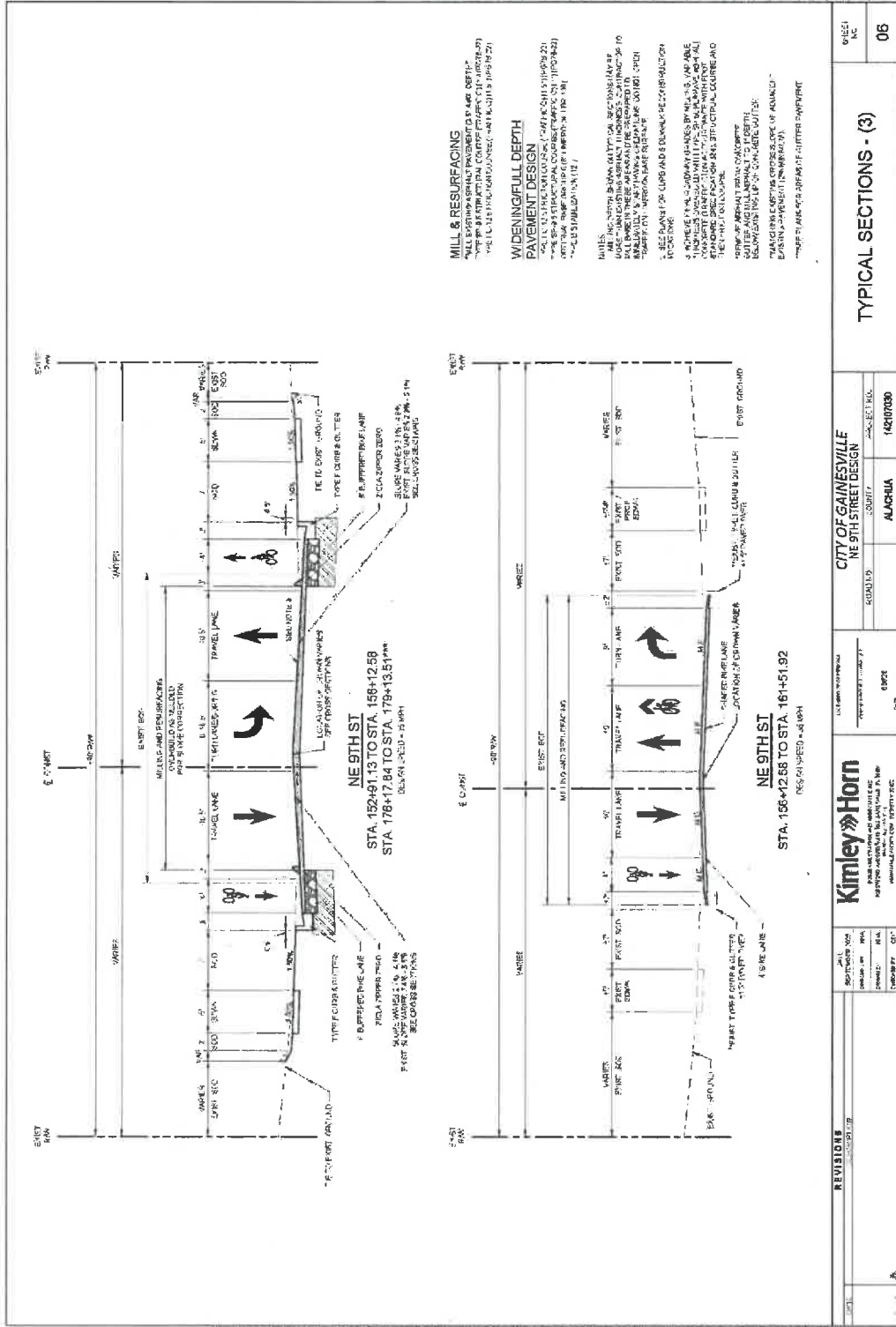

MILL & RESURFACING
 MILL EXISTING ASPHALT PAVEMENT TO 6" A.G.C. DEPTH
 TYPE III PORTLAND CEMENT CONCRETE (C1) (100% 2")
 4" (1.5) 1.5" (100% 2")
 4" (1.5) 1.5" (100% 2")

WIDENING/FULL DEPTH PAVEMENT DESIGN
 MILL EXISTING ASPHALT PAVEMENT TO 6" A.G.C. DEPTH
 TYPE III PORTLAND CEMENT CONCRETE (C1) (100% 2")
 4" (1.5) 1.5" (100% 2")
 4" (1.5) 1.5" (100% 2")

NOTE:
 1. SEE PLANS FOR CURB AND GUTTER RECONSTRUCTION
 2. SEE PLANS FOR CURB AND GUTTER RECONSTRUCTION
 3. SEE PLANS FOR CURB AND GUTTER RECONSTRUCTION
 4. SEE PLANS FOR CURB AND GUTTER RECONSTRUCTION
 5. SEE PLANS FOR CURB AND GUTTER RECONSTRUCTION
 6. SEE PLANS FOR CURB AND GUTTER RECONSTRUCTION
 7. SEE PLANS FOR CURB AND GUTTER RECONSTRUCTION
 8. SEE PLANS FOR CURB AND GUTTER RECONSTRUCTION
 9. SEE PLANS FOR CURB AND GUTTER RECONSTRUCTION
 10. SEE PLANS FOR CURB AND GUTTER RECONSTRUCTION
 11. SEE PLANS FOR CURB AND GUTTER RECONSTRUCTION
 12. SEE PLANS FOR CURB AND GUTTER RECONSTRUCTION
 13. SEE PLANS FOR CURB AND GUTTER RECONSTRUCTION
 14. SEE PLANS FOR CURB AND GUTTER RECONSTRUCTION
 15. SEE PLANS FOR CURB AND GUTTER RECONSTRUCTION
 16. SEE PLANS FOR CURB AND GUTTER RECONSTRUCTION
 17. SEE PLANS FOR CURB AND GUTTER RECONSTRUCTION
 18. SEE PLANS FOR CURB AND GUTTER RECONSTRUCTION
 19. SEE PLANS FOR CURB AND GUTTER RECONSTRUCTION
 20. SEE PLANS FOR CURB AND GUTTER RECONSTRUCTION
 21. SEE PLANS FOR CURB AND GUTTER RECONSTRUCTION
 22. SEE PLANS FOR CURB AND GUTTER RECONSTRUCTION
 23. SEE PLANS FOR CURB AND GUTTER RECONSTRUCTION
 24. SEE PLANS FOR CURB AND GUTTER RECONSTRUCTION
 25. SEE PLANS FOR CURB AND GUTTER RECONSTRUCTION
 26. SEE PLANS FOR CURB AND GUTTER RECONSTRUCTION
 27. SEE PLANS FOR CURB AND GUTTER RECONSTRUCTION
 28. SEE PLANS FOR CURB AND GUTTER RECONSTRUCTION
 29. SEE PLANS FOR CURB AND GUTTER RECONSTRUCTION
 30. SEE PLANS FOR CURB AND GUTTER RECONSTRUCTION
 31. SEE PLANS FOR CURB AND GUTTER RECONSTRUCTION
 32. SEE PLANS FOR CURB AND GUTTER RECONSTRUCTION
 33. SEE PLANS FOR CURB AND GUTTER RECONSTRUCTION
 34. SEE PLANS FOR CURB AND GUTTER RECONSTRUCTION
 35. SEE PLANS FOR CURB AND GUTTER RECONSTRUCTION
 36. SEE PLANS FOR CURB AND GUTTER RECONSTRUCTION
 37. SEE PLANS FOR CURB AND GUTTER RECONSTRUCTION
 38. SEE PLANS FOR CURB AND GUTTER RECONSTRUCTION
 39. SEE PLANS FOR CURB AND GUTTER RECONSTRUCTION
 40. SEE PLANS FOR CURB AND GUTTER RECONSTRUCTION
 41. SEE PLANS FOR CURB AND GUTTER RECONSTRUCTION
 42. SEE PLANS FOR CURB AND GUTTER RECONSTRUCTION
 43. SEE PLANS FOR CURB AND GUTTER RECONSTRUCTION
 44. SEE PLANS FOR CURB AND GUTTER RECONSTRUCTION
 45. SEE PLANS FOR CURB AND GUTTER RECONSTRUCTION
 46. SEE PLANS FOR CURB AND GUTTER RECONSTRUCTION
 47. SEE PLANS FOR CURB AND GUTTER RECONSTRUCTION
 48. SEE PLANS FOR CURB AND GUTTER RECONSTRUCTION
 49. SEE PLANS FOR CURB AND GUTTER RECONSTRUCTION
 50. SEE PLANS FOR CURB AND GUTTER RECONSTRUCTION
 51. SEE PLANS FOR CURB AND GUTTER RECONSTRUCTION
 52. SEE PLANS FOR CURB AND GUTTER RECONSTRUCTION
 53. SEE PLANS FOR CURB AND GUTTER RECONSTRUCTION
 54. SEE PLANS FOR CURB AND GUTTER RECONSTRUCTION
 55. SEE PLANS FOR CURB AND GUTTER RECONSTRUCTION
 56. SEE PLANS FOR CURB AND GUTTER RECONSTRUCTION
 57. SEE PLANS FOR CURB AND GUTTER RECONSTRUCTION
 58. SEE PLANS FOR CURB AND GUTTER RECONSTRUCTION
 59. SEE PLANS FOR CURB AND GUTTER RECONSTRUCTION
 60. SEE PLANS FOR CURB AND GUTTER RECONSTRUCTION
 61. SEE PLANS FOR CURB AND GUTTER RECONSTRUCTION
 62. SEE PLANS FOR CURB AND GUTTER RECONSTRUCTION
 63. SEE PLANS FOR CURB AND GUTTER RECONSTRUCTION
 64. SEE PLANS FOR CURB AND GUTTER RECONSTRUCTION
 65. SEE PLANS FOR CURB AND GUTTER RECONSTRUCTION
 66. SEE PLANS FOR CURB AND GUTTER RECONSTRUCTION
 67. SEE PLANS FOR CURB AND GUTTER RECONSTRUCTION
 68. SEE PLANS FOR CURB AND GUTTER RECONSTRUCTION
 69. SEE PLANS FOR CURB AND GUTTER RECONSTRUCTION
 70. SEE PLANS FOR CURB AND GUTTER RECONSTRUCTION
 71. SEE PLANS FOR CURB AND GUTTER RECONSTRUCTION
 72. SEE PLANS FOR CURB AND GUTTER RECONSTRUCTION
 73. SEE PLANS FOR CURB AND GUTTER RECONSTRUCTION
 74. SEE PLANS FOR CURB AND GUTTER RECONSTRUCTION
 75. SEE PLANS FOR CURB AND GUTTER RECONSTRUCTION
 76. SEE PLANS FOR CURB AND GUTTER RECONSTRUCTION
 77. SEE PLANS FOR CURB AND GUTTER RECONSTRUCTION
 78. SEE PLANS FOR CURB AND GUTTER RECONSTRUCTION
 79. SEE PLANS FOR CURB AND GUTTER RECONSTRUCTION
 80. SEE PLANS FOR CURB AND GUTTER RECONSTRUCTION
 81. SEE PLANS FOR CURB AND GUTTER RECONSTRUCTION
 82. SEE PLANS FOR CURB AND GUTTER RECONSTRUCTION
 83. SEE PLANS FOR CURB AND GUTTER RECONSTRUCTION
 84. SEE PLANS FOR CURB AND GUTTER RECONSTRUCTION
 85. SEE PLANS FOR CURB AND GUTTER RECONSTRUCTION
 86. SEE PLANS FOR CURB AND GUTTER RECONSTRUCTION
 87. SEE PLANS FOR CURB AND GUTTER RECONSTRUCTION
 88. SEE PLANS FOR CURB AND GUTTER RECONSTRUCTION
 89. SEE PLANS FOR CURB AND GUTTER RECONSTRUCTION
 90. SEE PLANS FOR CURB AND GUTTER RECONSTRUCTION
 91. SEE PLANS FOR CURB AND GUTTER RECONSTRUCTION
 92. SEE PLANS FOR CURB AND GUTTER RECONSTRUCTION
 93. SEE PLANS FOR CURB AND GUTTER RECONSTRUCTION
 94. SEE PLANS FOR CURB AND GUTTER RECONSTRUCTION
 95. SEE PLANS FOR CURB AND GUTTER RECONSTRUCTION
 96. SEE PLANS FOR CURB AND GUTTER RECONSTRUCTION
 97. SEE PLANS FOR CURB AND GUTTER RECONSTRUCTION
 98. SEE PLANS FOR CURB AND GUTTER RECONSTRUCTION
 99. SEE PLANS FOR CURB AND GUTTER RECONSTRUCTION
 100. SEE PLANS FOR CURB AND GUTTER RECONSTRUCTION

REVISIONS		CITY OF GAINESVILLE		DATE: 06/21/19
NO.	DATE	BY	REASON	PROJECT NO.
1				1420700
			ALACHUA	
		CITY OF GAINESVILLE		
		NE 9TH STREET DESIGN		
		ALACHUA		
		Kimley Horn		
		KIMLEY HORN AND ASSOCIATES, INC.		
		10000 15TH AVENUE, SUITE 100		
		GAINESVILLE, FL 32608		
		TEL: 352-336-7000		
		WWW.KIMLEYHORN.COM		

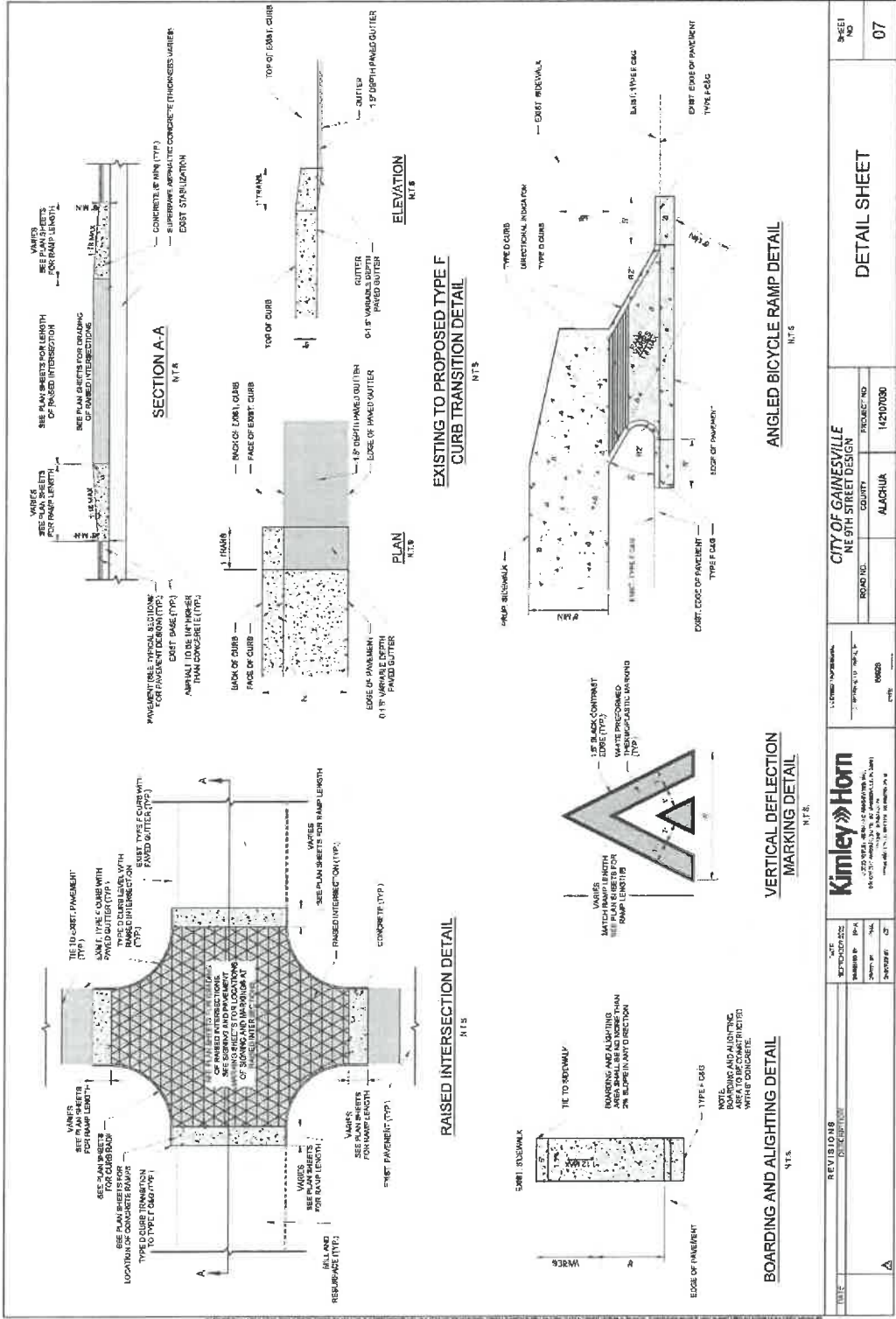

REVISIONS		DATE	BY	CHKD	APP'D
<p>Kimley-Horn INCORPORATED 1000 W. 10th Street, Suite 200 Gainesville, TX 77901 PH: 817.241.0000 WWW.KIMLEY-HORN.COM</p>					
CITY OF GAINESVILLE NE 9TH STREET DESIGN		PROJECT NO.	14210700	COUNTY	ALACHUA
ROAD NO.					
SHEET NO.		07			
DETAIL SHEET					

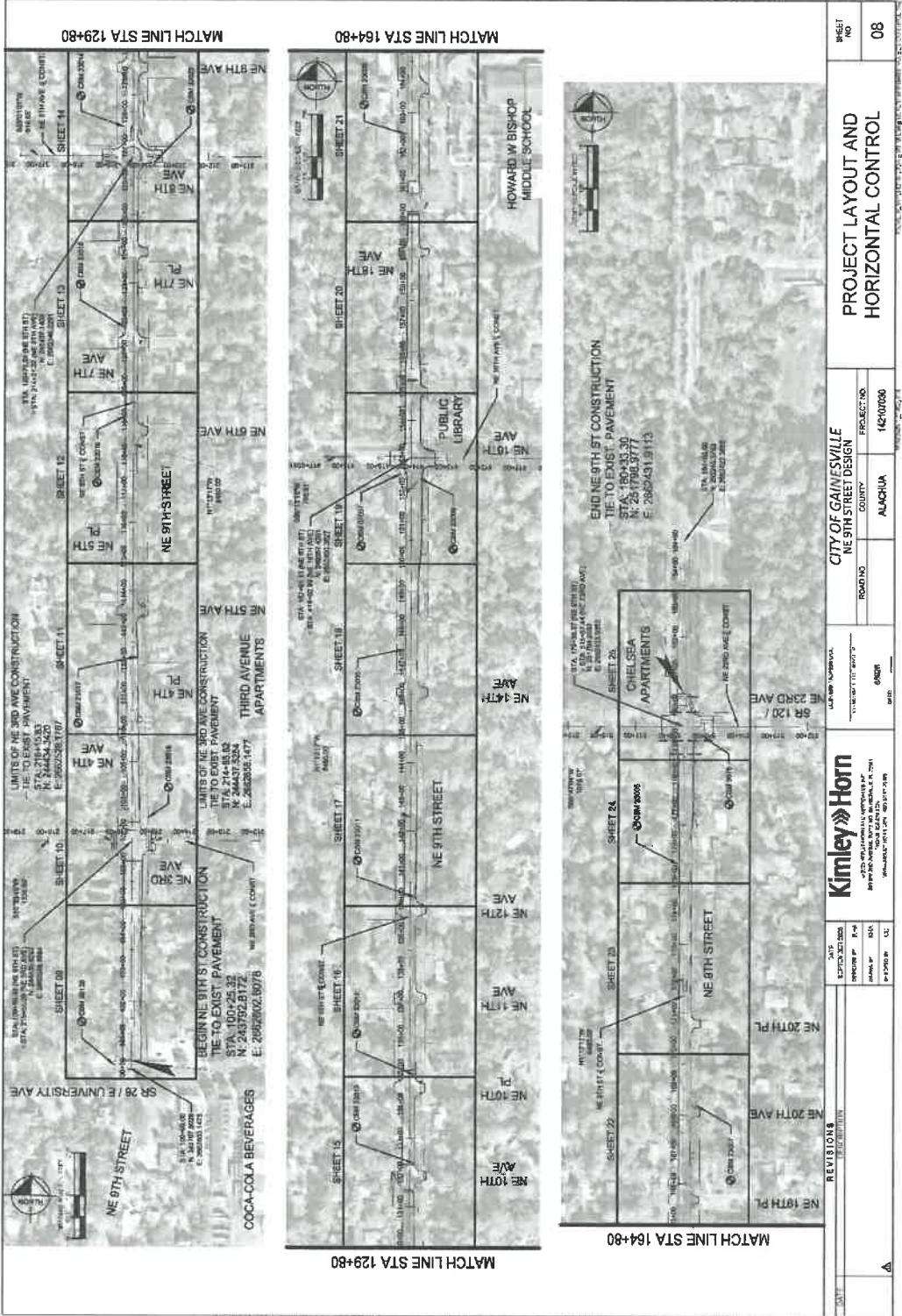

REVISIONS		DATE	BY	CHKD	APP'D	LC

CITY OF GAINESVILLE		PROJECT NO.	14240020
NE 9TH STREET DESIGN		COUNTY	ALACHUA
ROAD NO.		SR 120	
DATE		08/20/20	

PROJECT LAYOUT AND HORIZONTAL CONTROL		SHEET NO.	08
---------------------------------------	--	-----------	----

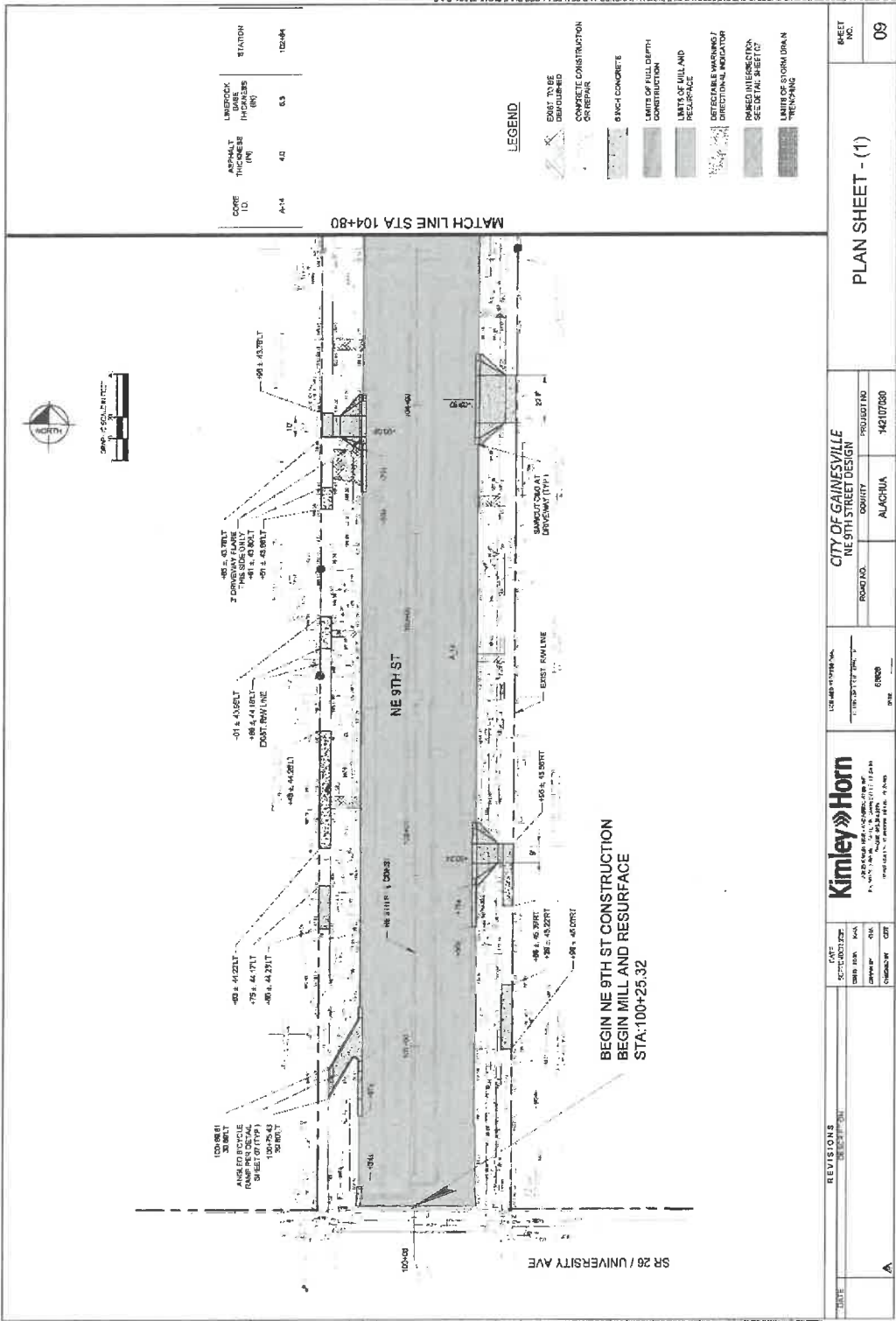

CORE ID	ANNUAL THICKNESS (IN)	UNDERLAY THICKNESS (IN)	STATION
A-4	4.0	0.5	100+80

LEGEND

- EXIST TO BE DEMOLISHED OR REPAIR
- 6 INCH CONCRETE
- LIMITS OF FULL DEPTH CONSTRUCTION
- 1/2 INCH MILL AND PATCH
- DETECTABLE WARNING / DIRECTIONAL INDICATOR
- RAISED INTERSECTION SPEED TABLE
- LIMITS OF STORM DRAIN TRENCHING

DATE	REVISIONS	DATE	BY	CHK	APP	PROJECT NO.	PROJECT NO.	PROJECT NO.
						14307280	14307280	14307280
						CITY	CITY	CITY
						ALACHUA	ALACHUA	ALACHUA

PLAN SHEET - (1)

Kimley Horn

CITY OF GAINESVILLE
NE 9TH STREET DESIGN

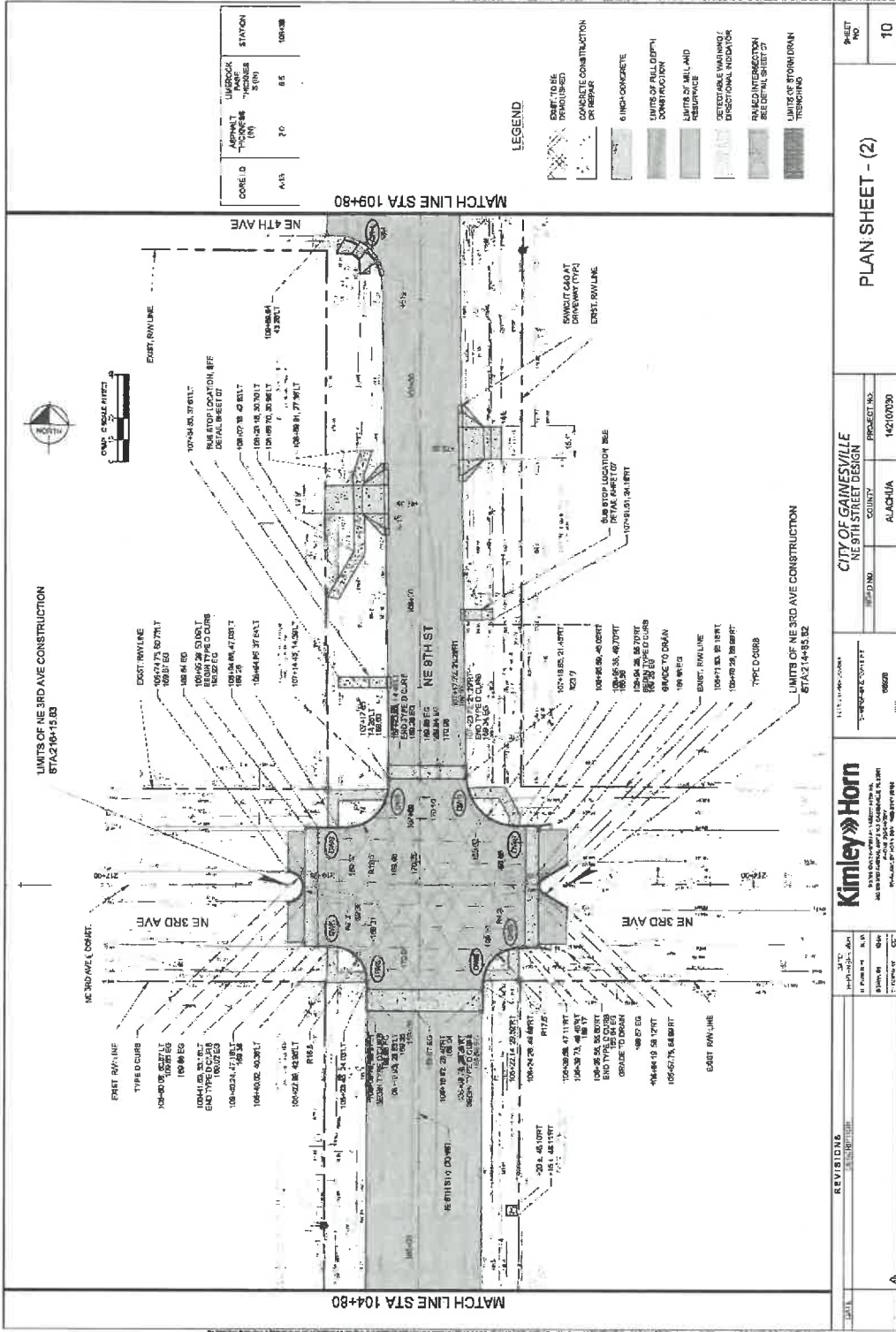

CORE ID	LOCATION	MARKING	STATION
AA5	7.0	8.5	109+38

LEGEND

- CONCRETE CONSTRUCTION OR REPAIR
- 6 INCH CONCRETE
- LIMITS OF FULL DEPTH CONSTRUCTION
- LIMITS OF FULL AND REPAIR
- DETECTABLE WARNING / DIRECTIONAL INDICATOR
- RAISED INTERSECTION
- LIMITS OF STORM DRAIN TRENCHING

PLAN SHEET - (2)	
SHEET NO.	10

CITY OF GAINESVILLE	PROJECT NO.
NE 8TH STREET DESIGN	14210730
COUNTY	ALACHUA

DATE	10/20/20
DESIGNER	10/20/20
CHECKED	10/20/20
APPROVED	10/20/20

Kimley-Horn

1115 W. Lake Wales Ave.
Gainesville, FL 32609
813-351-2200
www.kimley-horn.com

NO.	DATE	BY	CHKD.	APP'D.	DESCRIPTION
1	10/20/20	JLH	WJL	JLH	ISSUED FOR PERMIT

REVISIONS					
NO.	DATE	BY	CHKD.	APP'D.	DESCRIPTION
1	10/20/20	JLH	WJL	JLH	ISSUED FOR PERMIT

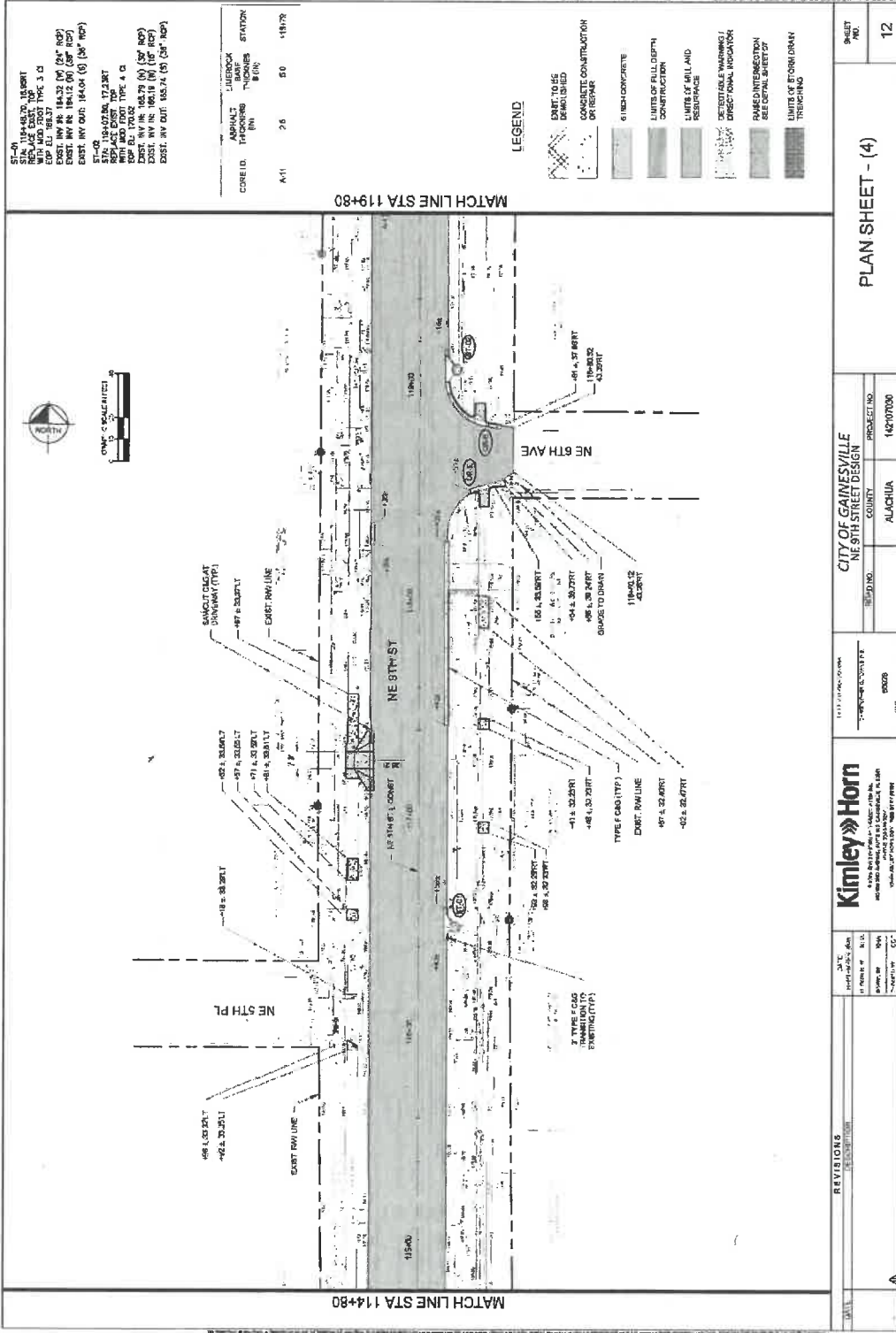

ST-01
 STA. 114+80.00, 15' OFFSET
 WITH MOD. 2000 TYPE 3 C
 COP. EQ. 188.37
 EXIST. HWY IN. 184.32 (6) (50' ROP)
 EXIST. HWY IN. 184.12 (6) (50' ROP)
 EXIST. HWY OUT. 184.04 (6) (50' ROP)
 ST-02
 STA. 114+80.00, 15' OFFSET
 WITH MOD. 2000 TYPE 3 C
 COP. EQ. 188.37
 EXIST. HWY IN. 184.32 (6) (50' ROP)
 EXIST. HWY IN. 184.12 (6) (50' ROP)
 EXIST. HWY OUT. 184.04 (6) (50' ROP)

CORE ID	APPROX. STATION	DESCRIPTION	
A11	26	50	18/79

LEGEND

[Symbol]	EXIST. TO BE DEMOLISHED
[Symbol]	CONCRETE CONSTRUCTION OR REPAIR
[Symbol]	6 INCH CONCRETE
[Symbol]	LIMITS OF FULL DEPTH CONSTRUCTION
[Symbol]	LIMITS OF FULL AND RESURFACE
[Symbol]	DETECTABLE WARNING / DIRECTIONAL INDICATOR
[Symbol]	PAVED INTERSECTION
[Symbol]	UNPAVED INTERSECTION
[Symbol]	LIMITS OF STORM DRAIN TRENCHING

CITY OF GAINESVILLE NE 8TH STREET DESIGN		PROJECT NO. 142107000	SHEET NO. 12
COUNTY ALACHUA		DATE 05/20/20	
DESIGNER KIMLEY HORN		CHECKER [Name]	
SCALE AS SHOWN		DATE PLOTTED 05/20/20	

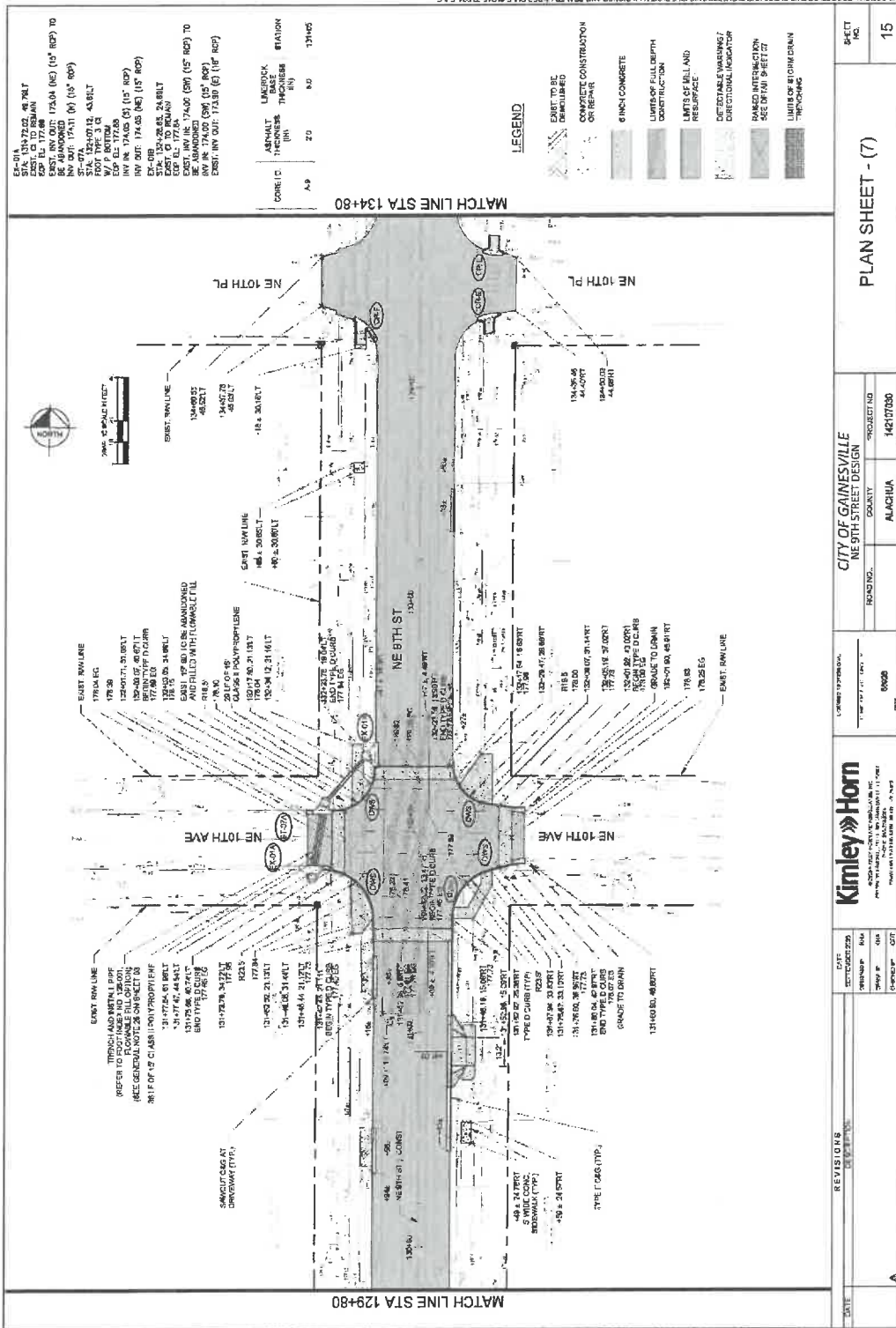

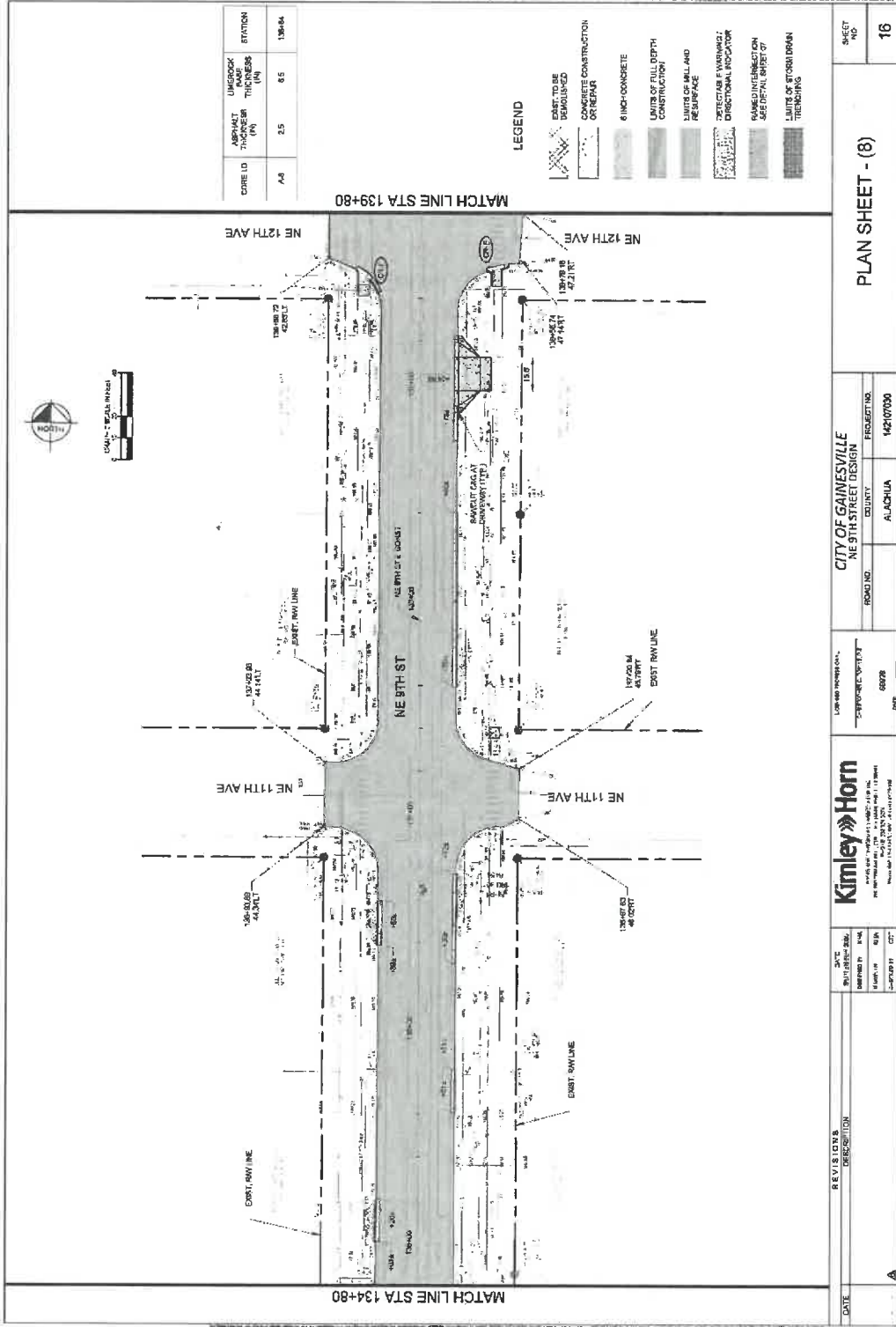

CORE ID	ASPHALT THICKNESS (IN)	UNDERLAY RAMP THICKNESS (IN)	STATION
A8	2.5	6.5	138+84

- LEGEND**
- [Symbol] EAST TO BE DEMOLISHED OR REPAIR
 - [Symbol] CONCRETE CONSTRUCTION
 - [Symbol] 6 INCH CONCRETE
 - [Symbol] LIMITS OF FULL DEPTH CONSTRUCTION
 - [Symbol] LIMITS OF ALL AND RESURFACE
 - [Symbol] DETECTOR WARNING ZONATIONAL INDICATOR
 - [Symbol] RAINWATER DRAINAGE DETAIL SHEET 07
 - [Symbol] LIMITS OF STORM DRAIN TRENCHING

REVISIONS		DATE	
NO.	DESCRIPTION	DATE	BY
A			

CITY OF GAINESVILLE		PROJECT NO.	
NE 8TH STREET DESIGN		14210700	
ROAD NO.	COUNTY	PROJECT NO.	
	ALACHUA	14210700	

DATE	BY	CHECKED BY	DATE

PLAN SHEET - (8)

SHEET NO. 18

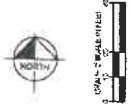
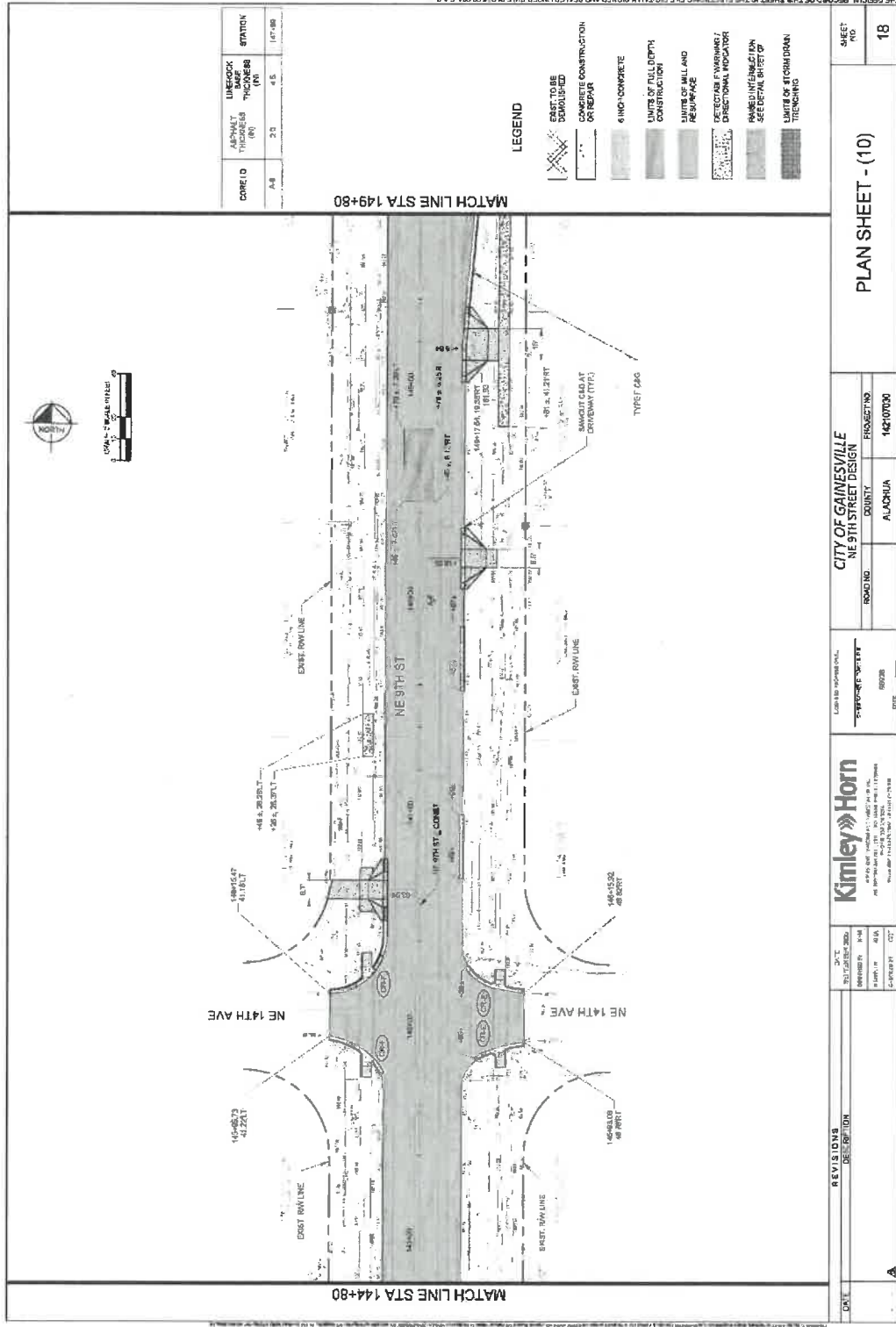

CORE ID	ASPHALT THICKNESS (IN)	LIMESTOCK THICKNESS (IN)	STATION
A-8	2.0	4.5	147+80

MATCH LINE STA 149+80

MATCH LINE STA 144+80

LEGEND

- EAST TO BE DEMOLISHED
- CONCRETE CONSTRUCTION OR REPAIR
- 6 IN. CONCRETE
- LIMITS OF FULL DEPTH CONSTRUCTION
- LIMITS OF MILL AND REPAVE
- DETECTABLE WARNING / PROTRUSION LOCATION
- RAISED INTERSECTION SEE DETAIL SHEET 07
- LIMITS OF STORM DRAIN TRENCH

REVISIONS DATE: _____ DESCRIPTION: _____ DESIGNED BY: _____ CHECKED BY: _____ DATE: _____		Kimley Horn 1400 N. GAINESVILLE STREET SUITE 200 GAINESVILLE, FL 32609 PHONE: 352.369.4300 FAX: 352.369.4308		LOW BID NUMBER: _____ PROJECT NUMBER: _____ PROJECT NAME: _____ COUNTY: _____ CITY: _____		CITY OF GAINESVILLE NE 9TH STREET DESIGN COUNTY: ALACHUA PROJECT NO: 144-10700 SHEET NO: 18	
---	--	---	--	---	--	--	--

PLAN SHEET - (10)

THE ORIGINAL RECORD OF THIS SHEET IS THE ELECTRONIC FILE DIGITALLY SIGNED AND SEALED UNDER RULE 61B-12.004, F.A.C.

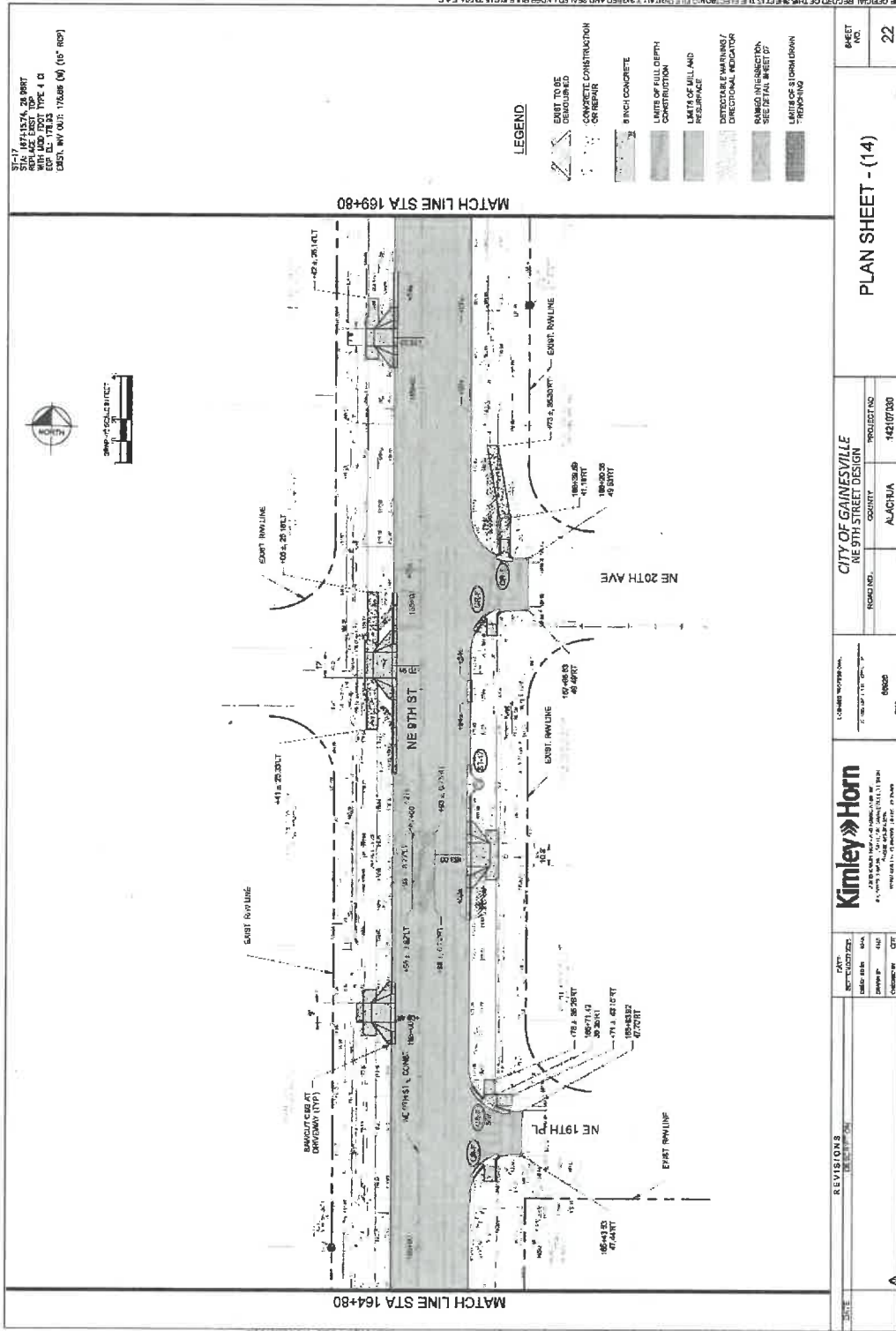

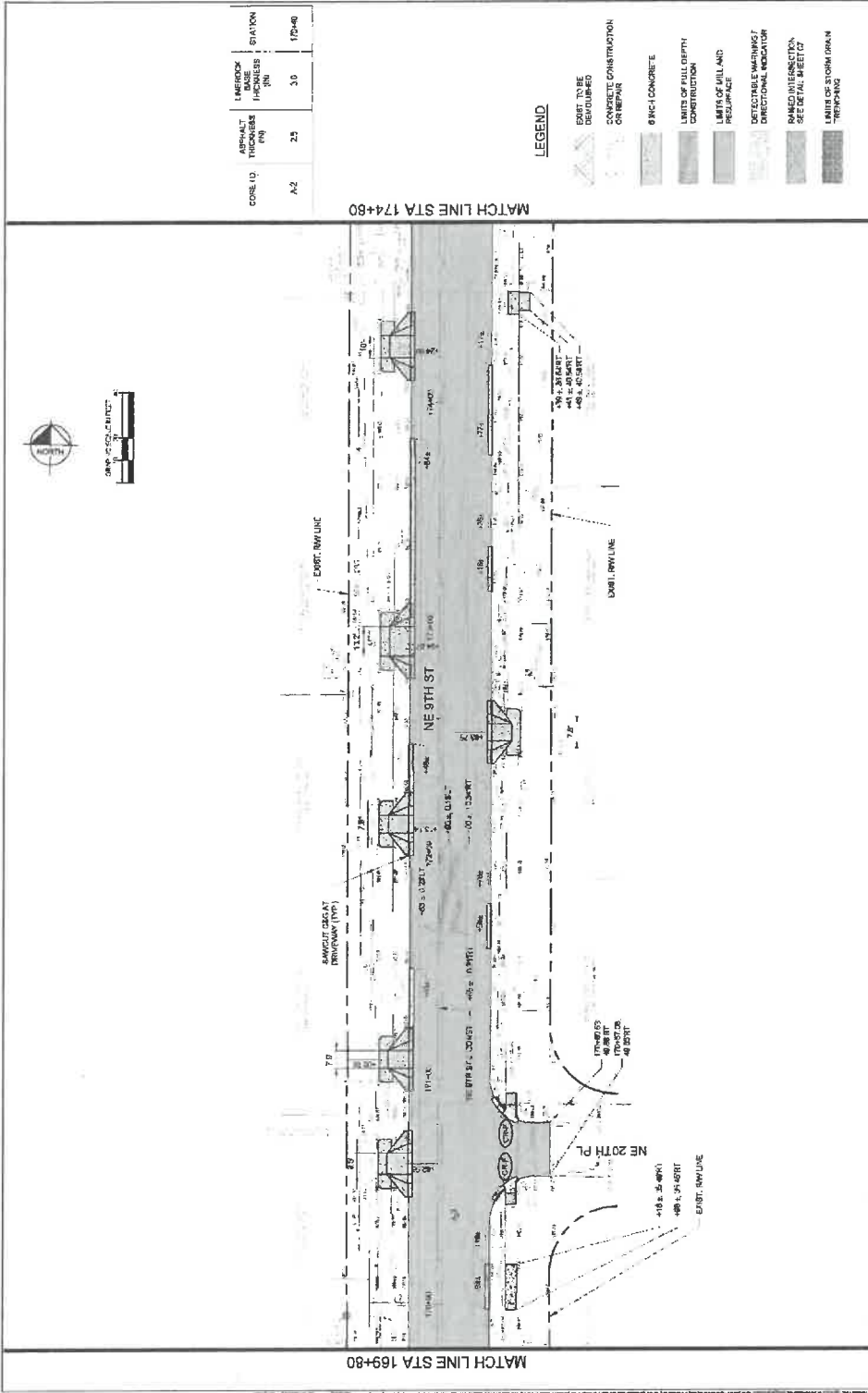

CONC'D	THICKNESS (IN)	LAYER/ROCK BASE FINISHES (IN)	STATION
A-2	2.5	3.0	170+00

LEGEND

- EXIST TO BE DEMOLISHED OR REPAIR
- CONCRETE CONSTRUCTION
- 8 IN.-CONCRETE
- LIMIT OF FULL DEPTH CONSTRUCTION
- LIMIT OF MILL AND PATCH
- DETECTABLE WARNING/DIRECTIONAL INDICATOR
- DETECTABLE WARNING/DIRECTIONAL INDICATOR
- LIMIT OF STORM DRAIN "TEMPING"

REVISIONS DATE: _____ BY: _____		Kimley Horn <small>ALABAMA REGISTERED PROFESSIONAL ENGINEERS AND ARCHITECTS 1000 UNIVERSITY BLVD., SUITE 200 TUSCALOOSA, ALABAMA 35403</small>		CITY OF GAINESVILLE NINTH STREET DESIGN COUNTY: ALACHUA PROJECT NO: 142107830 ROAD NO.: _____ DATE: 6/20/08		PLAN SHEET - (15) SHEET NO. 23	
---	--	--	--	---	--	--	--

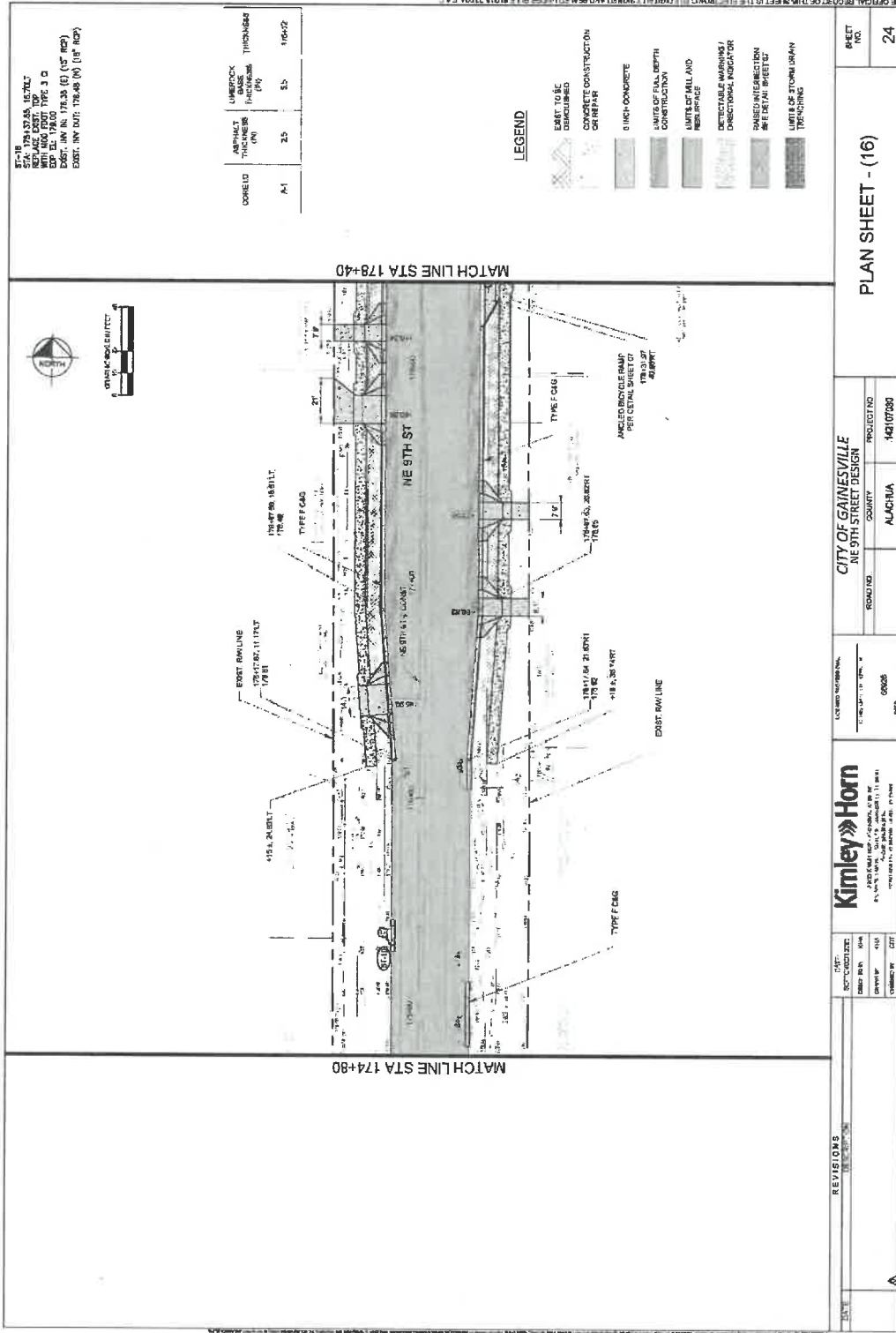

EC-18
 STA. 178+22.00 TO 187+74.75
 WITH 18\"/>

CORREL	APPROXIMATE TOLERANCE (IN)	UNDERLAY BANK THICKNESS (IN)	THICKNESS
A-1	± 0.5	± 0.5	100-22

LEGEND

- CONCRETE CONSTRUCTION
- 8 INCH CONCRETE
- LIMITS OF UTILITY DEPTH CONSTRUCTION
- LIMITS OF UTILITY AND RESTRIPIING
- DETECTABLE WARNINGS / DIRECTIONAL INDICATOR
- SIDEWALK SECTION
- LIMITS OF STORM DRAIN TRENCHING

REVISIONS DATE: _____ BY: _____ CHECKED BY: _____ DATE: _____ DESIGNED BY: _____ DATE: _____ DRAWN BY: _____ DATE: _____		CITY OF GAINESVILLE NE 9TH STREET DESIGN COUNTY: ALACHUA PROJECT NO: 143107830		SHEET NO. 24
Kimley Horn ENGINEERS, ARCHITECTS, PLANNERS 1000 UNIVERSITY BLVD., SUITE 200 GAINESVILLE, FL 32601 TEL: 352.339.1111 WWW.KIMLEYHORN.COM		ROAD NO.: _____ COUNTY: ALACHUA PROJECT NO: 143107830	PLAN SHEET - (16)	

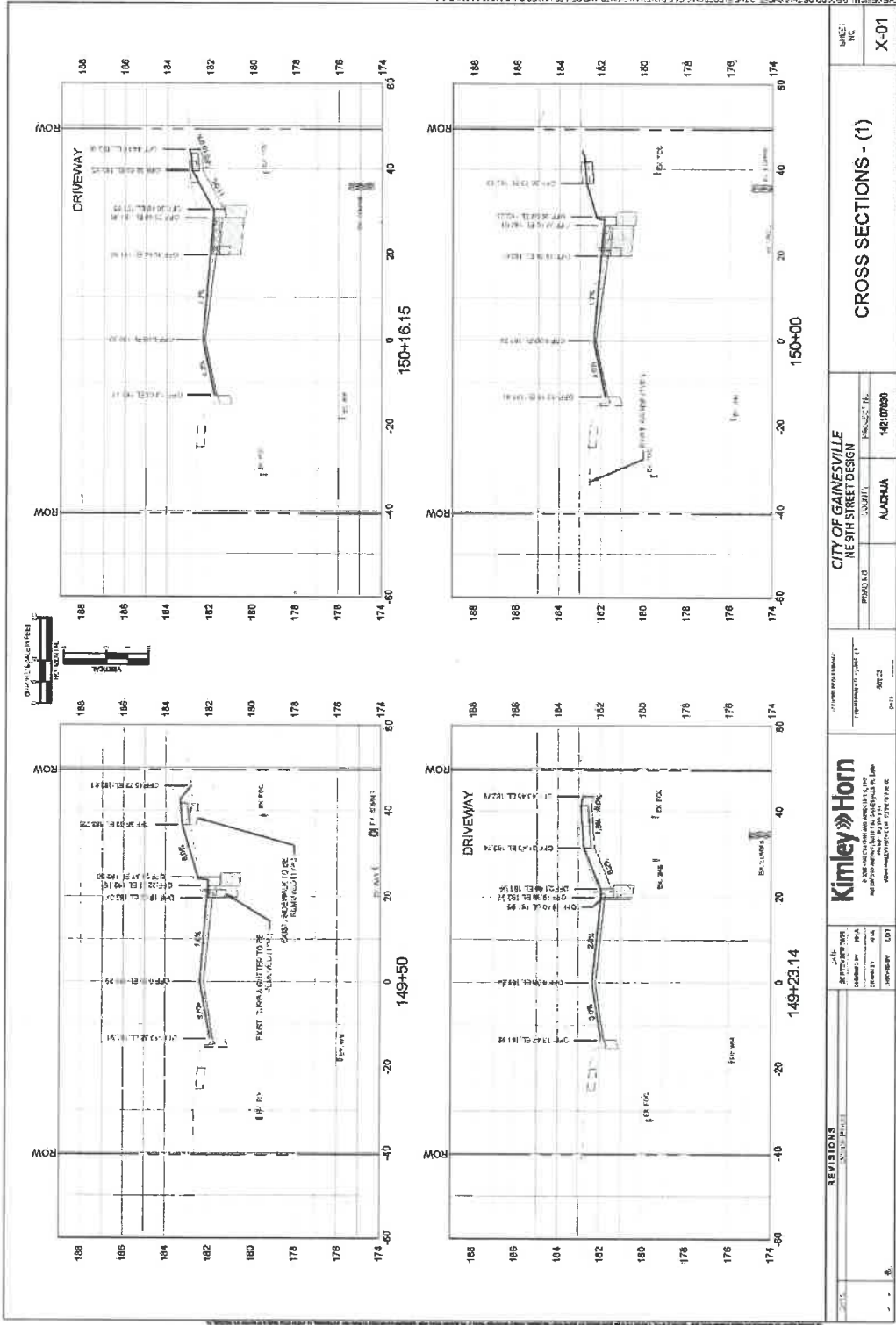

REVISIONS		CITY OF GAINESVILLE		CROSS SECTIONS - (1)		SHEET	
NO.	DATE	PROJECT	LOCATION	PROJECT NO.	DATE	NO.	DATE
		NE 9TH STREET DESIGN	ALACHUA	142107039		X-01	

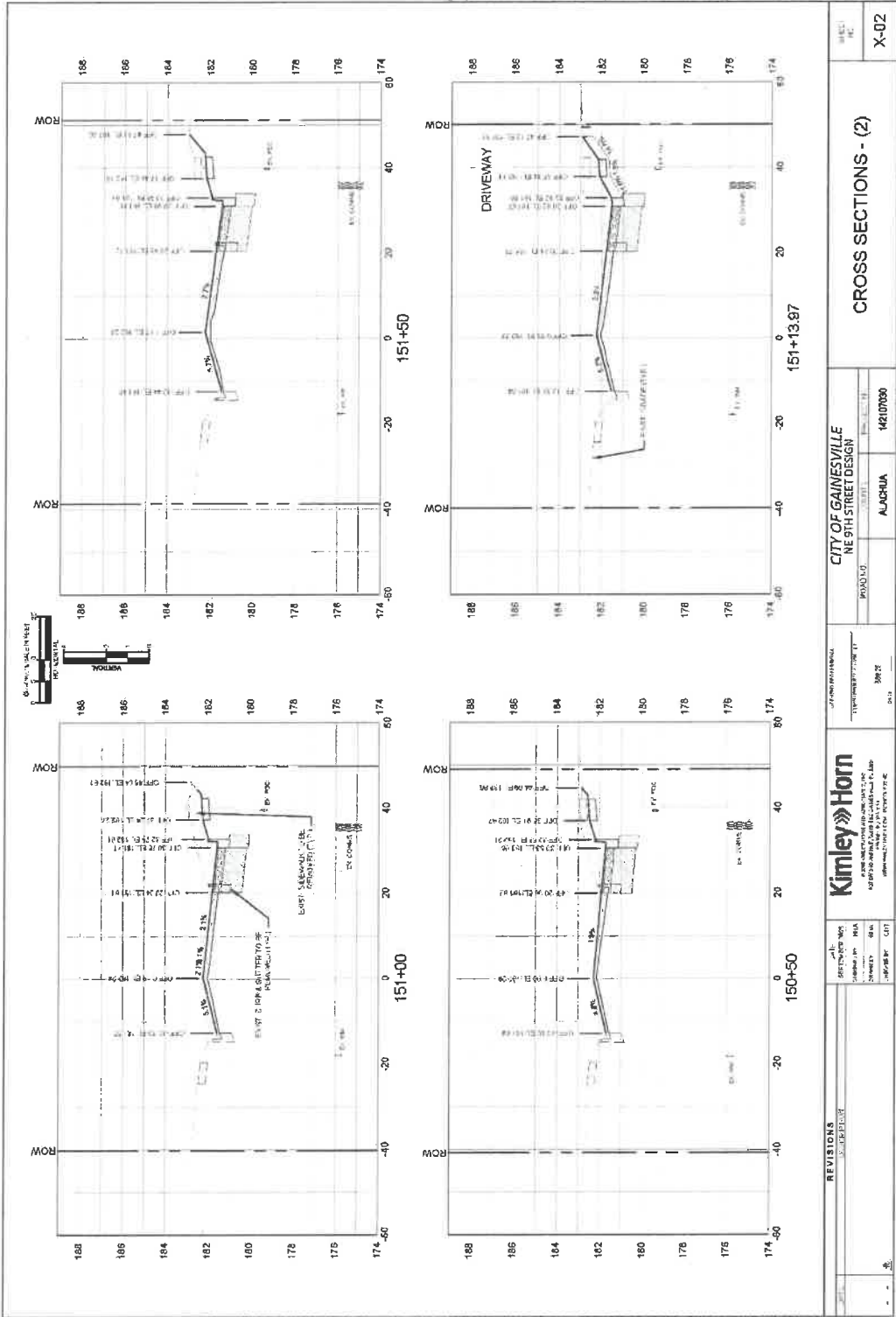

REVISIONS		CITY OF GAINESVILLE NE 9TH STREET DESIGN		CROSS SECTIONS - (2)	
NO.	DATE	BY	CHKD	PROJECT	SHEET NO.
1				ALACHUA	X-02
DESIGNED BY: KIMLEY-HORN			PROJECT NO: 142107030		
CHECKED BY: M.A.			DATE: 3/27/14		
DRAWN BY: C.J.T.			SCALE: AS SHOWN		

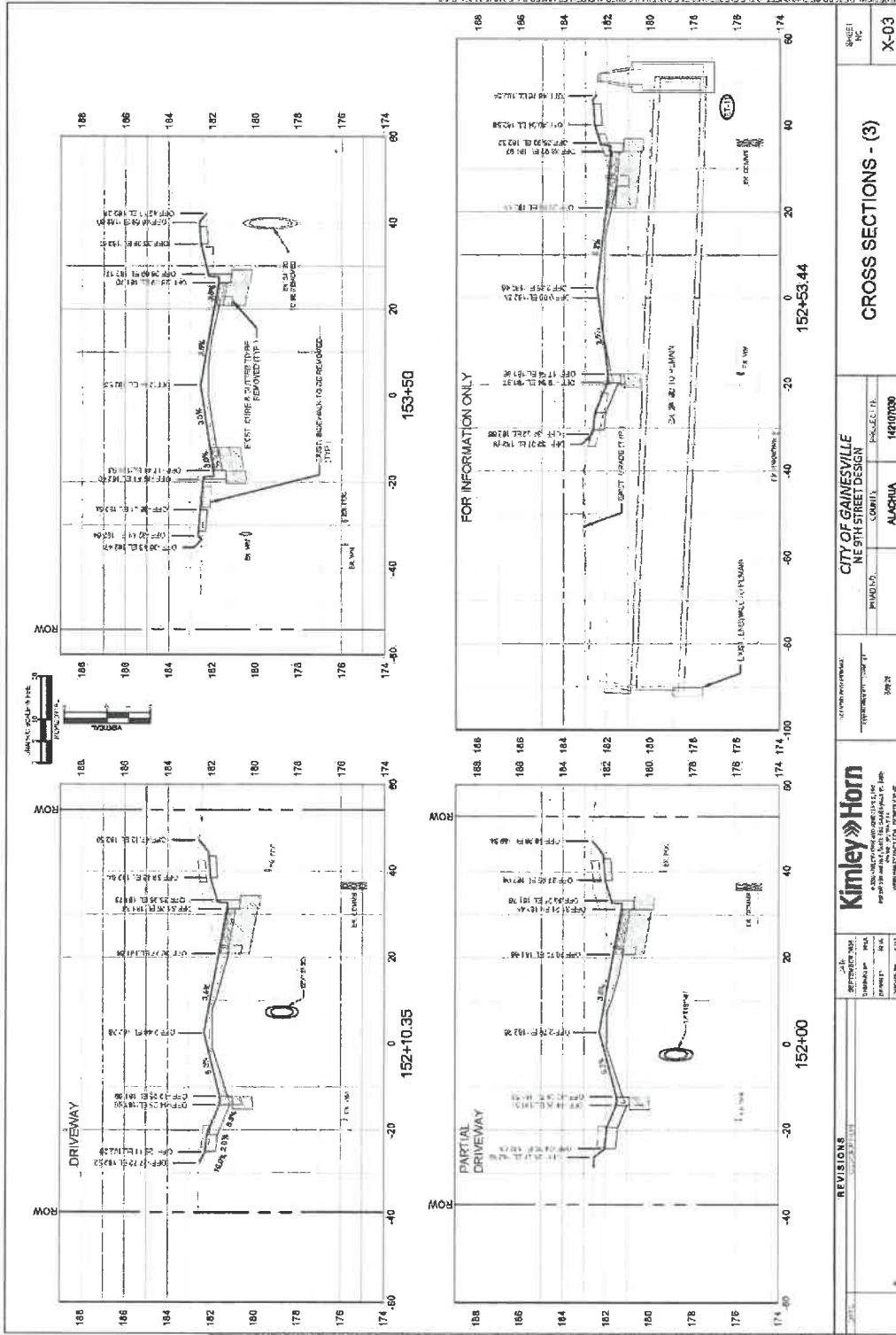

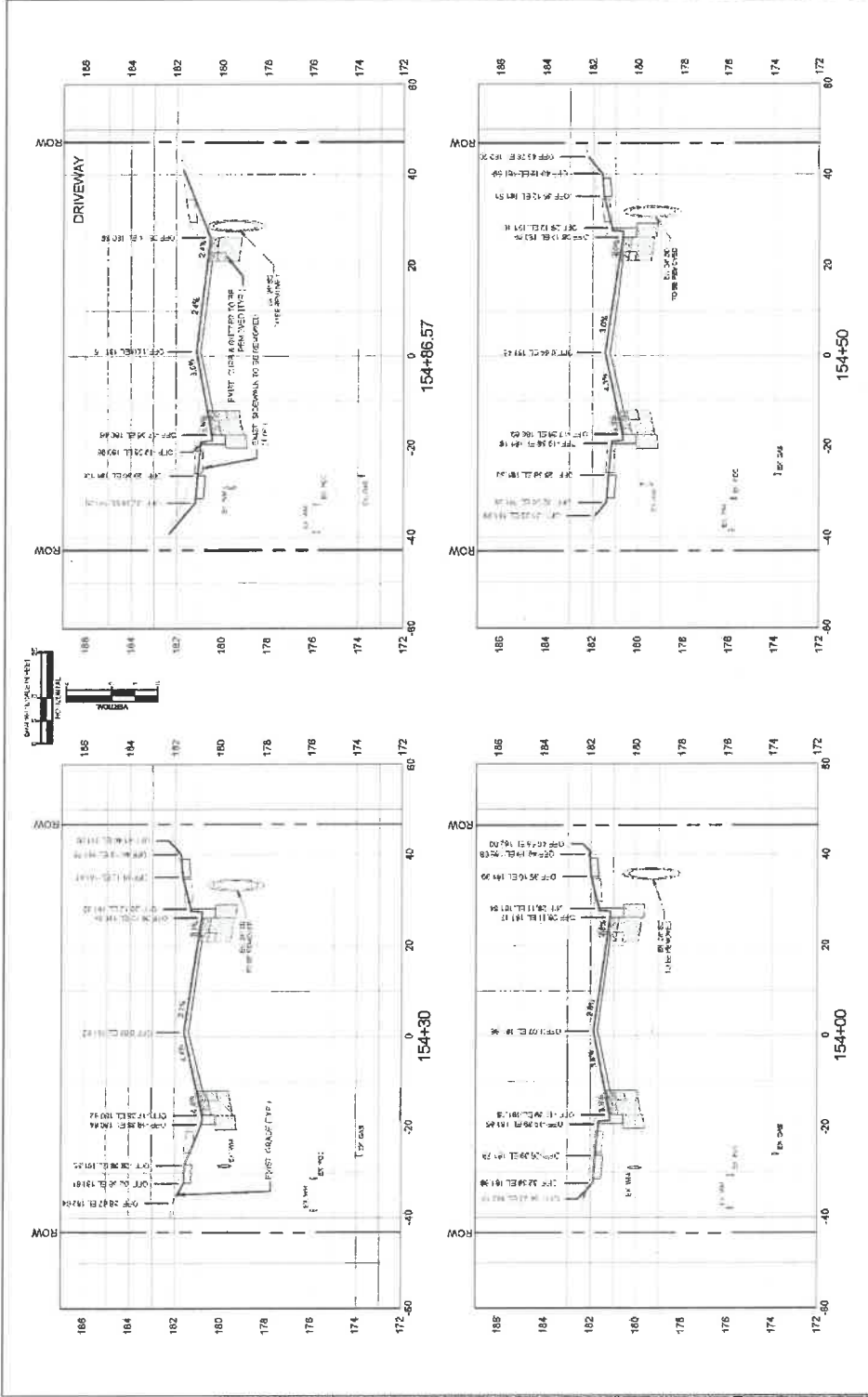

REVISIONS		Kimley Horn		CITY OF GAINESVILLE		CROSS SECTIONS - (4)	
DATE	DESCRIPTION	BY	CHECKED	PROJECT	DATE	DRAWN	SHEET NO.
				ALACHUA	14210080		X-04
				NE 9TH STREET DESIGN			

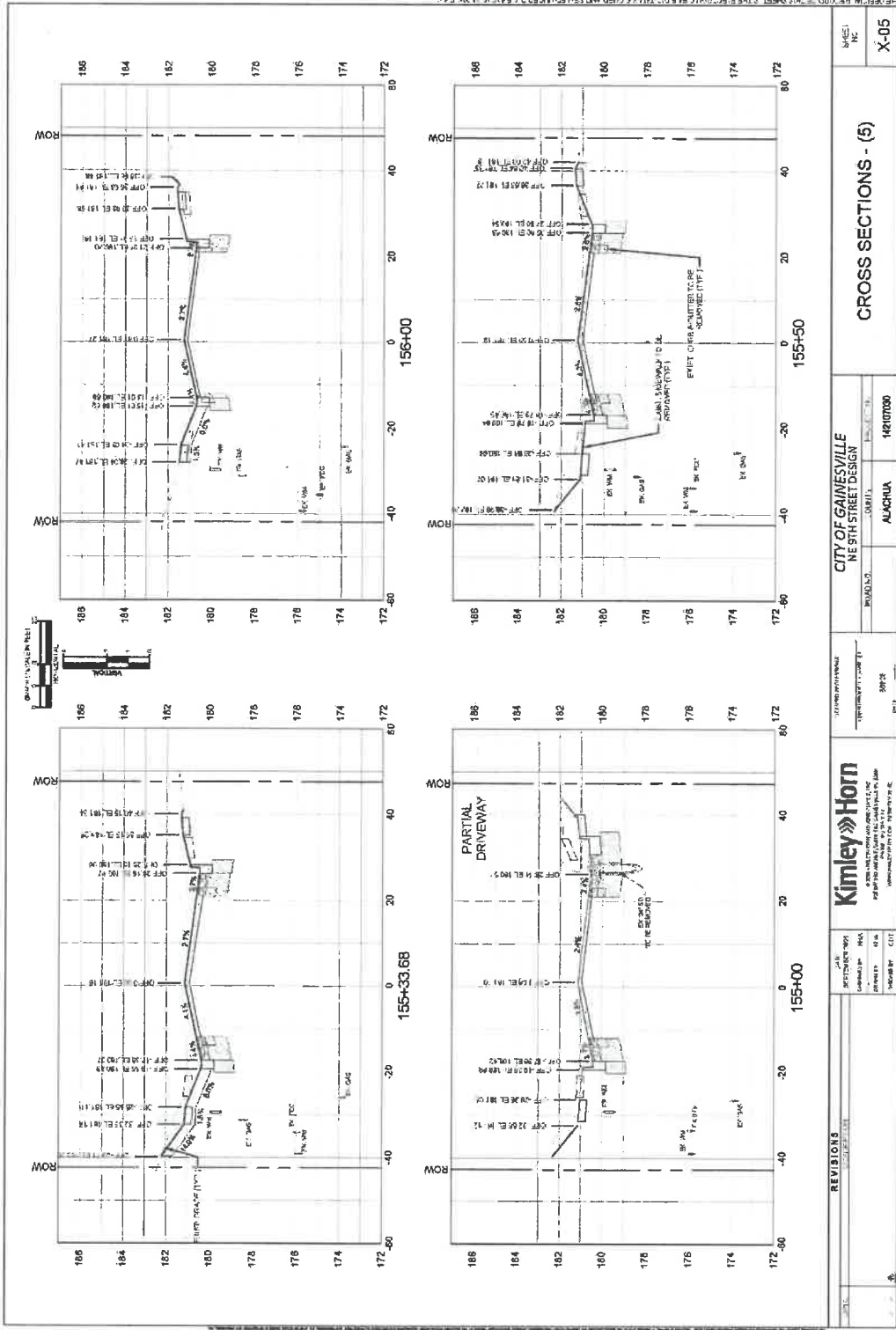

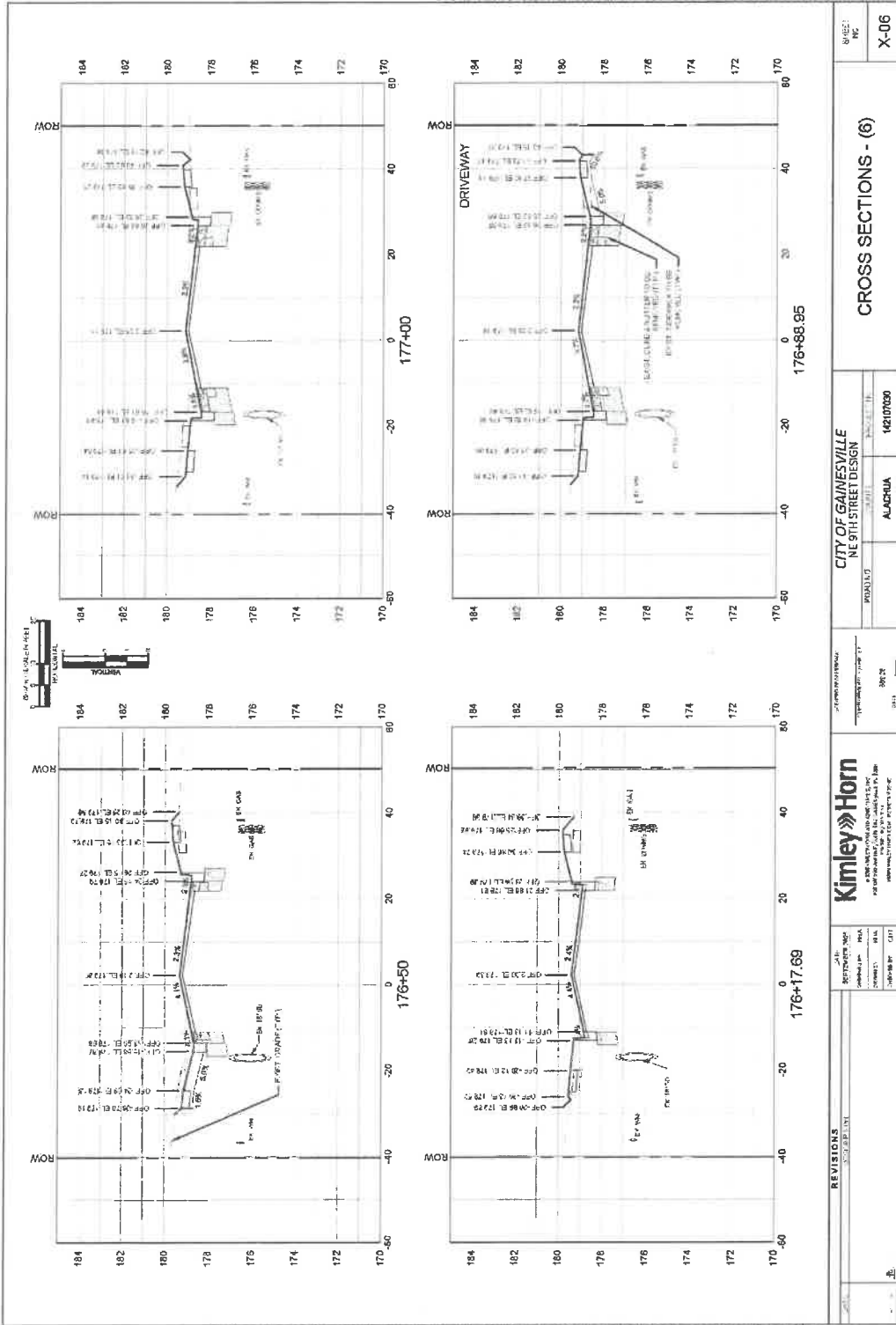

REVISIONS		DATE		BY	
NO.	DESCRIPTION	DATE	BY	DATE	BY

		CITY OF GAINESVILLE NEBIT STREET DESIGN	
PROJECT NO.	14210750	PROJECT TITLE	ALACRUA
DATE	08/22	SCALE	AS SHOWN

SHEET NO. 106	TOTAL SHEETS 110
------------------	---------------------

SHEET NO. X-06	TOTAL SHEETS 110
-------------------	---------------------

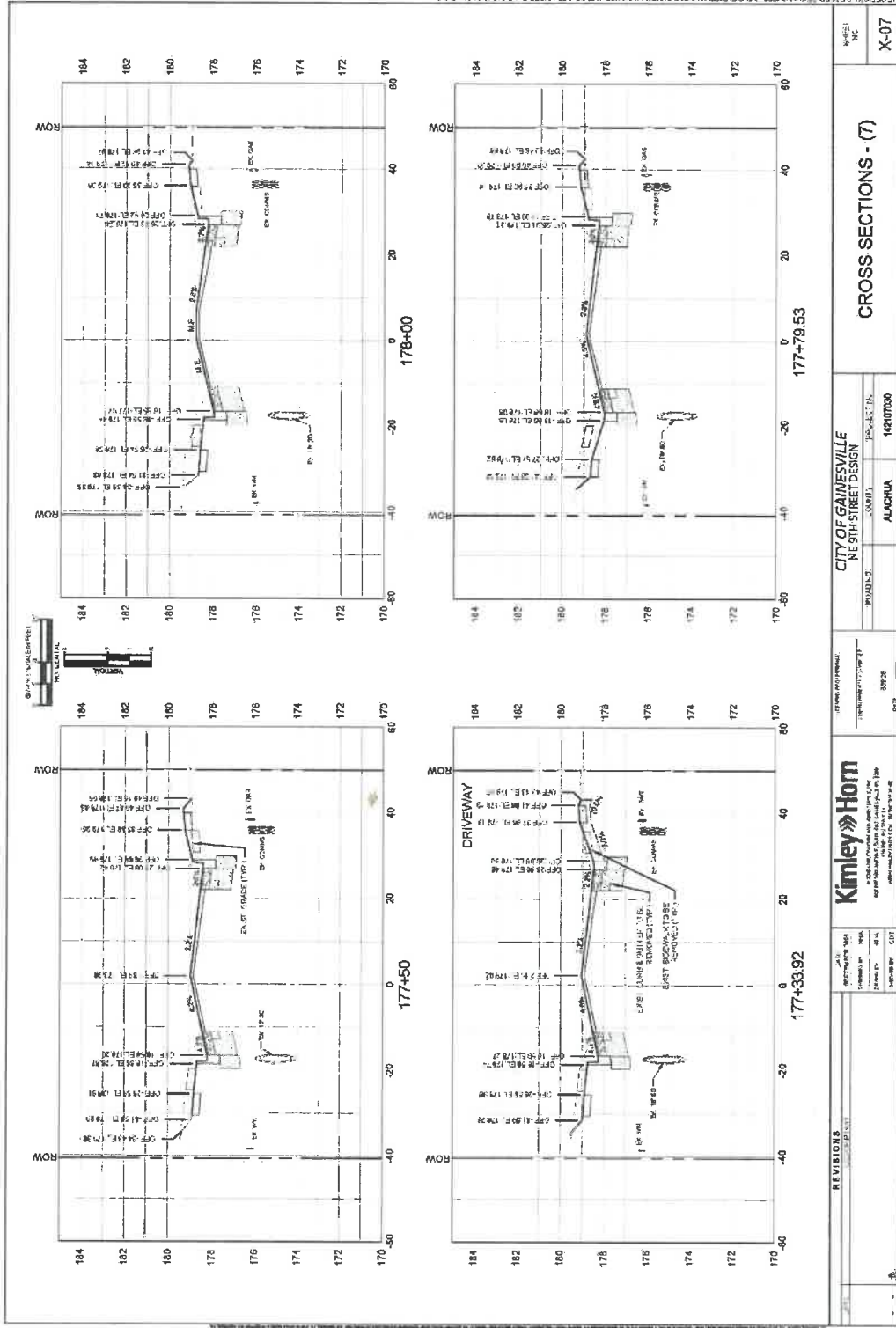

REVISIONS NO. DESCRIPTION DATE BY		CITY OF GAINESVILLE PE STIP STREET DESIGN		SHEET NO. X-07
PROJECT NO. 14107030		DRAWN BY ALAGRIA		CROSS SECTIONS - (7)
CHECKED BY [Signature]		DATE 11/10/2010		

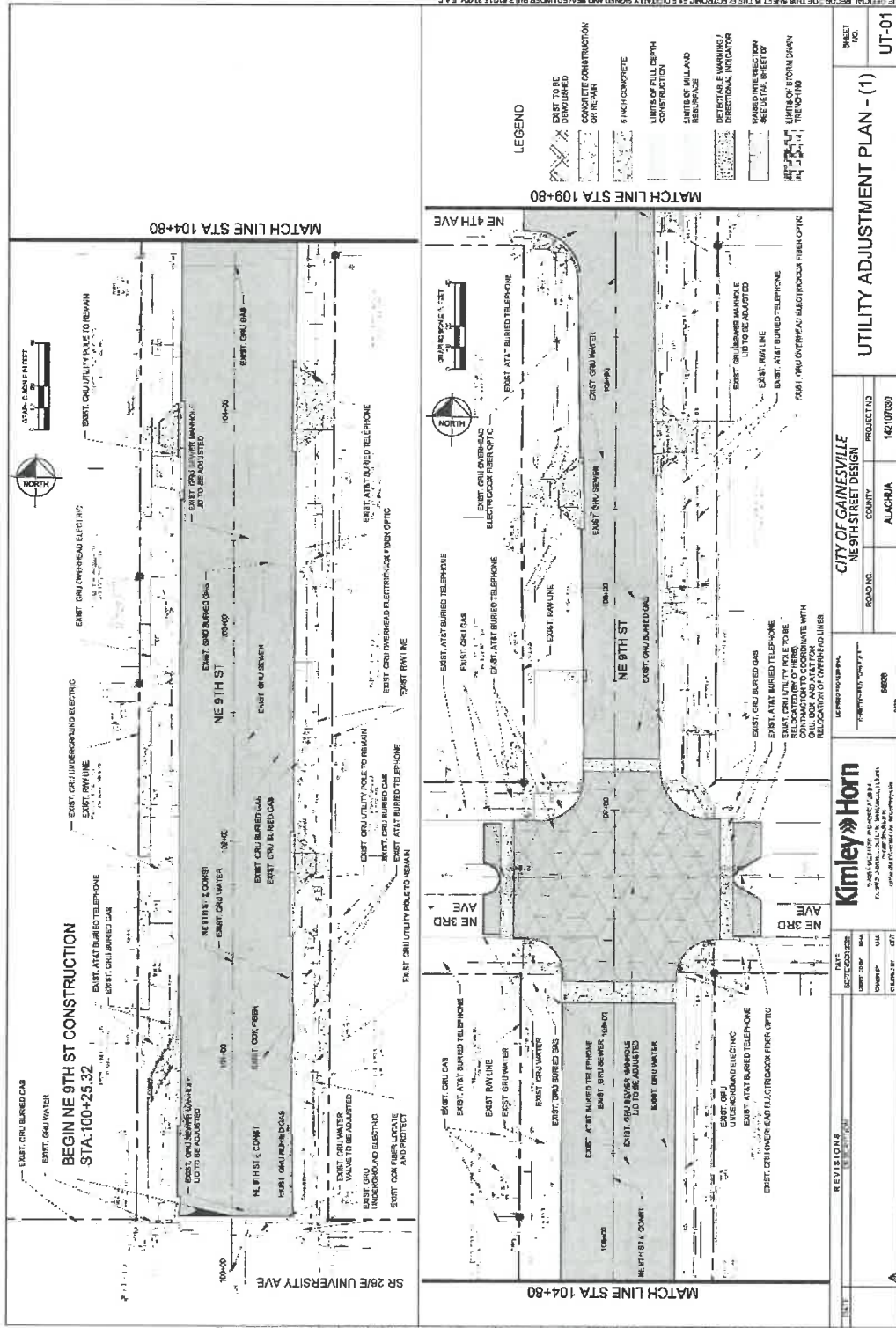

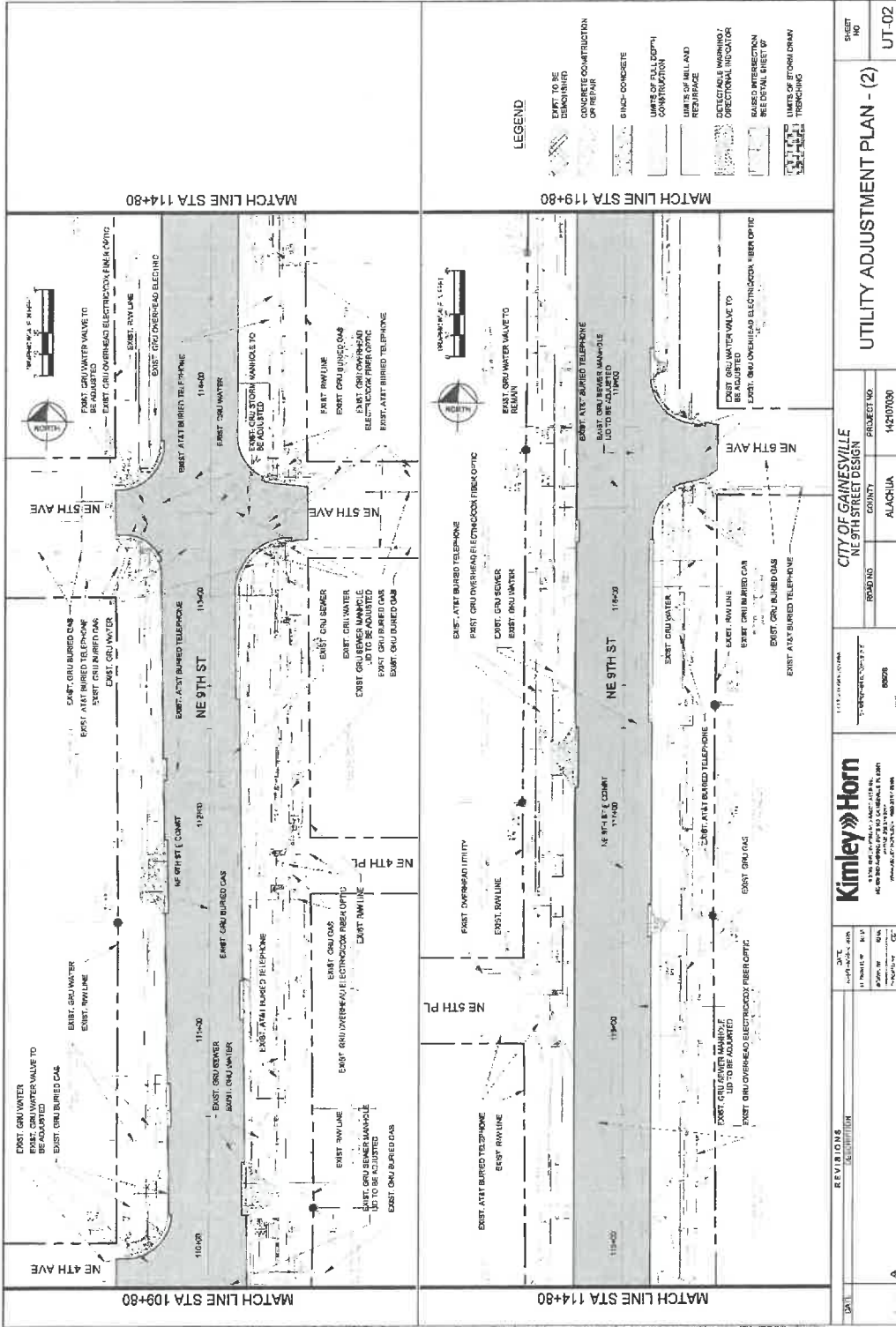

DATE: 11/11/2014		CITY OF GAINESVILLE		SHEET NO: UT-02	
PROJECT NO: 142-10700		COUNTY: ALACHUA		PROJECT NO: 142-10700	
PROJECT NO: 142-10700		COUNTY: ALACHUA		PROJECT NO: 142-10700	
PROJECT NO: 142-10700		COUNTY: ALACHUA		PROJECT NO: 142-10700	
PROJECT NO: 142-10700		COUNTY: ALACHUA		PROJECT NO: 142-10700	

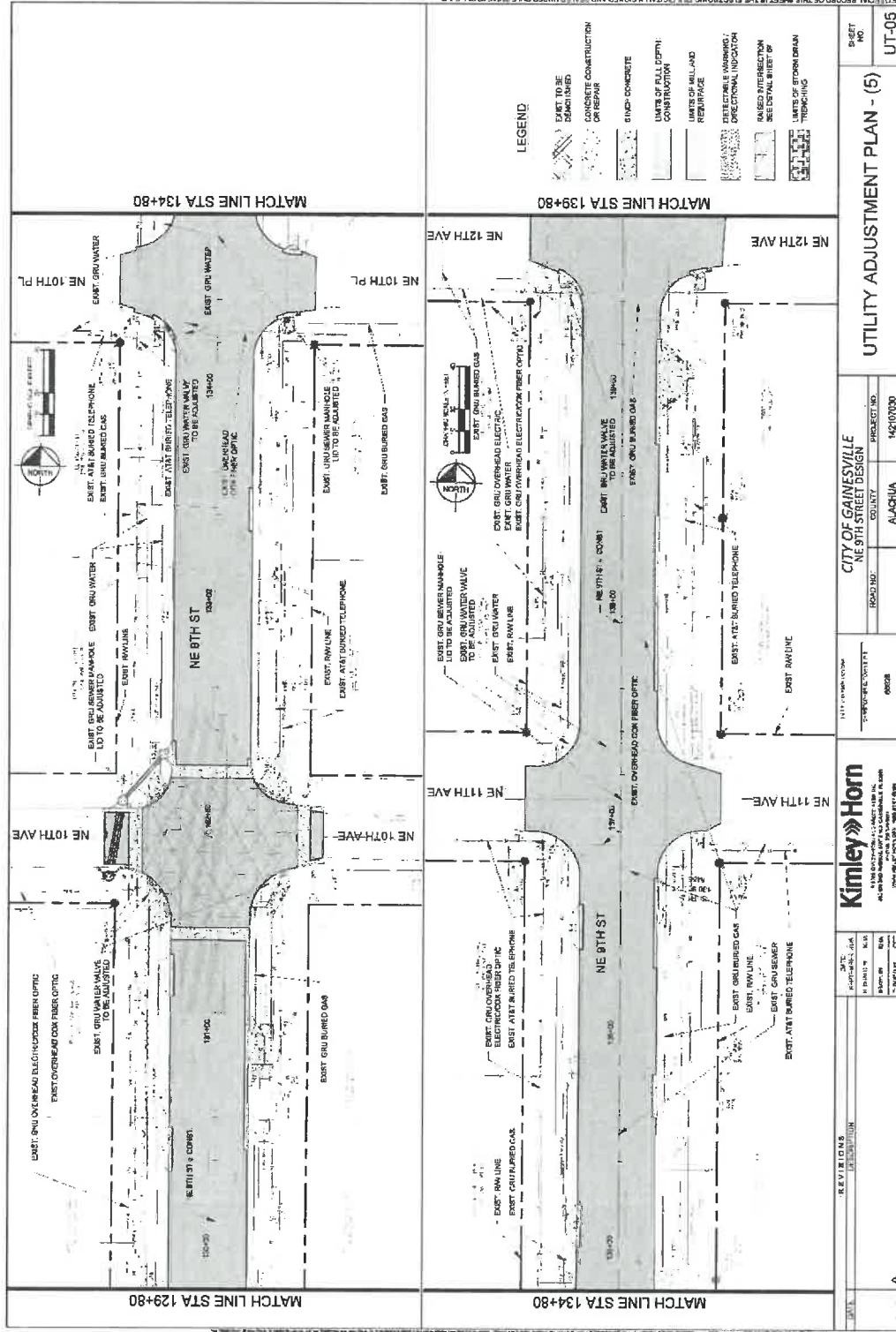

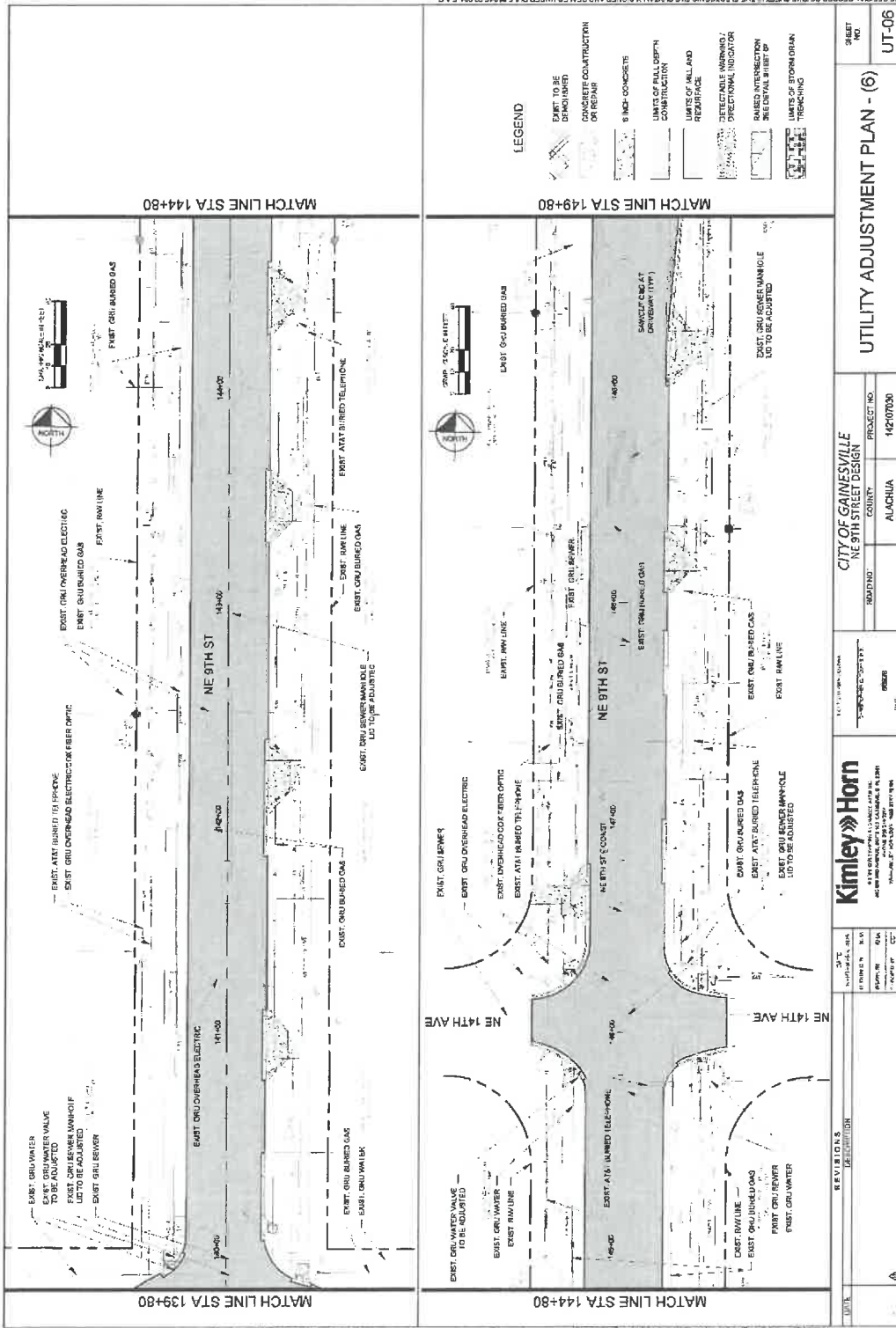

CITY OF GAINESVILLE NE 9TH STREET DESIGN		PROJECT NO. 142-07030	SHEET NO. UT-06
COUNTY ALACHUA		DATE 08/28/2018	
DESIGNED BY KIMLEY-HORN		CHECKED BY KIMLEY-HORN	
DRAWN BY KIMLEY-HORN		SCALE AS SHOWN	
APPROVED BY KIMLEY-HORN			

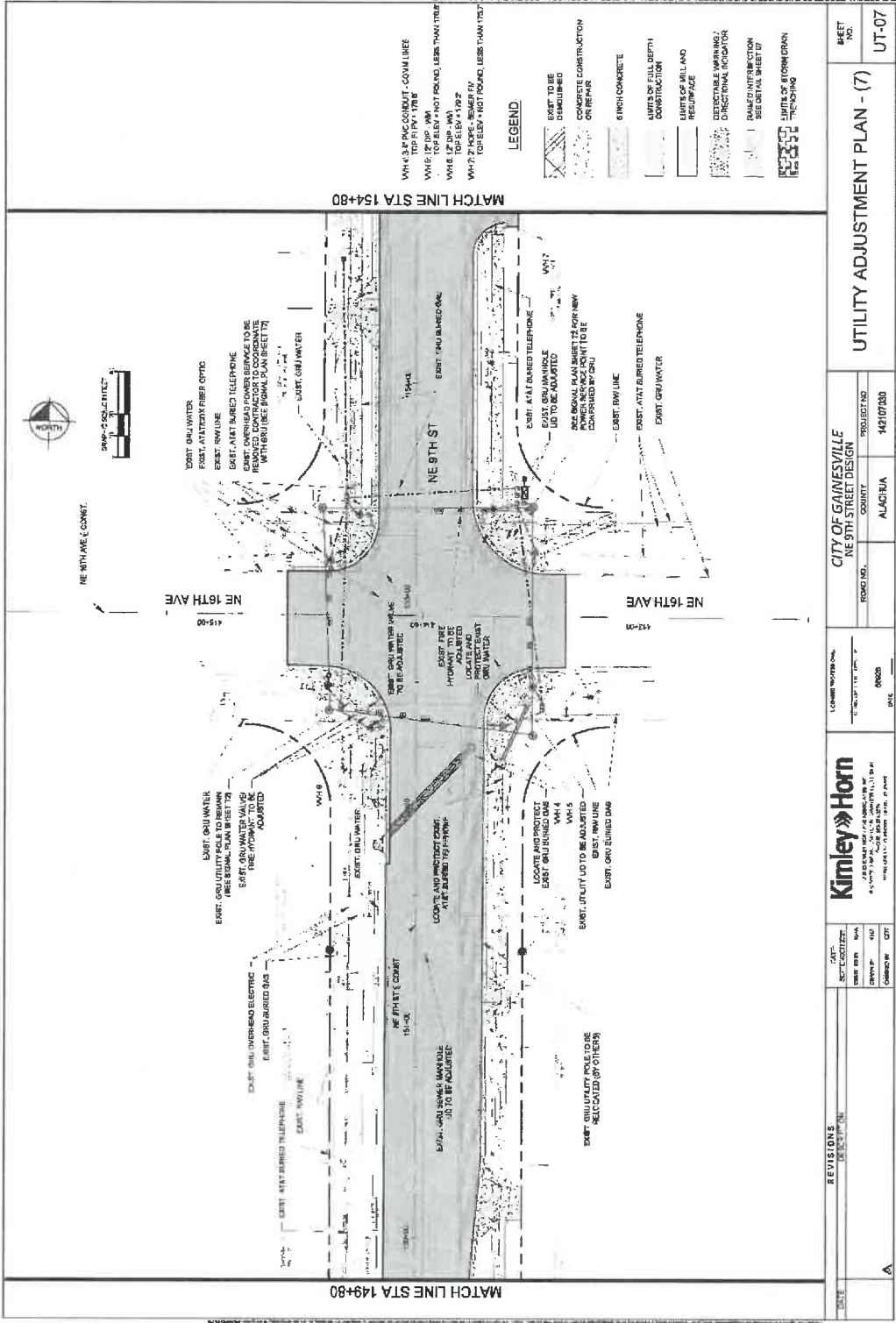

MATCH LINE STA 149+80

MATCH LINE STA 154+80

WH-4 8\"/>

LEGEND

- EXIST. TO BE DEMOLISHED
- CONCRETE CONSTRUCTION OR REPAIR
- 6 INCH CONCRETE
- EXPOSED FILL DEPTH CONSTRUCTION
- FLIPS OF MILL AND REPAIR
- DETECTABLE WARNING, DIRECTIONAL INDICATOR
- CONCRETE INTERLOCKING SIDEWALK SHEET PILE
- LIMITS OF EXHUMATION

DATE	REVISIONS	CITY OF GAINESVILLE	PROJECT NO.	ROAD NO.	COUNTY	ALACHUA	142107330	UT-07
		CITY OF GAINESVILLE	142107330		ALACHUA			
		NE 9TH STREET DESIGN						

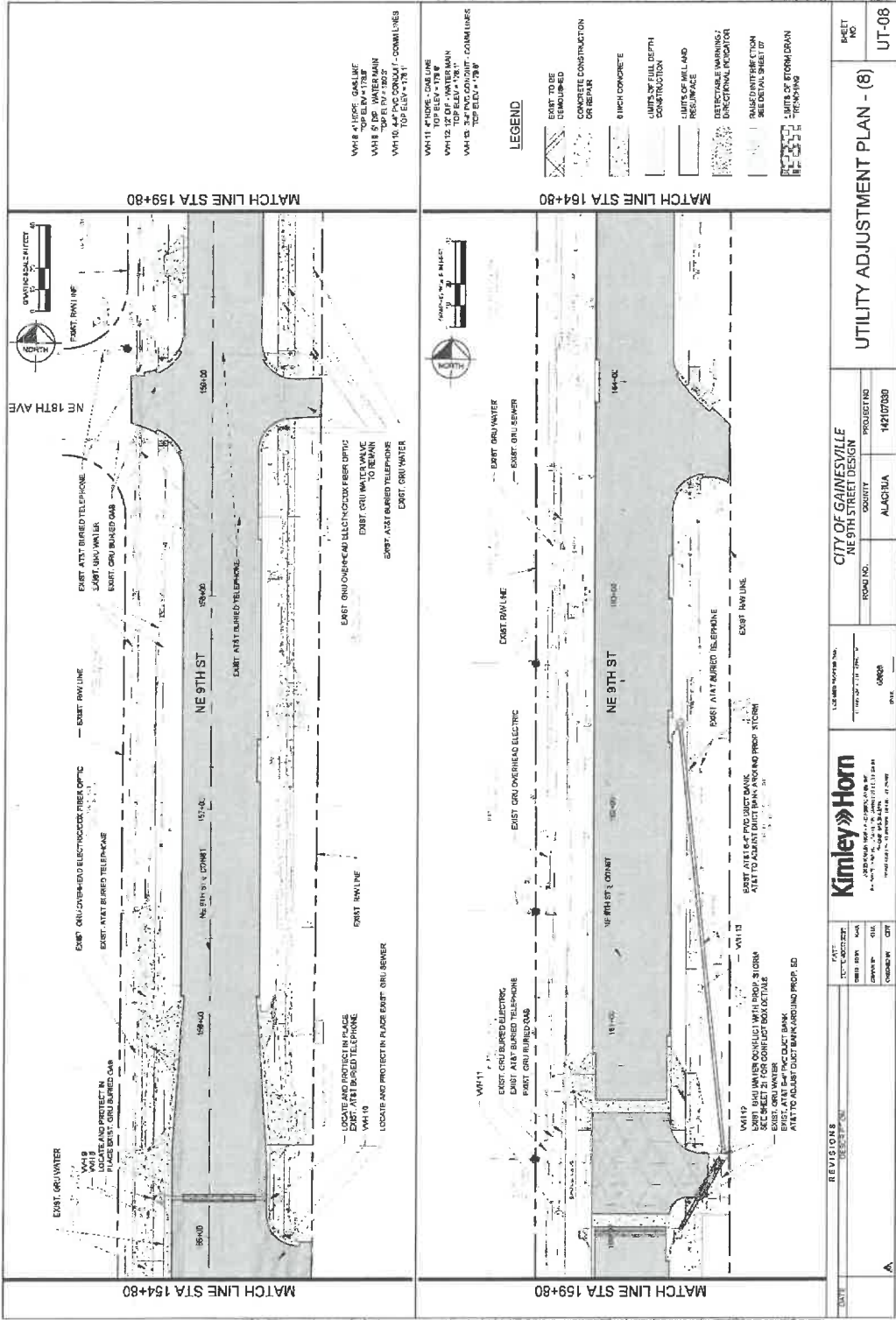

REVISIONS DATE DESCRIPTION		CITY OF GAINESVILLE NE 9TH STREET DESIGN	PROJECT NO. 14210730	SHEET NO. UT-08
DRAWN BY CHECKED BY DESIGNED BY IN CHARGE	DATE TIME	ROAD NO. COUNTY ALACHUA	LICENSE NUMBER NO. PROJECT NO. 14210730	PROJECT NO. 14210730
Kimley-Horn CONSULTING ENGINEERS 1000 N. GAINESVILLE BLVD., SUITE 200 GAINESVILLE, FL 32601 TEL: 352-369-4343 FAX: 352-369-4344 WWW.KIMLEY-HORN.COM		ROAD NO. COUNTY ALACHUA	LICENSE NUMBER NO. PROJECT NO. 14210730	SHEET NO. UT-08

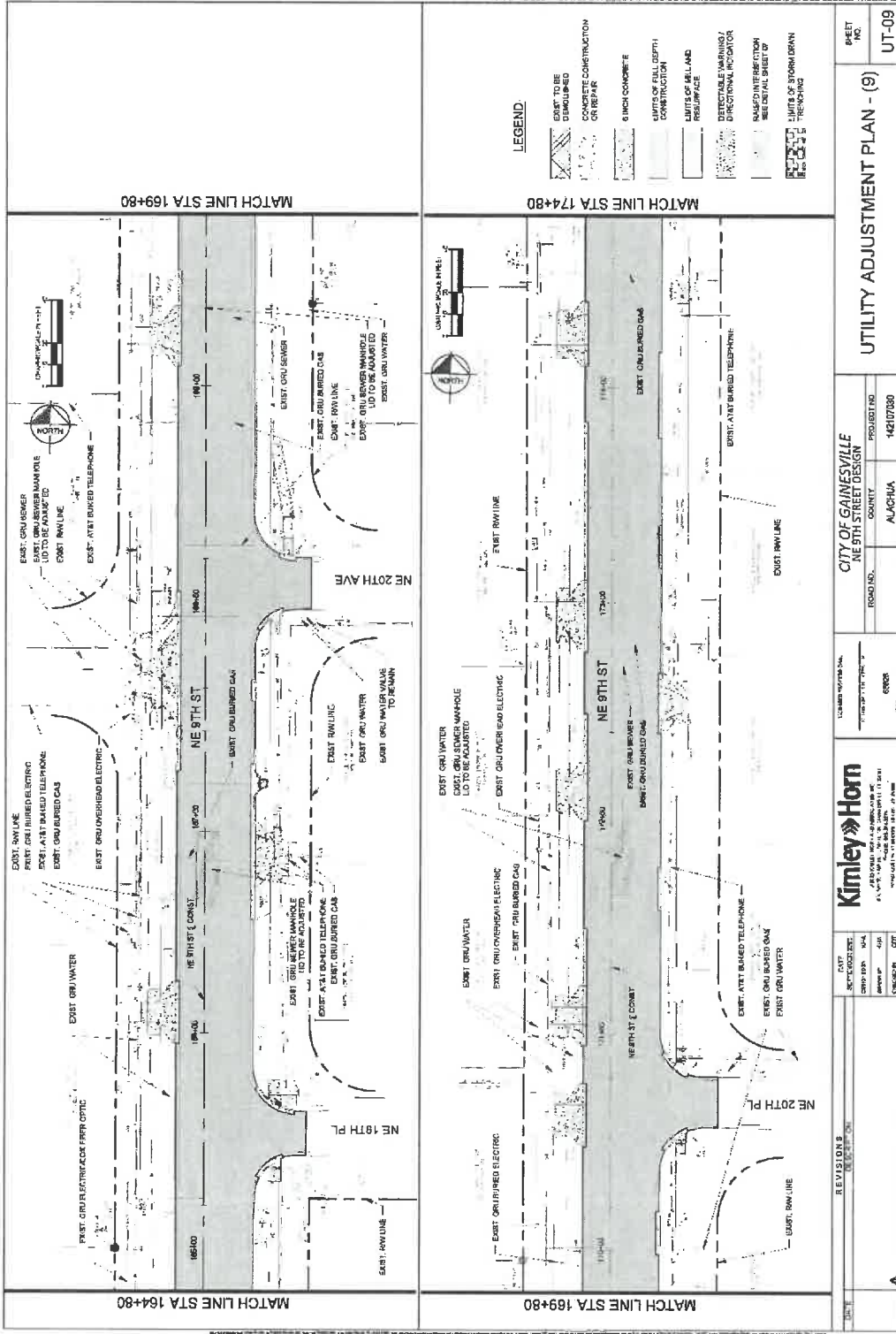

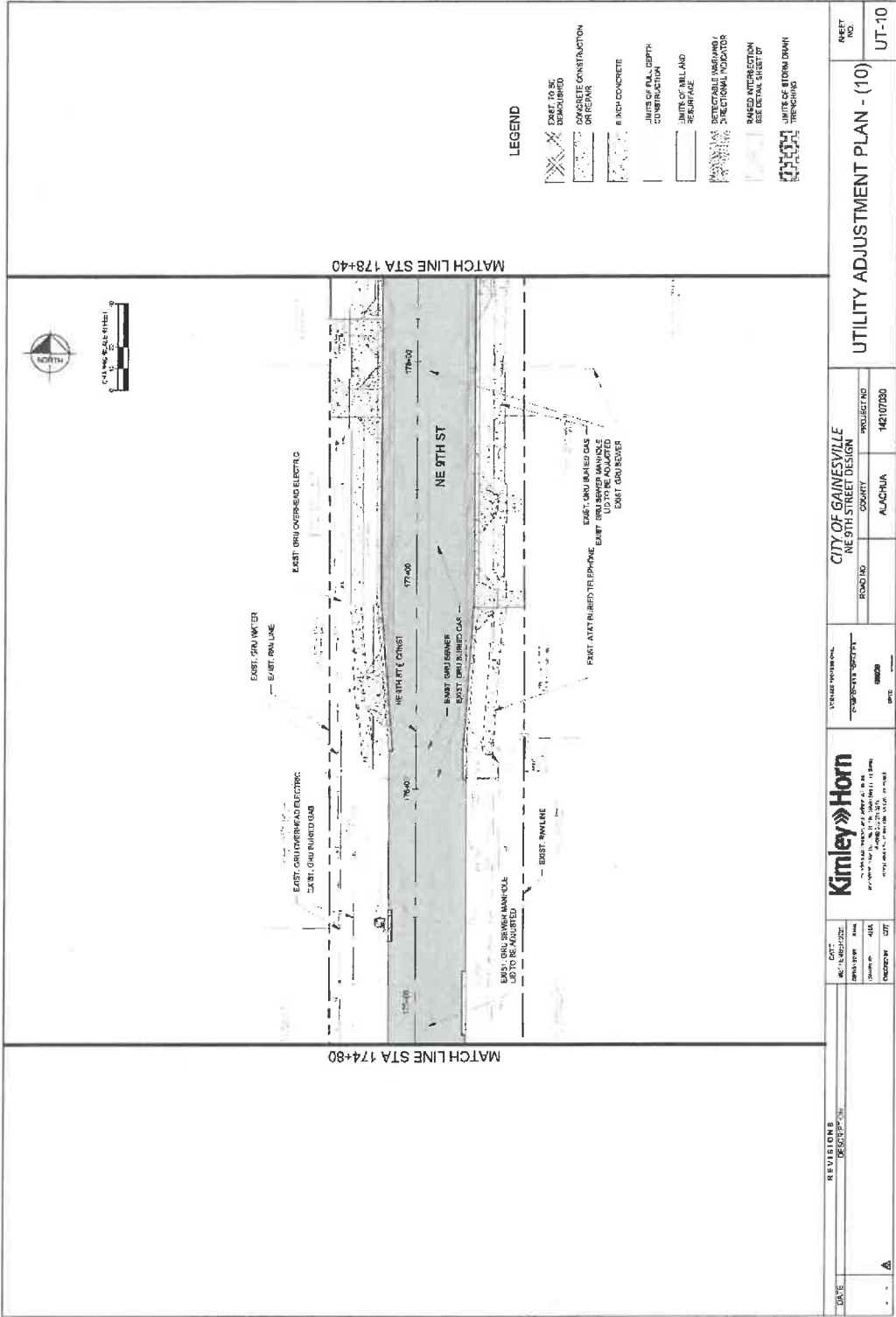

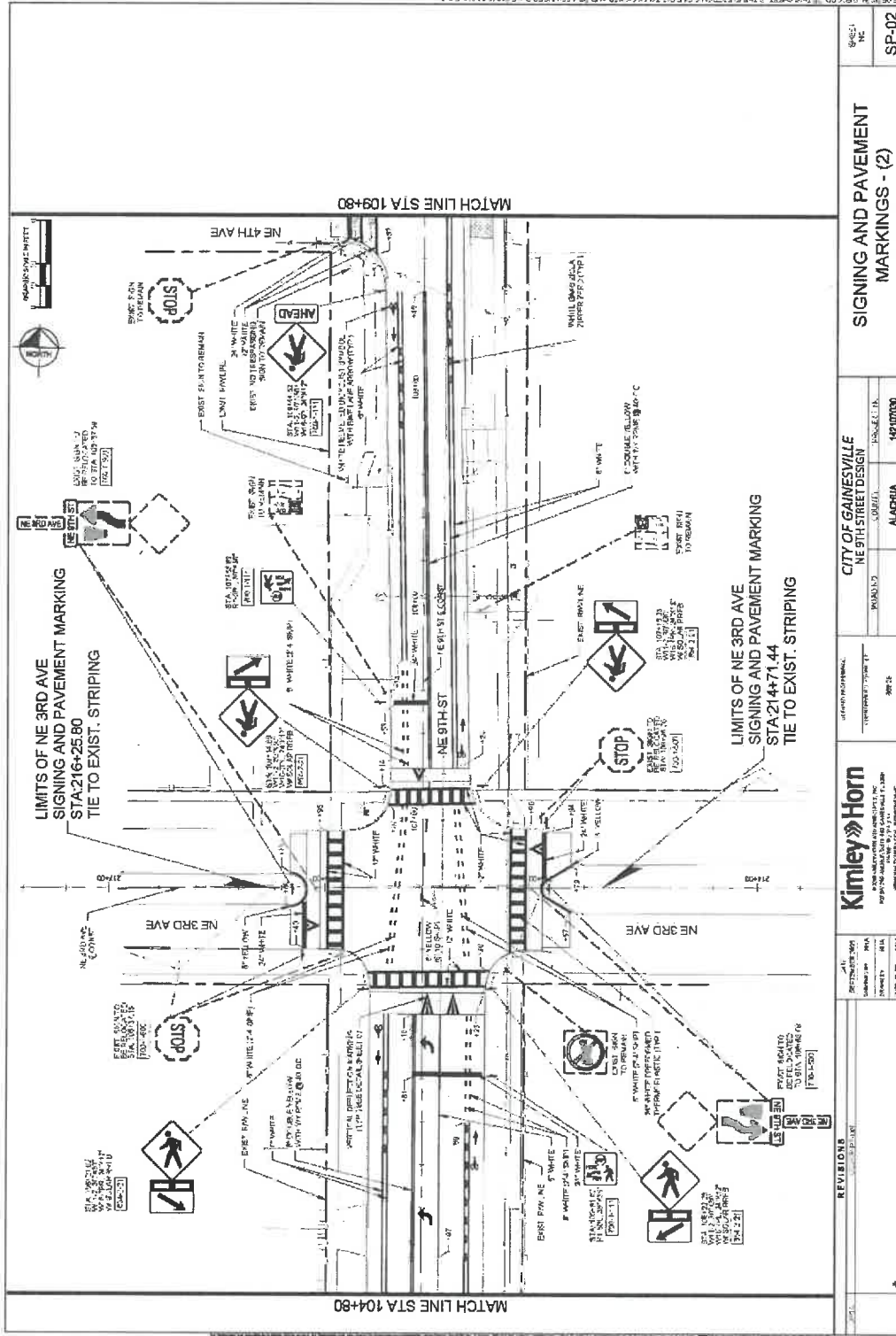

REVISIONS		CITY OF GAINESVILLE NE 9TH STREET DESIGN		SIGNING AND PAVEMENT MARKINGS - (2)	
NO.	DATE	BY	CHKD BY	PROJECT NO.	DATE
1				14907000	SP-02
		ALABAMA			
		TAMMUN, J.			
		DESIGNED BY			
		CHECKED BY			
		DATE			

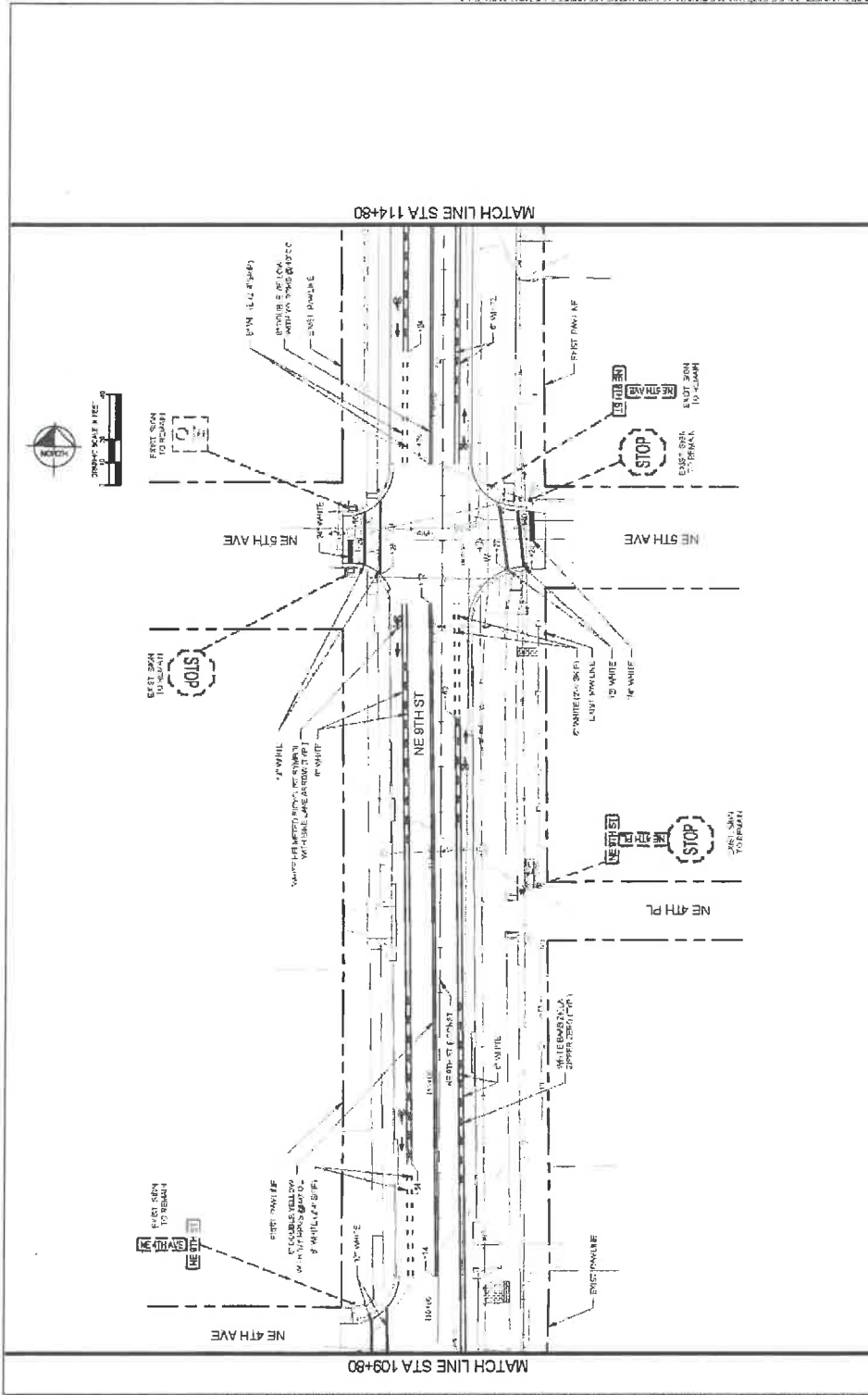

REVISIONS DATE: 08/21/2018 BY: JMM DESCRIPTION: 1. REVISED PER COMMENTS FROM CITY ENGINEER		City of Gainesville NE 9th Street Design		SHEET NO. SP-03
PROJECT NO. 14210700		PROJECT NAME ALACHUA		SCALE: 1" = 40'
DESIGNER Kimley-Horn		CITY OF GAINESVILLE PUBLIC WORKS DEPARTMENT		DATE: 08/21/2018
CHECKED BY JMM		PROJECT LOCATION ALACHUA		PROJECT NO. 14210700
DRAWN BY JMM		PROJECT NAME ALACHUA		SCALE: 1" = 40'

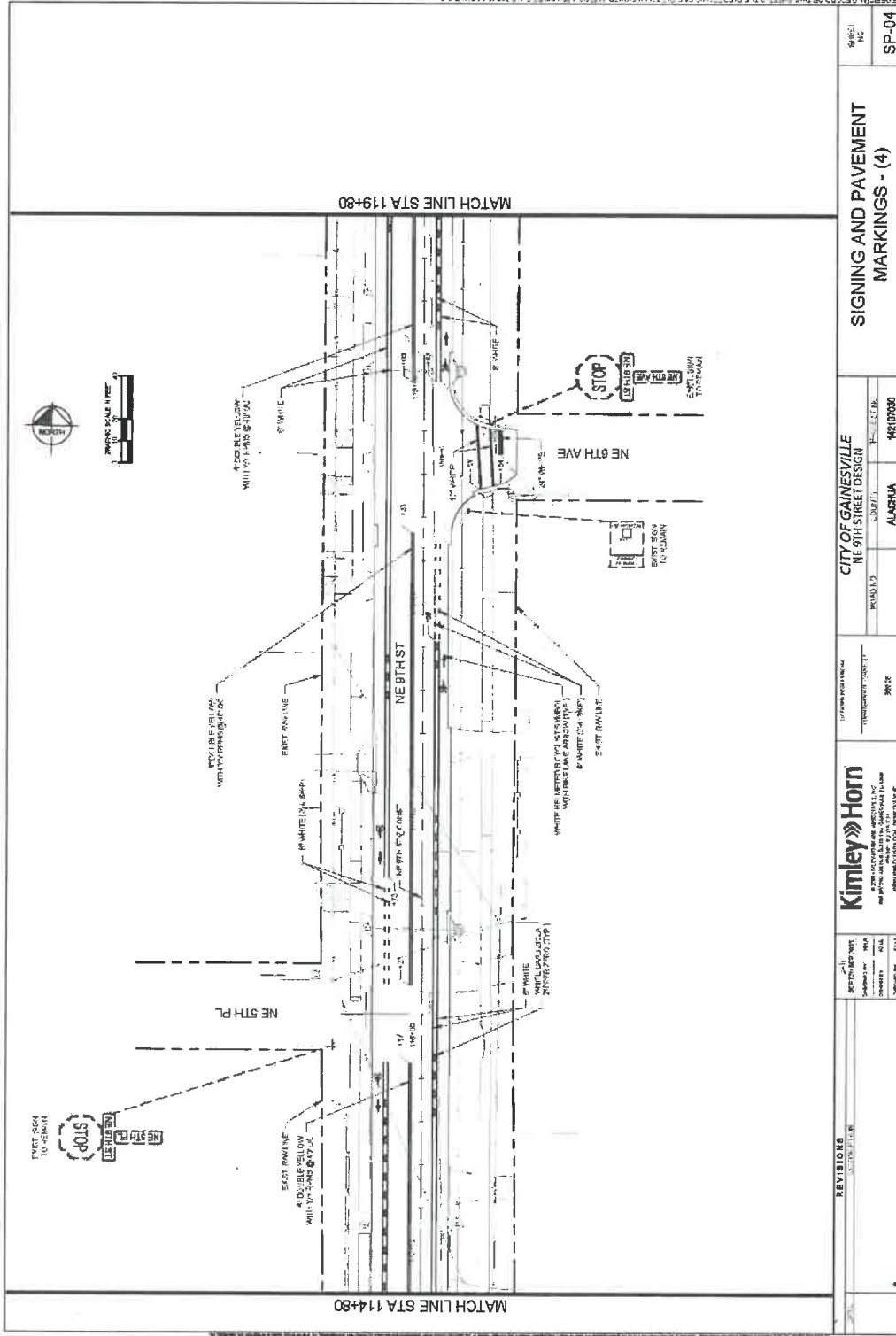

REVISIONS		DATE: _____ BY: _____ CHECKED BY: _____ APPROVED BY: _____	
CITY OF GAINESVILLE NORTH STREET DESIGN		PROJECT NO: ALABAMA 442107030	
DRAWN BY: _____ CHECKED BY: _____ DATE: 06/25/2014		SHEET NO: SP-04	
SIGNING AND PAVEMENT MARKINGS - (4)		SHEET NO: _____	

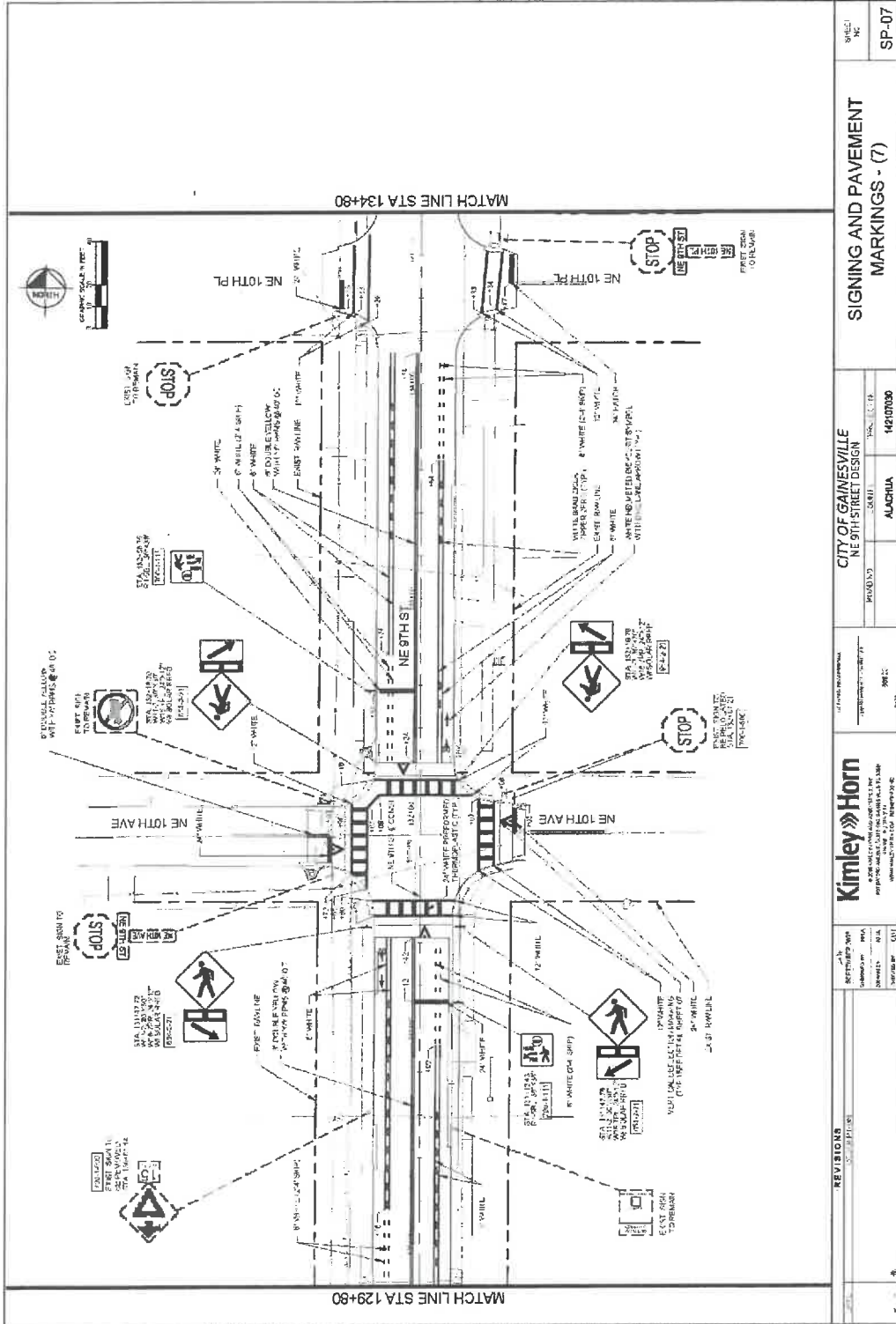

REVISIONS		CITY OF GAINESVILLE NE 9TH STREET DESIGN		SIGNING AND PAVEMENT MARKINGS - (7)	
NO.	DATE	BY	CHKD	PROJECT	SHEET NO.
				ALACHUA	SP-07
				DATE	
				14210030	

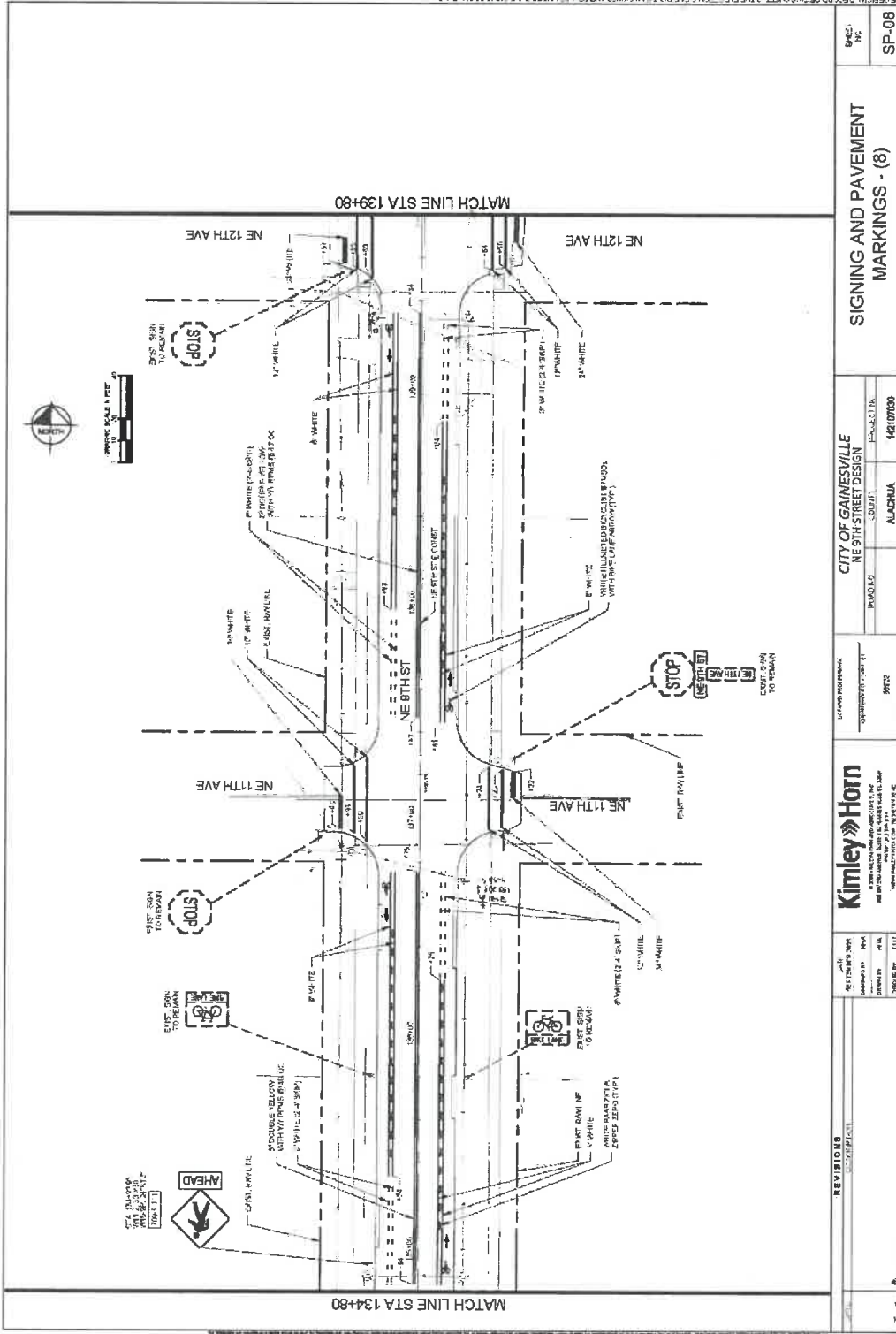

REVISIONS		DATE	BY	CHKD	APP'D	DESCRIPTION

Kimley Horn <small>INCORPORATING</small> <small>CONSULTING ENGINEERS & ARCHITECTS</small> <small>1000 N. UNIVERSITY AVENUE, SUITE 200</small> <small>ANN ARBOR, MI 48106-1000</small> <small>PH: 734.769.0800 FAX: 734.769.0801</small>		PROJECT NO.: 142107030	SHEET NO.: 811
CITY OF GAINESVILLE NE 8TH STREET DESIGN		COUNTY: ALACHUA	PROJECT NAME: NE 8TH STREET DESIGN
DESIGNER: JAMES W. HORN		DATE: 08/22/11	SCALE: AS SHOWN
CHECKED BY: JAMES W. HORN		DATE: 08/22/11	SCALE: AS SHOWN
APPROVED BY: JAMES W. HORN		DATE: 08/22/11	SCALE: AS SHOWN

SIGNING AND PAVEMENT MARKINGS - (8)	SHEET NO.: SP-08
-------------------------------------	---------------------

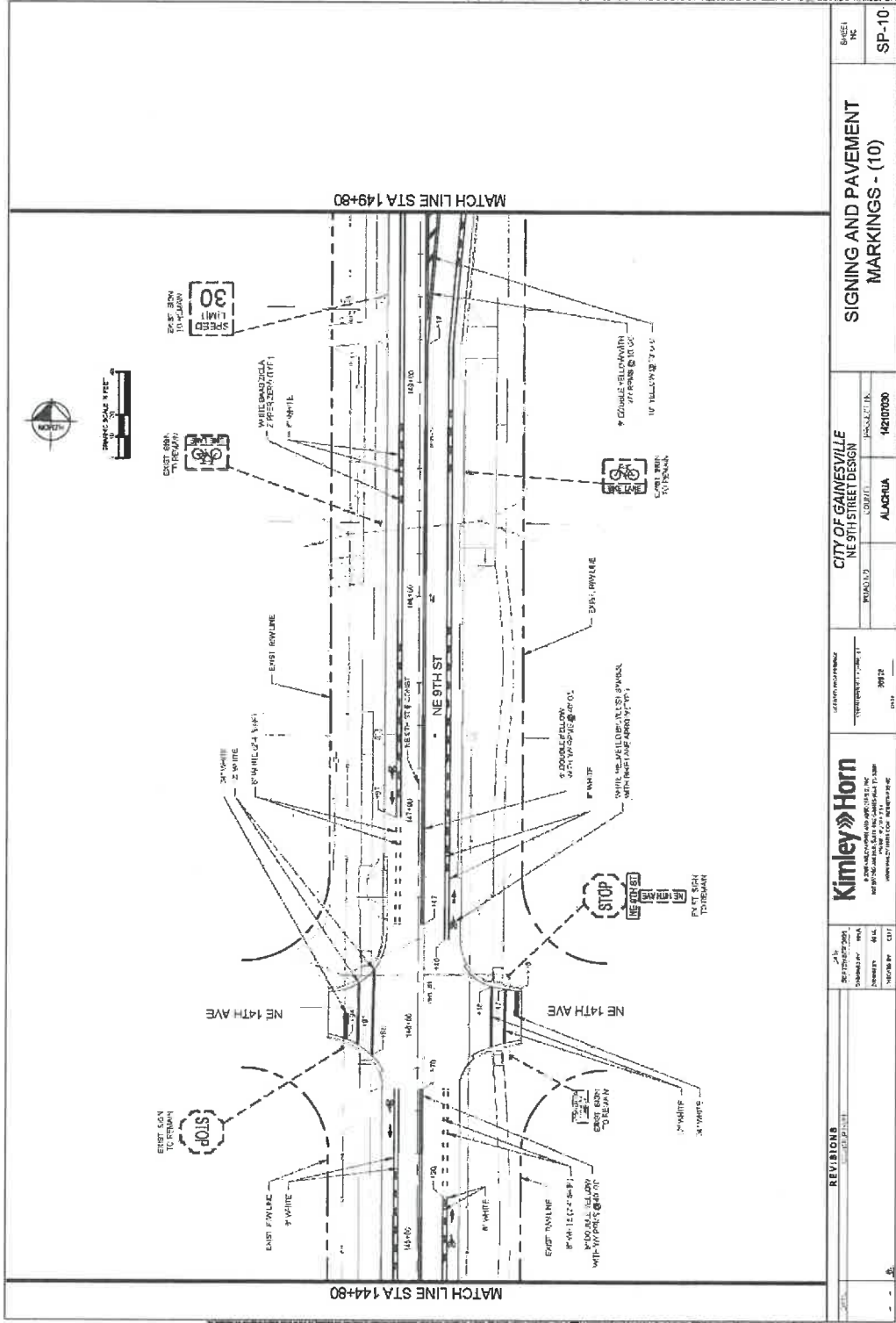

REVISIONS		DATE		BY	

Kimley-Horn <small>INCORPORATING</small> ENGINEERS AND ARCHITECTS, INC. <small>1000 WEST 10TH AVENUE, SUITE 200 DENVER, CO 80202</small>		PROJECT NO. 4420700	SHEET NO. 10
CITY OF GAINESVILLE NE 9TH STREET DESIGN		PROJECT NAME ALACHUA	PROJECT NO. 4420700

DESIGNER ALACHUA	CHECKED BY ALACHUA
DATE 08/12	CITY ALACHUA

BASED ON SP-10

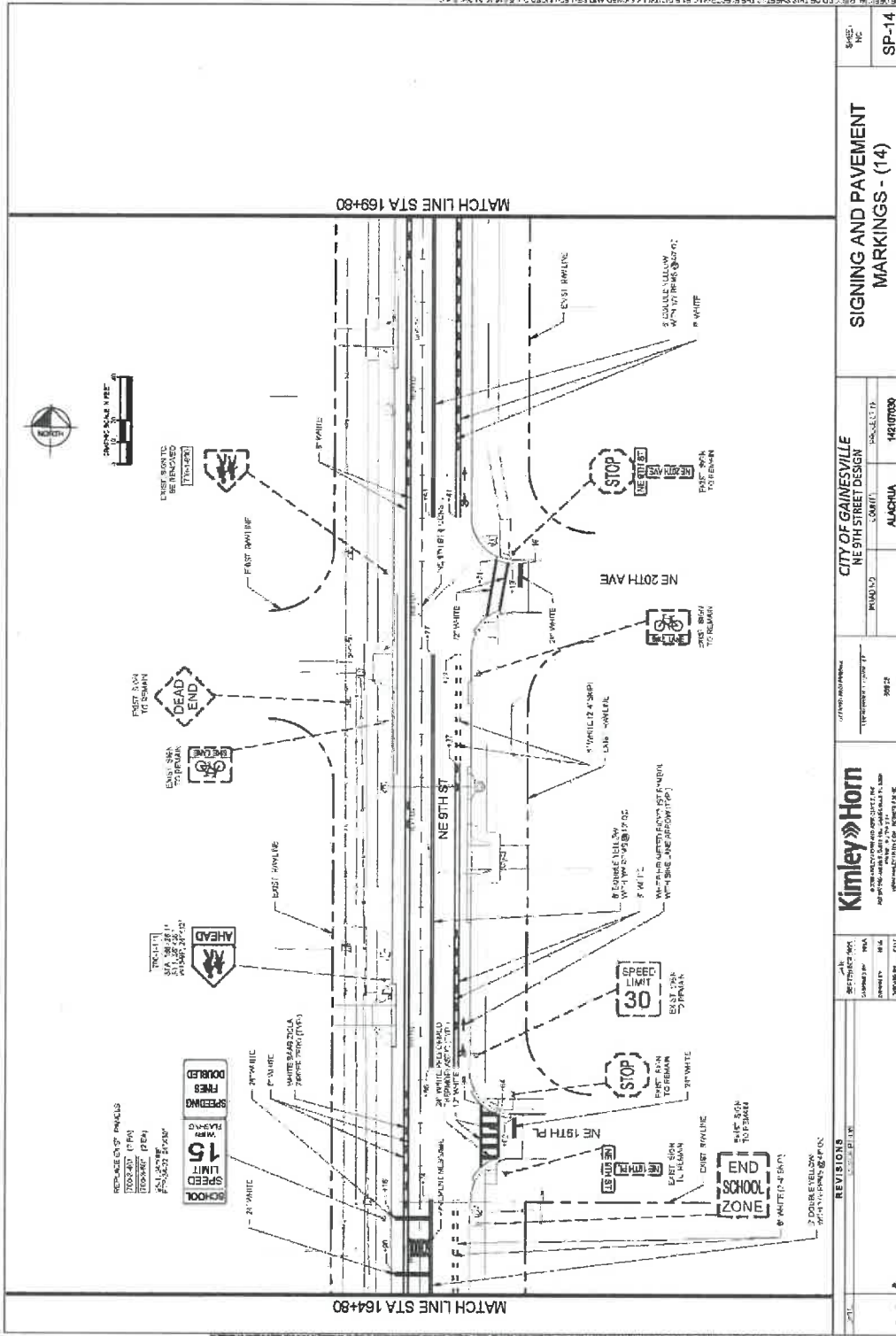

REVISIONS NO. DATE BY DESCRIPTION		City of Gainesville NORTH STREET DESIGN		SHEET NO. SP-14
PROJECT NO. 14207030		DRAWN BY ALACHUA		SCALE 1" = 40'
CHECKED BY MM		PROJECT NO. 14207030		DATE 08/22
DESIGNED BY MM		CITY ALACHUA		PROJECT NO. 14207030

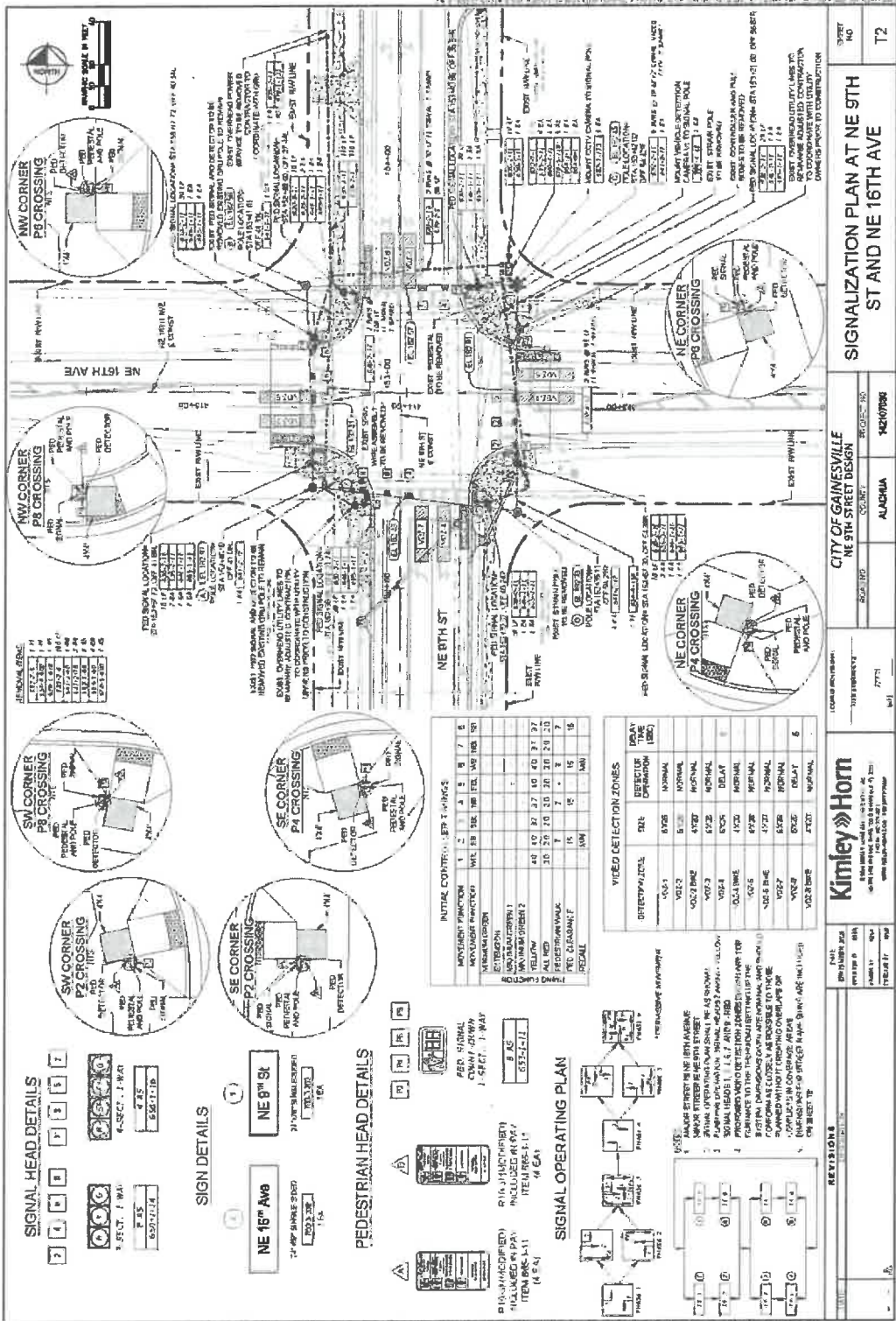

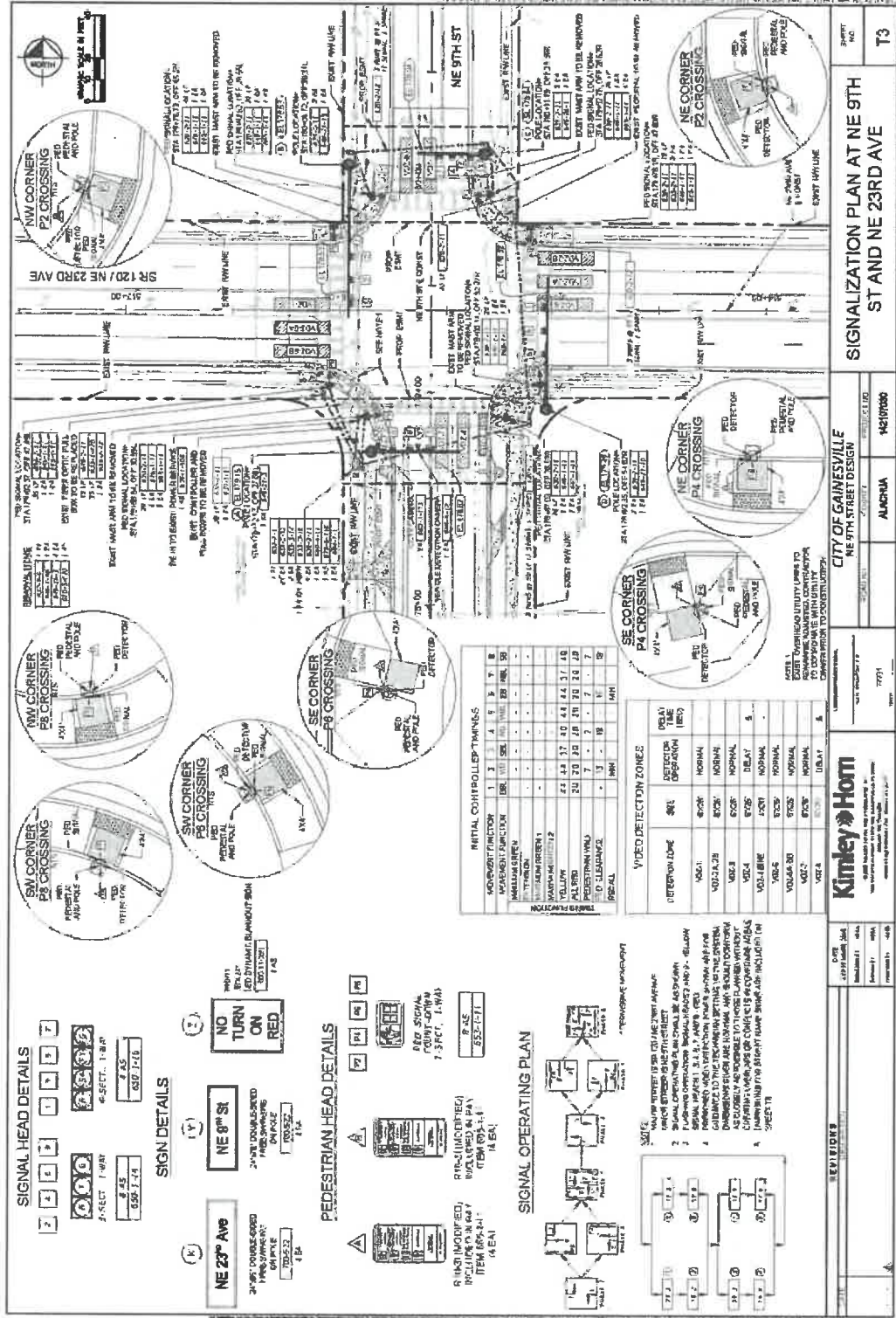

SIGNALIZATION PLAN AT NE 9TH ST AND NE 23RD AVE

CITY OF GAINESVILLE
NE 9TH STREET DESIGN

ALUCMA 142107000

Kimley-Horn

REVISIONS

NO.	DATE	DESCRIPTION
1	08/11/11	ISSUED FOR PERMIT
2	08/11/11	ISSUED FOR PERMIT
3	08/11/11	ISSUED FOR PERMIT
4	08/11/11	ISSUED FOR PERMIT
5	08/11/11	ISSUED FOR PERMIT

NOTES:

- ALL SIGNALS ARE TO BE CONTROLLED BY THE CITY OF GAINESVILLE.
- ALL SIGNALS ARE TO BE CONTROLLED BY THE CITY OF GAINESVILLE.
- ALL SIGNALS ARE TO BE CONTROLLED BY THE CITY OF GAINESVILLE.
- ALL SIGNALS ARE TO BE CONTROLLED BY THE CITY OF GAINESVILLE.
- ALL SIGNALS ARE TO BE CONTROLLED BY THE CITY OF GAINESVILLE.

SPAN TABULATION

POLE ID	SPAN LENGTH (ft)	BACK-PLATES (ft)	SIGNAL DATA						SIGN DATA					
			DISTANCE FROM POLE (DM) / NUMBER OF SECTIONS (S)		DISTANCE FROM POLE (DM) / HEIGHT (H) / WIDTH (W)		DISTANCE FROM POLE (DM) / HEIGHT (H) / WIDTH (W)							
			DT (ft)	HT (ft)	WT (ft)	DT (ft)	HT (ft)	WT (ft)	DT (ft)	HT (ft)	WT (ft)	DT (ft)	HT (ft)	WT (ft)
A	24	7	31.5	1	17.5	2	63.5	1	24.5	2	1.7	-	-	-
B	40	7	22.5	3	16.5	4	76.5	1	15.1	1	5	-	-	-
C	102	7	31.5	2	13.5	3	63.5	1	14.5	2	1.4	-	-	-
D	80	7	24.3	3	16.0	4	72.0	1	19.0	1	2	-	-	-

REVISIONS NO. DATE BY 1 11/11/11 RMA 2 02/08/12 BJA 3 02/08/12 BJA	Kimley Horn 10000 Highway 100, Suite 1000 Raleigh, NC 27617 www.kimley-horn.com	CITY OF GAINESVILLE NE 9TH STREET DESIGN PROJECT NO. 14210700 ALACHUA	SHEET NO. T4 TOTAL SHEETS 14
---	---	--	---------------------------------

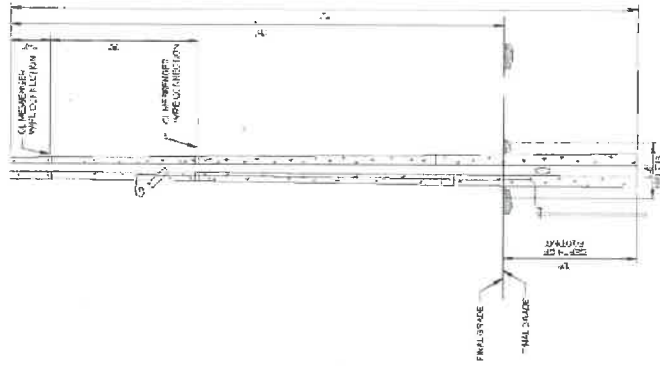

DETAIL OF PRESTRESSED CONCRETE STRAIN POLES TYPE P-III TO P-VIII (SEE INDEX 641-010 FOR POLE DETAILS)

STRAIN POLE SCHEDULE

POLE SHEET ID	SHEET NO.	POLE LOCATION STATION	POLE LOCATION OFFSET	SPAN	CROWN ELEVATION	POLE TYPE	GROUND ELEVATION	POLE LENGTH (L)	POLE HEIGHT (H)	DIMENSION (A)	DIMENSION (E)	CATEGORY WIRE DIA.	MESSENGER WIRE DIA.
B	1,2	152+46.92	41.02L	A-B 149.44	133.71 149.44	P-00	133.59	81	87	8.5"	4.7	0.312"	0.375"
C	1,2	150+14.31	41.37L	B-C 149.44	132.57 149.44	P-10	132.53	80	84	8.5"	4.6	0.312"	0.375"
D	1,2	153+41.81	36.41P	C-D 149.44	132.57 149.44	P-00	132.53	80	84	8.5"	4.7	0.312"	0.375"
E	1,2	153+38.11	36.36R	D-E 149.44	132.57 149.44	P-10	132.53	80	84	8.5"	4.6	0.312"	0.375"

- ADDITIONAL NOTES
1. THE POLE SHALL BE CONSTRUCTED WITH PRESTRESSED CONCRETE AND SHALL BE INSTALLED IN ACCORDANCE WITH THE LATEST EDITIONS OF THE STANDARD SPECIFICATIONS FOR ROAD AND BRIDGE CONSTRUCTION.
 2. ALL DIMENSIONS ARE IN FEET UNLESS OTHERWISE SPECIFIED.
 3. THE POLE SHALL BE CONSTRUCTED WITH A MINIMUM OF 10% OVERSTRESS AND SHALL BE CONSTRUCTED IN ACCORDANCE WITH THE LATEST EDITIONS OF THE STANDARD SPECIFICATIONS FOR ROAD AND BRIDGE CONSTRUCTION.
 4. THE POLE SHALL BE CONSTRUCTED WITH A MINIMUM OF 10% OVERSTRESS AND SHALL BE CONSTRUCTED IN ACCORDANCE WITH THE LATEST EDITIONS OF THE STANDARD SPECIFICATIONS FOR ROAD AND BRIDGE CONSTRUCTION.
 5. THE POLE SHALL BE CONSTRUCTED WITH A MINIMUM OF 10% OVERSTRESS AND SHALL BE CONSTRUCTED IN ACCORDANCE WITH THE LATEST EDITIONS OF THE STANDARD SPECIFICATIONS FOR ROAD AND BRIDGE CONSTRUCTION.
 6. DESIGN AND SPEED - 100 MPH.
 7. FOUNDATION DESIGN IS BASED ON SUBSURFACE SOIL DATA FROM AND GEOTECHNICAL ENGINEER'S REPORT NO. 198314.

		CITY OF GAINESVILLE NE 9TH STREET DESIGN		SHEET NO. T5
PROJECT NO. 14210700		DRAWN BY ALABRIA		STRAIN POLE SCHEDULE
DATE 07/17		CHECKED BY 08/07		SCALE AS SHOWN

STANDARD MAST ARM ASSEMBLIES DATA TABLE

REVISIONS	DESCRIPTION	SCOUTDOWN		OF		PILE		DRILLED SHFT ID
		ARM ID	ARM ID	ARM ID	ARM ID	ARM ID	ARM ID	
A	ADDITION OF SCOUTDOWN	ARM01	ARM02	ARM03	ARM04	ARM05	ARM06	ARM07
B	ADDITION OF SCOUTDOWN	ARM08	ARM09	ARM10	ARM11	ARM12	ARM13	ARM14
C	ADDITION OF SCOUTDOWN	ARM15	ARM16	ARM17	ARM18	ARM19	ARM20	ARM21
D	ADDITION OF SCOUTDOWN	ARM22	ARM23	ARM24	ARM25	ARM26	ARM27	ARM28

FOUNDATION NOTES:

1. ALL DIMENSIONS ARE IN FEET AND INCHES UNLESS OTHERWISE SPECIFIED. DIMENSIONS ARE TO FACE UNLESS OTHERWISE SPECIFIED. DIMENSIONS ARE TO FACE UNLESS OTHERWISE SPECIFIED.
2. ALL DIMENSIONS ARE IN FEET AND INCHES UNLESS OTHERWISE SPECIFIED. DIMENSIONS ARE TO FACE UNLESS OTHERWISE SPECIFIED.
3. ALL DIMENSIONS ARE IN FEET AND INCHES UNLESS OTHERWISE SPECIFIED. DIMENSIONS ARE TO FACE UNLESS OTHERWISE SPECIFIED.
4. ALL DIMENSIONS ARE IN FEET AND INCHES UNLESS OTHERWISE SPECIFIED. DIMENSIONS ARE TO FACE UNLESS OTHERWISE SPECIFIED.
5. ALL DIMENSIONS ARE IN FEET AND INCHES UNLESS OTHERWISE SPECIFIED. DIMENSIONS ARE TO FACE UNLESS OTHERWISE SPECIFIED.
6. ALL DIMENSIONS ARE IN FEET AND INCHES UNLESS OTHERWISE SPECIFIED. DIMENSIONS ARE TO FACE UNLESS OTHERWISE SPECIFIED.
7. ALL DIMENSIONS ARE IN FEET AND INCHES UNLESS OTHERWISE SPECIFIED. DIMENSIONS ARE TO FACE UNLESS OTHERWISE SPECIFIED.

REVISIONS	DATE	BY	CHKD BY	FILE NO.
				T7
Kimley-Horn		CITY OF GAINESVILLE		
Professional Engineer No. 123456789 State of Florida		NE 9TH STREET DESIGN		
1000 UNIVERSITY BLVD, SUITE 200 GAINESVILLE, FL 32601		ALABAMA		
PROJECT NO. 123456789		PROJECT NO. 123456789		

<p>REVISIONS</p> <table border="1" style="width:100%; border-collapse: collapse;"> <tr> <th>NO.</th> <th>DATE</th> <th>BY</th> <th>DESCRIPTION</th> </tr> <tr> <td> </td> <td> </td> <td> </td> <td> </td> </tr> </table>	NO.	DATE	BY	DESCRIPTION					<p>PROJECT INFORMATION</p> <p>PROJECT NO. 14210130</p> <p>PROJECT NAME CITY OF GAINESVILLE NE 5TH STREET DESIGN</p> <p>CLIENT ALACHUA</p> <p>DATE 10/20/10</p>	<p>SCALE</p> <p>1" = 10'-0"</p>	<p>REVISION NO.</p> <p>T8</p>
NO.	DATE	BY	DESCRIPTION								
<p>NE 16th Ave</p> <p>Stationing: 0+00 to 0+50</p> <p>Width: 6'-0"</p> <p>Right-of-Way: 10'-0"</p>	<p>NE 23rd Ave</p> <p>Stationing: 0+00 to 0+50</p> <p>Width: 6'-0"</p> <p>Right-of-Way: 10'-0"</p>	<table border="1" style="width:100%; border-collapse: collapse;"> <tr> <th>NO.</th> <th>DATE</th> <th>BY</th> <th>DESCRIPTION</th> </tr> <tr> <td> </td> <td> </td> <td> </td> <td> </td> </tr> </table>		NO.	DATE	BY	DESCRIPTION				
NO.	DATE	BY	DESCRIPTION								
<p>NE 16th Ave</p> <p>Stationing: 0+00 to 0+50</p> <p>Width: 6'-0"</p> <p>Right-of-Way: 10'-0"</p>		<table border="1" style="width:100%; border-collapse: collapse;"> <tr> <th>NO.</th> <th>DATE</th> <th>BY</th> <th>DESCRIPTION</th> </tr> <tr> <td> </td> <td> </td> <td> </td> <td> </td> </tr> </table>		NO.	DATE	BY	DESCRIPTION				
NO.	DATE	BY	DESCRIPTION								
<p>NE 23rd Ave</p> <p>Stationing: 0+00 to 0+50</p> <p>Width: 6'-0"</p> <p>Right-of-Way: 10'-0"</p>		<table border="1" style="width:100%; border-collapse: collapse;"> <tr> <th>NO.</th> <th>DATE</th> <th>BY</th> <th>DESCRIPTION</th> </tr> <tr> <td> </td> <td> </td> <td> </td> <td> </td> </tr> </table>		NO.	DATE	BY	DESCRIPTION				
NO.	DATE	BY	DESCRIPTION								

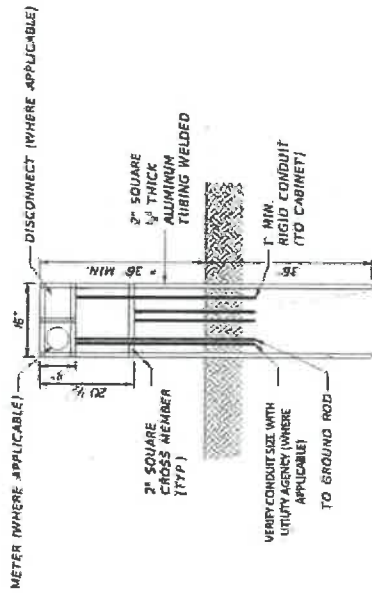

DISCONNECT
NT 5
"A" FRAME STAND DETAIL

* CONTRACTOR TO COORDINATE WITH POWER SERVICE PROVIDER FOR SPECIFIC METER/DISCONNECT MOUNTING HEIGHT

TRAFFIC SIGNAL (METERED)

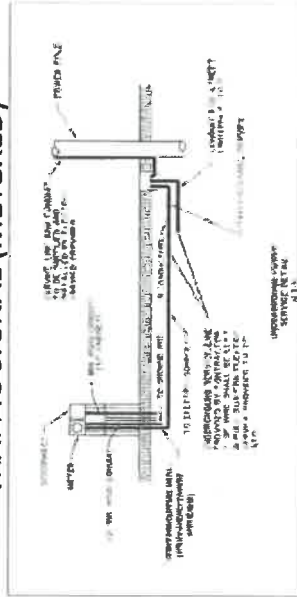

NO.	DATE	BY	CHKD.	APP.

Kimley-Horn
CONSULTING ENGINEERS
1000 WEST 10TH AVENUE, SUITE 100
DENVER, COLORADO 80202
TEL: 303.733.8900
WWW.KIMLEY-HORN.COM

11/20/2014
DATE PLOTTED
11/20/2014
DATE PRINTED
11/20/2014
PAGE 1 OF 1

CITY OF GAINESVILLE
16307000
PROJECT NO.
ALACHUA
COUNTY
FLORIDA
DESIGN

SPECIAL DETAILS

Sheet No. **T9**