



**Metropolitan Transportation Planning Organization**  
For the Gainesville and Alachua County Area

## **Information Item 8.1**

### **Interim Executive Director Report**

Attachments:

Tentative Work Program

SU Funding Plan

List of Priority Projects

Stadium Road Concept

Safe Streets for All

New Roadway Jurisdiction Webmap



# Tentative Five-Year Work Program Fiscal Years 2026/2027 - 2030/2031

## HYBRID PUBLIC HEARING

**Tuesday, October 21, 2025**

**Open House: 4:30 to 6:30 p.m.**

**Presentation: 6 p.m.**

### **In Person:**

Jacksonville Urban Office Training Facility  
2198 Edison Avenue  
Jacksonville, FL 32204

### **Virtual Public Hearing:**

Online: [nflroads.com/VPH](https://nflroads.com/VPH)  
[www.D2WPPH.com](https://www.D2WPPH.com)  
By Phone: (415) 655-0052  
Access Code: 883-020-274

This meeting will serve as the official public hearing for the Tentative Five-Year Work Program for FDOT District Two. There will be a brief work program development presentation at 6 p.m. followed by a public comment period. Department staff will be on hand to answer questions or concerns for all counties in District Two.

Interested persons may join the virtual public hearing (VPH) from a computer, tablet or phone or participate in person at the FDOT Jacksonville Urban Office Training Facility, 2198 Edison Avenue, Jacksonville, FL 32204. All participants, regardless of their chosen platform, will experience the same live hearing.

Participants who are unable to attend the webinar online can still listen to the hearing by calling: (415) 655-0052 and entering access code: 883-020-274 when prompted. Please note that while the call-in number is listen-only, callers may submit comments directly to Mr. Greg Evans, FDOT District Two Secretary, at the address listed below.

Public participation is solicited without regard to race, color, religion, sex, age, national origin, disability or family status. Persons who require special accommodations under the Americans with Disabilities Act or persons who require translation services (free of charge) should contact Teresa Thrasher at (800) 749-2967 ext. 7447 at least 7 days before the hearing.

If you cannot make the hearing, visit [nflroads.com/vph](https://nflroads.com/vph) to get information and submit comments. Comments will be received by the Department at the hearing, at [nflroads.com/vph](https://nflroads.com/vph) or by mail until **November 20, 2025** to be documented as part of the public hearing transcript.

### **Comments should be addressed to:**

Greg Evans, District Two Secretary  
Florida Department of Transportation  
1109 S. Marion Avenue, Mail Station 2000  
Lake City, Florida 32025-5874  
(386) 758-3700 or (800) 749-2967  
Email: [greg.evans@dot.state.fl.us](mailto:greg.evans@dot.state.fl.us)

## Gainesville MTPO SU Funding Plan

5/1/2025

SU Funded Projects	Project Number	Funded Thru Phase	Project Description
SR 26 from NW 34th St to SE 31st Street	215599-4	Design FY 24/25	Complete Streets
SR 24 from NE 3 <sup>rd</sup> Ave to SR 222 (NE 39th Ave)	427326-5	CST FY 24/25	Intersection Improvement
US 441 from Archer Rd to Museum Rd	435891-3	CST FY 25/26	Intersection/Multiuse Path
SR 26 from NW 43rd Street to SW 38th Street	441046-2	CST FY 28/29	Add Bike Lanes
SR 26 from SW 38 <sup>th</sup> Street to Gale Lemerand Dr (Priority #4)	207817-5	CST FY 26/27	Ped Upgrades added to Resurfacing
NW 143rd Street from Newberry Rd to NW 39 <sup>th</sup> Avenue (Priority #6)		PD&E FY 26/27	Construct a Multiuse path
US 441 at Stadium Rd (Priority #5)		Design FY 27/28 CST FY 29/30	Ped Intersection Modification

Red = New Project

# List of Priority Projects

Fiscal Years 2026-27 to 2030-31

Adopted

February 3, 2025



Metropolitan Transportation  
Planning Organization  
for the  
Gainesville Urbanized Area

## A. Transportation System Priorities

**Table 1**  
**Transportation System Priorities**  
**Gainesville Metropolitan Area**  
**Fiscal Years 2026-27 to 2030-31**

Number	Local Funds Available	Funding Source	Project	Location	Description
1			Newberry Road [SR 26]	FM: NW 43 Street TO: NW 38 Terrace	Install Offstreet Bicycle/Pedestrian facilities per modified design
2			Americans with Disabilities Act Modifications	AT: Gainesville Metropolitan Areawide	Modifications to Deficient Sidewalks, Ramps and Transit Stops
3	YES	TAP	NE 27 Avenue	FM: State Road 222 TO: State Road 26	Construct 8-Foot Multiuse Path on North Side of Roadway
4			University Avenue [SR 26]	FM: W 34 Street [SR 121] TO: NW 22 Street	2-Lane Divided with Center Turnlanes with Pedestrian Crossing [Raised Medians Study]
				FM: NW 22 Street TO: NE 31 Street	Upgrade Streetlighting; Widen Sidewalks; Add Protected Bikelanes; Additional Landscaping and Raised Medians; Narrow General Purpose Lanes
5			W 13 Street [U.S. HWY 441]	FM: SW 9 Avenue TO: NW 5 Avenue	More Areas with Medians; Widen Medians Narrower Vehicle Lanes
6	YES		NW 143 Street	FM: Newberry Road [SR 26] TO: NW 39 Avenue [SR 222]	Complete Sidewalk Network
7		SS SR2S SUNTrail TAP	Waldo Road [SR 24]- Williston Road [SR 331]-	AT: NE 3 Avenue	Intersection Modifications
				FM: University Avenue [SR 26] TO: NE 39 Avenue [SR 222] FM: SE 4 Street TO: University Avenue [SR 26]	Provide Bicycle and Pedestrian Safety Enhancements
8	YES		SW 47th Avenue Extension	FM: SW 34 Street TO: Williston Road/SW 27 Street	Extend 2-Lane Facility
9			Archer Road [SR 24]	FM: SW 34 Street [SR 121] TO: SW 16 Avenue [SR 226]	Add Midblock Pedestrian-Actuated Crossings and evaluation of Existing Traffic Signals for Pedestrian Safety

**Table 1 (Continued)**  
**Transportation System Priorities**  
**Gainesville Metropolitan Area**  
**Fiscal Years 2026-27 to 2030-31**

Number	Local Funds Available	Funding Source	Project	Location	Description
<b>10</b>			Archer Road [SR 24]	FM: SW 122 Street TO: SW 91 Street	Construct 4-Lane Divided Facility with Paved Shoulders/Bicycle Lanes
				FM: SW 91 Street TO: SW 75 Street	Reconstruct 4-Lane Divided Facility to Accommodate Dedicated Transit in the Median per Mobility Plan*

\* Does not include local funding for right-of-way and dedicated transit lane construction

ADA = Americans with Disabilities Act of 1990; AADT = Average Annual Daily Traffic; E = East; FM = From; HWY = Highway; NW = Northwest; RTS = Regional Transit System; SR2S = Safe Routes to School; SUNTrail = Shared-Use Network Trail; SR = State Road; SS = Surface Transportation Block Grant Safety Program Funds; SW = Southwest; TDP = Transit Development Plan; TAP = Transportation Alternatives Program; UF = University of Florida; U.S. = United States; W = West

**ADDITIONAL PROJECTS FOR CONSIDERATION**  
**2026 LIST OF PRIORITY PROJECTS**

	<b>PROJECT</b>	<b>AGENCY</b>	<b>DETAILS</b>
1	Newberry Road (122-98) Safety Enhancements	Alachua County	
2	Poe Springs Rd Signal or RAB	City of High Springs	
3	SW 47th Ave Extension - signal at SR331	City of Gainesville	

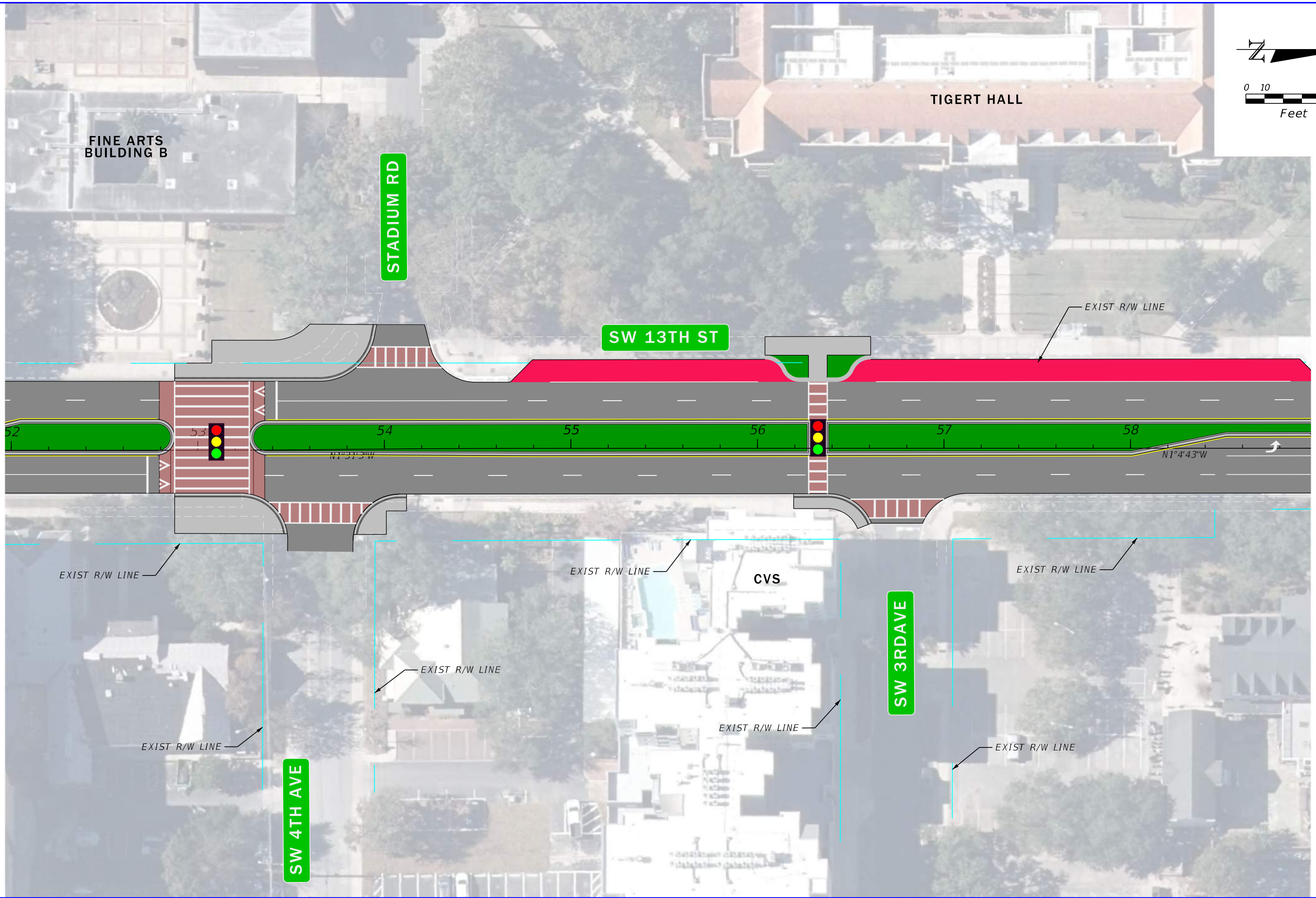
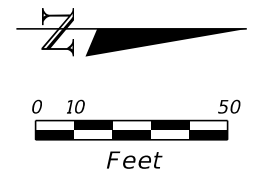

2/4/2025 4:04:31 PM williamson  
 P:\ORD\_FDOT\Worksets\FDOT\_SR\_25\_W\_13th Street\Roadway\PLAN\RD01\_V7-1.dgn

REVISIONS				ENGINEER OF RECORD			STATE OF FLORIDA DEPARTMENT OF TRANSPORTATION			SHEET NO.
DATE	DESCRIPTION	DATE	DESCRIPTION	RYAN J. WILLIAMSON LICENSE NUMBER: 81421 BURGESS & NIPLÉ, INC. 1800 PEMBROOK DRIVE, SUITE 265 ORLANDO, FLORIDA 32810			ROAD NO.	COUNTY	FINANCIAL PROJECT ID	
							SR 35	ALACHUA		

CONCEPT PLAN (7)

THE OFFICIAL RECORD OF THIS SHEET IS THE ELECTRONIC FILE DIGITALLY SIGNED AND SEALED UNDER RULE 61G15-23.004, F.A.C.

# US 441 at SW 4th Ave / Stadium Road



STRAIN POLE WITH PEDESTRIAN  
DETECTOR AND SIGNAL

STADIUM RD

STRAIN POLE  
WITH PEDESTRIAN  
DETECTOR AND SIGNAL

UNION RD

441

SW 13th ST

STRAIN POLE  
WITH PEDESTRIAN  
DETECTOR AND SIGNAL

SW 4th AVE

STRAIN POLE  
WITH PEDESTRIAN  
DETECTOR AND SIGNAL

SW 3rd AVE

SW 2nd AVE

- LEGEND
- MILLING AND RESURFACING
  - WIDENING
  - CONCRETE SIDEWALK
  - SOD
  - RAISED CROSSWALK

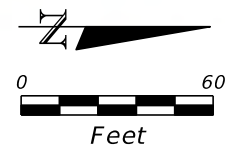



## **Metropolitan Transportation Planning Organization** For the Gainesville and Alachua County Area

### **UF/City of Gainesville Safe Streets 4 All Project:**

#### **INTEGRATING ROAD SAFETY AUDITS TO ENHANCE GAINESVILLE'S VISION ZERO ACTION PLAN**

This initiative focuses on conducting comprehensive Road Safety Audits along two high-risk multimodal corridors—34th Street (SR 121) and SW 35th Place. These corridors were identified in Gainesville's Vision Zero Action Plan as priority locations for safety improvements, especially in underserved communities.

Using a data-driven approach combined with input from residents, agencies, and community partners, the project will identify systemic and site-specific safety issues, propose equitable countermeasures, and support the City's Vision Zero commitment to eliminate traffic fatalities and serious injuries.

<https://techtransfer.ce.ufl.edu/tech-transfer/integrating-road-safety-audits-to-enhance-gainesvilles-vision-zero-action-plan/>



**Metropolitan Transportation Planning Organization**  
For the Gainesville and Alachua County Area

## **New Roadway Jurisdiction Map**

In response to MTPO Board discussion and interest, Alachua County has created a Roadway Jurisdiction Map, including ownership and maintenance responsibility for all streets and roadways in Alachua County.

<https://experience.arcgis.com/experience/2d75170a72fd4262828f93c842ca5295>