

DIMENSIONS ARE APPROXIMATE
 OVERALL HEIGHT = 112"
 OVERALL WIDTH WITH RUB
 RAILS & FENDERETTES = 98"

(7) WHELEN 900 SUPER LED WARNING LIGHTS
 RED/RED/RED/WHITE/RED/RED/RED
 WITH CLEAR LENSES

(5) AMBER
 MINI-LED MARKER LIGHTS

OEM POWER
 ADJUSTABLE
 MIRRORS

FLASHING HEADLIGHTS W/
 DAYTIME RUNNING LIGHTS

(2) 100W SIREN
 SPEAKERS IN THE BUMPER

(2) WHELEN ION SERIES
 RED SUPER LED GRILLE
 LIGHTS WITH CLEAR LENSES

HIDDEN UNLOCK SWITCH
 IN GRILLE AREA

THIS DRAWING IS FOR REPRESENTATIONAL PURPOSES ONLY. DETAILS ARE CONCEPTUAL AND ARE SUBJECT TO CHANGE DURING DESIGN AND CONSTRUCTION
 DIMENSIONS ARE APPROXIMATE UNLESS NOTED OTHERWISE TO MEET A SPECIFIC CUSTOMER NEED.

MODEL YEAR 2025



FRONT EXTERIOR VIEW
 CHIEF XL-I/F450-F550 CHASSIS

DATE: 2-22-24
 DWG. TKD REV. NR
 DATE:

DRAWING NO.
 CHIEFXL-1

APPROVAL SIGNATURE:

DIMENSIONS ARE APPROXIMATE
OVERALL HEIGHT = 112"
OVERALL WIDTH WITH RUB
RAILS & FENDERETTES = 98"

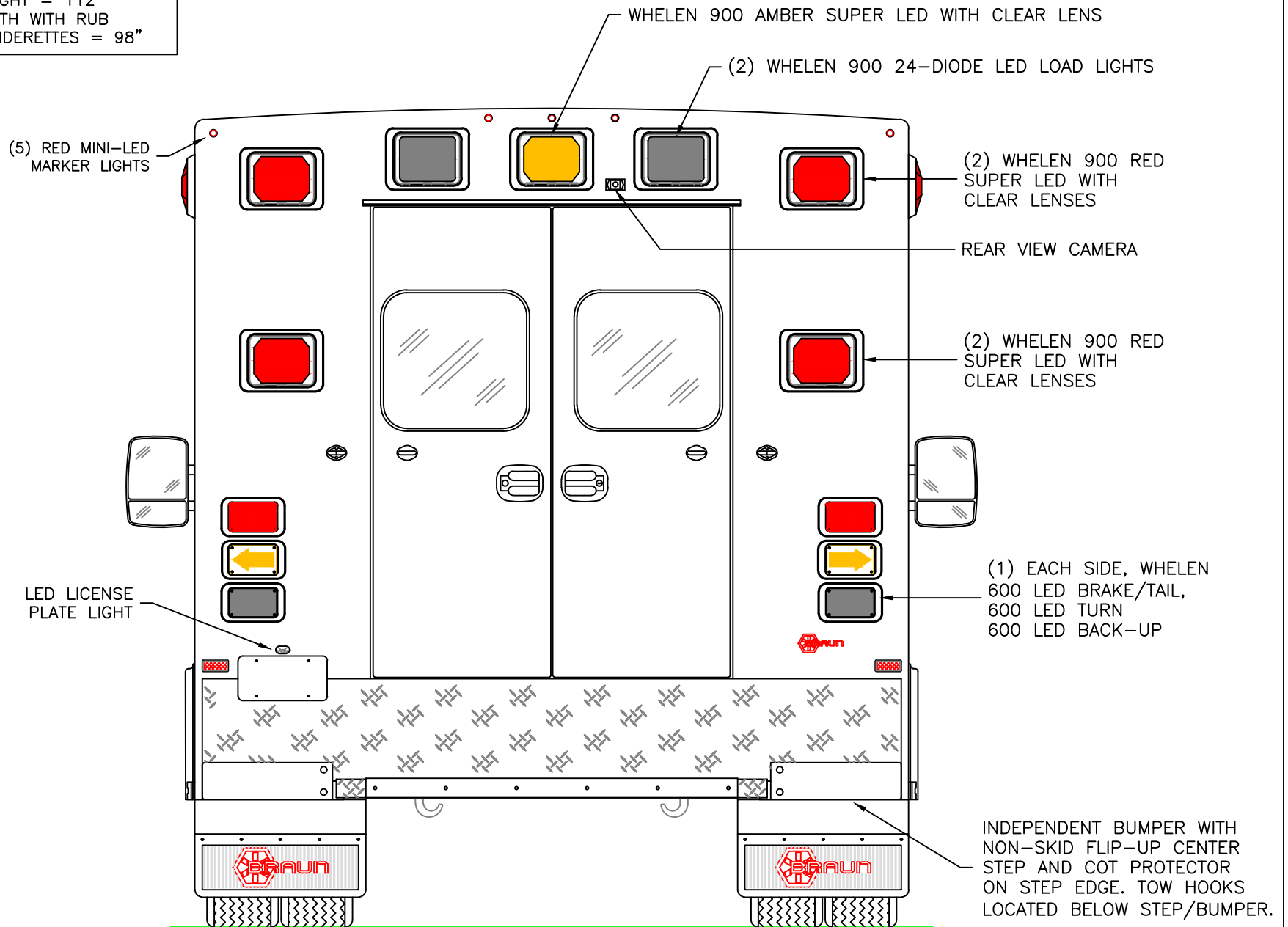

THIS DRAWING IS FOR REPRESENTATIONAL PURPOSES ONLY. DETAILS ARE CONCEPTUAL AND ARE SUBJECT TO CHANGE DURING DESIGN AND CONSTRUCTION
DIMENSIONS ARE APPROXIMATE UNLESS NOTED OTHERWISE TO MEET A SPECIFIC CUSTOMER NEED.

MODEL YEAR 2025



REAR EXTERIOR VIEW
CHIEF XL-1/F450-F550 CHASSIS

1:16

DATE: 2-22-24
DWG. TKD
REV. NR

DRAWING NO. CHIEFXL-2

DIMENSIONS ARE APPROXIMATE
OVERALL HEIGHT = 112"
OVERALL LENGTH = 307"
MODULE LENGTH = 169"

NOTE: DEF FILL REMOVED IF
GAS CHASSIS IS QUOTED.

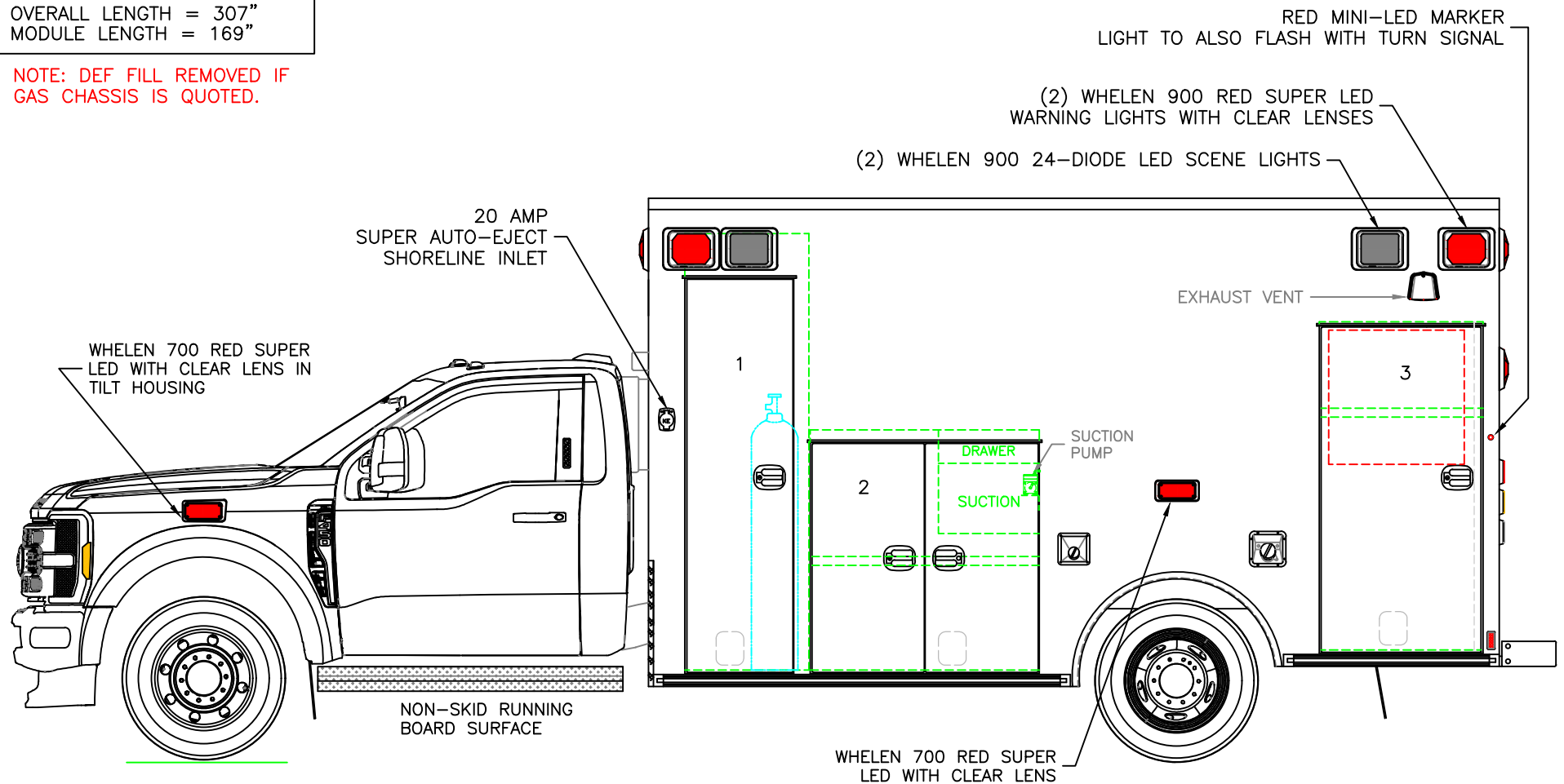

COMPARTMENT

O.S.S #1

CLEAR OPENING: 77.00h x 18.25w
INSIDE DIM'S.: 86.75h x 24.50w x 20.75d
MAIN OXYGEN STORAGE

O.S.S #2

CLEAR OPENING: 44.25h x 39.50w
INSIDE DIM'S.: 47.75h x 45.50w x 20.75d
(1) ADJUSTABLE SHELF

O.S.S #3

CLEAR OPENING: 63.50h x 28.75w
INSIDE DIM'S.: 65.25h x 32.50w x 20.75d
INSIDE/OUTSIDE ACCESS
(1) ADJUSTABLE SHELF

THIS DRAWING IS FOR REPRESENTATIONAL PURPOSES ONLY. DETAILS ARE CONCEPTUAL AND ARE SUBJECT TO CHANGE DURING DESIGN AND CONSTRUCTION
DIMENSIONS ARE APPROXIMATE UNLESS NOTED OTHERWISE TO MEET A SPECIFIC CUSTOMER NEED.

MODEL YEAR 2025



STREETSIDE EXTERIOR VIEW
CHIEF XL-I/F450-F550 CHASSIS

1:30

DATE:

2-22-24

DWG.

TKD

REV.

NR

DRAWING NO.

CHIEFXL-3

DIMENSIONS ARE APPROXIMATE
 OVERALL HEIGHT = 112"
 OVERALL LENGTH = 307"
 MODULE LENGTH = 169"

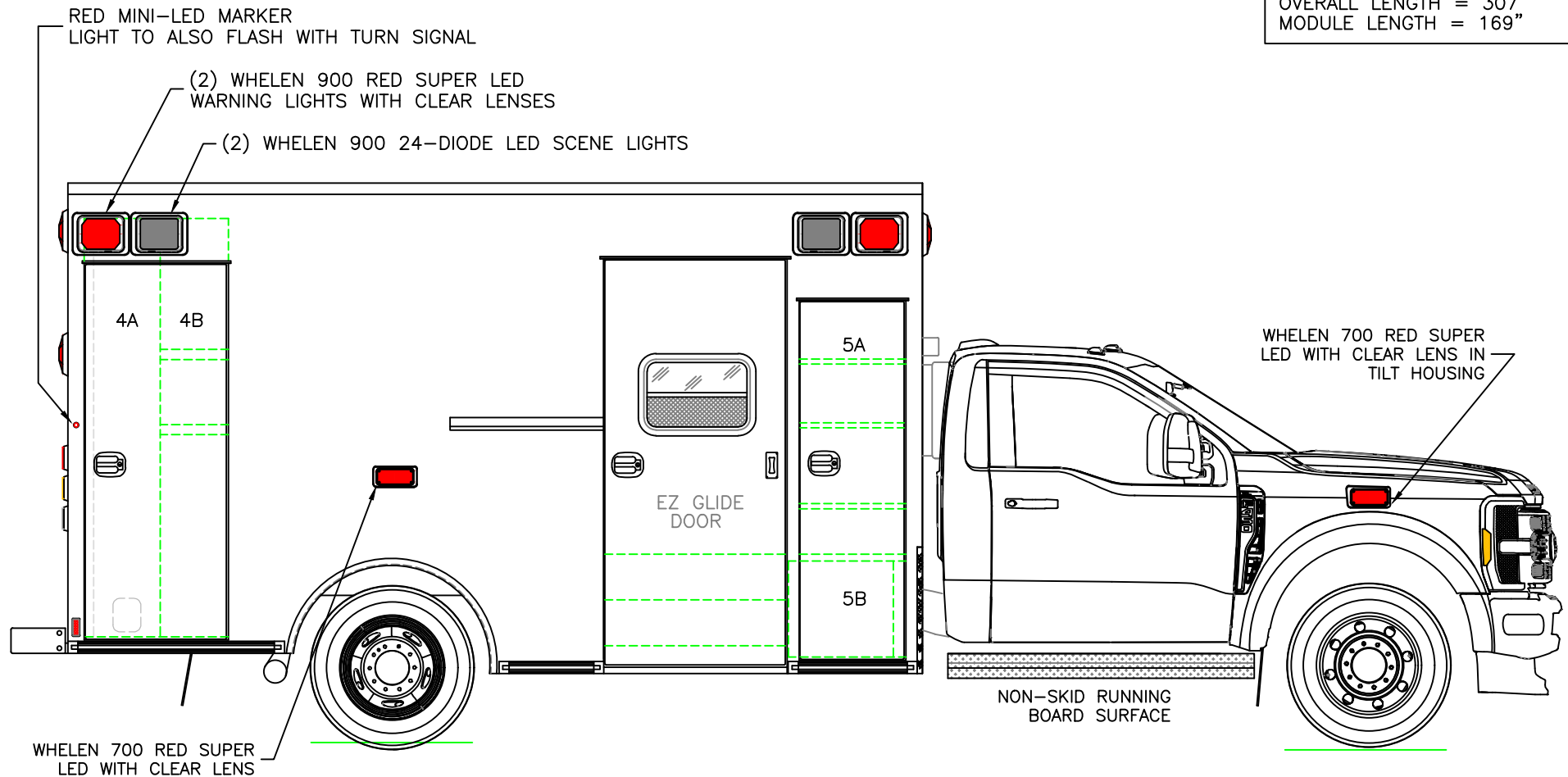

COMPARTMENT
 O.S.S #4

CLEAR OPENING: 73.00h x 24.75w
 INSIDE DIM'S. 4A: 82.75h x 15.00w x 20.75d
 BACKBOARD/SCOOP STORAGE
 INSIDE DIM'S. 4B: 82.75h x 13.50w x 20.75d
 (2) ADJUSTABLE SHELVES WITH INSIDE/OUTSIDE ACCESS

O.S.S #5

CLEAR OPENING: 69.50h x 17.50w
 INSIDE DIM'S. 5A: SEE PARTITION INTERIOR VIEW
 INSIDE/OUTSIDE STORAGE WITH (3) ADJUSTABLE SHELVES
 INSIDE DIM'S. 5B: 19.00h x 20.75w x 18.00d

THIS DRAWING IS FOR REPRESENTATIONAL PURPOSES ONLY. DETAILS ARE CONCEPTUAL AND ARE SUBJECT TO CHANGE DURING DESIGN AND CONSTRUCTION
 DIMENSIONS ARE APPROXIMATE UNLESS NOTED OTHERWISE TO MEET A SPECIFIC CUSTOMER NEED.

MODEL YEAR 2025



CURBSIDE EXTERIOR VIEW
 CHIEF XL-I/F450-F550 CHASSIS

1:30

DATE:
 2-22-24
 DWG. TKD
 REV. NR

DRAWING NO.
 CHIEFXL-4

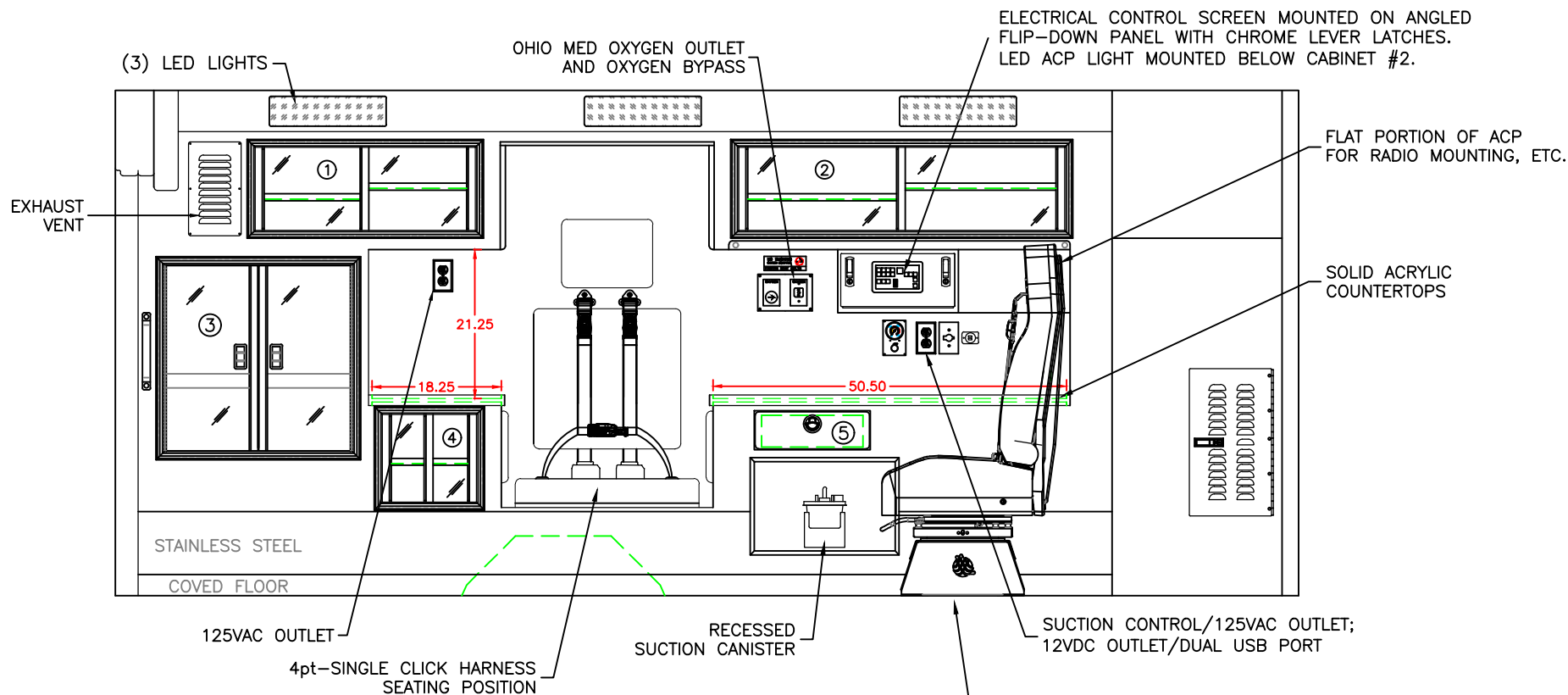

COMPARTMENT

#1 DOOR OPENING: 11.75h x 31.50w

INSIDE DIMS: 13.25h x 33.00w x 17.25d

(1) ADJ SHELF EACH SIDE OF CENTER DIVIDER

SLIDING POLYCARBONATE DOORS

TOTAL CABINET WEIGHT RATING = 25 lbs.

#2 DOOR OPENING: 11.75h x 46.50w

INSIDE DIMS: 13.25h x 48.00w x 17.25d

(1) ADJ SHELF EACH SIDE OF CENTER DIVIDER

SLIDING POLYCARBONATE DOORS

TOTAL CABINET WEIGHT RATING = 25 lbs.

#3 DOOR OPENING: 26.50h x 26.75w

INSIDE DIMS: O.S.S. #3

HINGED POLYCARBONATE DOORS WITH FULL LENGTH

HANDLES AND CENTER SQUEEZE LATCHES

TOTAL CABINET WEIGHT RATING = 40 lbs.

#4 DOOR OPENING: 12.50h x 13.50w

INSIDE DIMS: 14.00h x 15.00w x 17.25d

(1) ADJUSTABLE SHELF

SLIDING POLYCARBONATE DOORS

TOTAL CABINET WEIGHT RATING = 15 lbs.

#5 PULL-OUT DRAWER WITH HINGED ACRYLIC WRITING SURFACE

INSIDE DIMS: 4.50h x 14.50w x 13.25d

LOCKING STAINLESS STEEL FLUSH PULL LATCH

TOTAL DRAWER WEIGHT RATING = 10 lbs.

THIS DRAWING IS FOR REPRESENTATIONAL PURPOSES ONLY. DETAILS ARE CONCEPTUAL AND ARE SUBJECT TO CHANGE DURING DESIGN AND CONSTRUCTION
DIMENSIONS ARE APPROXIMATE UNLESS NOTED OTHERWISE TO MEET A SPECIFIC CUSTOMER NEED.

MODEL YEAR 2025



STREETSIDE INTERIOR VIEW

CHIEF XL-I

1:22

DATE:
3-11-24
DWG. TKD
REV. NR

DRAWING NO.

CHIEFXL-5

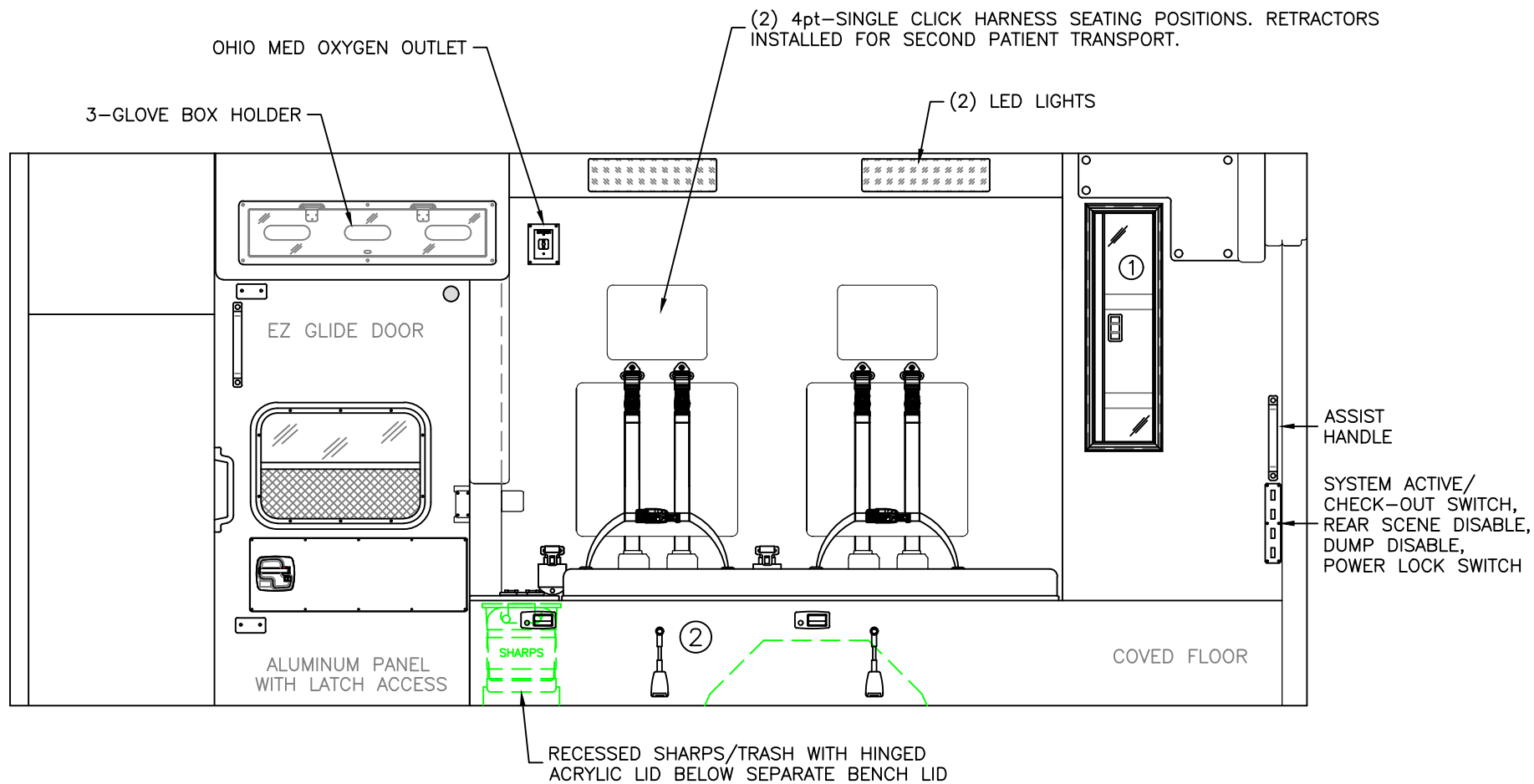

COMPARTMENT

#1 DOOR OPENING: 30.00h x 7.25w
 INSIDE/OUTSIDE ACCESS TO OSS #4B
 HINGED POLYCARBONATE DOOR WITH FULL LENGTH
 HANDLE AND CENTER SQUEEZE LATCH
 TOTAL CABINET WEIGHT RATING = 25 lbs.

#2 INSIDE DIM'S: 14.25h x 77.00w x 21.00d

THIS DRAWING IS FOR REPRESENTATIONAL PURPOSES ONLY. DETAILS ARE CONCEPTUAL AND ARE SUBJECT TO CHANGE DURING DESIGN AND CONSTRUCTION
 DIMENSIONS ARE APPROXIMATE UNLESS NOTED OTHERWISE TO MEET A SPECIFIC CUSTOMER NEED.

MODEL YEAR 2025



CURBSIDE INTERIOR VIEW
 CHIEF XL-I

1:20

DATE:	3-11-24
DWG.	TKD
REV.	NR

DRAWING NO.
CHIEFXL-6

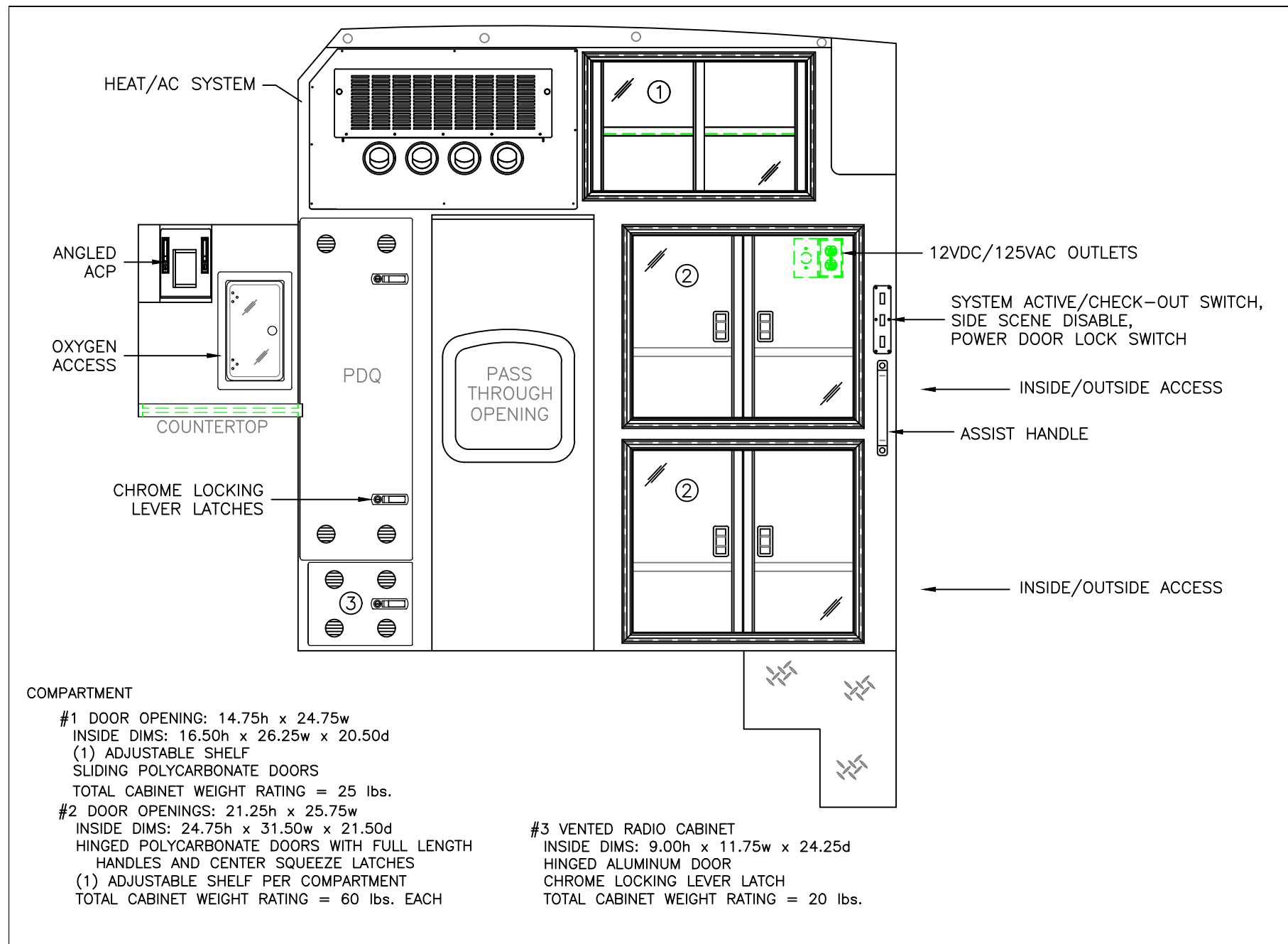

THIS DRAWING IS FOR REPRESENTATIONAL PURPOSES ONLY. DETAILS ARE CONCEPTUAL AND ARE SUBJECT TO CHANGE DURING DESIGN AND CONSTRUCTION
 DIMENSIONS ARE APPROXIMATE UNLESS NOTED OTHERWISE TO MEET A SPECIFIC CUSTOMER NEED.

MODEL YEAR 2025



PARTITION INTERIOR VIEW
 CHIEF XL-1

DATE:
 2-22-24
 DWG. TKD
 REV. NR

DRAWING NO.
 CHIEFXL-7

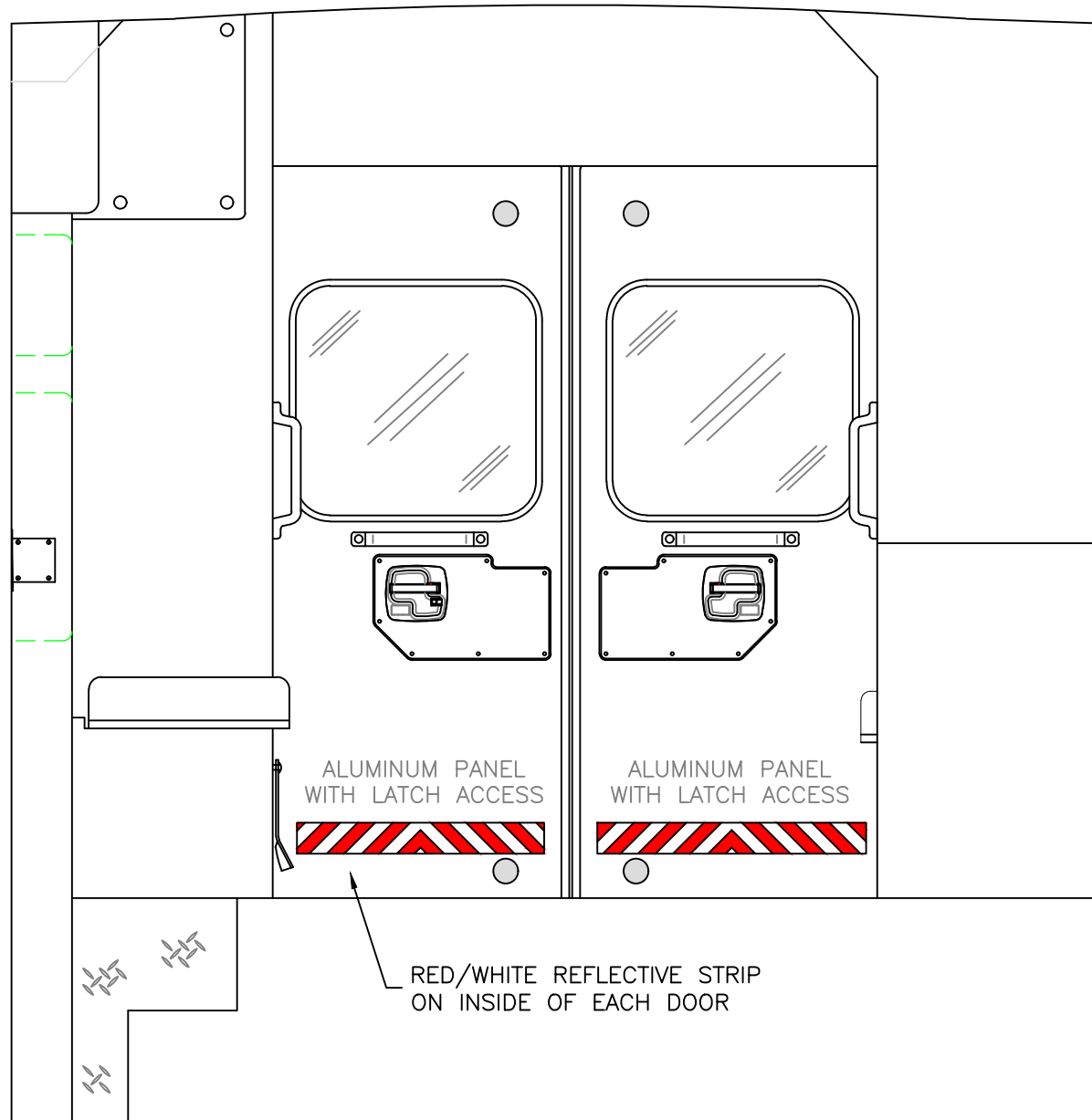

THIS DRAWING IS FOR REPRESENTATIONAL PURPOSES ONLY. DETAILS ARE CONCEPTUAL AND ARE SUBJECT TO CHANGE DURING DESIGN AND CONSTRUCTION
 DIMENSIONS ARE APPROXIMATE UNLESS NOTED OTHERWISE TO MEET A SPECIFIC CUSTOMER NEED.

MODEL YEAR 2025



REAR INTERIOR VIEW
 CHIEF XL-1

1:12

DATE:	3-11-24
DWG.	REV.
TKD	NR

DRAWING NO.
CHIEFXL-8

RECESSED SHARPS/TRASH WITH HINGED
ACRYLIC LID BELOW SEPARATE BENCH LID

(8) LED
DOME LIGHTS

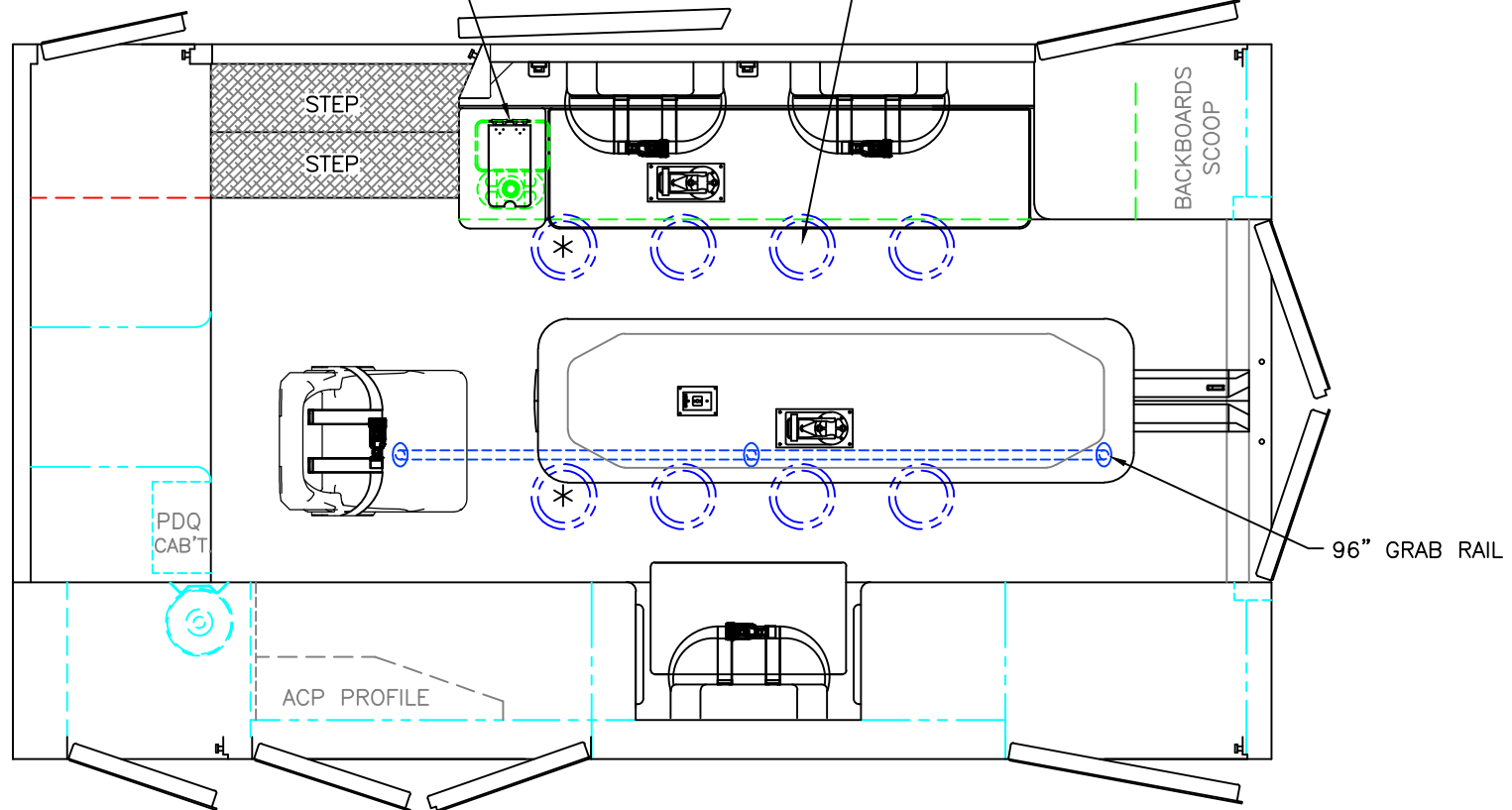

 = (2) RECESSED CEILING IV HANGER LOCATIONS

 = (1) CEILING OXYGEN OUTLET

* (2) ANTENNA BASES LOCATED OUTBOARD OF
DOME LIGHTS WITH COAX SERVICE LOOP

96" FERNO STAT-TRAC CENTER MOUNT COT HARDWARE

MODULE WIDTH = 96"
MODULE LENGTH = 169"
MODULE HEAD ROOM = 72"

THIS DRAWING IS FOR REPRESENTATIONAL PURPOSES ONLY. DETAILS ARE CONCEPTUAL AND ARE SUBJECT TO CHANGE DURING DESIGN AND CONSTRUCTION
DIMENSIONS ARE APPROXIMATE UNLESS NOTED OTHERWISE TO MEET A SPECIFIC CUSTOMER NEED.

MODEL YEAR 2025



FLOOR INTERIOR VIEW
CHIEF XL-I

1:22

DATE:
3-11-24
DWG. TKD
REV. NR

DRAWING NO.
CHIEFXL-9



Quotation Summary

Florida Sheriff's Association Braun Proposals 2025-01-30 17-00-55

Reference: QUO0000011897 **Rev:** 0
Purchaser: Ten-8 Fire Equipment, Inc.
Contact: Cindy Morgan
Address: 2904 59th Ave. Dr. East
Brandenton, FL
USA
Telephone:

Opportunity: Florida Sherrif's Association
Account: Florida Sheriff's Association
Contact: Cindy Morgan
Billing Address: 2617 Mahan Drive
Tallahassee, FL
USA
Currency: USD
Quotation Date: 2025-01-29
Quote Exp Date: 2025-02-28
Price Effective: 2025-01-29
Factory Contact: Chuck Burgess
Mobile: 4196517924

Sales Contact: Travis Parsons
Mobile: 419-203-2217
Phone: 877-989-7660

Name

Chief XL Type I

Specifications

-72" Headroom
-169"L Full Seam Welded Module





Sales Options by Category

Braun - KKK Change Notice

Item Number	Description	Quantity
00-01-0001	GENERAL CONDITIONS	1.00
00-01-0006	DYNAMIC SIDE IMPACT & ROLLOVER TESTS	1.00
00-01-0017	BIDDER IS KKK-A-1822F AMENDMENT 1 COMPLIANT	1.00
80-10-0000	KKK-A-1822F COMPLIANCE PACKAGE KKK-A-1822F compliance sticker, electrical load analysis sticker, and payload sticker shall be installed in the oxygen compartment. Any deviations from KKK-A-1822F shall be listed in the vehicle delivery packet with a notation on the-compliance sticker.	1.00
00-01-0029	NO CONTRACT REQUIRED NO STS, HGAC, FSA, SOURCEWELL or GPO contract required	1.00
00-01-0053	NO BOND REQUIRED No Bond is Required	1.00

Braun - Chassis

Item Number	Description	Quantity
00-01-0040	Administration Fee	1.00
MODULE_XLF450-550	TYPE I - AMBULANCE - CHIEF XL I FORD - 72 INCH INTERIOR HEADROOM Chief XL Type I - 169" Module - 72" Interior Headroom. Manufactured in Van Wert, Ohio, USA.	1.00
CH_F2550L	CHASSIS - FORD F550 193" WB 4X2 DRW (108 C.A.) DIESEL ENGINE FORD F550 CHASSIS CAB, 193" WB 4X2 DRW (108" C.A.)	1.00
15-00-0010	FUEL TANK - FULL UPON FACTORY RELEASE The chassis fuel tank of the completed unit shall be full at time of release from the ambulance manufacturer's facility.	1.00
20-10-0603	ENGINE BLOCK HEATER - OEM PLUG An engine block heater shall be included in the chassis with the 125 VAC power cord.	1.00
20-20-0252	HEAT SHIELDS, PROTECTIVE Install: aluminized steel protective heat shields to the upper laterals above the exhaust system.	1.00
20-20-0277B	HIGH IDLE SYSTEM - B A high-idle module will be added to the chassis. The high idle will be engaged automatically by the M-Tech system when all chassis parameters are met. Chassis parameters include but not limited to vehicle in park, service brake not depressed, accelerator not depressed, parking brake set and battery voltage. High-idle may also be	1.00



activated by the M-Tech heat or A/C.FORD F-SERIES ONLY: A high-idle/parking brake module will be added to the chassis The chassis parking brake signal will also be provided by this module.

20-01-0105	SUSPENSION - LIQUID SPRING TYPE I Install: Liquid Spring	1.00
20-10-0206	BATTERY - TWO SYSTEM - F SERIES CHASSIS The vehicle shall have a 12 V two (2) battery system rated at 1500 cold cranking amps. Both batteries shall be securely installed in the Ford OEM locations, under the vehicle hood.	1.00
20-21-0101	FLOOR CONSOLE F450/F550 STANDARD CONSOLE - ALUMINUM PLEASE NOTE: Console drawings are for reference only and do not include all features depicted on the drawings. All consoles shall be designed, priced, and approved internally to allow for accurate BOM pricing. The prices shown are estimated for general budget pricing only and pricing is subject to design; must contact manufacturer for pricing validation.	1.00
30-10-0030	BACKUP ALARM Install: (OSHA approved) back up alarm with a disable control for silent backing, located on the MCC (master control console).	1.00
20-30-0806	RUNNING BOARDS - STAR PUNCHED DIAMOND PLATE Aluminum diamond plate running boards with a star punched non-skid surface shall be provided on the cab. The running boards shall be dip anodized after they are formed to retain finish and increase corrosion resistance.	1.00
20-30-0202	MIRRORS, EXT OEM MANUAL TELESCOPNG WREMOTE & HEAT The chassis shall have OEM manual telescoping, folding trailer tow mirrors with power/heated glass, heated convex spotter mirror, integrated clearance lamps/turn signals.	1.00
20-30-0261	OEM AUTO-LOCK DISABLED (cab & module doors do not auto lock or unlock) The OEM auto-lock feature will be disabled.	1.00
30-10-0753	SIREN, WHELEN 295-HFSA7-REMOTE WITH MICROPHONE (Meets CA Title 13) A Whelen 295-HFSA7 remote dual siren amplifier shall be flush-mounted in the master control console located in the cab. The siren shall be capable of hands-free operation and shall be equipped with a noise canceling microphone. (Meets CA Title 13)	1.00
30-10-0808	SIREN SPEAKERS, WHELEN SA315 - BEHIND THE GRILLE Install: Whelen dual 100-watt siren speakers shall be installed behind the grille area.	1.00
20-30-0400	TIRE PRESSURE MONITOR - QuickPressure Install QuickPressure tire pressure caps. (must check tire PSI to select correct QuickPressure Model)	1.00
20-40-0203	WHEELS, FORGED POLISHED ALUMINUM - 19.5 - F450/550 193" WB Forged, polished aluminum wheels shall be provided, to include bright hub covers and center ornaments and valve stem extensions.	1.00



Braun - Electrical

Item Number	Description	Quantity
30-06-0001	ELECTRICAL SYSTEM - MICRO PROCESSOR BASED Install: Microprocessor based multiplex system. -----	1.00
30-10-0110	ELECTRICAL CIRCUITS All electrical circuits: shall have wiring and circuit protection suitable to the demand and must meet the national electric code (NEC) wiring requirements, added on wiring (18 GA through 10 GA) color coded and stamped with code numbers for easy identification, SLX high temperature thermoplastic cross link wire used. SGX insulated cable used for all under hood / underbody battery and charging system cable. High temperature (375° f) thermoplastic loom used on all harnesses. -----	1.00
30-06-0126	ELECTRICAL COMPARTMENT (PDQ) - MULTIPLEX ELECTRICAL SYSTEM Electrical compartment / hinged door w/ (2) chrome locking lever latches/ located on the partition wall behind the attendant seat. -----	1.00
30-06-0325	FLASHER - MULTIPLEX ELECTRICAL SYSTEM Provide: Flasher within and programmed by the multiplex electrical system. -----	1.00
30-06-0350	FLASHING HEADLIGHTS - MULTIPLEX ELECTRICAL SYSTEM Headlights (high beams) shall be programmed through the multiplex system to alternate flash (wig-wag). -----	1.00
30-10-0190	GROUND FAULT CIRCUIT INTERRUPTER-GFCI Install: A 125 VAC, 20 AMP circuit breaker with ground fault circuit interrupter (GFCI) electronic ground leakage detection in the load center for the shoreline circuit. -----	1.00
30-06-0285	MODULE DISCONNECT - MULTIPLEX ELECTRICAL SYSTEM Install: Disconnect to keep the system power engaged after the ignition is switched to the "off" position. -----	1.00
30-06-0575	REVERSE -TRANSMISSION- FUNCTIONS - MULTIPLEX ELECTRICAL SYSTEM System programmed to provide activation for: rear outboard warning lights, rear side warning lights, rear scene lights, the rear side scene lights - when the transmission selector lever is placed into "reverse" position. -----	1.00
30-06-0150	SPARE CIRCUIT - MULTIPLEX ELECTRICAL SYSTEM Provide (1) spare 15-amp circuit. -----	1.00
30-06-0175	WIRING HARNESS CONNECTORS - MULTIPLEX ELECTRICAL SYSTEM Connect all wiring harnesses via quick connect circular plug connectors. -----	1.00
30-06-0300	VOLTMETER - MULTIPLEX ELECTRICAL SYSTEM Provide: (1) digital voltmeter on the master control console screen. -----	1.00
30-06-0026	WARNING DISPLAY - MULTIPLEX ELECTRICAL SYSTEM Install: digital warning display integrated into the cab display console, programmed through the multiplex system to provide visual and audible indication. -----	1.00
30-06-0225	EMERGENCY MASTER SWITCH - MULTIPLEX ELECTRICAL SYSTEM	1.00



	Supply: A single emergency master switch for activating all the emergency warning lights on the master control console screen, emergency master switch will activate the module power automatically, include an Emergency Master Menu button to allow access to individual warning light functions.	
30-06-0250	CONTROL PANEL SWITCHES - MULTIPLEX ELECTRICAL SYSTEM Switches on the master control console and attendant control panel screens shall have dimmable perimeter backlighting.	1.00
30-06-0275	MODULE POWER SWITCH - MULTIPLEX ELECTRICAL SYSTEM Provide: A module power switch for the electrical system on both the Master Control Console and the Attendant Control Panel screens.	1.00
30-06-0101	ATTENDANT CONTROL PANEL (ACP) - MULTIPLEX ELECTRICAL SYSTEM Attendant Control Panel (ACP) contains a color micro processor screen, controls all equipment installed in the patient compartment.	1.00
30-06-0375	PARK OVERRIDE - MULTIPLEX ELECTRICAL SYSTEM Park override switch on the master control console screen, reactivates all lights disabled when the transmission is placed in the neutral/park position.	1.00
30-06-0400	LOAD MANAGER-SEQUENTIAL SWITCHING SYSTEM - MULTIPLEX ELECTRIC SYSTEM Load manager-sequential switching system controlled by the microprocessor based electrical system: emergency master button shall control the sequential switching of the emergency lights and/or other warning devices, load manager shall automatically shed non-critical electrical loads during low voltage conditions.	1.00
30-06-0450	FRONT CLEAR DISABLE SWITCH - MULTIPLEX ELECTRICAL SYSTEM Activation of the switch on the master control console screen to disable all forward-facing clear warning lights.	1.00
30-06-0076	MASTER CONTROL CONSOLE (MCC) - MULTIPLEX ELECTRICAL SYSTEM Floor mounted Master Control Console (MCC) located in the cab, housing siren, color microprocessor display screen, controlling all the Emergency Warning functions, Patient Compartment lighting and module heat/ac functions.	1.00
30-06-0475	CURBSIDE SCENE LIGHTS ON WITH CURBSIDE DOOR The Curbside scene lights: programmed to activate when the Curbside door is in the open position.	1.00
30-06-0500	REAR SCENE LIGHTS ON WITH REAR DOORS OPEN Rear scene lights programmed to activate when the rear doors are in the open position.	1.00
30-06-0525	DISABLE SWITCH FOR REAR SCENE LIGHTS - MULTIPLEX ELECTRICAL SYSTEM Install: disable switch at the rear door area to disable the rear scene lights.	1.00
30-06-0550	DISABLE SWITCH FOR SIDE SCENE LIGHTS - MULTIPLEX ELECTRICAL SYSTEM A disable switch shall be installed at the curbside door area to disable the curbside scene lights.	1.00
30-07-0001	CONTROL SCREEN, MCC	1.00



	Install: interface module / display screen in the cab.	
30-07-0003	CONTROL SCREEN, ACP Install: interface module / display screen mounted on an angled flip - down panel with chrome lever latches, in the patient compartment ACP area.	1.00
30-10-0901	SYSTEM ACTIVE AND CHECK OUT LIGHTS - 15 MINUTES Switch: located at the curb and rear entry doors for activation of the electrical system, check out light switch located at the curb and rear doors for activation of the LED angled lights prior to entering the module, system programmed to shut down automatically after 15 minutes unless the ignition is on.	1.00
30-06-0050	DAYTIME RUNNING LAMPS - MULTIPLEX ELECTRICAL SYSTEM OEM Daytime Running Light headlights activated for daytime operation, when transmission is placed in drive.	1.00
30-10-0050	BATTERY CONVERTER - CHARGER Connect to Shoreline inlet: 45 amp, 125 VAC to 13.6 VDC converter, capable of maintaining the batteries when plugged in.	1.00
30-10-0068	CAMERA REAR VIEW - SINGLE SYSTEM - CONTROL SCREEN Install: camera system rear view, tied to the control screen. Per Dwg #2. Camera alignment will be conducted at final inspection, if applicable.	1.00
30-10-0915	SYSTEM AUTO ACTIVE WITH ENTRY DOOR OPEN OR UNLOCK SIGNAL The system will auto activate when a module entry door is opened or when a door unlock signal is received.	1.00
30-10-0585	USB - DUAL OUTLET, ONE (1) INTERIOR LOCATED ON CONSOLE Install: (1) dual USB port outlet, 5 volt / 2.1 amp, in the vehicle, located on the Master Control Console in the cab.	1.00
USBAA101	OUTLET, USB - ONE (1) DUAL - PRIMARY ACTION AREA One (1) dual USB port outlet, 5 volt / 2.1 amp, shall be installed in the vehicle, located on the streetside primary action area in the patient compartment.	1.00
125AA101	OUTLET, 125VAC - ONE (1) INTERIOR DUPLEX - LEFT WALL ACTION AREA One (1) 2-wire +plus ground 125 VAC duplex outlet in the street side wall in the primary action area.	1.00
125AA201	OUTLET, 125VAC - ONE (1) INTERIOR DUPLEX - SECONDARY ACTION AREA One (1) 2-wire +plus ground 125 VAC duplex outlet in the street side wall in the secondary action area.	1.00
125IF201	OUTLET, 125VAC - ONE (1) INTERIOR DUPLEX - FRONT WALL CABINET One (1) 2-wire +plus ground 125 VAC duplex outlet in the front wall cabinet.	1.00
12VAA101	OUTLET, 12VDC - ONE (1) - LEFT WALL ACTION AREA One (1) 12 VDC power point outlet shall be installed in the street side wall in the primary action area. The outlet shall be labeled, "12 VDC". A Schottky diode medical isolator shall be provided to protect the 12 VDC outlet.	1.00



12VIF201	OUTLET, 12VDC - ONE (1) FRONT WALL - CABINET One (1) 12 VDC power point outlet shall be installed in the patient compartment, in the front wall cabinet. The outlet shall be labeled, "12 VDC". A Schottky diode medical isolator shall be provided to protect the 12 VDC outlet.	1.00
30-12-0001	RECEPTACLE SHORELINE INLET-SUPER 20 AMP, AUTO EJECT - YELLOW COVER Install: Kussmaul super auto eject shoreline inlet receptacle with yellow cover on module exterior per the drawings, equipped with an integral dynamic disconnect.	1.00
30-10-0657	RADIO ANTENNA BASES - TWO (2) The coax cable(s) shall terminate in radio cabinet. If no radio cabinet is present, they will terminate behind the drivers seat in the cab. Install: (2) antenna bases with attached coax cables shall be installed on the module roof. The coax cables shall terminate in radio cabinet. If no radio cabinet is present, they will terminate behind the drivers seat in the cab. Access to the antenna bases shall be through adjacent module interior dome lights.	1.00
30-10-0299	LIGHT, ATTENDANT CONTROL PANEL AREA - TECNIQ SILHO-X LED - WARM WHITE A Tecniq Silho-X 2.75" round warm white LED light with SS trim ring, shall be mounted above the left wall forward action area counter. The light shall be operated through a button on the control screen screen labeled "Attendant Light". (Braun #26415)	1.00
30-10-0310	LIGHT, LED ELECTRICAL COMPARTMENT -PDQ A 12 VDC LED light shall be located in the PDQ. The light shall be wired "battery-hot" to activate when the PDQ door is in the open position. The light shall be off when the door is in the closed position.	1.00
30-11-0106	LIGHTS, DOME LED (8) WHELEN SUPER LED Eight (8) Whelen #LED (80C0EHCR) dome lights, shall be installed. See dwg #9	1.00
30-11-0152	LIGHTS, RIDGEBACK LED PANEL (3) STREETSIDE - ANGLED Install: (3) Ridgeback LED lights streetside per dwg #5.	1.00
30-11-0176	LIGHTS, RIDGEBACK LED PANEL (2) CURBSIDE - ANGLED Install: (2) Ridgeback LED lights mounted on an angled panel above curbside seating area per dwg #6.	1.00
30-10-0410	LIGHTS, OSS COMPARTMENTS - INCANDESCENT Install: Incandescent lights, activated by magnetic switches. Compartments #1, #2, #3, and #4, each contain two (2) clear 4" round lights, and compartment #5 shall contain two (2) 2-1/2" clear round lights.	1.00
40-10-0191	LOCKS POWER - PASSAGE, 5 COMPARTMENTS, KEY FOBS Install: power door locks on module passage doors, and (5) OSS compartments, use OEM key fobs. Does not include battery bay door.	1.00
40-10-0151	SWITCH DOOR UNLOCK, WATERPROOF - HIDDEN IN FRONT GRILLE AREA Install: exterior hidden door unlock switch in grille area.	1.00
30-06-0201	RADIO TIE-IN POINT - (1) 12V/40 AMP - CAB CONSOLE AREA Install (1) set of 12 volt/40 amp radio tie-in studs in cab console: (1) battery hot, (1) ignition hot, (1) grounded stud.	1.00
30-06-0202	RADIO TIE-IN POINT - (1) 12V/40 AMP - PATIENT COMPARTMENT	1.00



Install (1) set of 12 volt/40 amp radio tie-in studs in patient compartment: (1) battery hot, (1) ignition hot, (1) grounded stud.

30-06-0203	RADIO TIE-IN POINT - (1) 12V/250 AMP - PDQ Install (1) set of 12 volt/250 amp radio tie-in studs in the PDQ: (1) battery hot, (1) ignition hot, (1) grounded stud.	1.00
------------	--	------

Braun - Exterior Lighting

Item Number	Description	Quantity
30-06-0410	WARNING LIGHTS FLASH PATTERN SIGNAL ALERT 75 - MULTIPLEX ELECTRICAL SYSTEM The default flash pattern for the vehicle warning lights: Signal Alert 75.	1.00
ClearLENS	CLEAR LENSES ON ALL WARNING LIGHTS	1.00
GWLIO0002	LIGHTS GRILLE - 2 WHELEN ION LED Two (2) Whelen ION series super LED warning lights, with waterproof connectors shall be installed the grille area of the chassis. The lights shall operate from a switch on the master control console labeled "Flashers". Note: these lights are only available with a clear lenses.	1.00
GWLC1R1R	GRILLE WARNING LIGHT LOCATION 1 - RED The warning light located on the grille in location 1 shall be red.	1.00
GWLC1R2R	GRILLE WARNING LIGHT LOCATION 2 - RED The warning light located on the grille in location 2 shall be red.	1.00
STRPTRN	STRAIGHT PATTERN WARNING LIGHTS The front warning lights will be aligned in a straight pattern across the module.	1.00
30-25-0122	LIGHTS, ICC / LED CLEARANCE - ON MODULE FRONT - TECNIQ Install: (5) amber Tecniq LED (S33-AA00-1) clearance / ICC lights on the front of the module near the roof line per dwg #1.	1.00
FWL090007	LIGHTS FRONT MODULE - 7 WHELEN 900 SUPER LED Seven (7) Whelen 900 series super LED warning lights with chrome bezels shall be installed on the module front. The lights shall operate from a switch on the master control console, labeled "Flashers".	1.00
FWLC1R1R	FRONT WARNING LIGHT LOCATION 1 - RED The warning light located on the upper front of the module in location 1 shall be red.	1.00
FWLC1R2R	FRONT WARNING LIGHT LOCATION 2 - RED The warning light located on the upper front of the module in location 2 shall be red.	1.00
FWLC1R3R	FRONT WARNING LIGHT LOCATION 3 - RED The warning light located on the upper front of the module in location 3 shall be red.	1.00
FWLC1R4W	FRONT WARNING LIGHT LOCATION 4 - WHITE	1.00



	The warning light located on the upper front of the module in location 4 shall be white.	
FWLCLR5R	FRONT WARNING LIGHT LOCATION 5 - RED The warning light located on the upper front of the module in location 5 shall be red.	1.00
FWLCLR6R	FRONT WARNING LIGHT LOCATION 6 - RED The warning light located on the upper front of the module in location 6 shall be red.	1.00
FWLCLR7R	FRONT WARNING LIGHT LOCATION 7 - RED The warning light located on the upper front of the module in location 7 shall be red.	1.00
30-25-0123	LIGHTS, ICC / LED CLEARANCE - ON MODULE REAR - TECNIQ Install: (5) red TECNIQ LED (S33-RR00-1) clearance / ICC lights on the rear of the module near the roof line per dwg #2.	1.00
ROL090002	LIGHTS REAR MODULE, UPPER OUTER - 2 WHELEN 900 LED Two (2) Whelen 900 series super LED warning light with chrome bezels shall be installed on the upper rear of the module, in the outer location. The lights shall operate from a switch on the master control console, labeled "Flashers".	1.00
ROLCLR1R	REAR OUTER MODULE LIGHT LOCATION 1 - RED The warning light located on upper rear of the module, in outer location 1 shall be red.	1.00
ROLCLR2R	REAR OUTER MODULE LIGHT LOCATION 2 - RED The warning light located on upper rear of the module, in outer location 2 shall be red.	1.00
RCL090001	LIGHTS REAR MODULE, UPPER CENTER - 1 WHELEN 900 LED One (1) Whelen 900 series super LED warning light with a chrome bezel shall be installed on the upper rear of the module, center location. The light shall operate from a switch on the master control console, labeled "Flashers".	1.00
RCLCLR1A	REAR CENTER MODULE LIGHT LOCATION 1-AMBER The warning light located on upper rear of the module in the center location shall be amber.	1.00
RS090002	LIGHTS REAR SCENE - 2 WHELEN 900 24 DIODE LED Two (2) Whelen 900 Series super LED scene/load lights with chrome bezels shall be installed on the upper rear of the module. The lights shall operate from a switch on the master control console, labeled "Rear Scene Lights".	1.00
WL090002	LIGHTS REAR WINDOW - 2 WHELEN 900 SUPER LED Two (2) Whelen 900 series super LED warning lights with chrome flanges shall be installed on the rear of the module at window level, one (1) on each side. These lights shall operate from a switch on the master control console, labeled "Flashers".	1.00
WLCLR1R	WINDOW LEVEL LIGHT LOCATION 1 - RED The warning light located on rear of the module at window level, location 1 shall be red.	1.00
WLCLR2R	WINDOW LEVEL LIGHT LOCATION 2 - RED	1.00



The warning light located on rear of the module at window level, location 2 shall be red.

30-26-3009	LIGHTS, REAR TAIL - WHELEN 600 LED STOP, TURN, & MAXIMUM INTENSITY BACK-UP Install: (1) pair each of Whelen 600 series LED stop/tail lights, turn lights, and fully populated MAXIMUM intensity LED back-up lights with chrome bezels on rear of the module.	1.00
30-26-7002	LIGHT, LICENSE PLATE LED - WHELEN OACOEDCR Install:(1) Whelen OACOEDCR LED license plate light with 45 deg angled chrome-plated bezel on the rear of module, lower left side.	1.00
FIL07T0002	LIGHTS FRONT INTERSECTION - 2 WHELEN 700 LED W/15 DEGREE TILT HOUSING Two (2) Whelen 700 series super LED warning lights, with water-proof connectors, shall be mounted in 15 degree tilt housings on the front chassis fenders, one (1) on each side. The lights shall operate from a switch on the master control console labeled "Flashers".NOTE: When vehicle is placed in park, the override switch must be on for intersection light(s) to remain on.	1.00
FILCLR1R	FRONT INTERSECTION LIGHT LOCATION 1 - RED The warning light located on front of the chassis fender in location 1 shall be red.	1.00
FILCLR2R	FRONT INTERSECTION LIGHT LOCATION 2 - RED The warning light located on front of the chassis fender in location 2 shall be red.	1.00
RIL070002	LIGHTS INTERSECTION REAR - 2 WHELEN 700 LED Two (2) Whelen 700 series super LED warning lights with, chrome flanges and water-proof connectors, shall be installed above the rear wheel wells, one (1) on each side. These lights shall operate from a switch on the master control console screen labeled "Flashers".NOTE: When vehicle is placed in park, the override switch must be on for intersection light(s) to remain on.	1.00
RILCLR1R	REAR INTERSECTION LIGHT LOCATION 1 - RED The warning light located on above the rear wheel well at location 1 shall be red.	1.00
RILCLR2R	REAR INTERSECTION LIGHT LOCATION 2 - RED The warning light located on above the rear wheel well at location 2 shall be red.	1.00
30-27-1102	LIGHTS, ICC / LED CLEARANCE - ON MODULE SIDE - TECNIQ Install: (2) red Tecniq LED (S33-RR00-1) clearance/ICC lights, (1) red on each side at rear of the vehicle, flash with turn signal, per Dwg #3 and #4.	1.00
SWL090004	LIGHTS SIDE WARNING - 4 WHELEN 900 SUPER LED Four (4) Whelen 900 series super LED warning lights with chrome flanges shall be installed, two (2)on each side of module exterior per dwg.	1.00
SWLCLR1R	SIDE WARNING LIGHT LOCATION 1 - RED The warning light located on side of the module, in outer location 1 shall be red.	1.00
SWLCLR2R	SIDE WARNING LIGHT LOCATION 2 - RED The warning light located on side of the module, in outer location 2 shall be red.	1.00



SWLCLR3R	SIDE WARNING LIGHT LOCATION 3 - RED The warning light located on side of the module, in outer location 3 shall be red. -----	1.00
SWLCLR4R	SIDE WARNING LIGHT LOCATION 4 - RED The warning light located on side of the module, in outer location 4 shall be red. -----	1.00
SS090004	LIGHTS SIDE SCENE - 4 WHELEN 900 24 DIODE LED Four (4) Whelen 900 series 24 Diode LED scene lights with chrome flanges shall be installed, two (2) each module side. These lights shall operate from switches on the master control console labeled "Left Scene Light" and "Right Scene Light". -----	1.00

Braun - Module Body Construction

Item Number	Description	Quantity
39-00-0005	AWS ALUMINUM CERTIFIED WELDERS -----	1.00
39-10-0003	CONNECTIONS, MODULE Bolt: to the chassis frame rail with (12) 5/8" -11 grade 8 bolts through OEM rubber insulating spacers installed on outriggers at twelve (12) separate locations (six each frame rail), providing noise insulation and easy removal for chassis replacement, mounting bolts to be properly torqued and secured with locktite, system used for fastening the module to the frame to be that approved by the chassis manufacturer.	1.00
40-00-0080	INSULATION - POLYURETHANE SPRAY FOAM The entire underside of the module floor (except for mounting pads), the underside of the outside storage compartments, the wheel wells, and the underside of the curbside step area shall be completely insulated with sprayed on Class I urethane foam for thermal and acoustical insulation. The insulation shall comply with FMVSS #302 flame spread requirements. The underside of the body shall be properly prepared to ensure adhesion before the spray insulation is applied.	1.00
40-00-0079	INSULATION - EXTERIOR PASSAGE AND OSS DOORS AND INTERIOR WALLS AND CEILING The walls, ceiling, passage doors, and outside storage doors shall have foam for thermal and acoustical insulation. The insulation shall comply with FMVSS #302 flame spread requirements. -----	1.00
39-00-0001	MODULE BODY CONSTRUCTION - SEAMLESS Module: fabricated entirely of parts cut and formed from .125" (minimum) thickness 5052-H32 flat aluminum sheet stock, using CNC machines capable of .010" repeatability. This is the only alloy that may be used for body parts that are welded together. Roll-cage type interior super-structure, aluminum partition and module welded together into a single unit, roof designed with a minimum 1.5" crown to facilitate water run-off. Floor, roof, sides, all exterior doors fabricated from .125" (minimum) thick flat aluminum sheet stock, exterior joints between the roof and side components continuous full seam welded the entire length of the module. All exterior body panel joints continuous full seam welded. No VHB bonding tape or other adhesives used in the construction of the ambulance module. -----	1.00
39-00-0002	SOLE SOURCE MODULE BODY CONSTRUCTION	1.00



Braun - Module Features / Exterior

Item Number	Description	Quantity
40-00-0009	ALUMINUM PARTS - MODULE EXTERIOR All unpainted exterior aluminum parts to be bright dip anodized after fabrication to retain the finish and increase corrosion resistance.	1.00
40-00-0010	CORROSION MINIMIZATION - MODULE All module contact with dissimilar metals shall be minimized with the use of nylon screw-hole inserts to provide hinge to door isolation with the module body, polypropylene strip hinge isolation, polyethylene backed rubber tape, ceramic coated stainless steel hinge bolts, and corrosion inhibitor spray.	1.00
40-00-0020	DOOR CONSTRUCTION - GASKET PLACEMENT All exterior hinged module doors shall be constructed in an inverted pan-formed design. The pan shall be constructed from .125" thick 5052-H32 flat sheet aluminum. The exterior door skin shall be constructed of .190" thick aluminum and welded to the pan. Door gaskets shall be attached to the interior side of the door skin on the top, bottom and outer edge of the door. The gasket on the hinge side of the door will be attached to the door frame.	1.00
40-00-0060	EXTERIOR COMPARTMENTS - SWEEP-OUT Exterior module compartments: a sweep-out design to aid in facilitation of the purchaser's routine care and cleaning of the vehicle. All exterior compartment floors, with the exception of the front ALS compartment to be constructed to be flush with the bottom door frame.	1.00
40-00-0030	EXTERIOR COMPARTMENTS DESIGN All exterior compartments shall be vented and include: sound absorbing slip resistant polyurethane material sprayed on the inside of all compartments and compartment shelving, slide out trays and closeouts, baffled seep holes provided to prevent water from splashing or seeping into the exterior compartments, full-length, two-way adjustable, stainless steel hinges on all exterior compartment doors with 3/16" stainless steel hinge pins, compartment doors installed, flush with the module body, when double doors are provided, each door to have exterior handle, but only the forward door lockable, rearward door is secured when forward door is locked), all exterior compartments and passage doors keyed alike, lockable Eberhard "free-floating" type chrome plated handles with rotary locks. Gasket installed under each handle to protect the paint; drip rails installed above all exterior compartment doors.	1.00
40-00-0050	EXTERIOR COMPARTMENTS, VENTING (9) square inches (minimum) of venting inside #1, #2, #3, & #4 exterior storage compartments to provide for easier closure of the compartment doors.	1.00
40-00-0055	EXTERIOR COMPARTMENTS, VENTING - OXYGEN STORAGE (9) square inches (minimum) of venting provided in the exterior oxygen storage compartment, to dissipate any leaking oxygen gas.	1.00
40-00-0070	HANDLES, EBERHARD - CHROME FREE FLOATING TYPE	1.00



	Install: Eberhard #EMC-1-2110 chrome "free-floating" handles on each exterior module door, large enough to accommodate a gloved hand.	
40-10-0072	LOWERED MODULE SIDES Module sides to be as low as possible and still comply with KKK-1822-F ramp break over angle.	1.00
40-10-0321	STEPWELL, CURBSIDE DOORWAY - MID STEP AREA Install: aluminum diamond plate step well and mid-level step in curbside doorway threshold area.	1.00
40-00-0091	THRESHOLD, STAINLESS STEEL - ALL OSS STORAGE COMPARTMENTS Each exterior storage compartment with a hinged door: stainless steel lower threshold at the door opening to protect the paint.	1.00
40-10-0340	STONE GUARDS, MOD FRNT -ANODIZED DIAMOND PLATE Install: anodized aluminum diamond plate stone guards on module front, (1) each side.	1.00
40-10-0066	DOOR SLIDING - MODULE CURBSIDE PASSAGE Install EZ Glide curb door.	1.00
40-10-0088	DOORS - REAR PASSAGE Patient compartment rear door opening: doors flush without a protruding flange or lip, right rear passage door lockable, chrome exterior handle, left rear door non-locking, chrome exterior handle, all handles installed with a gasket, hinge full length stainless steel with a 3/16" stainless steel hinge pin, two-way adjustable, each rear door two-point slam action automotive type rotary latching system to the body, right rear door lock to the body at the top and bottom, not to left rear door, doors .218" stainless steel door latch activator rods with clevis adjusters, doors lockable from inside and outside, shut on molded, air-core, automotive type door seals to prevent water from leaking into vehicle interior.	1.00
40-10-0130	EMERGENCY RELEASE LEVER, REAR PATIENT PASSAGE DOORS Install emergency release lever, attached to each rear passage door latch to be free-floating from the interior door linkages. Access to the lever shall be behind a removable cover in the door skin.	1.00
40-10-0505	WINDOWS, PASSAGE DOOR - (CURB SLIDING, REAR FIXED) Curbside passage door (sliding) window with removable screen, rear passage doors w/ non-openable window, windows 69% dark tint, secured with black oxide coated fasteners, open doors not to block warning lights.	1.00
40-10-0103	FENDERETTES - POLISHED ALUMINUM Install: Polished aluminum fenderettes around the rear wheel well openings.	1.00
40-10-0119	HOLD-OPEN - REAR DOORS - GRABBERS Install: door grabbers (1 pair) with hard rubber inserts on rear doors.	1.00
40-10-0360	KICKPLATE/THRESHOLD, REAR DOORWAY - ANODIZED DIAMOND PLATE Install: anodized aluminum diamond plate kick plate at the rear exterior doorway, providing a kick / scuff plate at rear of the vehicle above rear step, per dwg # 2.	1.00
40-10-0204	MUD FLAPS, REAR - BLACK RUBBER FIBERGLASS REINFORCED - THREE COLOR Install black rubber, fiberglass reinforced mud flaps with a minimum 1/4" thickness bolted to underside of module behind rear wheels, to provide adequate coverage of	1.00



	ear dual wheels of the chassis, mud flaps to be (3) color with the Manufacturers Logo.	
40-10-0266	REAR STEP/BUMPER -FLIP-UP CENTER SECTION - STAR PUNCHED AND ANODIZED Affix: rear bumper to chassis frame, constructed with a hinged center section, (2) steel braces to secure step to chassis frame, outer 17" on each end of bumper constructed from heavy gauge stamped polished stainless steel bumper parts, to provide smooth rounded corners, step constructed of star punched .125" thick aluminum diamond plate, (2) rear LED step illumination lights provided. All diamond plate surfaces to be anodized; strip of black PVC installed on face of step.	1.00
40-10-0381	TOW HOOKS, MODULE REAR Secure: fasten (2) tow hooks in rear step area to rear step braces.	1.00
40-10-0280	RUB RAILS, ANODIZED ALUMINUM Install: anodized polished aluminum rub rails on lower sides of body, below outside compartment sill areas., rub rails to be offset 3/16" from body.	1.00
40-00-0019	DOOR SKINS, OUTSIDE STORAGE COMPARTMENTS - DIAMOND PLATE INTERIOR SKINS Interior door skins for all outside storage compartments constructed of .063" thick aluminum diamond plate.	1.00
OS1XL1STD	OSS #1 - STREETSIDE FORWARD OSS #1 streetside forward, hinged door with spring-loaded gas cylinder, locking handle installed on the exterior of the door.	1.00
OS1XL1OP4	OSS #1 - OXYGEN STORAGE OSS #1 streetside forward, for housing an O2 cylinder.	1.00
OS102WELD	OSS #1 - OXYGEN STORAGE BRACKET WELDED IN FOR H or M CYLINDER An oxygen storage bracket shall be welded in OSS #1 for retention of "H" or "M" oxygen cylinders.	1.00
OS2XL1STD	OSS #2 - STREETSIDE CENTER OSS #2 streetside center, hinged double doors with spring-loaded gas cylinders, handles installed on the exterior of each door, forward door with locking handle.	1.00
OS2XL1OP1	OSS #2 - (1) ADJUSTABLE SHELF OSS #2 streetside center, with one (1) adjustable shelf.	1.00
OS2SHELF1	OSS #2 - SHELF ONE (1) ADJUSTABLE WITH TRACK Outside storage compartment #2 shall contain one (1) adjustable shelf with track.	1.00
OS3XL1STD	OSS #3 - STREETSIDE REAR - TALL DOOR OSS #3 streetside rear, hinged door with spring-loaded gas cylinder, locking handle installed on the exterior of the door.	1.00
OS3XL1OP1	OSS #3 - (1) ADJUSTABLE SHELF WITH INSIDE/OUTSIDE ACCESS OSS #3 streetside rear, for providing I/O storage access, and contain one (1) adjustable shelf.	1.00
OS3SHELF1	OSS #3 - SHELF ONE (1) ADJUSTABLE WITH TRACK	1.00



	Outside storage compartment #3 shall contain one (1) adjustable shelf with track.	
OS4XL1STD	OSS #4 - CURBSIDE REAR OSS #4 curbside rear, hinged door with spring-loaded gas cylinder, locking handle installed on the exterior of the door.	1.00
OS4XL1OP4	OSS #4 - BACKBOARD AND (2) ADJUSTABLE SHELVES WITH INSIDE/OUTSIDE ACCESS AND FIXED DIVIDER OSS #4 curbside rear, with one (1) fixed vertical divider for backboard/scoop stretcher storage on one side and and two (2) adjustable shelves with inside/outside storage access on other.	1.00
OS4BB	OSS #4 - BACKBOARD - SCOOP STRETCHER STORAGE Compartment #4 shall provide storage for backboards / scoop stretcher, with a (1) inch adjustable strap with black plastic buckle.	1.00
OS4DIV1	OSS #4 - FIXED DIVIDER One (1), fixed divider with sprayed on polyurethane material shall be provided and installed in outside storage compartment #4 per dwg. #4.	1.00
OS4SHELF2	OSS #4 - SHELVES TWO (2) ADJUSTABLE WITH TRACK Two (2) adjustable shelves with track in outside storage compartment #4.	1.00
OS5XL1STD	OSS #5 - CURBSIDE FORWARD OSS #5 curbside forward, hinged door with spring-loaded gas cylinder, locking handle installed on the exterior of the door.	1.00
OS5XL1OP1	OSS #5 - INSIDE/OUTSIDE ACCESS TO THE ALS CABINET - #5B OPEN STORAGE AREA OSS #5 curbside forward, inside/outside access to the ALS cabinet, and #5B lower storage area.	1.00

Braun - Module Interior / Patient Compartment

Item Number	Description	Quantity
50-51-1001	CABINET CONSTRUCTION - INTERIOR - ALUMINUM All interior cabinets shall be constructed of .090" thick welded aluminum.	1.00
50-60-0220	EMBLEMS / SIGNS - REAR PATIENT COMPARTMENT (2) "No Smoking / Oxygen Equipped / Fasten Seat Belts" signs: (1) sign installed in the cab, (1) above the oxygen outlets in the patient compartment street side cabinet.	1.00
50-60-0300	FLOOR CONSTRUCTION- PATIENT COMPARTMENT, NON-WOOD COMPOSITE Sub-floor in the patient compartment: constructed of .125" thick aluminum over .125" and .190" thick reinforcing hat sections and mounting laterals, aluminum sub-floor covered with a 3/4" non-wood composite material, all corner molding, edging and trim anodized aluminum or stainless steel and sealed to prevent fluids from seeping under the cabinets.	1.00
50-60-0301	FLOORING - COVE	1.00



	Patient compartment floor radius: coved with pre-formed floor coving material, installed behind the vinyl floor covering, along both the street side and curbside walls.	
50-60-0391	HEADLINER - REAR PATIENT COMPARTMENT Headliner in the patient compartment shall be one-piece, seamless, .090 thick aluminum finished with sprayed-on multi-use polychromatic coating.	1.00
50-51-1013	HOLD OPENS FOR INTERIOR DOORS All interior cabinets with doors less than 6" tall shall have friction hinges as hold opens for door(s). Doors 6" and taller shall be designed using gas shocks as hold opens for the door(s).	1.00
50-60-0660	PADDED EDGING PROTECTION Install: padded corner edging where necessary on exposed corners and edges in the patient compartment for patient and attendant protection.	1.00
50-00-0202	ROUNDED INTERIOR CORNERS Interior vertical edges: rounded/padded corners in the following locations: forward and aft edges of the CPR seat, the wall at the aft end of the squad bench, the partition opening cabinet edges and the upper front wall cabinet.	1.00
50-51-1011	RECESSED ADJUSTABLE SHELF TRACK - CABINETS Install recessed adjustable shelf track in cabinets.	1.00
50-51-5001	UPHOLSTERY - PATRIOT PLUS CHARCOAL #8605 All cushions, head pads and seating surfaces shall be covered with Patriot Plus Charcoal #8605	1.00
50-60-0661	INTERIOR MODULE PADS Vinyl upholstered, foam cushioned head/back pads shall be installed as follows: the lower edge of the upper front wall cabinet (above the partition doorway or window), above the rear doors, above the side door, and on the street side wall behind and on each side of the CPR seat. The pads shall be covered with a flame-retardant color coordinated vinyl upholstery material.	1.00
50-51-6003	LONPLATE II, NON-SLIP EMBOSSED SM. GRID - GUNMETAL #424 The floor in the patient compartment shall be covered with Lonseal brand "Lonplate II" non-slip; small grid (embossed) Gunmetal #424.	1.00
50-51-2002	CABINET DOORS - CLEAR POLYCARBONATE All cabinet doors shall be clear polycarbonate material / installed in aluminum track lined with PPL inserts / An edge mounted aluminum handle shall be installed on each sliding cabinet door.	1.00
50-51-3001	CABINETS/ WALLS - POLYCHROMATIC COATING - MARBLE STONE Headliner, walls, cabinet faces, and cabinet interiors MultiSpec color to be Marble Stone	1.00
IS-CNT2-ACR	COUNTER TOP, SOLID ACRYLIC - SECONDARY ACTION AREA Install: solid acrylic countertop with 1/2" lip on the secondary action area.	1.00
IS-CNT-ACR	COUNTER TOP, SOLID ACRYLIC Install: solid acrylic countertop with 1/2" lip on the primary action area.	1.00



50-51-4033	COUNTERTOP - SOLID ACRYLIC - RAVEN BOULDER (GRAY/BLACK) Install a solid acrylic counter top, Raven Boulder (#810).	1.00
50-01-0408	LATCHES, CABINET, CN10 COMPLIANT AS APPLICABLE - INCLUDING RADIO CABINET The ACP (attendant control panel) door, the PDQ (power distribution quarters) door, and the radio cabinet door shall be secured with chrome locking lever latches/ all remaining interior hinged cabinet doors with center squeeze latches/all interior drawers with locking flush pull latches.	1.00
50-10-0229	LEFT WALL - ATTENDANT CONTROL PANEL - WITH FLAT AREA A control screen shall be mounted on a hinged access panel and secured with two (2) latches. The panel will be located to the immediate right of the attendant's seat. The forward portion of the panel will contain a flat area that may be used for future radio mounting, etc.	1.00
IS1XL1OP1	CABINET - FIXED FRAME WITH SLIDING POLYCARBONATE DOORS AND (1) ADJ. SHELF EACH SIDE OF CENTER DIVIDER Left wall, upper rear interior cabinet (#1): fixed frame, sliding polycarbonate doors w/full length handles, the outer most sliding door to have handles on both ends, center divider with (1) adjustable shelf each side	1.00
IS2XL1OP1	CABINET - FIXED FRAME WITH SLIDING POLYCARBONATE DOORS AND (1) ADJ. SHELF EACH SIDE OF CENTER DIVIDER Left wall, upper interior cabinet (#2): fixed frame, sliding polycarbonate doors w/full length handles, the outer most sliding door to have handles on both ends, center divider with (1) adjustable shelf, each side.	1.00
IS3XL1OP1	CABINET - HINGED POLYCARBONATE DOORS WITH LATCHES AND FULL LENGTH HANDLES, INSIDE/OUTSIDE ACCESS TO OSS #3 Left wall rear interior cabinet (#3): fixed frame, hinged polycarbonate doors w/ latches and full length handles, inside/outside access to OSS #3.	1.00
IS4XL1OP1	CABINET - SLIDING POLYCARBONATEDOORS WITH (1) ADJUSTABLE SHELF Left wall interior cabinet (#4) below secondary action area: fixed frame, sliding polycarbonate doors w/ full length handles, the outermost sliding door to have handles on both ends (1) adjustable shelf.	1.00
IS5XL1OP1	PULL-OUT DRAWER WITH HINGED ACRYLIC WRITING SURFACE AND LOCKING STAINLESS STEEL FLUSH PULL LATCH. RECESSED SUCTION BELOW DRAWER Left lower wall: (1) drawer (#5) aisle facing, primary action area, under the attendant control panel, hinged acrylic writing surface, locking stainless steel flush pull latch. A recessed SSCOR suction canister shall be located below the drawer. An SSCOR suction system with a 12 VDC electric vacuum pump: recessed into the street side lower interior wall near the attendant seat, pump shall be mounted in the standard OSS #2, pump exhaust shall be vented to the exterior of the vehicle. (must use SSCOR pump and tubing)	1.00
50-60-0018	ASPIRATOR / SUCTION - SSCOR - WITH ELECTRIC PUMP - RECESSED An SSCOR suction system shall be recessed into the street side lower interior wall near the attendant's seat. The 12 VDC SSCOR electric vacuum pump to be installed in an exterior compartment per the location on the drawing (must use SSCOR pump and tubing).	1.00



IC1XL1OP2	INSIDE/OUTSIDE ACCESS TO OSS #4 WITH HINGED POLYCARBONATE DOOR, FULL LENGTH HANDLE, AND LATCH Compartment #1 on the rearward curb side wall, inside/outside access to OSS #4, hinged polycarbonate door, full length handle, latch.	1.00
IC2XL1OP22	SQUAD BENCH WITH RECESSED SHARPS/WASTE BELOW SEPARATE BENCH LID. SECOND PATIENT TRANSPORT ON THE SQUAD BENCH. The Curb side wall shall have a squad bench which will include storage, a split lid with gas cylinder hold opens, and a recessed sharps and trash container.	1.00
IC3XL1OP1	(2) ANGLED LED LIGHTS OVERHEAD WITH OXYGEN OUTLET MOUNTED TO THE WALL (2) LED lights on overhead angled panel on curb side upper wall.	1.00
50-50-0503	SQUAD BENCH TOP - SPLIT WITH HINGED LID FORWARD WITH SHARPS / TRASH ACCESS Squad bench top and cushion shall be split into two (2) sections with separate hinged lids/ forward most section shall have the sharps and trash container installed/ bench covered with color coordinated vinyl upholstery material/automatic latching fastener shall be installed in both sections	1.00
50-50-0541	HOLD OPENS - SQUAD BENCH LID - GAS CYLINDERS Gas cylinder hold-open(s) shall be provided and installed to hold lid in the open and closed position.	1.00
50-60-0709	SHARPS AND TRASH CONTAINERS - ACCESS THRU SQUAD BENCH LID A sharps container and a trash container installed in the forward end of the squad bench base, containers accessed through the squad bench lid covered with a 3/8" thick clear acrylic hinged lid with a biohazard warning label.	1.00
50-60-0718	SQUAD BENCH FACE - VINYL FLOORING MATERIAL The face of the squad bench shall be covered with vinyl flooring material.	1.00
SQ-BN-BASE	SQUAD BENCH BASE W/STORAGE A storage area shall be provided in the squad bench base. The squad bench base shall be constructed of .090" thick aluminum for maximum storage capacity and minimum weight. The interior of the squad bench shall be sprayed with sound absorbing polyurethane material.	1.00
IF3PDQ	CABINET - PDQ The Power Distribution Quarters (PDQ) shall hold electrical components, (i.e., power distribution nodes, circuit breakers, etc.), hinged door with (2) chrome locking lever latches, located on the partition wall behind the attendant seat.	1.00
IF1XL1C2	CABINET - FRONT WALL, UPPER #1 - HINGED ALUMINUM DOOR W/INSERT The front wall interior cabinet #1, flip up hinged aluminum door with polycarbonate insert and gas shock hold-open(s), latch, (1) adjustable shelf.	1.00
IF1XL1OP2	CABINET WITH HINGED ALUMINUM DOOR WITH POLYCARBONATE INSERT AND LATCH WITH (1) ADJUSTABLE SHELF Install cabinet with hinged aluminum door and polycarbonate insert and gas shock hold-open(s) in the upper front wall.	1.00



IF2XL1OP1	CABINET - UPPER/LOWER WITH HINGED POLYCARBONATE DOORS, LATCHES, (1) ADJ. SHELF PER CABINET Front interior wall cabinet #2 fixed frame separated into (2) cabinet sections, upper and lower, each enclosed with (1) set of hinged polycarbonate doors with latches, (1) adjustable shelf per each section and (1) adjustable shelf between the sections for a total of (3) adjustable shelves.	1.00
IF3XL1OP1	CABINET - VENTED RADIO CABINET PDQ ABOVE Power Distribution Quarters (PDQ) compartment and a vented radio compartment below the PDQ, lower front wall, left.	1.00
IF3XL1RAD	CABINET - FRONT WALL, LOWER BELOW PDQ (SINGLE VENTED DOOR) A radio cabinet with a vented, hinged aluminum door, secured by a chrome locking lever latch, located on the front lower left wall, door to open towards rear of the module.	1.00
IF4XL1OP1	PASS-THROUGH WINDOW OPEN TO THE CAB Window opening, pass-through from cab to module.	1.00
50-20-0507	PASS THROUGH - CAB TO MODULE, WINDOW OPENING A window opening: provided in the rear of the cab to accommodate pass-through communications to the patient compartment, bellows provided to connect the cab to the module.	1.00
50-50-0106	SEATING - ATTENDANT - EVS DBC CONTOURED, INTEGRAL CHILD, SWIVEL BASE CN8 COMPLIANT A rear facing EVS DBC attendant seat shall be installed at the head of the patient cot. The seat shall be equipped with a sliding swivel base and PRO4 belting. The seat shall be padded and covered with color coordinated, cushioned vinyl.	1.00
50-50-0122	SEATING - ATTENDANT - SIDE MOUNT POSITION The attendant seat shall be in a side mount position.	1.00
CPROP6	SEATING - CPR - EVS WITH Pro4 HARNESS A CPR seat shall be installed on the street side of the patient compartment aft of the primary action area counter. The CPR seat shall be KKK-A-1822F Change Notice 8 compliant with Pro4 harness style shoulder / seat belt and conform to all applicable FMVSS and SAE J3026 requirements.	1.00
SQSTOP9	SEATING - CN8 COMPLIANT TWO (2) EVS Pro4 A Squad bench seat with two (2) EVS individual seating positions on the curb side of the patient compartment. The squad bench seat shall be KKK-A-1822F Change Notice 8 compliant with (2) Pro4 harness style shoulder / seat belts and conform to all applicable FMVSS and SAE J3026 requirements. The headrest and backrest will be constructed of energy absorbing material. The seat bottom, backrest, and headrest shall be padded and covered with color coordinated, cushioned vinyl material.	1.00
HVC_BAS_01	HVAC - BASIC 12V TIE-IN PACKAGE Install Basic Package HVAC system. THE EVAPORATOR IS TIED-IN TO THE OEM HVAC SYSTEM, HEATING AND COOLING THE AIR OF THE PATIENT COMPARTMENT THROUGH THE VENTS (BASIC SETUP).	1.00
50-61-0001	ASSIST HANDLES, (6) BLACK RUBBER	1.00



	Install: a total of (6) 10-7/8" black vulcanized rubber with steel core assist handles installed: (1) handle on each rear door, (1) on the curbside door, (1) at the curbside doorway and (2) at the rear doorway.	
50-60-0730	DOOR PANELS - MODULE PASSAGE DOORS - FULL LENGTH ALUMINUM - W/ACCESS PANELS Interior rear and curbside passage door panels to be full length aluminum, Multi-Spec sprayed to match interior color and contain removable latch access panel per dwg. # 6 & # 8. (Total 3).	1.00
50-60-0256	EXHAUST VENTILATOR, 3-SPEED - MULTIPLEX ELECTRIC SYSTEM Install: three-speed, 250 CFM (minimum) exhaust fan in the street side cabinet in the patient compartment, fan pulse width modulated from a switch on the attendant control panel control screen, exhaust system to have a louvered grille inside and a chrome vent outside, system vent through the side of the vehicle.	1.00
50-60-0322	GLOVE DISPENSER - (3) BOX - ABOVE ENTRY DOOR - CURBSIDE (ABS) A three (3) - box glove dispenser unit, with a clear acrylic hinged access panel with three (3) cut-outs, shall be provided above the curbside entry door. A 1/4" turn latch will be installed on the face of the glove box access panel.	1.00
50-60-0340	GRAB RAIL, 1-1/4" DIAMETER, (96") OVER COT AREA One (1) 1-1/4" diameter x 96" long stainless steel grab rail shall be installed on the ceiling. The grab rail shall be attached to the ceiling with three (3) mounting brackets that secure it to the super structure of the module.	1.00
50-60-0440	IV HANGERS - CEILING RECESSED - DUAL IV BAG HOLDER Recessed ceiling IV hanger(s) provided and installed per the drawings.	2.00
50-60-0640	OXYGEN SYSTEM, ELECTRIC - MULTIPLEX ELECTRIC SYSTEM A 12 VDC controlled electric O2 system operated through the electrical system shall be provided and installed.	1.00
50-60-1601	OXYGEN OUTLET (1) LEFT WALL - OHIO MED - ACTION AREA One (1) Ohio Medical flush mounted; quick release wall outlet shall be installed in the forward street side cabinet action area. Per dwg #5	1.00
50-60-1640	OXYGEN OUTLET (1) RIGHT WALL - OHIO MED - HEAD END OF SEATING AREA One (1) Ohio Medical flush mounted; quick release wall outlet shall be installed in the right wall above the head end of the curbside seating area. Per dwg #6	1.00
50-60-1680	OXYGEN OUTLET (1) CEILING - OHIO MED - ABOVE HEAD OF COT One (1) Ohio Medical flush mounted; quick release oxygen outlet shall be installed in the ceiling above the head of cot in the center mount position. Per dwg #9	1.00
50-60-0629	FLOW METER, OXYGEN - THORPE STYLE One (1) Thorpe style oxygen flow meter (15LPM) shipped loose with the completed vehicle.	1.00
50-60-0761	STAINLESS STEEL WALL PROTECTION - INTERIOR STREETSIDE A brushed stainless steel panel shall be provided on the street side wall from the bottom of the CPR seat.	1.00
50-60-0820	ANTI-SLIP MATTING - CURBSIDE STEPWELL	1.00



Anti-Slip charcoal gray matting shall be installed in the curbside step well.

Braun - Optional Patient Compartment Items

Item Number	Description	Quantity
50-62-0302	COT FASTENER - STAT-TRAC SINGLE - CENTER POSITION CN8 COMPLIANT Install a 96" Stat-Trac single position center mount -----	1.00

Braun - Paint / Graphics

Item Number	Description	Quantity
60-01-0001	PAINT PROCEDURE All non-anodized aluminum module body surfaces: completely chemically steam cleaned, filled with premium body filler as needed, sanded smooth and primed with an epoxy primer and then primed again with a high solid primer, cured primer surfacer shall be DA sanded with 320 grit and cleaned. A high solid primer shall then be applied, where needed, as a sealer. -----	1.00
60-01-0005	STANDARDS AND SPECIFICATIONS FOR VEHICLE PAINT APPEARANCE -----	1.00
60-10-0108	CAB - OEM PAINT White The cab shall have OEM paint. -----	1.00
60-01-0004	BUFFING, PAINT - MODULE The paint on the module sides shall be buffed to a high shine using a recommended paint buff system. -----	1.00
60-01-0002	PAINT MODULE - OEM PAINT PLUS CLEAR COAT White Paint module OEM to match the chassis. The entire module shall be clear-coated, using an automotive coatings process, sprayed over the final paint coat. -----	1.00
60-30-0200	REFLECTIVE - DOOR REFLECTIVITY Install reflective material (25" x 2.5" red/silver chevron style), on the lower interior panel of each rear door and hinged side door. NOTE: If a sliding side door is provided, install a 1.50" x 40.00" white reflective stripe on the rear facing edge. -----	1.00
60-25-0101	REFLECTIVE - BLACK MATERIAL IN RUB RAILS Install black reflective material in rub rails. -----	1.00

Braun - Vehicle Manuals

Item Number	Description	Quantity
80-20-0001	VEHICLE MANUALS (1) PACKAGE SET One (1) Delivery Manual Package shall be supplied with the vehicle and shall include the following items: Ambulance manufacturer parts, service, and operation manuals, OEM chassis owner's guide, complete 12 VDC and 125 VAC wiring schematics for all included standard and optional systems, Multiplex Electrical system programming - electronic media -----	1.00
90-10-0007	STATEMENT OF LIMITED WARRANTY NEW AMBULANCES	1.00



F5G FORD F550 CHASSIS CAB, 193" WB 4X2 DRW (108" C.A.)

SPECIFICATION FOR GENERAL REFERENCE ONLY

MECHANICAL

- Axle -Mono-beam front axle w/coil spring suspension
- Battery - Batteries Dual 750 CCA
- Brakes – Four-wheel Disc Brakes; Anti-lock Brake System (ABS)
- Emission 50-State Emissions System
- Engine — 6.7L 4V OHV POWER STROKE V8 TURBO DIESEL B20 (*99T*)
- Engine block heater (*41H*)
- Operator Command Regeneration (*98R*)
- Rear-axle “Standard” width 4.10 Limited-slip w/DRW (*X4N*)
- Tires - 225/70Rx19.5G BSW Traction (THB)
- Transmission – TorqShift® Ten-Speed automatic w/Selectable Drive Modes (*44G*)

FUNCTIONAL

- Alternator: 397 amp (*67B*)
- Ambulance Prep Package (*47L*)
- Hood release
- Horn - dual electric
- Intelligent Oil-Life Monitor
- Shock absorbers - heavy -duty gas
- Sirius XM® Radio (Note: Includes a 6-month prepaid subscription. Service is not available in Alaska or Hawaii)
- Spare Tire, Wheel and Jack (Excludes carrier; includes Hydraulic Jack (*512* *61J*))
- Springs, rear auxiliary
- Stabilizer bars – front & rear
- Trailer Brake Controller

- Transmission Power Take-Off Provision (62R)

EXTERIOR

- Bumper – front, chrome
- CAL SER VEH EXP (*936*)
- Color - Oxford White (*Z1*)
- Fender vents – front
- Front License Plate Bracket
- Fuel Tank — 40 gallon aft axle
- Glass – privacy
- Grille – two (2) bar, bright chrome
- Preferred Equipment Package XLT Trim (*663A*)
- Scuff plates – front, color-coordinated
- "Three Blink" Lane change signal
- Tow hooks – front (2)
- Trailer wiring – 7 wire harness w/relays, blunt cut & labeled
- Wheels – 19.5" Forged Polished Aluminum w/bright hub covers (64D)
- Windshield Wipers – intermittent

INTERIOR/COMFORT/CONVENIENCE

- 4.2" LCD Productivity Screen in IP Cluster w/Compass display
- 12V Power point, auxiliary
- Adjustable Gas / Brake Pedal (62M)
- Air conditioning – single-zone, manual
- Air conditioning vents – black w/chrome ring and knob
- Auxiliary audio input jack
- Cabin Air Particulate Filter
- Carpet Delete (*166*)

- Coat hooks, LH/RH color-coordinated
- Dash top tray
- Daytime Running Lamps (DRL) (*942*)
- Dome lamp – LH/RH door activated & I/P switch operated w/delay
- Door locks w/ backlit switches
- Door-trim – soft armrest, grab handle, power window/lock switches and reflector; front map pockets
- Gauges & Meters - Fuel , Transmission temperature, Engine coolant temperature, Oil pressure (gas engine), and Turbo (diesel engine) gauges, Speedometer, Odometer, and Tachometer
- Handles, grab – driver & front-passenger Handles, roof ride – front-passenger (also over rear-doors on Crew Cab)
- Headrests - driver and passenger 4 way adjustable
- Map lights – dual (front and rear w/Crew Cab)
- Mirror – rearview 11.5" day/night
- Outside Temperature Display
- Power Equipment Group – 1ST row (front-seat) windows w/one-touch up/down, power 2ND row (rear-seat) windows (Super/Crew Cab); power/door-locks w/backlit switches & accessory delay
- Seat –Front, high-series cloth 40/20/40 medium earth grey (*3S*) split bench - 20% center under-seat storage, – w/center armrest, cupholder and storage (manual lumbar – driver's side) — Four-way adjustable driver/passenger headrests
- Steering – power
- Steering wheel – Black urethane with tilt and telescoping steering wheel/column; includes three (3) button message control
- Sun visors – color-coordinated cloth, driver w/pocket, both driver and passenger w/covered mirrors
- Upfitter switches – 6 located in Overhead Console
- Power windows w/backlit switches

SAFETY/SECURITY

- AdvanceTrac® with RSC® (Roll Stability Control™)
- AutoLamp – Auto On/Off Headlamps with Rain lamp Wiper activated Headlamps
- Belt-Minder® (front safety belt reminder)
- Driver and passenger frontal and side airbag/curtain; passenger side deactivation switch
- Headlamps – Quad beam jewel effect halogen
- Lamps – Roof marker/clearance – LED
- Mirrors – manually telescoping (*54K*) /folding trailer tow with power/heated glass, heated convex spotter mirror, integrated clearance lamps/turn signals
- MyKey® owner controls feature
- Remote keyless entry and Perimeter anti-theft alarm
- Safety Belts – color-coordinated w/height adjustment (front-outboard seating positions only)
- Safety Canopy® System
- SecuriLock® Passive Anti-Theft System (PATS)
- Stationary Elevated Idle Control (SEIC)
- SOS Post-Crash Alert System™

DRIVER ASSIST

- Automatic High Beam – standard
- Cruise Control (steering wheel mounted)
- SYNC® 3 – Enhanced Voice-Recognition Communications and Entertainment System with 911 Assist® and AppLink®, Apple CarPlay™, and Android Auto™

WEIGHT RATINGS

- FRONT AXLE WEIGHT RATING 7000 lbs
- REAR AXLE WEIGHT RATING 13600 lbs
- GROSS VEHICLE WEIGHT RATING 18000 lbsc