

# ALACHUA COUNTY PUBLIC WORKS

## CONSTRUCTION DRAWINGS FOR COUNTY PROJECT 917-7912

### SW 170th STREET RESURFACING

**CONSTRUCTION REFERENCES:**

FDOT STANDARD PLANS, 2019-2020

FDOT STANDARD SPECIFICATIONS FOR ROAD & BRIDGE CONSTRUCTION JULY 2019

MANUAL ON UNIFORM TRAFFIC CONTROL DEVICES, 2009 AND SUPPLEMENTS THERETO.

**SURVEY NOTES:**

1. THE SURVEY THESE PLANS ARE BASED ON WAS PERFORMED BY DRMP UNDER THEIR PROJECT NUMBER 17-0255.006 AND DATED FEBRUARY 2019. VERTICAL DATUM IS BASED ON NAVD 88.

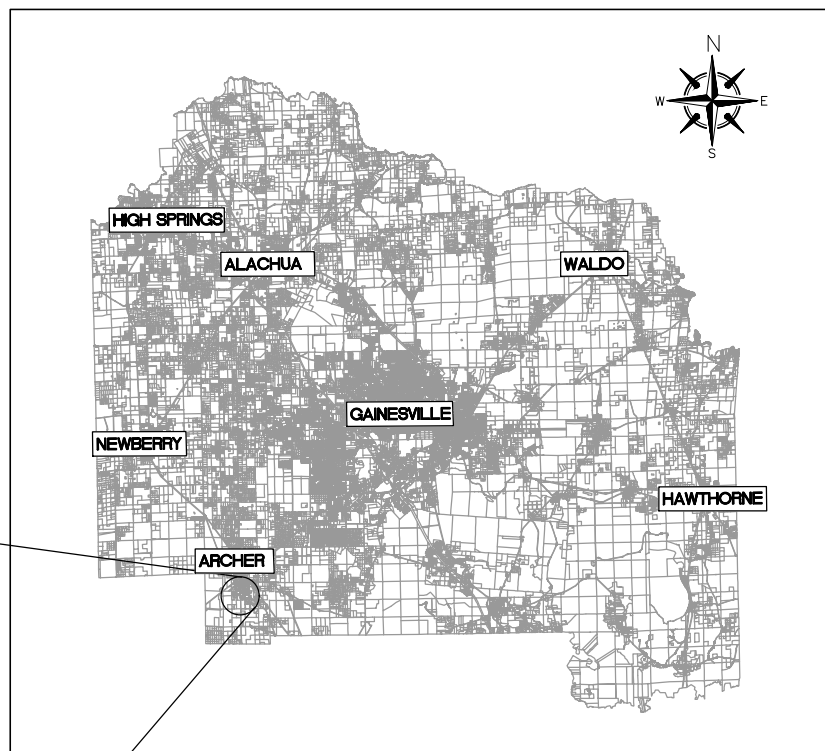
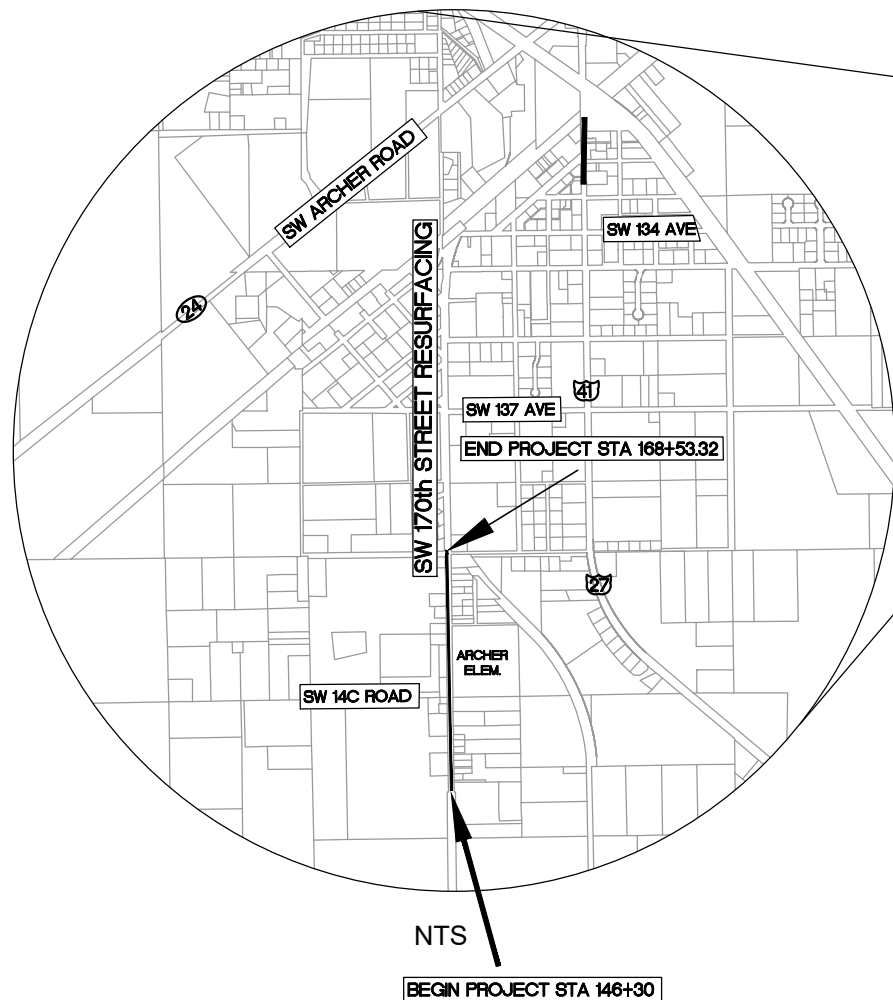

**PROJECT LOCATION MAP**

DRAWING INDEX	
SHEET NUMBER	DRAWING DESCRIPTION
1	COVER SHEET
2	GENERAL NOTES
3	TYPICAL SECTIONS
4	DETAIL SHEET
5-19	PLAN SHEET
20-31	CROSS SECTIONS
32-33	OMITTED SHEETS
34-45	SIGNING AND PAVEMENT MARKING PLAN
1 OF 12	SURVEY, BENCHMARK AND CONTROL SHEETS

UTILITY COMPANIES		
UTILITY & COMPANY	CONTACT PERSON	PHONE NUMBER
CITY OF ARCHER - WATER	PATRICK THOMAS	352-727-2321
TELEPHONE - AT&T	KIRBY SPENCER	386-281-6957
ELECTRIC - CLAY	QUINTON HOWE	352-337-8115
CABLE - COX	RANDY EHLERS	352-337-2009

LENGTH OF PROJECT		
	LINEAR FEET	MILES
ROADWAY	2228.32	0.422
EXCEPTIONS	0	0
NET LENGTH OF PROJECT	2228.32	0.422
GROSS LENGTH OF PROJECT	2228.32	0.422

**PROJECT MANAGER: THOMAS C. STROM, P.E.**

100% PLAN SET -  
MAY 2022  
FOR CONSTRUCTION

REVISIONS	
DATE	REVISION

PROJECT NUMBER  
917-7912

SW 170th STREET  
RESURFACING

COVER SHEET

ALACHUA COUNTY  
PUBLIC WORKS  
ENGINEERING

PHONE: 352-374-5245 - FAX: 352-337-8243  
MAILING ADDRESS: 5620 NW 120TH LANE, GAINESVILLE, FL 32653

DATE: AUGUST 2019  
SCALE: AS SHOWN  
DRAWN BY: M. ROBINSON  
DESIGNED BY: T. STROM  
REVIEWED BY: B. SINGLETON

ENGINEER'S SEAL  
RAMON D. GAVARRETE, P.E.  
FLORIDA REG. NO. 51372  
DATE: 05/03/22 15:28  
VALID ONLY WITH EMBOSSED SEAL

GENERAL CONSTRUCTION NOTES:

1. ALL RECYCLABLE/REUSABLE MATERIAL, INCLUDING ASPHALT MILLINGS, SHALL REMAIN THE PROPERTY OF ALACHUA COUNTY UNLESS OTHERWISE SPECIFIED BY THE COUNTY ENGINEER. CONTRACTOR SHALL COORDINATE WITH THE COUNTY ROAD AND BRIDGE DIVISION FOR THE REMOVAL OF THE RECYCLABLE/REUSABLE MATERIAL FROM THE CONSTRUCTION SITE. ALL MILL MATERIALS SHALL BE DELIVERED TO THE ALACHUA COUNTY PUBLIC WORKS COMPOUND LOCATED AT 5620 NW 120TH LANE, GAINESVILLE, FL.
2. CONTRACTOR IS RESPONSIBLE TO VERIFY EXISTING SITE CONDITIONS PRIOR TO CONSTRUCTION. IF A DISCREPANCY SHOULD ARISE, THE CONTRACTOR SHALL IMMEDIATELY NOTIFY THE PROJECT ENGINEER IN WRITING FOR PROPOSED RESOLUTION OR CLARIFICATION.
3. IF A SINKHOLE SHOULD FORM ON THE SITE, THE PROCEDURES OUTLINED BY THE GOVERNING WATER MANAGEMENT DISTRICT SHALL BE FOLLOWED. BOTH THE PROJECT ENGINEER AND THE WATER MANAGEMENT DISTRICT SHALL BE NOTIFIED.
4. THE CONTRACTOR IS RESPONSIBLE FOR THE SAFE MAINTENANCE OF VEHICULAR AND PEDESTRIAN TRAFFIC PER THE MOST RECENT FDOT INDEX FOR THE DURATION OF THE PROJECT 24 HRS/7 DAYS WEEK.
5. JOB SAFETY SHALL BE IMPLEMENTED AT ALL TIMES. IT IS THE CONTRACTOR'S RESPONSIBILITY TO BE FAMILIAR WITH OSHA STANDARDS AND TO ABIDE BY THEM AS WELL AS ANY OTHER LOCAL, STATE, AND FEDERAL REGULATIONS.
6. DAMAGE TO UTILITIES, STRUCTURES OR PROPERTY ON OR ADJACENT TO THE PROJECT SITE CAUSED BY CONSTRUCTION ACTIVITIES SHALL BE THE RESPONSIBILITY OF THE CONTRACTOR.
7. THE CONTRACTOR SHALL NOTIFY THE ALACHUA COUNTY PUBLIC WORKS DEPARTMENT A MINIMUM OF 48 HOURS PRIOR TO THE COMMENCEMENT OF ANY CONSTRUCTION.
8. THESE PLANS REFLECT CONDITIONS KNOWN DURING PLAN DEVELOPMENT. IN THE EVENT THAT ACTUAL CONDITIONS PREVENT THE APPLICATION OF THESE PLANS AND SPECIFICATIONS IN THE CONSTRUCTION OF THE WORK, THE CONTRACTOR SHALL PROMPTLY NOTIFY THE ENGINEER IN CHARGE PRIOR TO FURTHER CONSTRUCTION ACTIVITY.
9. THE CONTRACTOR AND SUBCONTRACTORS ARE HEREBY REQUIRED TO PROMPTLY NOTIFY THE PROJECT ENGINEER OF ANY DISCREPANCIES OR CONFLICTS FOUND IN THE PLANS OR SPECIFICATIONS, SO THEY ARE CLARIFIED BY THE ENGINEER.
10. NO CHANGES TO THE WORK AS SHOWN ON THESE PLANS SHALL BE MADE WITHOUT PRIOR WRITTEN APPROVAL OF THE PROJECT ENGINEER. CONTRACTOR SHALL CHECK ACTUAL SITE CONDITIONS PRIOR TO CONSTRUCTION. ANY NEED FOR CLARIFICATION OF PROPOSED IMPROVEMENTS OR FOR RESOLUTION OF DISCREPANCIES SHALL BE IMMEDIATELY BROUGHT TO THE ATTENTION OF THE PROJECT ENGINEER.
11. THE PROJECT ENGINEER SHALL HAVE ACCESS TO THE WORK SITE AT ALL TIMES.
12. ALL ASTM DESIGNATIONS SHALL BE AS AMENDED TO DATE UNLESS NOTED OTHERWISE.
13. ADDITIONAL TEST BORINGS AND EXPLORATORY INVESTIGATIONS MAY BE MADE BY THE CONTRACTOR AT THE CONTRACTORS'S EXPENSE.
14. ALL EXISTING STORMWATER DRAINAGE PATTERNS AND CHANNELS OUTSIDE THE CONSTRUCTION AREAS SHOWN ON THESE PLANS ARE TO BE MAINTAINED. THE CONTRACTOR SHALL NOTIFY THE ENGINEER IF THE WORK APPEARS TO INTERRUPT AN EXISTING STORMWATER DRAINAGE PATTERN. THE CONTRACTOR SHALL MAINTAIN A CLEAR PATH FOR ALL SURFACE WATER DRAINAGE STRUCTURES AND DITCHES DURING ALL PHASES OF CONSTRUCTION SUCH THAT IMPACT TO CONSTRUCTION AND/OR SURROUNDING FACILITIES IS MINIMIZED. THE CONTRACTOR SHALL BE RESPONSIBLE FOR ANY EROSION, SEDIMENT TRANSPORT, DISTURBED FOUNDATIONS, IMPACT TO STRUCTURES AND ANY OTHER DAMAGE CAUSED DURING CONSTRUCTION.
15. UNSUITABLE MATERIAL FROM WITHIN THE PROJECT SHALL BE PROPERLY DISPOSED OF OFF SITE BY THE CONTRACTOR. SUITABLE MATERIAL FROM WITHIN THE PROJECT SHALL BE USED FOR FILL AS NEEDED TO COMPLETE THE PROJECT.
16. BURNING WITHIN THE LIMITS OF THE PROPOSED PROJECT SHALL NOT BE ALLOWED UNLESS OTHERWISE SPECIFIED BY THE PROJECT ENGINEER. THE CONTRACTOR IS RESPONSIBLE FOR CONTACTING THE APPROPRIATE AGENCY AND OBTAINING A BURNING PERMIT.
17. ANY SURVEY MARKER, INCLUDING BUT NOT LIMITED TO SECTION MARKERS, BENCH MARKS, LOT CORNERS, ETC. WHICH ARE DISTURBED DURING CONSTRUCTION SHALL BE REPLACED AT THE CONTRACTOR'S EXPENSE PRIOR TO FINAL PAYMENT. RESETTING OF MONUMENTS AND MARKERS SHALL BE PERFORMED BY A PROFESSIONAL LAND SURVEYOR LICENSED TO PRACTICE IN THE STATE OF FLORIDA.
18. UPON COMPLETION OF STRUCTURAL COURSE, LANES SHALL BE PAINTED AND RPMS PLACED. UPON COMPLETION OF FRICTION COURSE, LANES SHALL BE PAINTED AND RPMS PLACED. 30 DAYS AFTER COMPLETION OF FRICTION COURSE PLACE LEAD-FREE THERMOPLASTIC. ALL RPM'S SHALL BE PLACED IN ACCORDANCE WITH FDOT DESIGN STANDARDS (INDEX 706-001).
19. ALL EXISTING CULVERTS ARE TO REMAIN UNLESS SPECIFIED OTHERWISE.

UTILITY NOTES

1. UTILITIES SHOWN HEREON ARE BASED ON A SURVEY DATED FEBRUARY 2019 BY DRMP (PROJ. NUMBER 17-0255.006). THE CONTRACTOR SHALL BE RESPONSIBLE FOR VERIFYING THE LOCATION OF ALL EXISTING UTILITIES SHOWN OR NOT SHOWN THROUGH DIRECT CONTACT WITH THE APPROPRIATE UTILITY COMPANY IN ACCORDANCE WITH THE ALACHUA COUNTY LAND DEVELOPMENT CODE PRIOR TO OR IN CONJUNCTION WITH THE PROJECT. ALACHUA COUNTY SHALL NOT BE HELD RESPONSIBLE FOR ANY DAMAGES OR DELAYS CAUSED BY THE LOCATION OR DISPOSITION OF ANY UTILITIES.
2. ALL ABOVE GROUND UTILITY STRUCTURES SHALL BE RELOCATED AS REQUIRED PER CLEAR ZONE REQUIREMENTS, UNLESS OTHERWISE APPROVED BY THE PROJECT ENGINEER.
3. ALL UNDERGROUND UTILITIES CONFLICTING WITH CONSTRUCTION SHALL BE RELOCATED, UNLESS OTHERWISE APPROVED BY THE PROJECT ENGINEER.
4. CONTRACTOR SHALL HAND EXCAVATE WHEN CONSTRUCTION ACTIVITIES ARE WITHIN 18 INCHES OF EXISTING UTILITIES.
5. CONTRACTOR SHALL BE RESPONSIBLE FOR VERIFYING THE LOCATION OF ALL UTILITIES SHOWN OR NOT SHOWN ON THE PLANS AND SHALL MAINTAIN DIRECT CONTACT WITH THE APPROPRIATE UTILITY COMPANIES THROUGHOUT CONSTRUCTION.
6. THE CONTRACTOR SHALL BE RESPONSIBLE FOR DAMAGE TO UTILITIES, STRUCTURES AND PROPERTY ON AND ADJACENT TO THE SITE CAUSED BY CONSTRUCTION ACTIVITIES.

EROSION CONTROL NOTES:

1. ALL EROSION AND SEDIMENT CONTROL DEVICES NECESSARY FOR CONSTRUCTION SHALL CONFORM TO THE FLORIDA DEPARTMENT OF TRANSPORTATION (FDOT) STANDARD PLANS AND FLORIDA BEST MANAGEMENT PRACTICES.
2. THE CONTRACTOR SHALL PREVENT THE DISCHARGE OF SEDIMENT INTO DRAINAGE DITCHES DUE TO CONSTRUCTION OPERATIONS. APPROVED EROSION CONTROL DEVICES SHALL BE INSTALLED TO PREVENT DISCHARGE OF SEDIMENT INTO A DRY OR WET WATERCOURSE. EROSION CONTROL SHALL CONSIST OF SILT FENCE, OR OTHER EROSION CONTROL METHODS APPROVED BY THE PROJECT ENGINEER. ALL NEW AND EXISTING DRAIN PIPES AND STRUCTURES SHALL BE DESILTED PRIOR TO FINAL PAYMENT.
3. CONTRACTOR SHALL CLEAR AND GRUB CONSTRUCTION AREAS BEFORE FILL IS PLACED. ALL AREAS TO RECEIVE FILL SHALL BE STRIPPED OF ALL VEGETATION AND TOPSOIL AND PROOF ROLLED PRIOR TO PLACING CLEAN FILL.
4. ALL SLOPES STEEPER THAN 3:1 SHALL HAVE PINNED OR PEGGED BAHIA SOD. PROVIDE EROSION CONTROL BLANKET FOR ALL SLOPES 2:1 HORIZONTAL TO VERTICAL OR STEEPER.
5. ALL AREAS INSIDE AND OUTSIDE THE PROJECT LIMITS, WHICH ARE DISTURBED AS A RESULT OF THE PROJECT CONSTRUCTION, SHALL BE RESTORED TO ORIGINAL OR DESIGN GRADE AS APPLICABLE, AND SODDED WITH ARGENTINE BAHIA AT THE CONTRACTOR'S EXPENSE, UNLESS OTHERWISE APPROVED BY THE PROJECT ENGINEER. ALL DISTURBED AREAS WITHIN THE COUNTY RIGHT OF WAY SHALL BE REGRADED AND SODDED WITH ARGENTINE BAHIA SOD.
6. THE CONTRACTOR IS RESPONSIBLE FOR REMOVING THE TEMPORARY EROSION AND SEDIMENT CONTROL DEVICES AFTER COMPLETION OF CONSTRUCTION AND ONLY WHEN AREAS HAVE BEEN STABILIZED.
7. ADDITIONAL PROTECTION: ON-SITE PROTECTION IN ADDITION TO THE ABOVE MUST BE PROVIDED THAT WILL NOT PERMIT SILT TO LEAVE THE PROJECT CONFINES DUE TO UNSEEN CONDITIONS OR ACCIDENTS.
8. CONTRACTOR SHALL INSPECT EROSION CONTROL MEASURES DAILY. NECESSARY REPAIRS TO BARRIERS OR REPLACEMENT OF BALES SHALL BE ACCOMPLISHED PROMPTLY.
9. SEDIMENT DEPOSITS SHALL BE REMOVED AFTER EACH RAINFALL. DEPOSITS SHALL BE REMOVED WHEN THE LEVEL OF DEPOSITIONS REACHES APPROXIMATELY ONE-HALF THE HEIGHT OF THE BARRIER
10. SEDIMENT DEPOSITS REMAINING IN PLACE AFTER THE BARRIER IS NO LONGER REQUIRED, SHALL BE DRESSED TO CONFORM TO THE EXISTING GRADE, PREPARED AND SODDED.
11. SILT FENCES AND FILTER BARRIERS SHALL BE INSPECTED IMMEDIATELY AFTER EACH RAINFALL AND AT LEAST DAILY DURING PROLONGED RAINFALL. ANY REQUIRED REPAIRS SHALL BE MADE IMMEDIATELY.
12. SHOULD THE FABRIC ON A SILT FENCE OR FILTER BARRIER DECOMPOSE OR BECOME INEFFECTIVE PRIOR TO THE END OF EXPECTED USABLE LIFE AND THE BARRIERS ARE STILL NECESSARY THE FABRIC SHALL BE REPLACED IMMEDIATELY.
13. THIS PLAN INDICATES THE MINIMUM EROSION AND SEDIMENT MEASURES REQUIRED FOR THIS PROJECT. THE CONTRACTOR IS RESPONSIBLE FOR MEETING ALL APPLICABLE RULES, REGULATIONS AND WATER QUALITY GUIDELINES AND MAY NEED TO INSTALL ADDITIONAL CONTROLS.
14. THE CONTRACTOR SHALL SUBMIT A DETAILED STORMWATER POLLUTION PREVENTION PLAN TO THE COUNTY FOR APPROVAL.
15. THE CONTRACTOR IS RESPONSIBLE FOR SUBMITTING THE NOTICE OF INTENT (NOI) TO THE FLORIDA DEPARTMENT OF ENVIRONMENTAL PROTECTION.
16. DISCHARGE OF SEDIMENT TO DRAINAGE DITCHES AND/OR OFF SITE PROPERTY IS PROHIBITED. THE CONTRACTOR SHALL BE RESPONSIBLE FOR IMPLEMENTING AND MAINTAINING EROSION CONTROL AS OUTLINED IN THE EROSION CONTROL PLAN.

	PROJECT NUMBER 917-7912	2
<b>SW 170th STREET RESURFACING</b>	GENERAL NOTES	
<b>ALACHUA COUNTY PUBLIC WORKS ENGINEERING</b>	PHONE: 352-374-5245 - FAX: 352-337-6243 MAILING ADDRESS: 5620 NW 120TH LANE, GAINESVILLE, FL 32653	
DATE:	AUGUST 2019	
SCALE:	AS SHOWN	
DRAWN BY:	M. ROBINSON	
DESIGNED BY:	T. STROM	
REVIEWED BY:	B. SINGLETON	
ENGINEER'S SEAL RAMON D. GAVARRETE, P.E. FLORIDA REG. NO. 51372 M.A.B. 817-9818 SW 170 ST CORNER 06/03/28 1328	VALID ONLY WITH EMBOSSED SEAL	

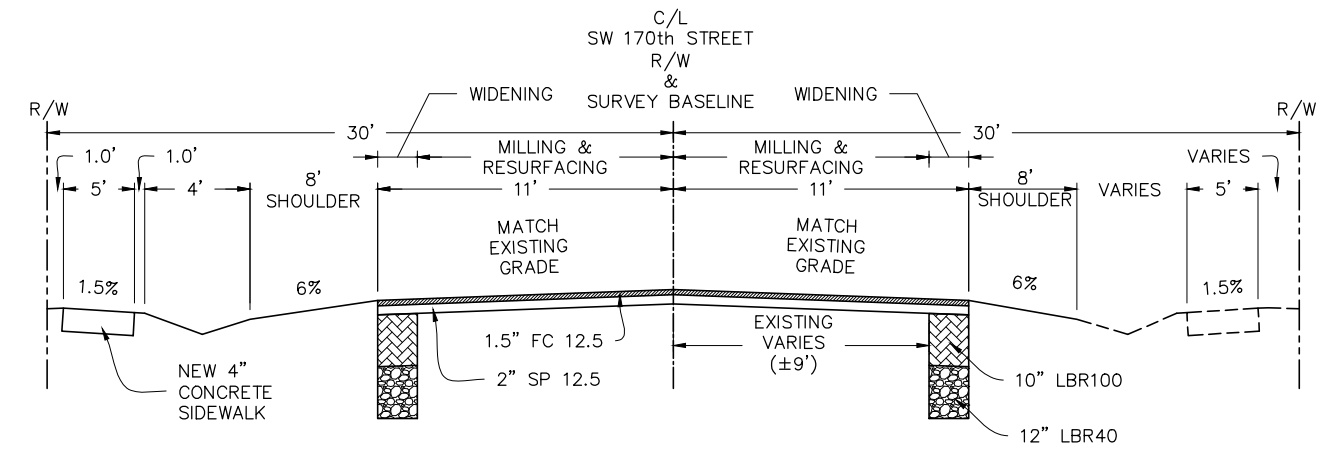

**TYPICAL SECTION #1**  
NOT TO SCALE

STA: 146+30 TO STA: 168+14.69

**TRAFFIC DATA**

CURRENT YEAR = 2019 AADT=1700  
DESIGN YEAR = 2020  
T = 3.5 %  
DESIGN SPEED = 45 MPH  
POSTED SPEED = 45 MPH

**MILLING**  
2" MILL EXISTING ASPHALT PAVEMENT

**RESURFACING**  
(FRIC.) = 1.5" FC 12.5 PG76-22  
(STRUC.) = 2" SP 12.5 PG76-22,  
(TRAFFIC B)

**WIDENING**  
(FRIC.) = 1.5" FC 12.5 PG76-22  
(STRUC.) = 2" SP 12.5 PG76-22 (TRAFFIC B)  
LIME ROCK (LBR100) = 10"  
TYPE B STABILIZATION (LBR40) = 12"

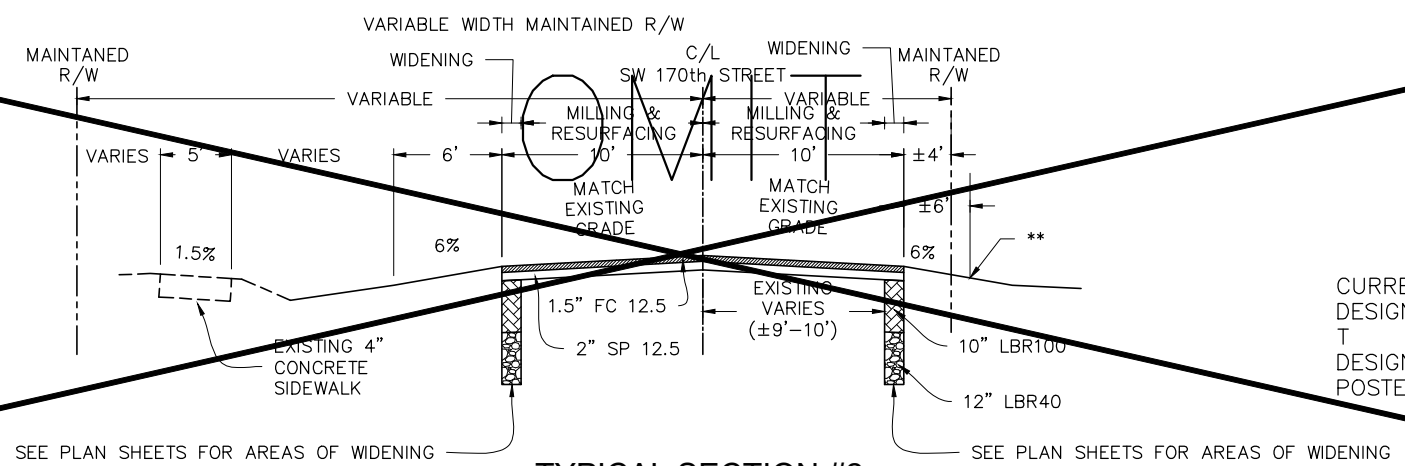

**TYPICAL SECTION #2**  
NOT TO SCALE

STA: 168+14.69 TO STA: 198+32.10

**TRAFFIC DATA**

CURRENT YEAR = 2019 AADT=1700  
DESIGN YEAR = 2020  
T = 3.5 %  
DESIGN SPEED = 30 MPH  
POSTED SPEED = 30 MPH

**MILLING**  
2" MILL EXISTING ASPHALT PAVEMENT

**RESURFACING**  
(FRIC.) = 1.5" FC 12.5 PG76-22  
(STRUC.) = 2" SP 12.5 PG76-22,  
(TRAFFIC B)

**WIDENING**  
(FRIC.) = 1.5" FC 12.5 PG76-22  
(STRUC.) = 2" SP 12.5 PG76-22 (TRAFFIC B)  
LIME ROCK (LBR100) = 10"  
TYPE B STABILIZATION (LBR40) = 12"

\*\* - WORK OUTSIDE OF THE MAINTAINED RIGHT OF WAY MAY BE REQUIRED TO COMPLETE THE TO GRADE. SEE PLAN SHEETS FOR THESE AREAS.

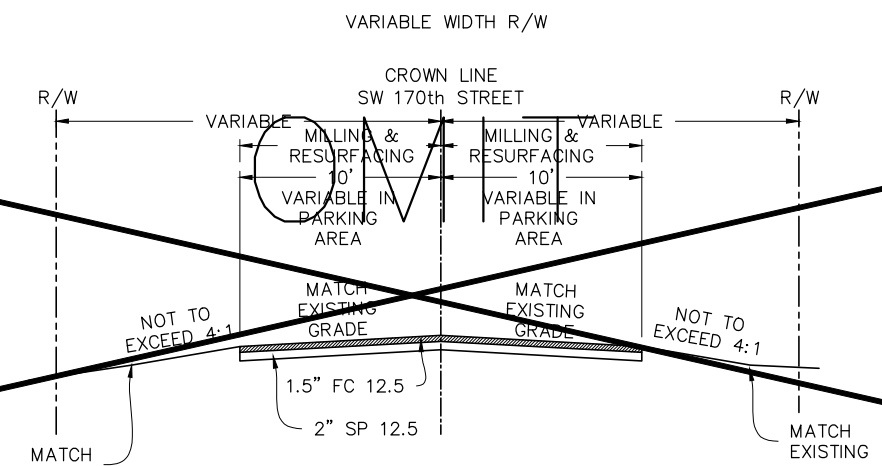

**TYPICAL SECTION #3**  
NOT TO SCALE

STA: 198+32.10 TO STA: 209+71.72

**TRAFFIC DATA**

CURRENT YEAR = 2019 AADT=1700  
DESIGN YEAR = 2020  
T = 3.5 %  
DESIGN SPEED = 30 MPH  
POSTED SPEED = 30 MPH

**MILLING**  
2" MILL EXISTING ASPHALT PAVEMENT

**RESURFACING**  
(FRIC.) = 1.5" FC 12.5 PG76-22  
(STRUC.) = 2" SP 12.5 PG76-22,  
(TRAFFIC B)

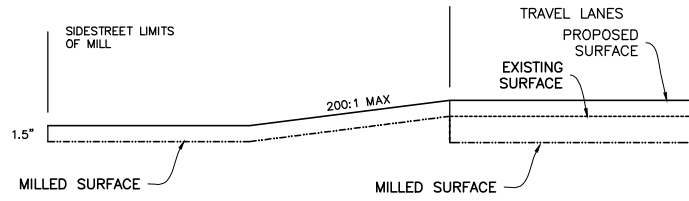

MILLING SIDESTREETS  
1.5" VARY - SEE DETAIL

RESURFACING SIDESTREETS  
1.5" TYPE FC 12.5 FRICTION COURSE  
(TRAFFIC LEVEL B)

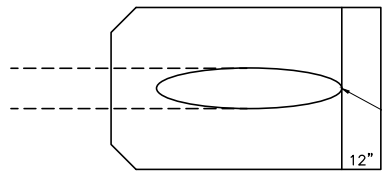

PIPE REFERENCE DETAIL  
FOR SIDE DRAIN MITERS  
N.T.S.

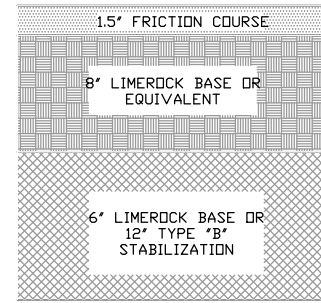

SIDE STREET PAVEMENT DETAIL  
NOT TO SCALE

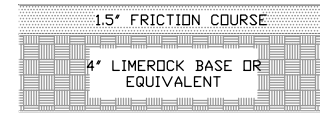

DRIVEWAY PAVEMENT DETAIL  
NOT TO SCALE

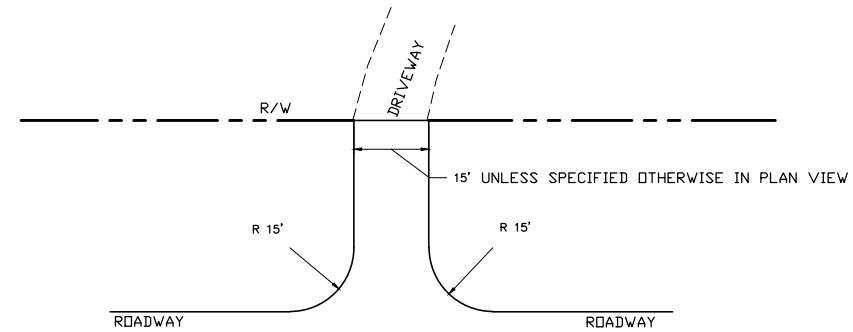

DRIVEWAY CONNECTION DETAIL  
NOT TO SCALE

- NOTES:
- 1) UNLESS OTHERWISE SPECIFIED IN PLAN SHEETS, DRIVEWAY CONNECTION RADIUS SHALL BE 15' RADIUS.
  - 2) SEE PAVEMENT DESIGN DETAILS ABOVE
  - 3) PROFILE PER FDOT INDEX 330-001

ENGINEER'S SEAL  
RAMON D. GAVARRETE, P.E.  
FLORIDA REG. NO. 51372  
M.A.B. 817-9813 SW 170 ST CORNER  
06/03/23 13:28

DATE: AUGUST 2019  
SCALE: AS SHOWN  
DRAWN BY: M. ROBINSON  
DESIGNED BY: T. STROM  
REVIEWED BY: B. SINGLETON

ALACHUA COUNTY  
PUBLIC WORKS  
ENGINEERING  
PHONE: 352-374-5245 - FAX: 352-337-4243  
MAILING ADDRESS: 5620 NW 120TH LANE, GAINESVILLE, FL 32653

SW 170th STREET  
RESURFACING

DETAIL SHEET

PROJECT NUMBER  
917-7912

4

VALID ONLY WITH EMPRESSED SEAL

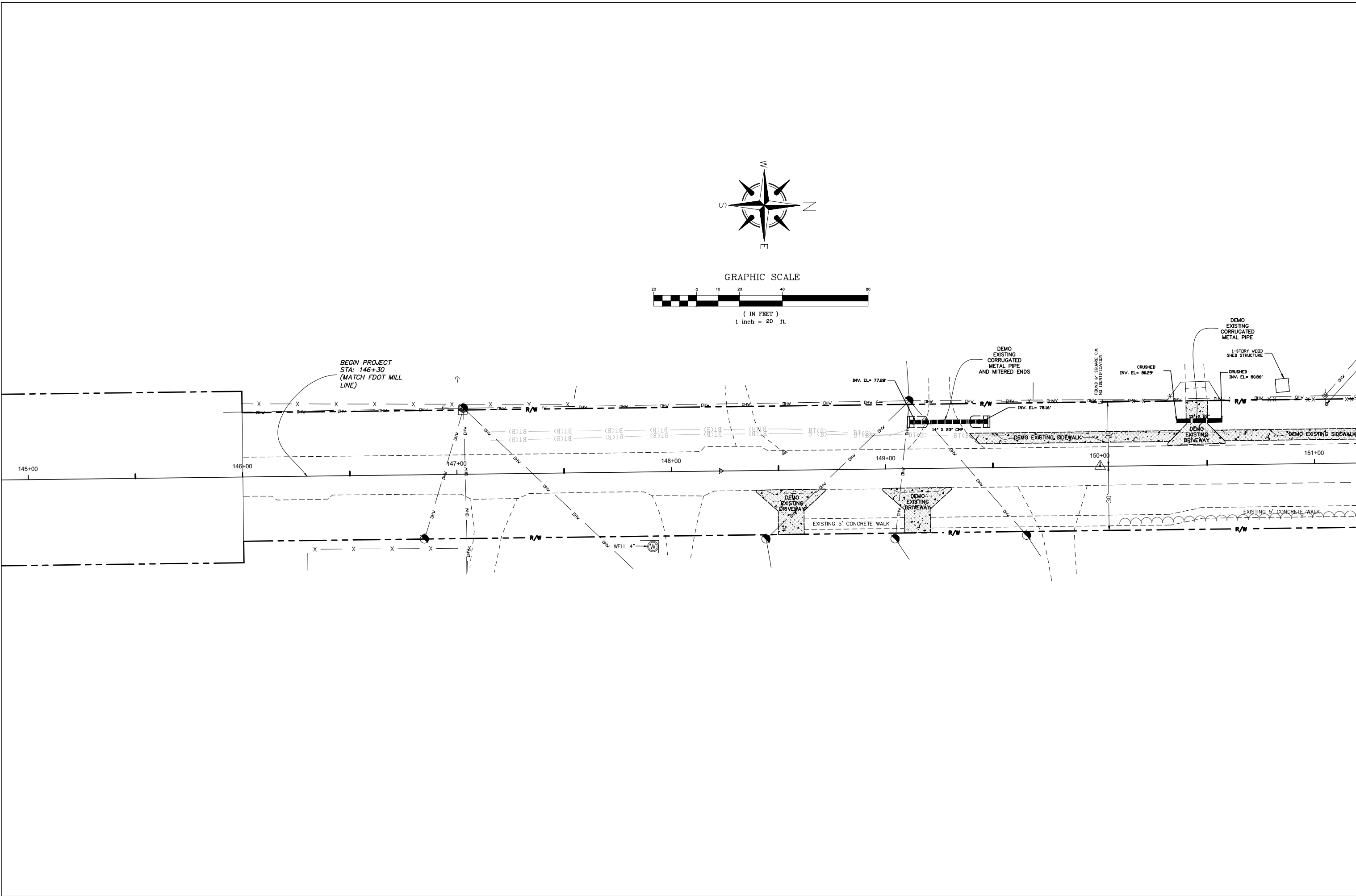

<b>ENGINEER'S SEAL</b> RAMON D. GAVARRETE, P.E. FLORIDA REG. NO. 51372 M.A.R. 917-7912 SW. 170 ST. BLDG 2 06/01/20 1339	DATE: AUGUST 2019 SCALE: AS SHOWN DRAWN BY: M. ROBINSON DESIGNED BY: T. STROM REVIEWED BY: J.A. FLEGERT	<b>ALACHUA COUNTY</b> <b>PUBLIC WORKS</b> <b>ENGINEERING</b> PHONE: 352-374-5245 - FAX: 352-337-8243 MAILING ADDRESS: 5620 NW 120TH LANE, GAINESVILLE, FL 32653	<b>SW 170th STREET</b> DEMOLITION PLAN SHEET	PROJECT 917-7912
	VALID ONLY WITH EMBOSSED SEAL			5

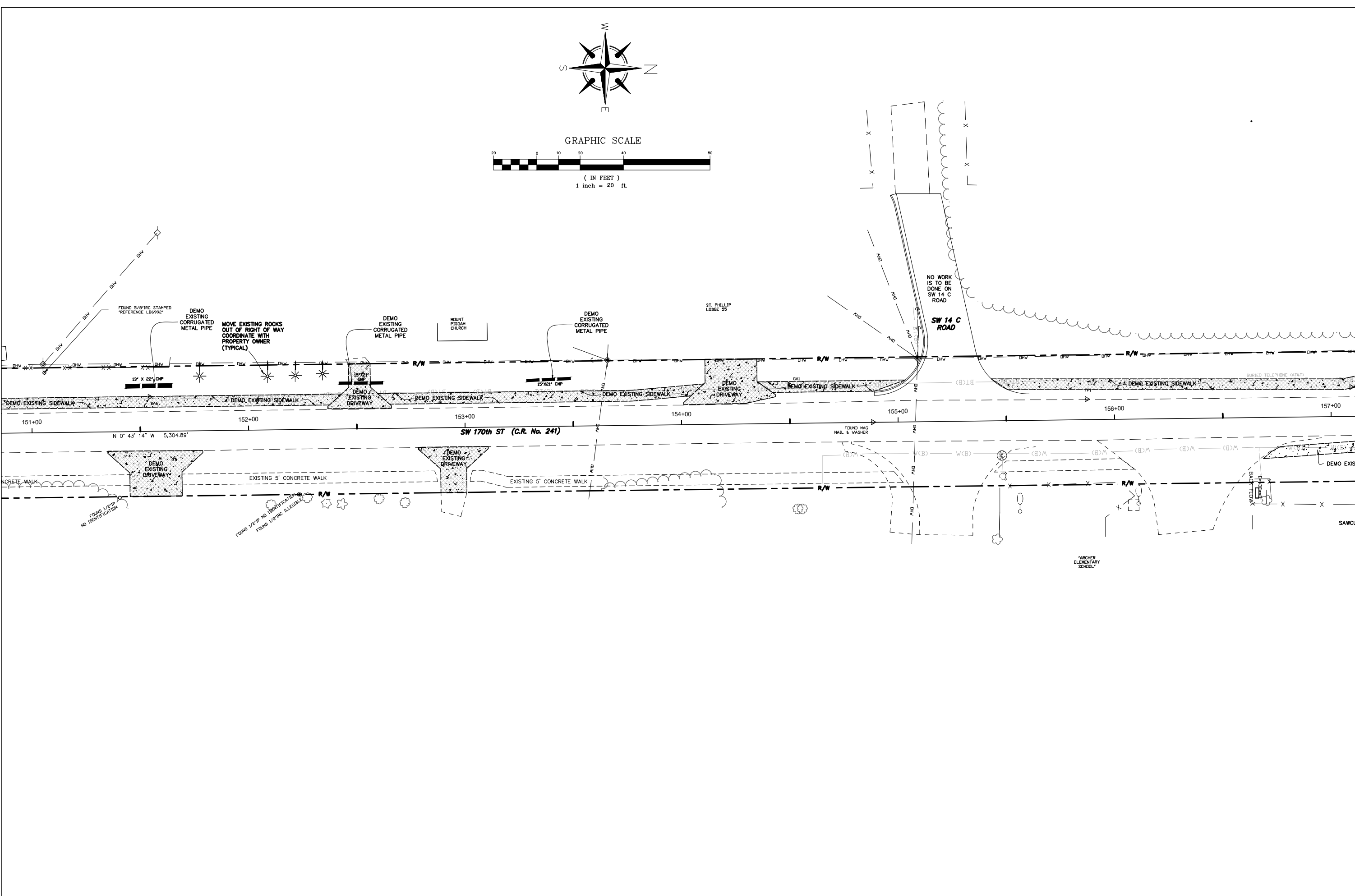
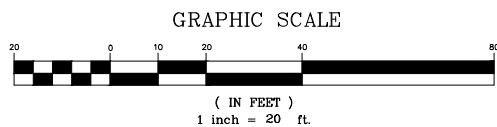
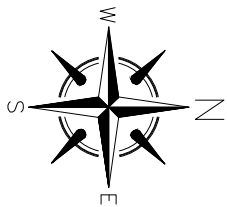

PROJECT  
917-7912

SW 170th STREET  
DEMOLITION PLAN SHEET

ALACHUA COUNTY  
PUBLIC WORKS  
ENGINEERING  
PHONE: 352-374-5245 - FAX: 352-337-8243  
MAILING ADDRESS: 5620 NW 120TH LANE, GAINESVILLE, FL 32653

DATE:	AUGUST 2019
SCALE:	AS SHOWN
DRAWN BY:	M. ROBINSON
DESIGNED BY:	T. STROM
REVIEWED BY:	J.A. FLEGERT

ENGINEER'S SEAL  
RAMON D. GAVARRETE, P.E.  
FLORIDA REG. NO. 51372  
DATE: 06/05/20 1330  
VALID ONLY WITH EMBOSSED SEAL

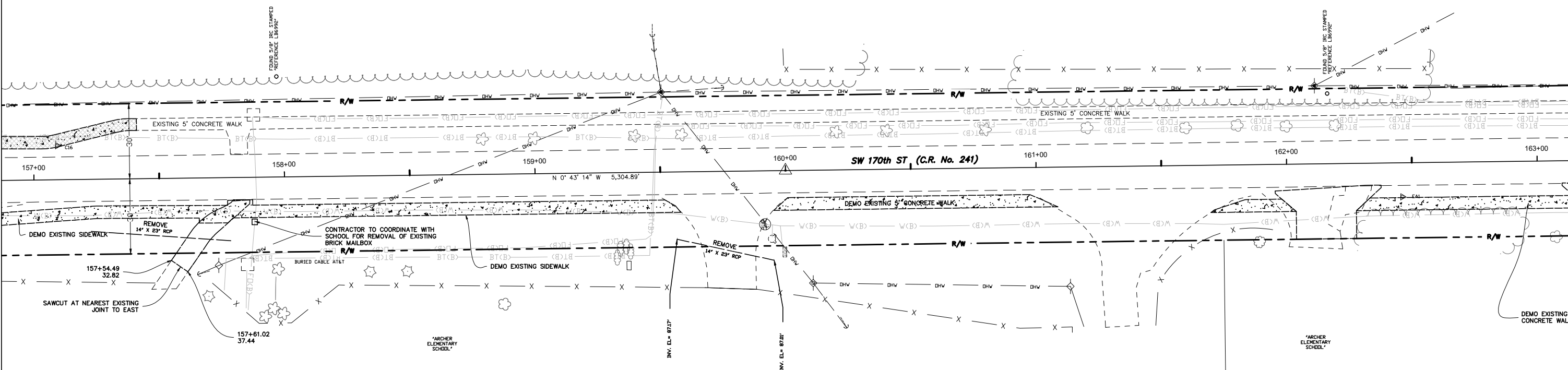
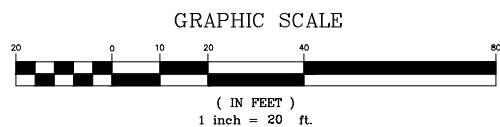
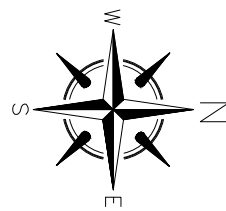

PROJECT 917-7912	
SW 170th STREET	
DEMOLITION PLAN SHEET	
ALACHUA COUNTY PUBLIC WORKS ENGINEERING PHONE: 352-374-5245 - FAX: 352-337-8243 MAILING ADDRESS: 5620 NW 120TH LANE, GAINESVILLE, FL 32653	
DATE:	AUGUST 2019
SCALE:	AS SHOWN
DRAWN BY:	M. ROBINSON
DESIGNED BY:	T. STROM
REVIEWED BY:	J.A. FLEGERT
ENGINEER'S SEAL RAMON D. GAVARRETE, P.E. FLORIDA REG. NO. 51372 M.A.R. 917-7912 SW 170 ST BLDG 2 06/01/20 1336	VALID ONLY WITH EMBOSSED SEAL

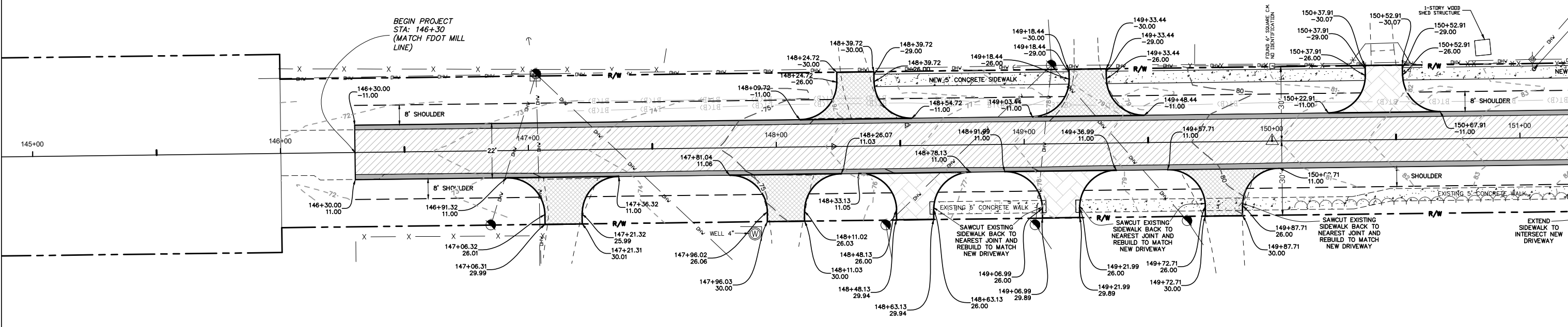
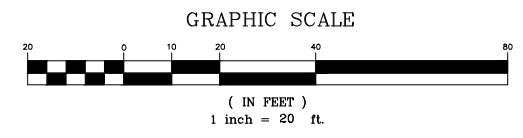
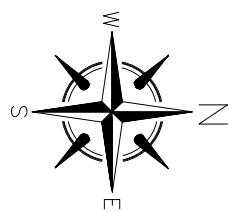

NOTE:  
 CONTRACTOR TO ADJUST UTILITY COVERS  
 TO MATCH FINAL GRADES.

NOTE:  
 PROPOSED CONTOURS SHOWN  
 ON ALL PLAN SHEETS

**HATCH LEGEND:**

	LANE MILL AND RESURFACE
	AREA OF WIDENING
	NEW ASPHALT DRIVEWAY
	NEW CONCRETE SIDEWALK
	RECONSTRUCT DRIVEWAY FROM CONCRETE TO ASPHALT: ENSURE SLOPES MATCH SIDEWALK AND ROADWAY



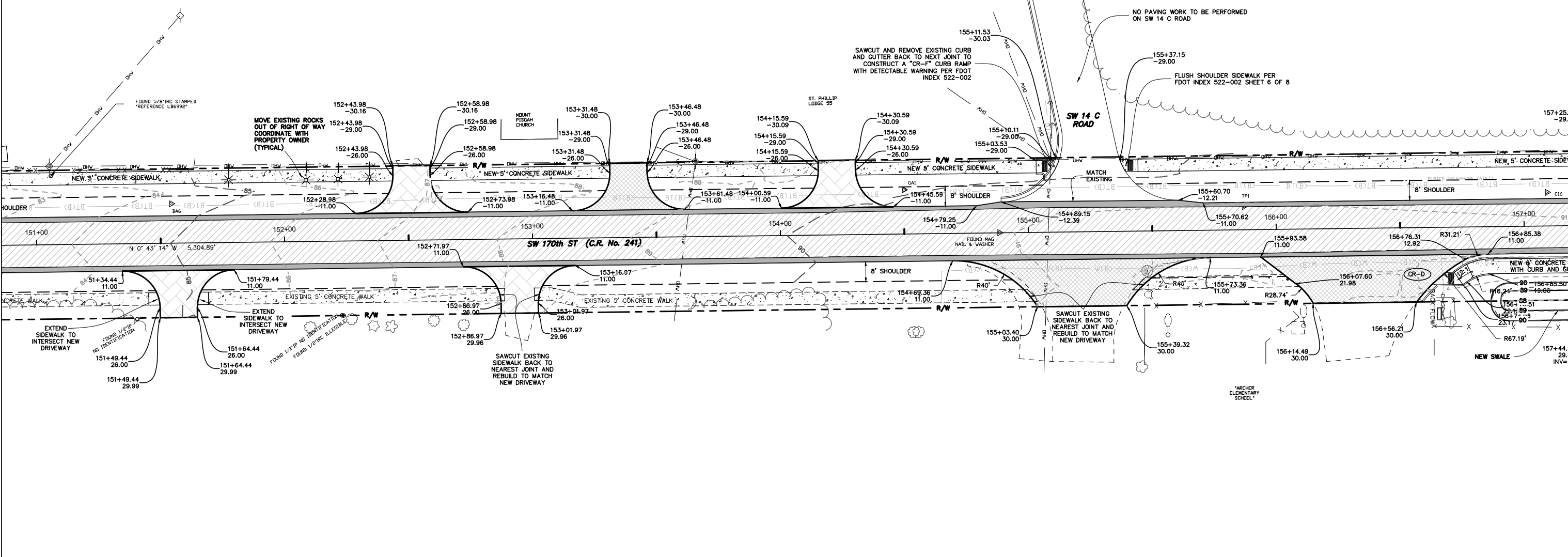
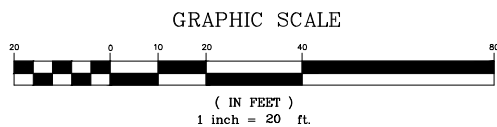
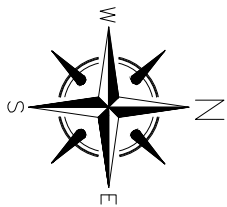

NOTE:  
CONTRACTOR TO ADJUST UTILITY COVERS  
TO MATCH FINAL GRADES.

HATCH LEGEND:	
	LANE MILL AND RESURFACE
	AREA OF WIDENING
	NEW DRIVEWAY
	NEW CONCRETE SIDEWALK
	RECONSTRUCT DRIVEWAY FROM CONCRETE TO ASPHALT. ENSURE SLOPES MATCH SIDEWALK AND ROADWAY

PROJECT 917-7912	SW 170th STREET PLAN SHEET	ALACHUA COUNTY PUBLIC WORKS ENGINEERING PHONE: 352-374-5245 - FAX: 352-337-8243 MAILING ADDRESS: 5620 NW 120TH LANE, GAINESVILLE, FL 32653
ENGINEER'S SEAL RAMON D. GAVARRETE, P.E. FLORIDA REG. NO. 51372 M.A.R. 917-7912 SW 170 ST BLVD 06/07/25 1338	DATE: AUGUST 2019 SCALE: AS SHOWN DRAWN BY: M. ROBINSON DESIGNED BY: T. STROM REVIEWED BY: J.A. FLEGERT	VALID ONLY WITH EMPOSSED SEAL

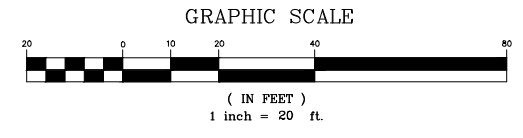
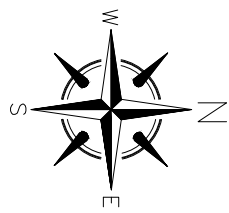

NOTE:  
CONTRACTOR TO ADJUST UTILITY COVERS  
TO MATCH FINAL GRADES.

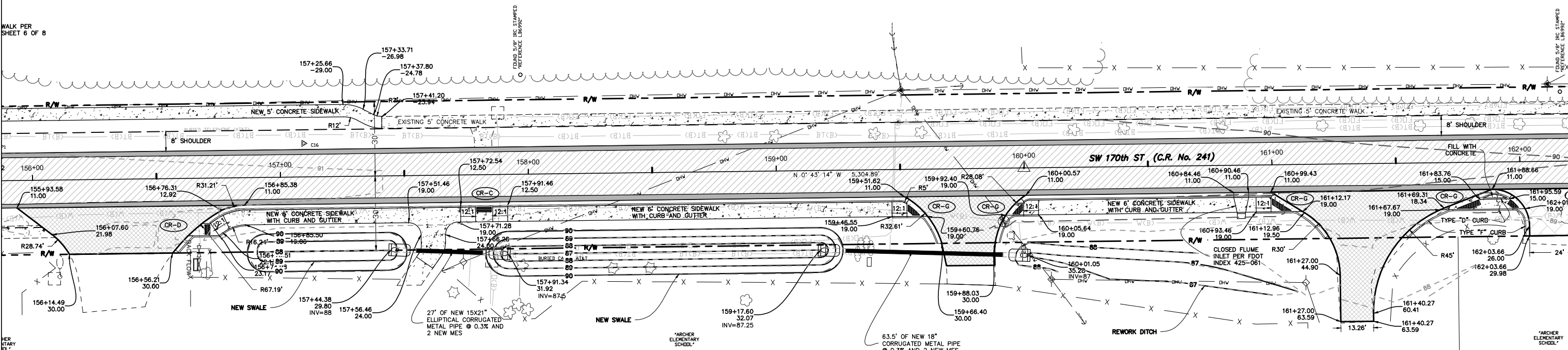

**HATCH LEGEND:**

	LANE MILL AND RESURFACE
	AREA OF WIDENING
	NEW DRIVEWAY
	NEW CONCRETE SIDEWALK
	RECONSTRUCT DRIVEWAY FROM CONCRETE TO ASPHALT; ENSURE SLOPES MATCH SIDEWALK AND ROADWAY

CR-C REFERENCE TO FDOT STANDARD INDEX 522-002

WALK PER SHEET 6 OF 8

SEE ATTACHED SHEET

SEE ATTACHED SHEET

SEE ATTACHED SHEET

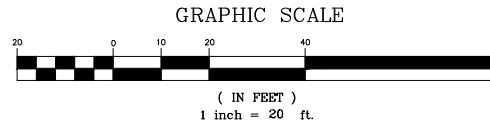
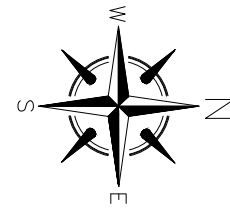

NOTE:  
CONTRACTOR TO ADJUST UTILITY COVERS  
TO MATCH FINAL GRADES.

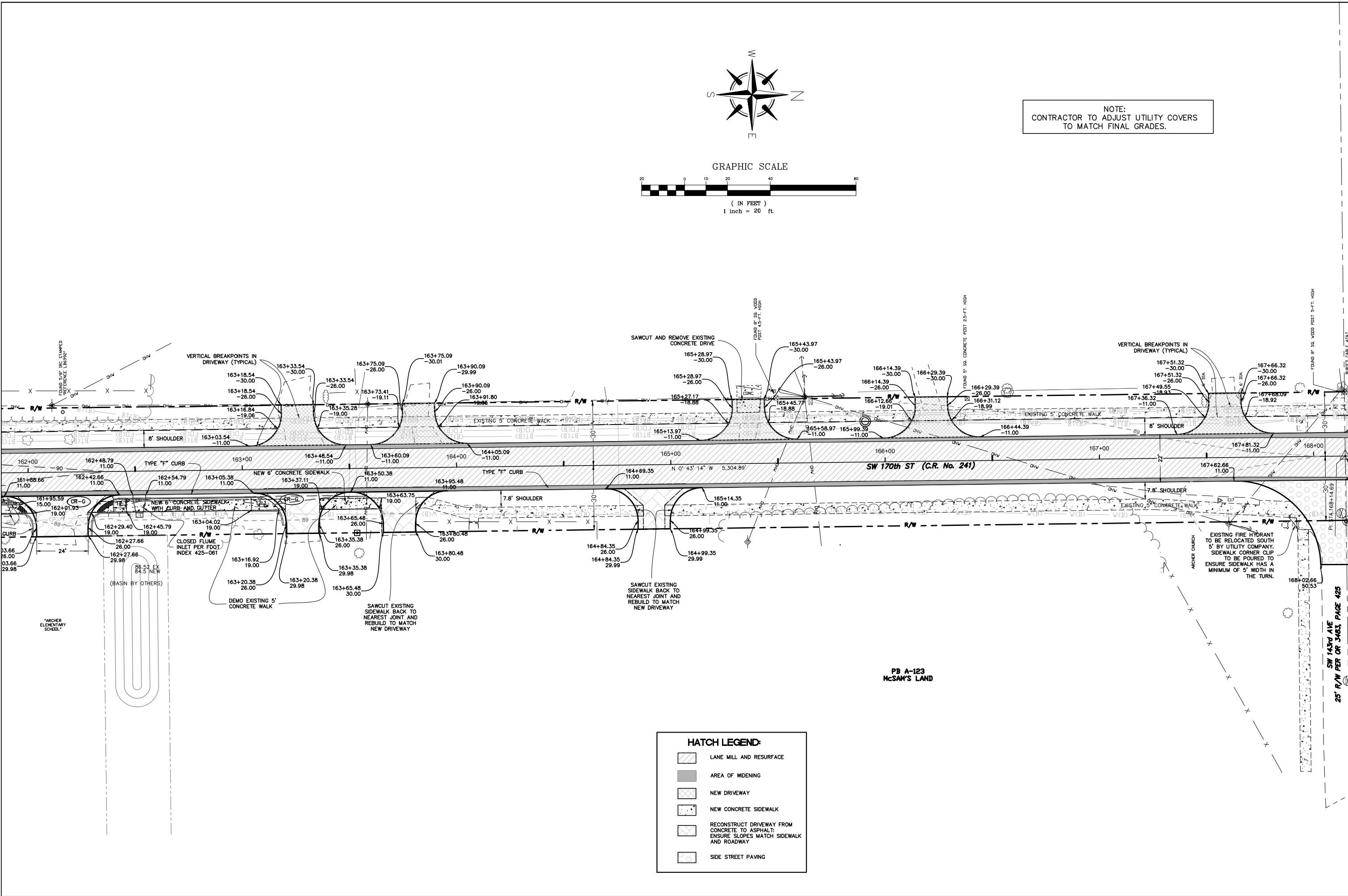

**HATCH LEGEND:**

	LANE MILL AND RESURFACE
	AREA OF WIDENING
	NEW DRIVEWAY
	NEW CONCRETE SIDEWALK
	RECONSTRUCT DRIVEWAY FROM CONCRETE TO ASPHALT; ENSURE SLOPES MATCH SIDEWALK AND ROADWAY
	SIDE STREET PAVING

PB A-123  
McSAM'S LAND

SW 143rd AVE  
25' R/W PER CR 3483, PAGE 425

ENGINEER'S SEAL RAMON D. GAVARRETE, P.E. FLORIDA REG. NO. 51372 M.A.R. 917-7912 SW 170 ST BLDG 2 06/07/25 1339	DATE: AUGUST 2019 SCALE: AS SHOWN DRAWN BY: M. ROBINSON DESIGNED BY: T. STROM REVIEWED BY: J.A. FLECKT	PROJECT 917-7912	PLAN SHEET 11
	ALACHUA COUNTY PUBLIC WORKS ENGINEERING PHONE: 352-374-5245 - FAX: 352-337-8243 MAILING ADDRESS: 5620 NW 120TH LANE, GAINESVILLE, FL 32653		

NOTE:  
CONTRACTOR TO ADJUST UTILITY COVERS  
TO MATCH FINAL GRADES.

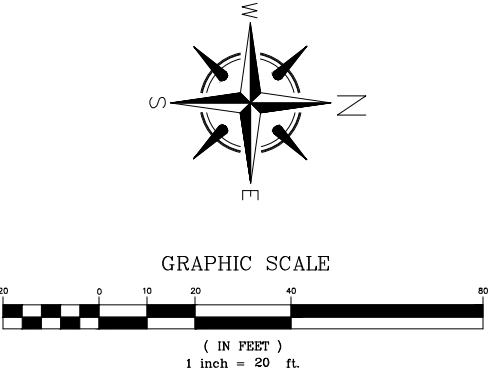
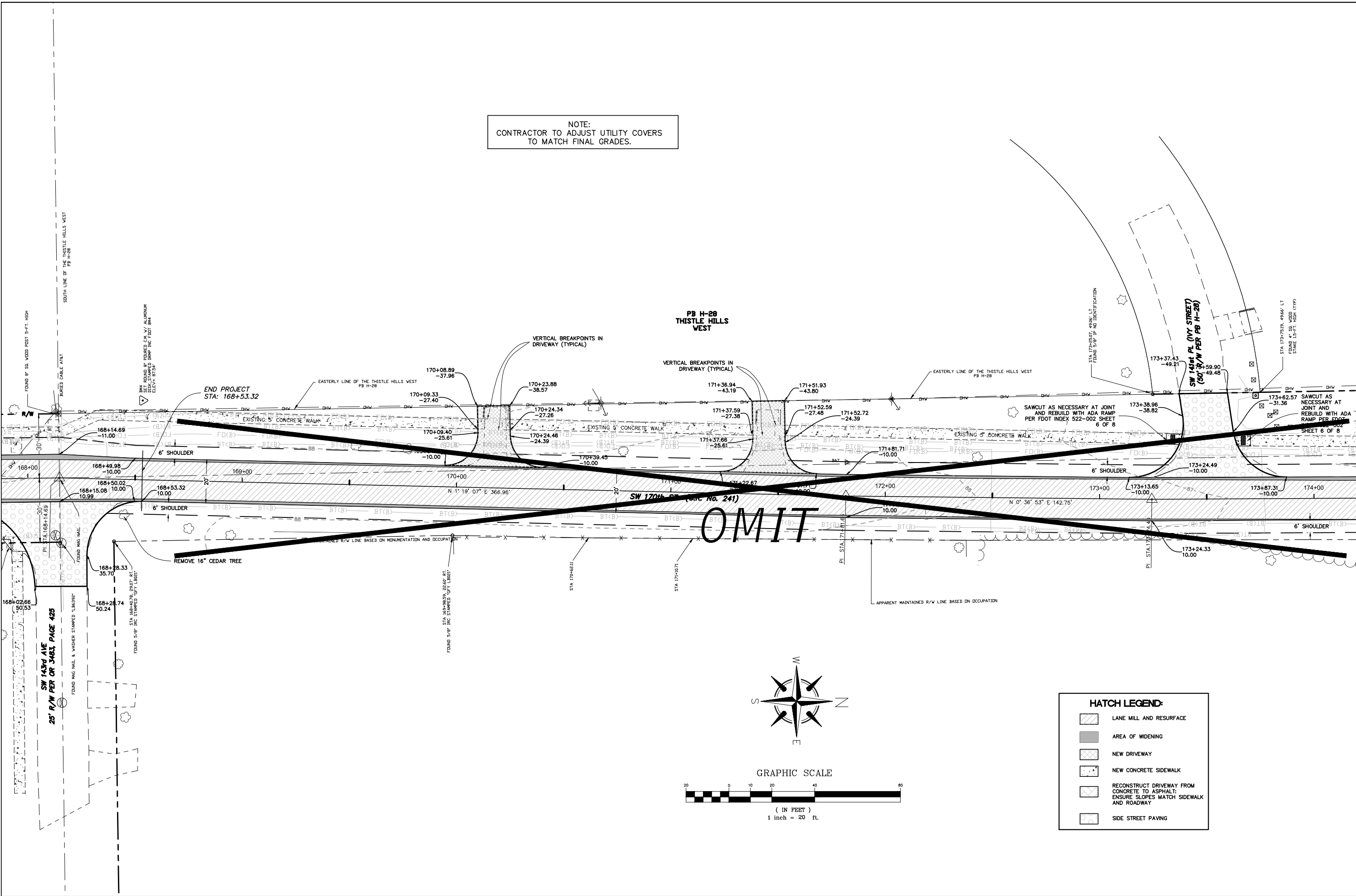

**HATCH LEGEND:**

	LANE MILL AND RESURFACE
	AREA OF WIDENING
	NEW DRIVEWAY
	NEW CONCRETE SIDEWALK
	RECONSTRUCT DRIVEWAY FROM CONCRETE TO ASPHALT: ENSURE SLOPES MATCH SIDEWALK AND ROADWAY
	SIDE STREET PAVING

<p><b>ENGINEER'S SEAL</b> RAMON D. GAVARRETE, P.E. FLORIDA REG. NO. 51372 M.A.R. 917-7932 SW 170 ST BLVD 06/01/25 1339</p>	<p><b>ALACHUA COUNTY PUBLIC WORKS ENGINEERING</b> PHONE: 352-374-5245 - FAX: 352-337-8243 MAILING ADDRESS: 5620 NW 120TH LANE, GAINESVILLE, FL 32653</p>	<p>PROJECT 917-7912</p>	<p>SW 170th STREET PLAN SHEET 12</p>
<p>DATE: AUGUST 2019 SCALE: AS SHOWN DRAWN BY: M.ROBINSON DESIGNED BY: T.TSTROM REVIEWED BY: J.A.FLEGERT</p>	<p>VALID ONLY WITH EMBOSSED SEAL</p>		

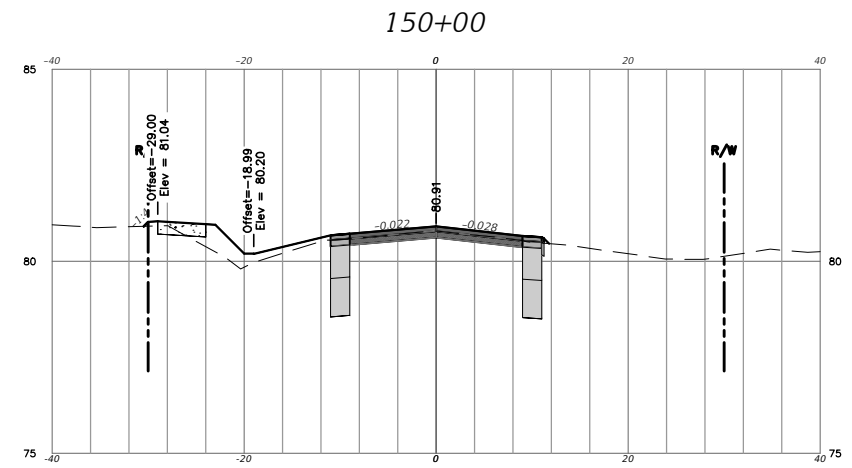
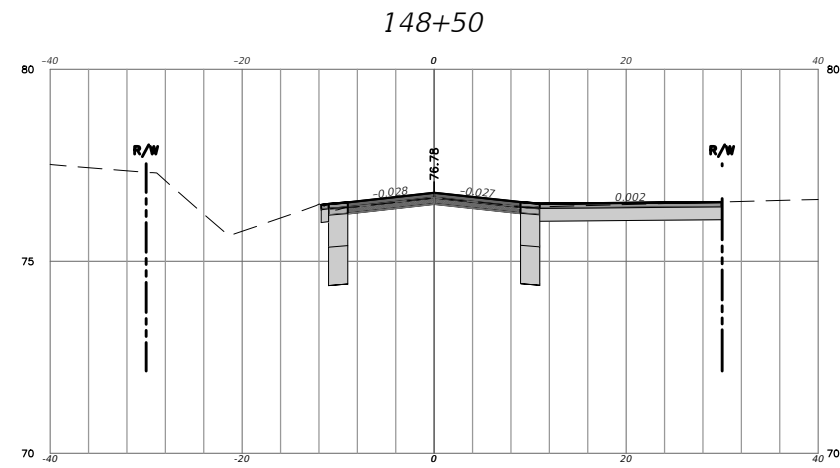
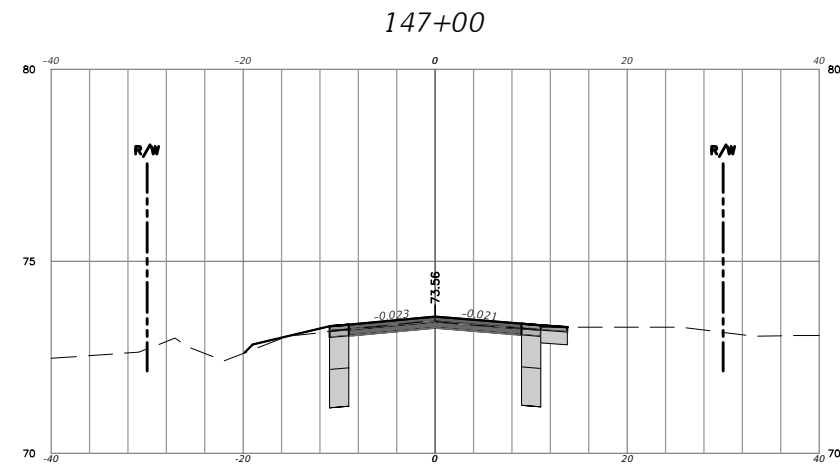
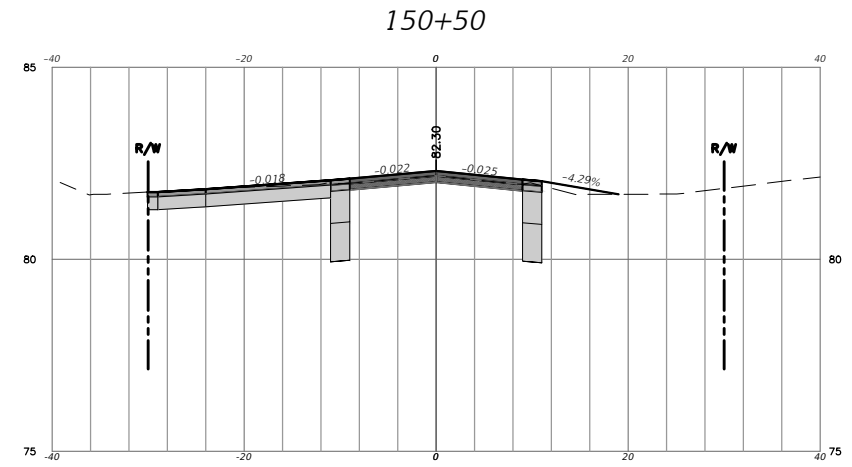
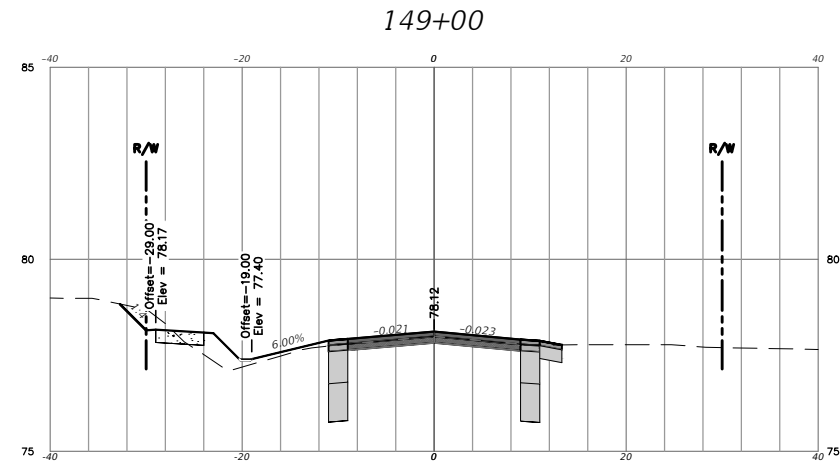
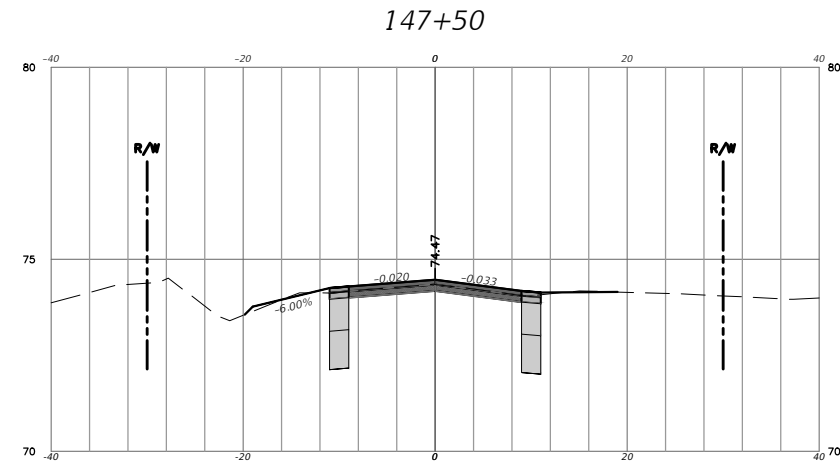
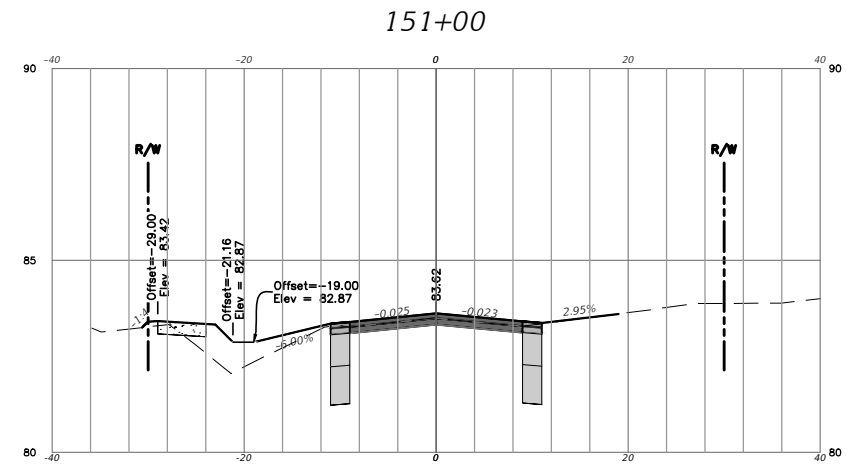
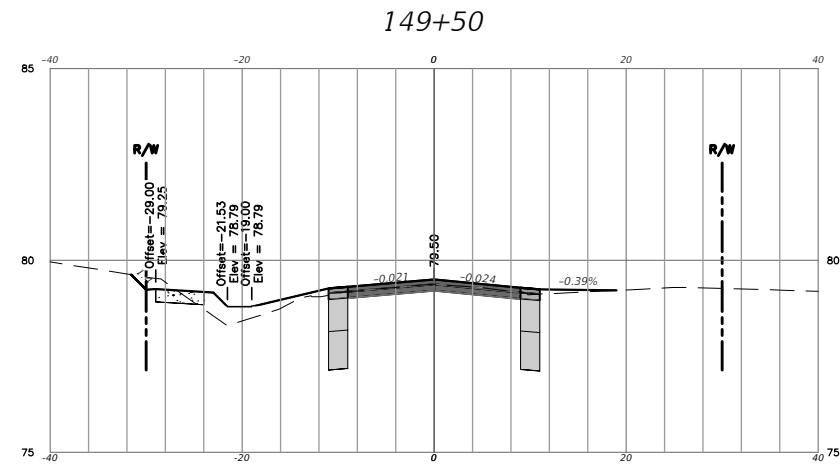
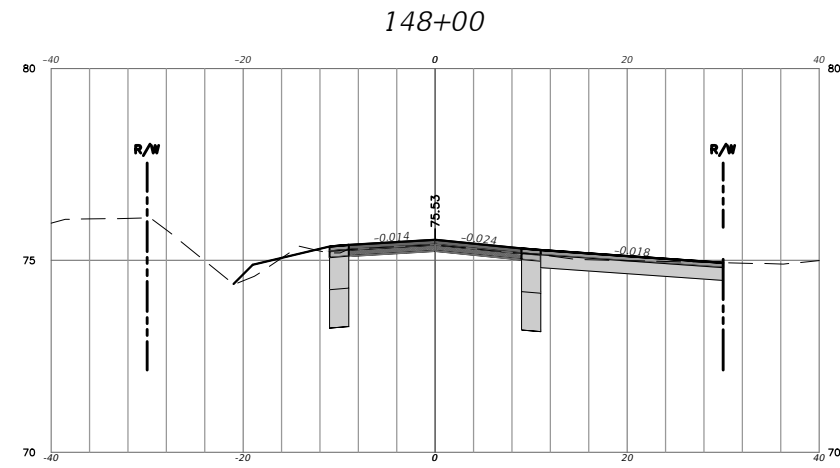

PROJECT 917-7912		20	
SW 170th STREET		CROSS SECTIONS	
<b>ALACHUA COUNTY</b> <b>PUBLIC WORKS</b> <b>ENGINEERING</b> PHONE: 352-337-5245 - FAX: 352-337-6243 MAILING ADDRESS: 5620 NW 120TH LANE, GAINESVILLE, FL 32653			
DATE:	AUGUST 2019	DESIGNED BY:	T. STROM
SCALE:	AS SHOWN	DRAWN BY:	M. ROBINSON
REVIEWED BY:	J.A. FLEERT	ENGINEER'S SEAL:	RAMON D. GAVARRETE, P.E.
		FLORIDA REG. NO.:	51372
		M.A.R. 917-7912 SW 170 ST BLDG 20	DATE: 06/01/20 1336

11"X17"  
 HOR: 1"=20'  
 VER: 1"=5'

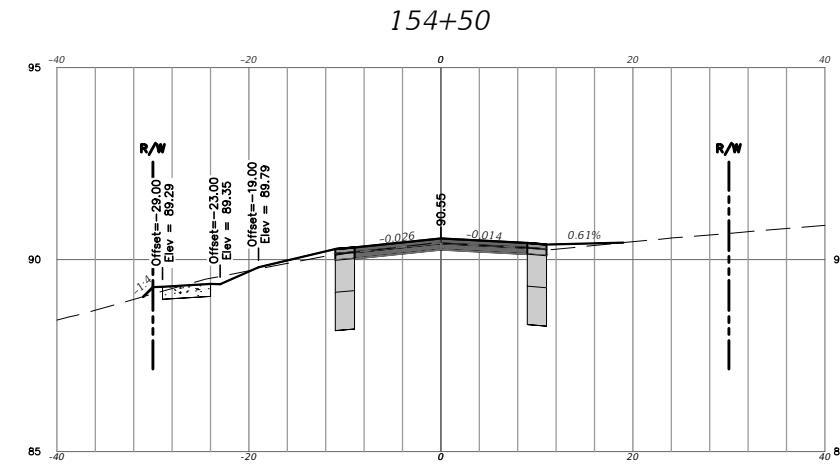
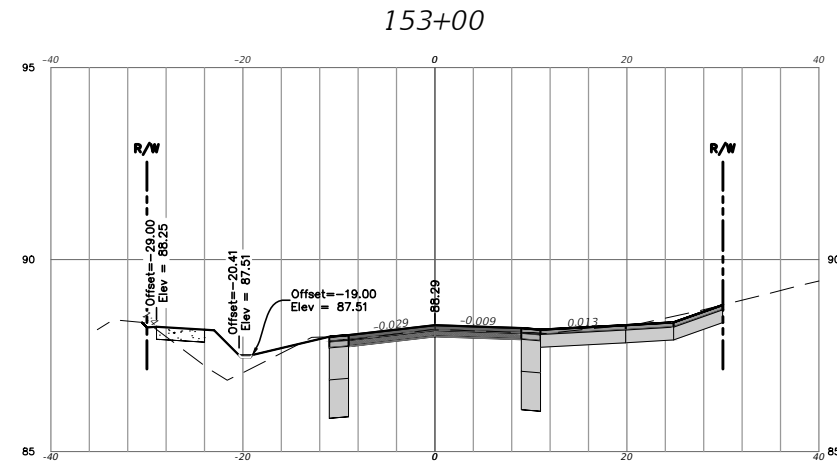
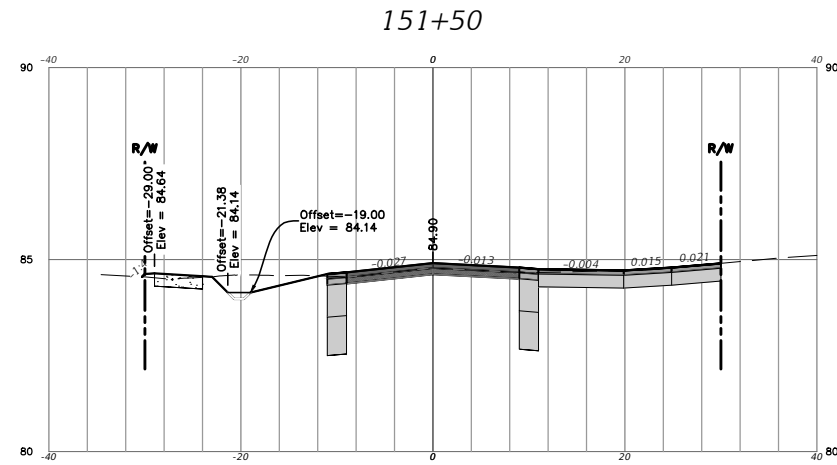
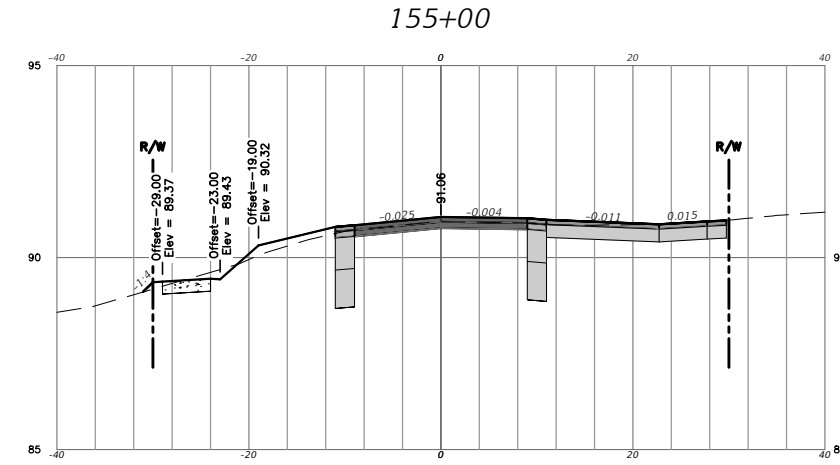
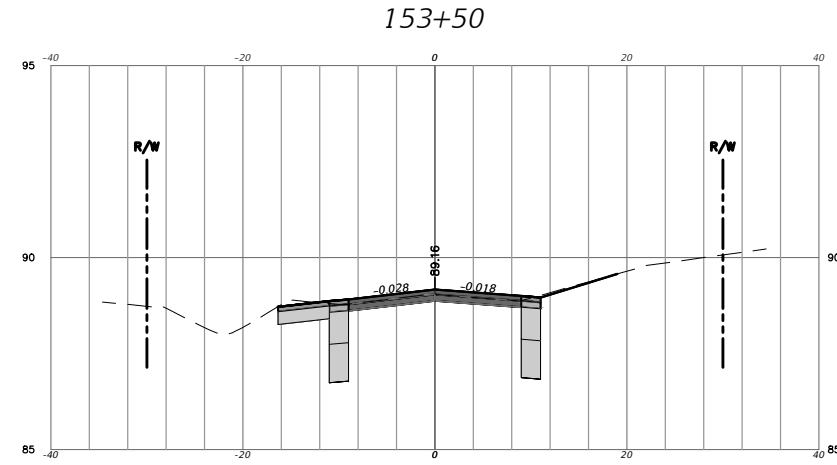
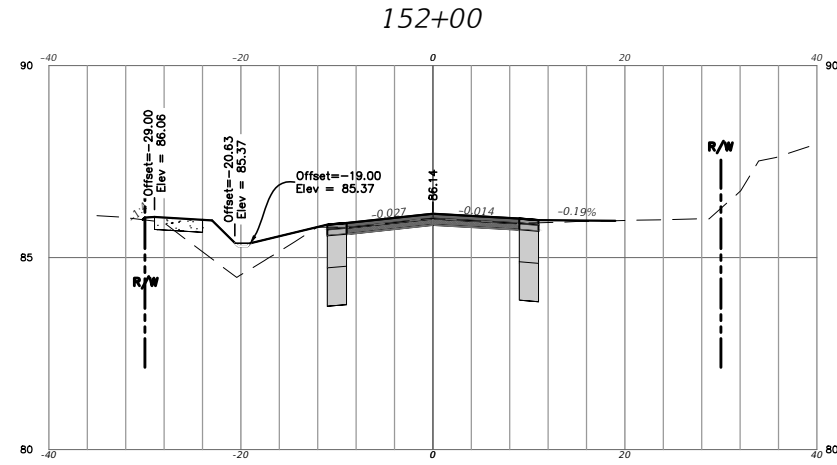
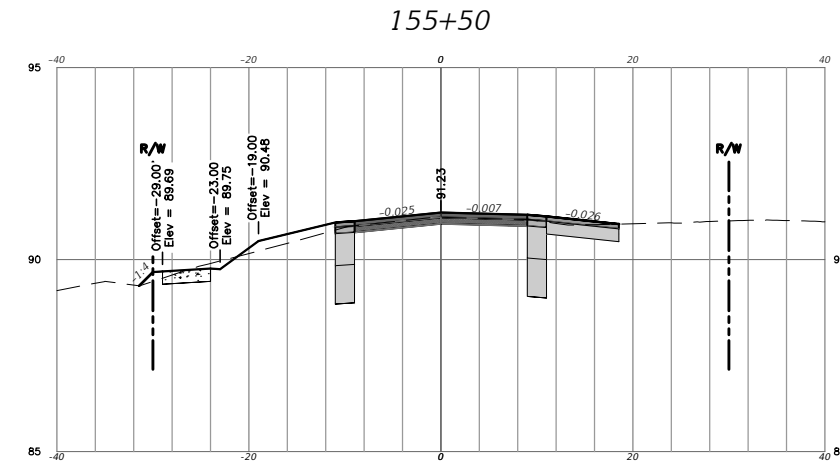
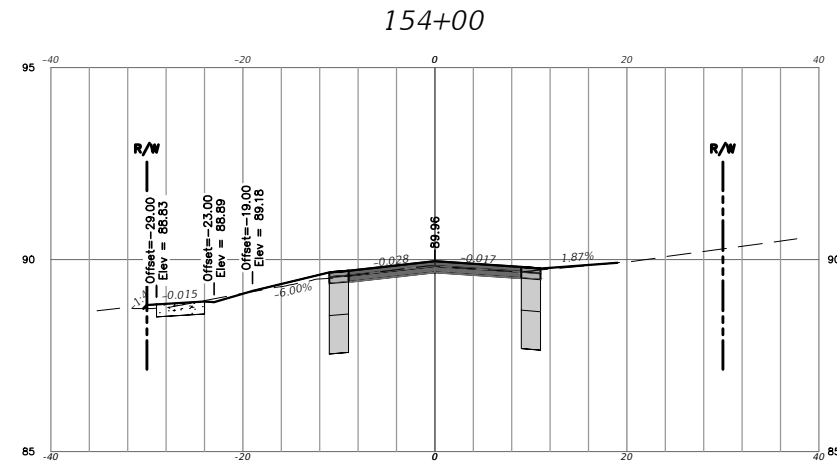
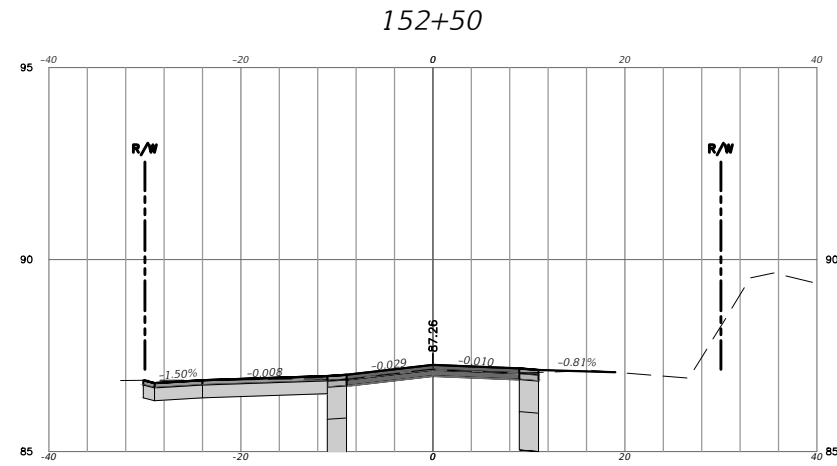

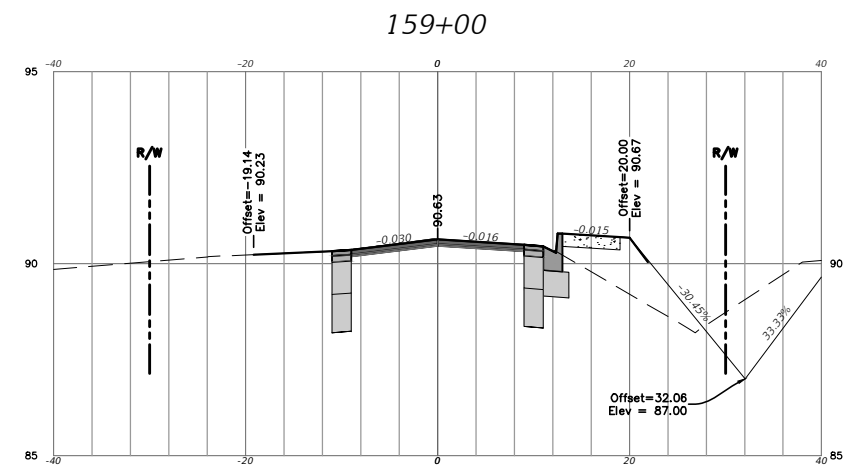
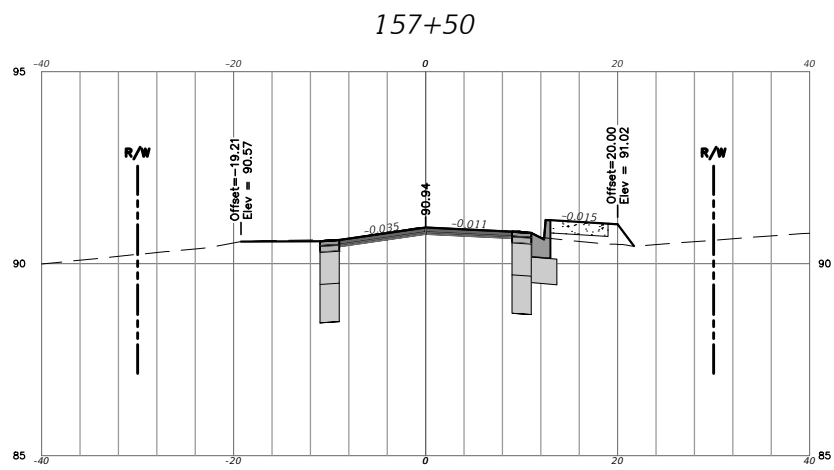
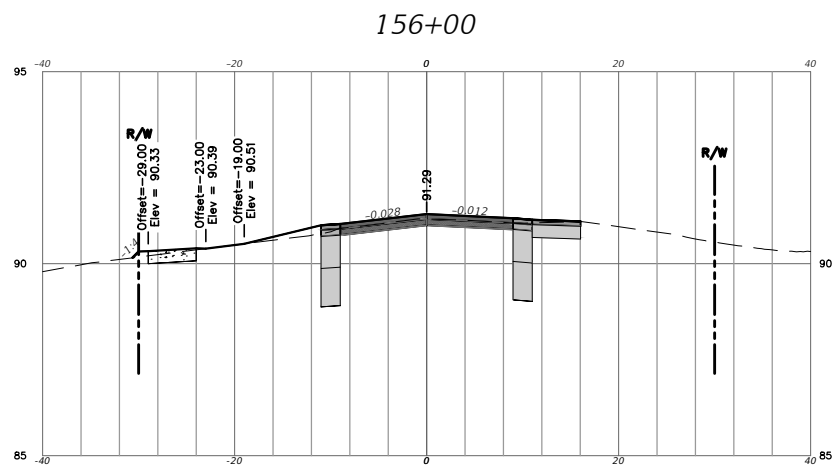
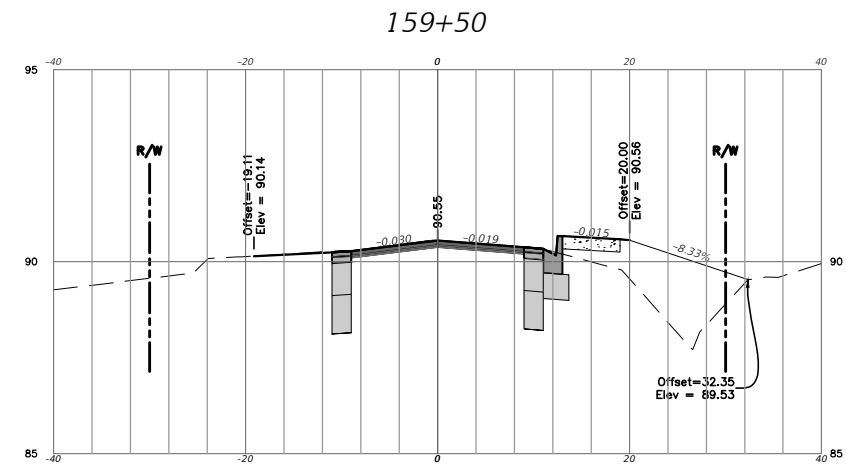
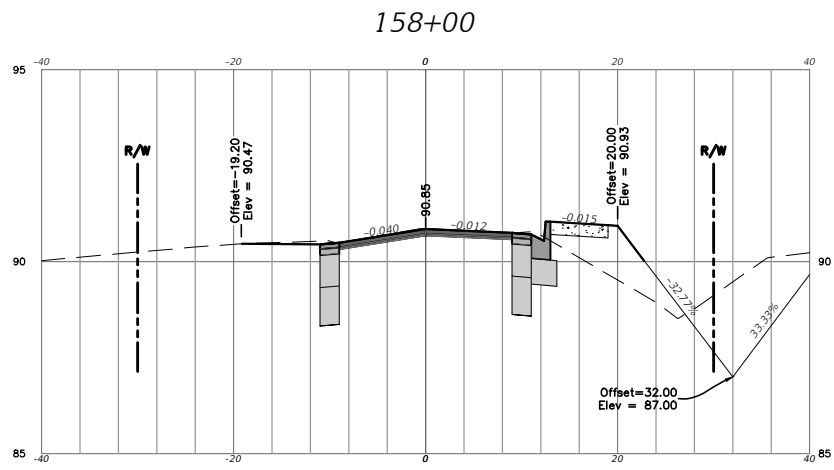
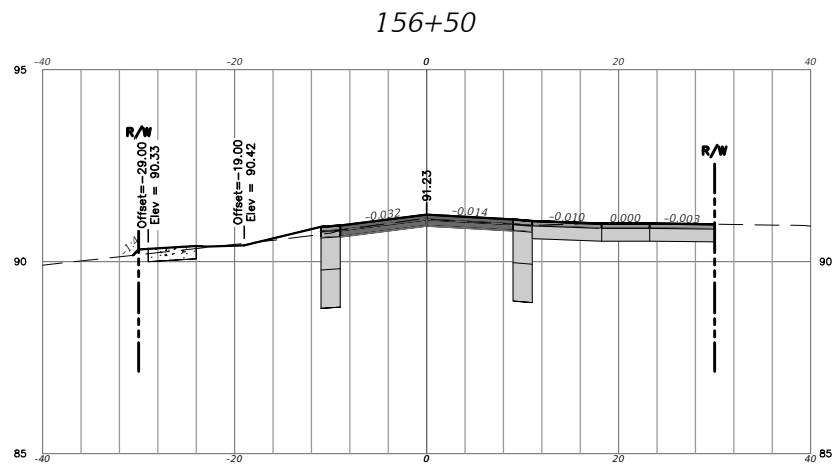
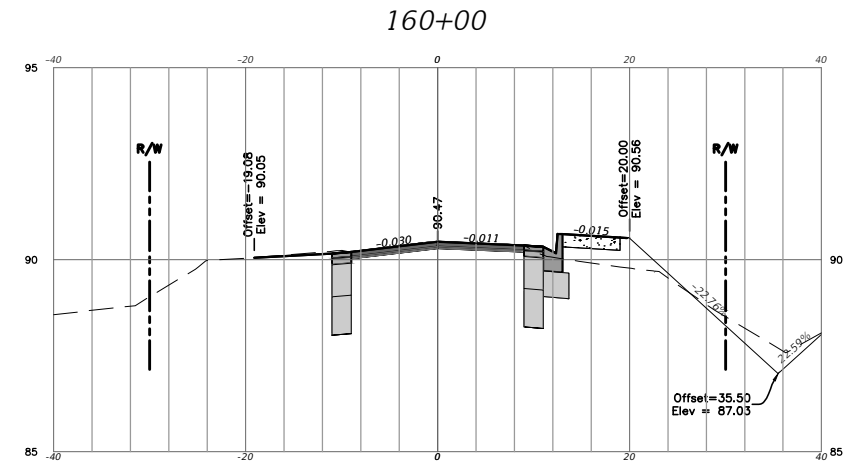
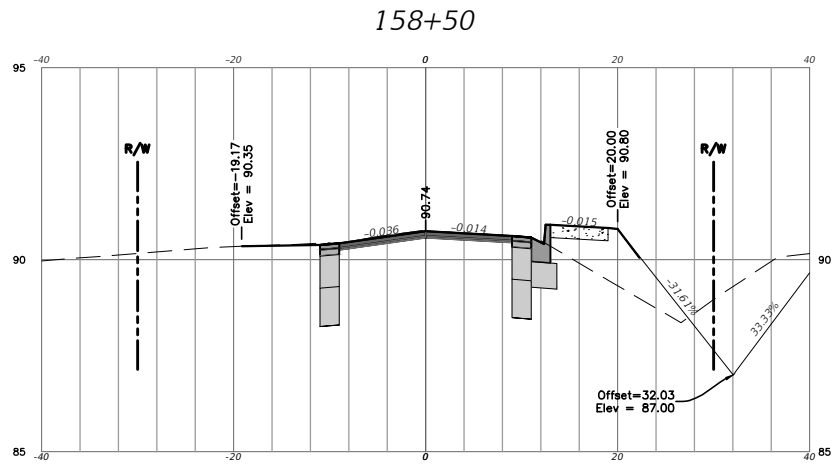
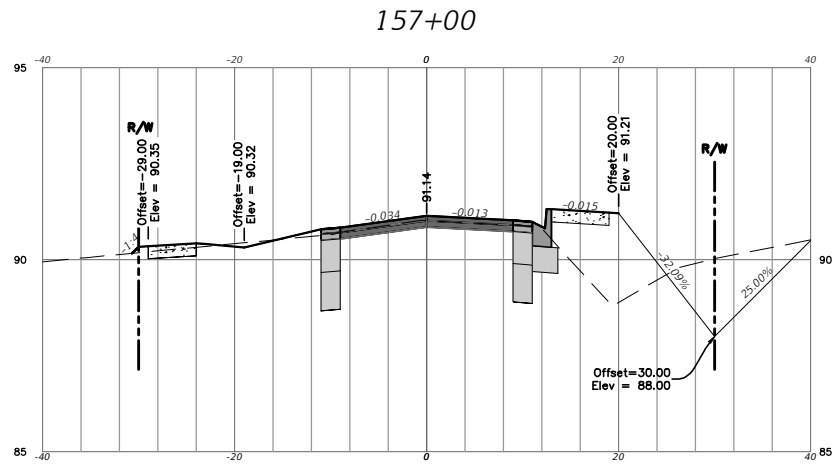

PROJECT 917-7912	22
SW 170th STREET	CROSS SECTIONS
<b>ALACHUA COUNTY PUBLIC WORKS ENGINEERING</b> PHONE: 352-374-5245 - FAX: 352-337-8243 MAILING ADDRESS: 5620 NW 120TH LANE, GAINESVILLE, FL 32653	
DATE: AUGUST 2019	AS SHOWN
SCALE:	M. ROBINSON
DRAWN BY:	T. STROM
DESIGNED BY:	J.A. FLEERT
REVIEWED BY:	
ENGINEER'S SEAL RAMON D. GAVARRETE, P.E. FLORIDA REG. NO. 51372 M.A.R. 917-7912 SW 170 ST BLDG 2 06/05/20 1339	VALID ONLY WITH EMBOSSED SEAL

11"x17"  
HOR: 1"=20'  
VER: 1"=5'

161+50

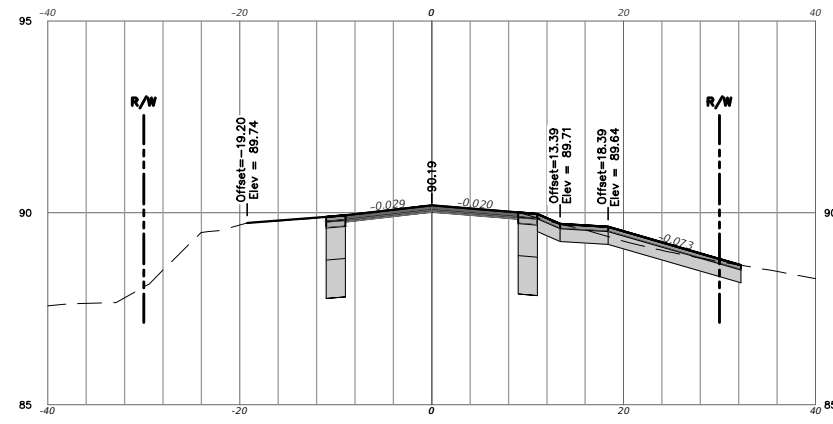

163+00

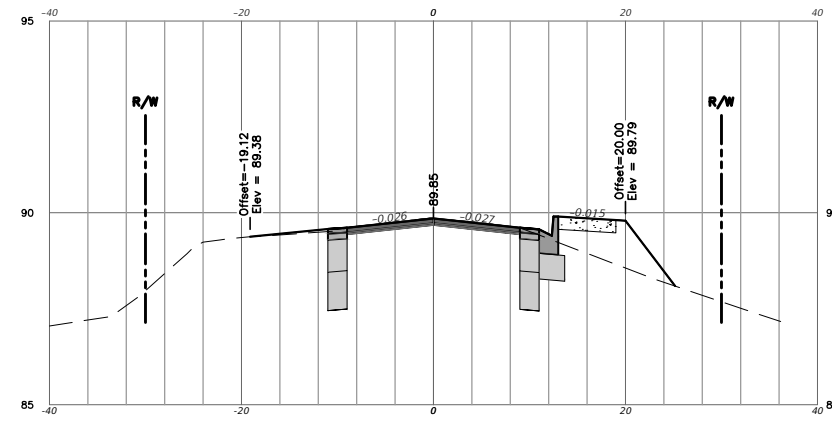

164+50

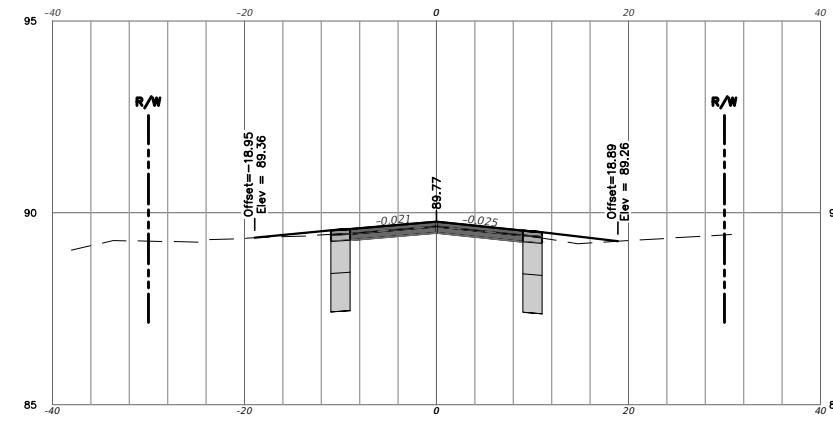

161+00

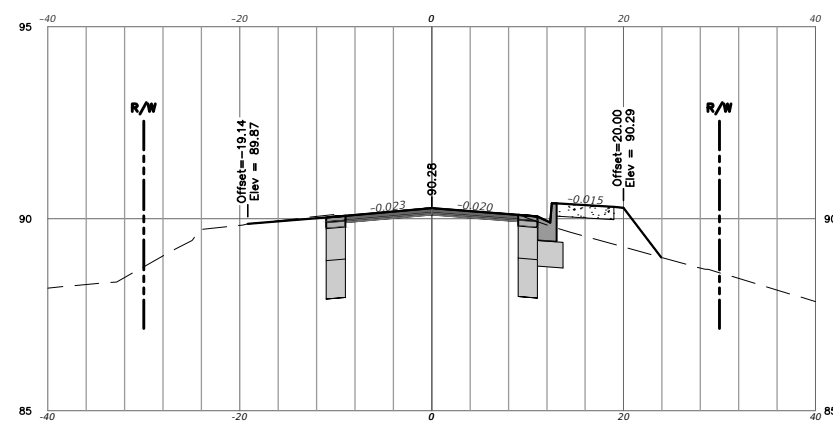

162+50

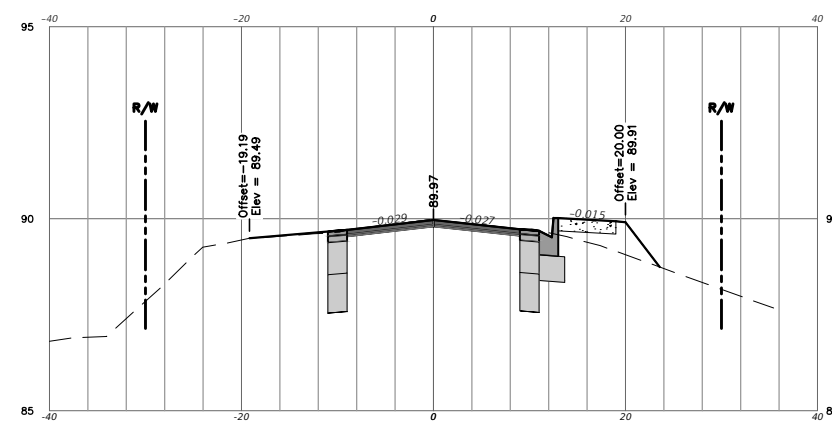

164+00

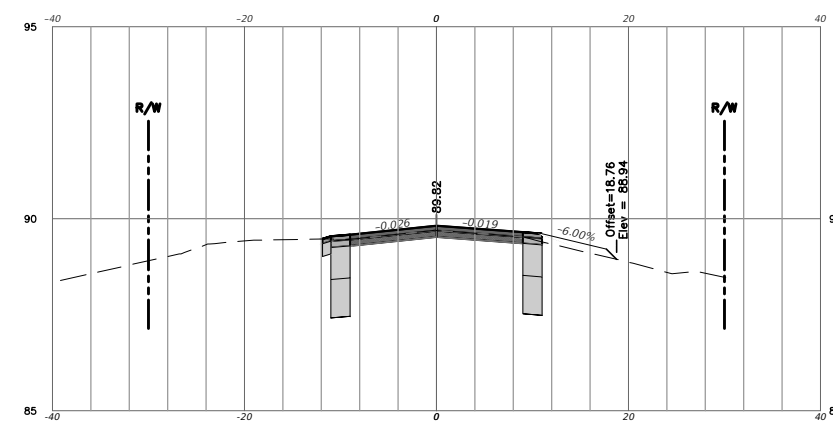

160+50

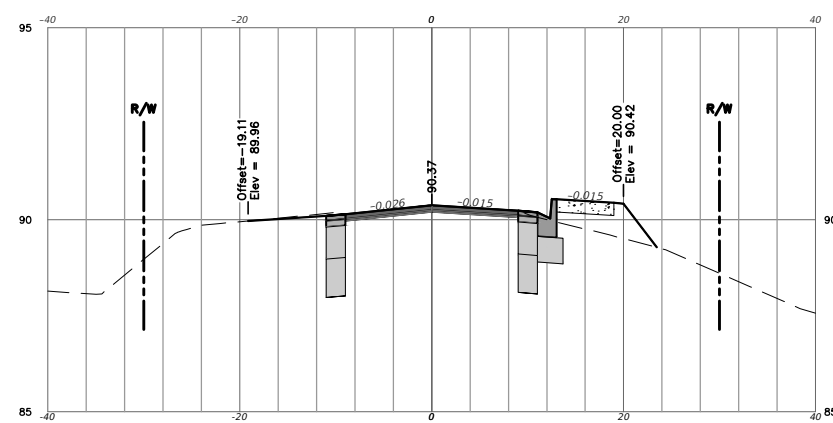

162+00

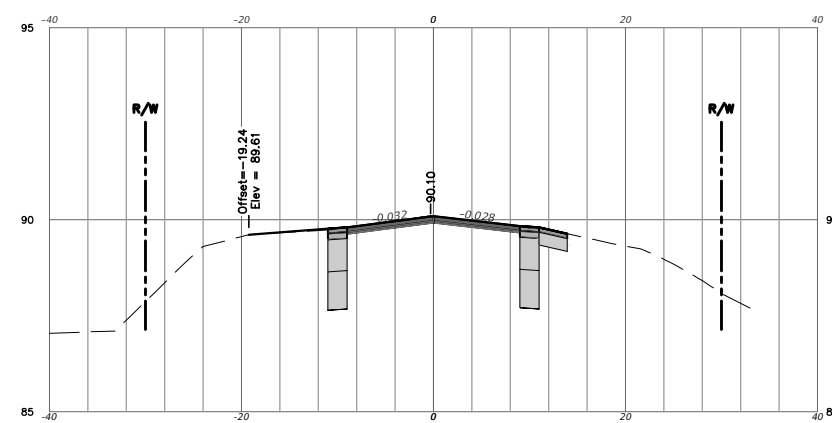

163+50

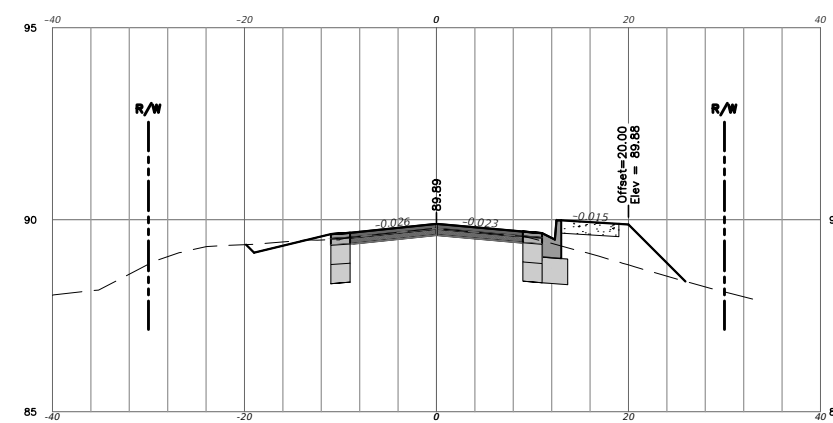

11"X17"  
HOR: 1"=20'  
VER: 1"=5'



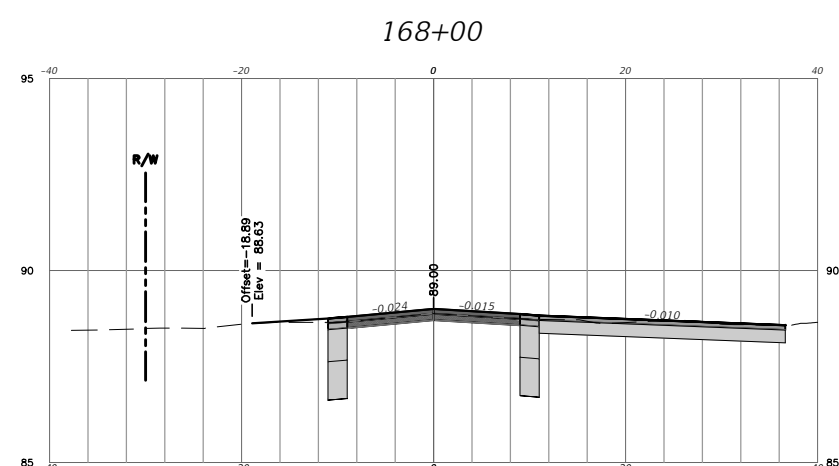
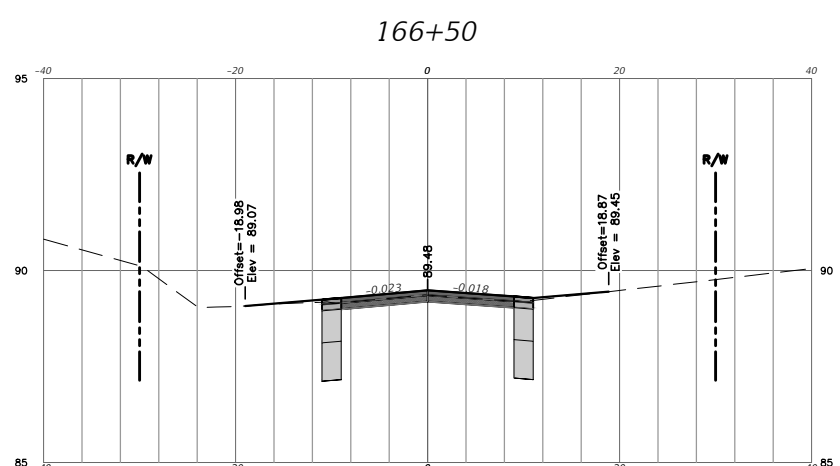
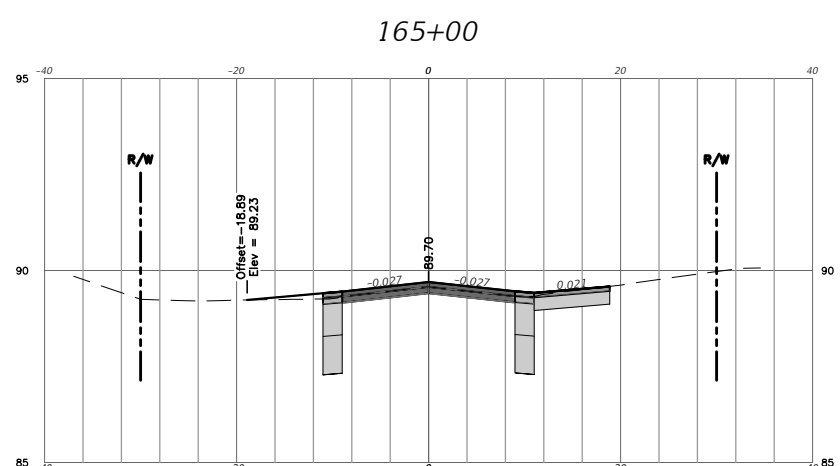
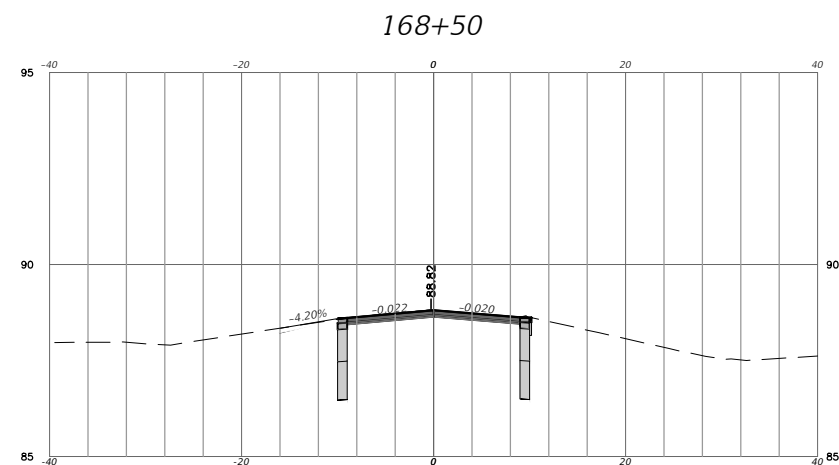
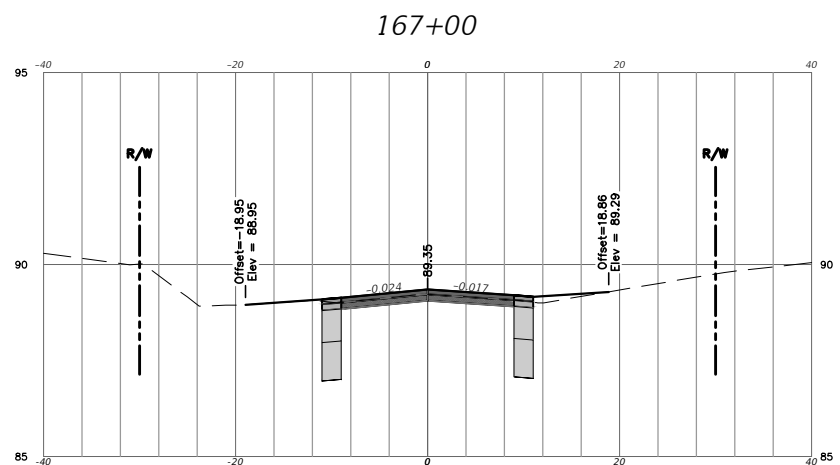
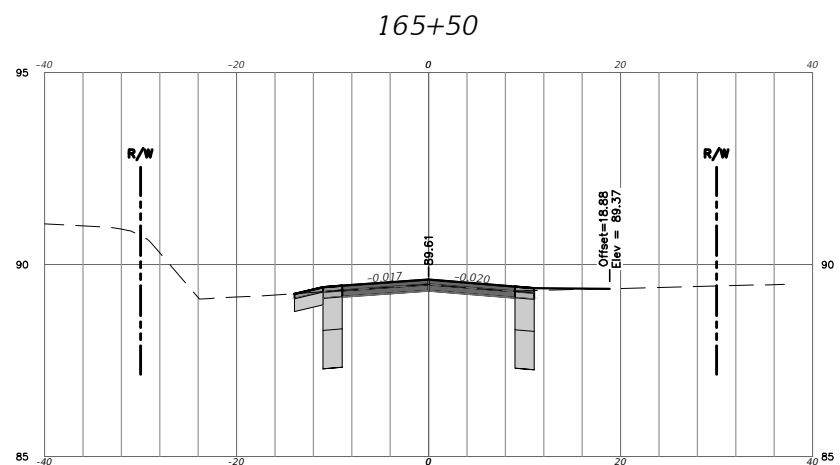
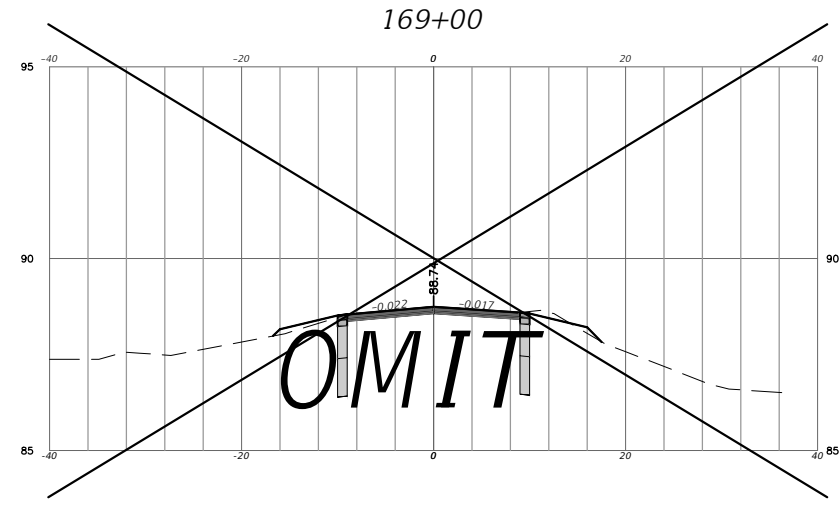
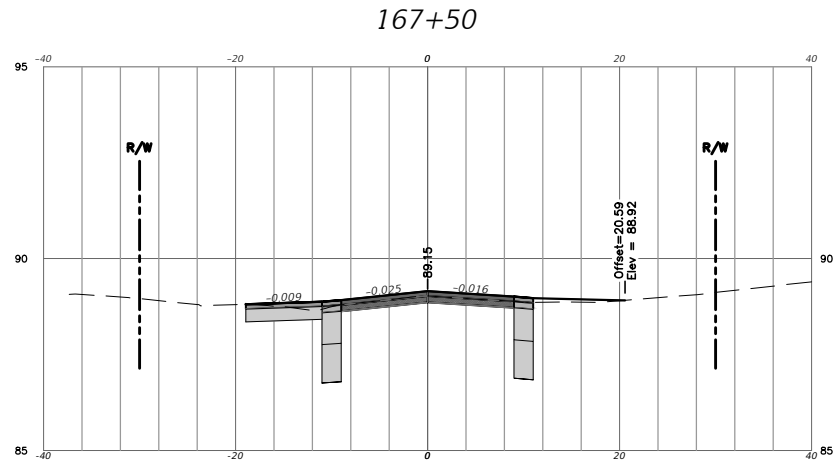
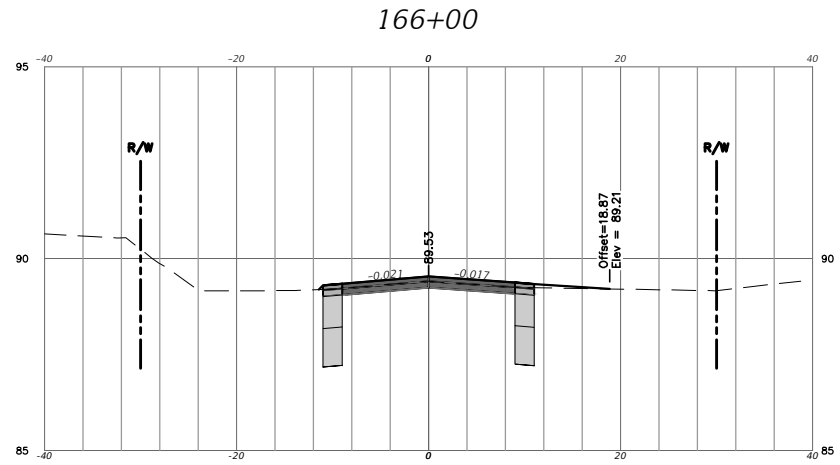

PROJECT 917-7912	24
SW 170th STREET	CROSS SECTIONS
<b>ALACHUA COUNTY PUBLIC WORKS ENGINEERING</b> PHONE: 352-374-5245 - FAX: 352-337-4243 MAILING ADDRESS: 5620 NW 120TH LANE, GAINESVILLE, FL 32653	
DATE: AUGUST 2019	AS SHOWN
SCALE:	M. ROBINSON
DRAWN BY:	T. STROM
DESIGNED BY:	J.A. FLEERT
REVIEWED BY:	
ENGINEER'S SEAL RAMON D. GAVARRETE, P.E. FLORIDA REG. NO. 51372 M.A.R. 917-7912 SW 170 ST BLDG 2 06/05/20 1339	VALID ONLY WITH EMPOSSED SEAL

11"x17"  
HOR: 1"=20'  
VER: 1"=5'

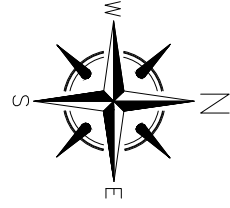
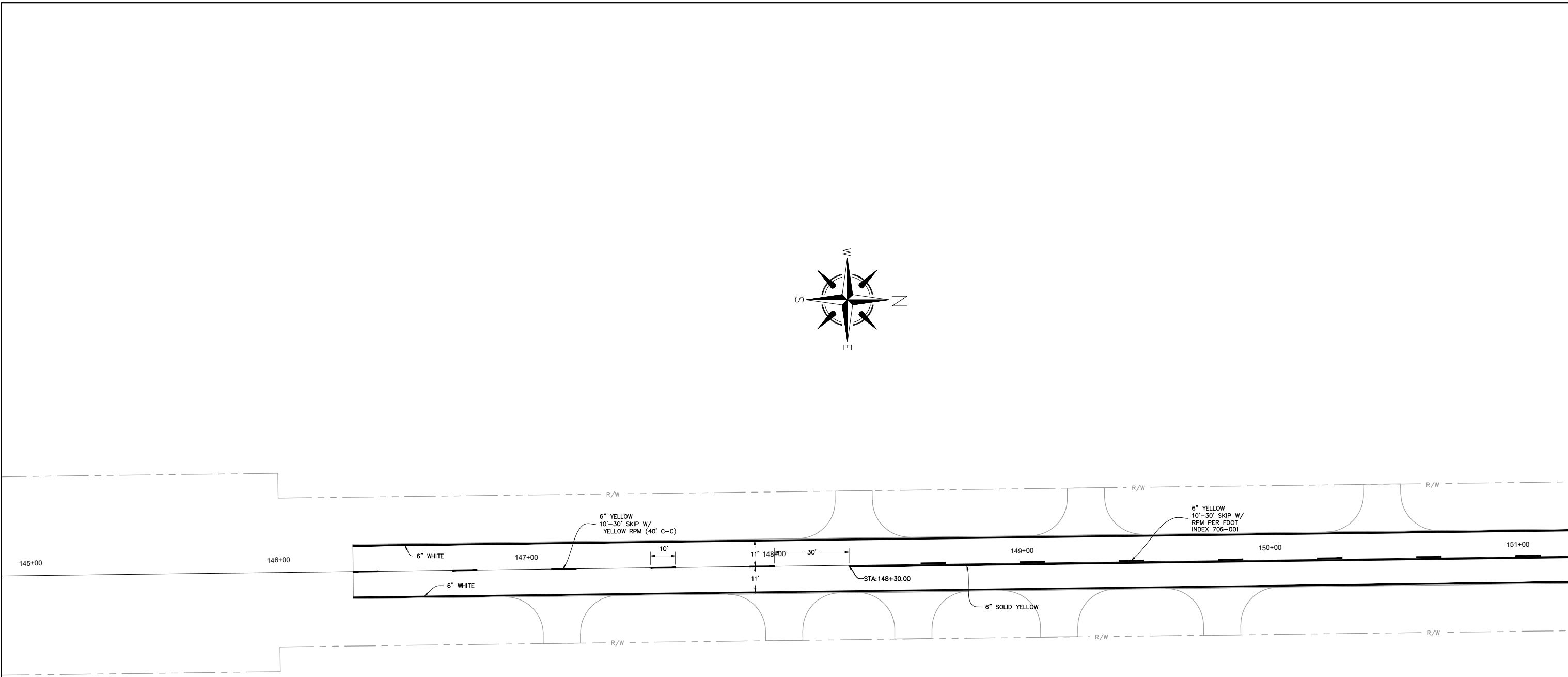

PROJECT  
917-7912

SW 170th STREET  
SIGNING AND PAVEMENT MARKING PLAN

**ALACHUA COUNTY  
PUBLIC WORKS  
ENGINEERING**  
PHONE: 352-374-5245 - FAX: 352-337-4243  
MAILING ADDRESS: 5620 NW 120TH LANE, GAINESVILLE, FL 32653

DATE:	AUGUST 2019
SCALE:	AS SHOWN
DRAWN BY:	M. ROBINSON
DESIGNED BY:	T. STROM
REVIEWED BY:	J.A. FLEGERT

ENGINEER'S SEAL  
RAMON D. GAVARRETE, P.E.  
FLORIDA REG. NO. 51372  
M.A.R. 917-7912 SW 170 ST STRIPING  
06/01/20 1339

- SIGNING AND STRIPING NOTES:
- 1) ALL STRIPING TO BE INSTALLED PER FDOT DESIGN STANDARD FY 2019-2020.
  - 2) ALL SIGNAGE TO REMAIN UNLESS OTHERWISE NOTED.
  - 3) ALL MAILBOXES THAT REQUIRE RELOCATION DUE TO CONSTRUCTION SHALL BE RELOCATED PER INDEX 110-200.

VALID ONLY WITH EMBOSSED SEAL

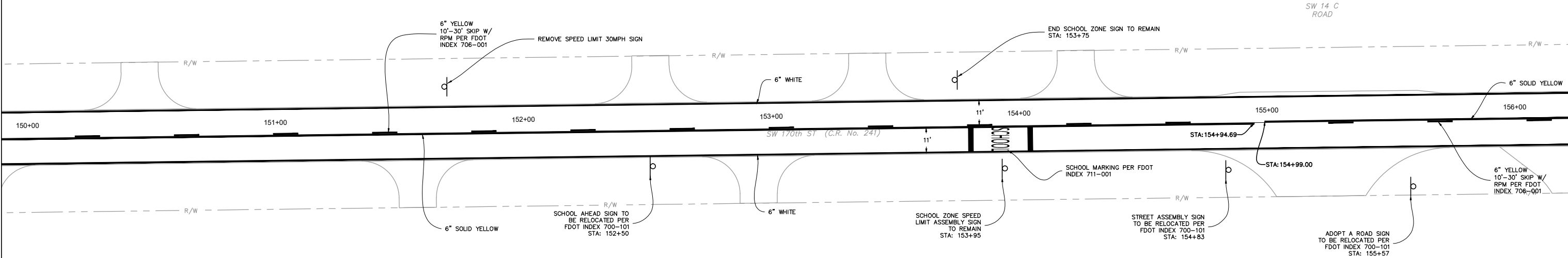
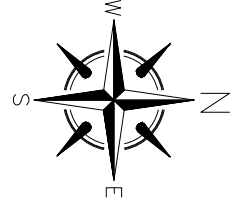

- SIGNING AND STRIPING NOTES:
- 1) ALL STRIPING TO BE INSTALLED PER FDOT DESIGN STANDARD FY 2019-2020.
  - 2) ALL SIGNAGE TO REMAIN UNLESS OTHERWISE NOTED.
  - 3) ALL MAILBOXES THAT REQUIRE RELOCATION DUE TO CONSTRUCTION SHALL BE RELOCATED PER INDEX 110-200.

<b>ENGINEER'S SEAL</b> RAMON D. GAVARRETE, P.E. FLORIDA REG. NO. 51372 M.A.B. 917-7932 SW 170 ST STRIPING 06/01/20 1339	DATE: AUGUST 2019 SCALE: AS SHOWN DRAWN BY: M. ROBINSON DESIGNED BY: T. STROM REVIEWED BY: J.A. FLEGERT	<b>ALACHUA COUNTY          PUBLIC WORKS          ENGINEERING</b> PHONE: 352-374-5245 - FAX: 352-337-4243 MAILING ADDRESS: 5620 NW 120TH LANE, GAINESVILLE, FL 32653	<b>PROJECT</b> 917-7912
	<b>SW 170th STREET</b>	<b>SIGNING AND PAVEMENT MARKING PLAN</b>	35

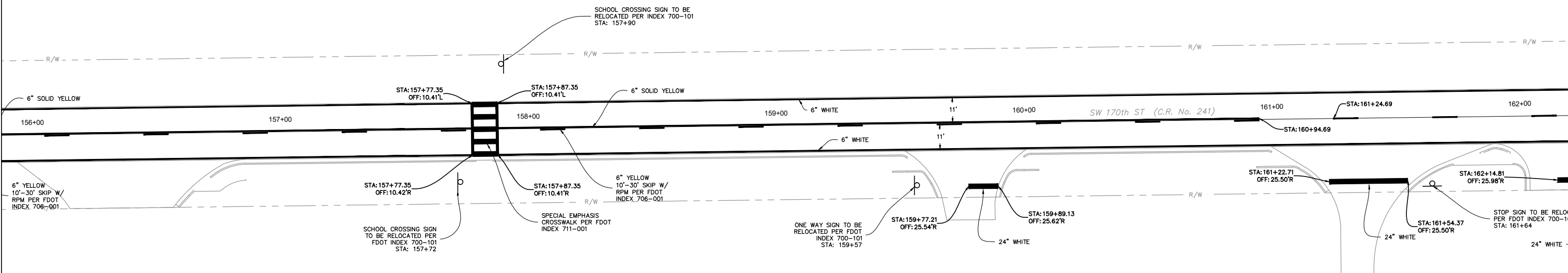
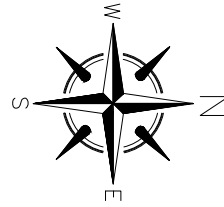

- SIGNING AND STRIPING NOTES:
- 1) ALL STRIPING TO BE INSTALLED PER FDOT DESIGN STANDARD FY 2019-2020.
  - 2) ALL SIGNAGE TO REMAIN UNLESS OTHERWISE NOTED.
  - 3) ALL MAILBOXES THAT REQUIRE RELOCATION DUE TO CONSTRUCTION SHALL BE RELOCATED PER INDEX 110-200.

ENGINEER'S SEAL RAMON D. GAVARRETE, P.E. FLORIDA REG. NO. 51372 M.A.B. 917-7982 SW 170th ST STRIPING 06/05/20 1339	DATE: AUGUST 2019 SCALE: AS SHOWN DRAWN BY: M. ROBINSON DESIGNED BY: T. STROM REVIEWED BY: J.A. FLEGERT	<b>ALACHUA COUNTY          PUBLIC WORKS          ENGINEERING</b> PHONE: 352-337-4245 - FAX: 352-337-4243 MAILING ADDRESS: 5620 NW 120TH LANE, GAINESVILLE, FL 32653	PROJECT 917-7912
	SW 170th STREET	SIGNING AND PAVEMENT MARKING PLAN	36

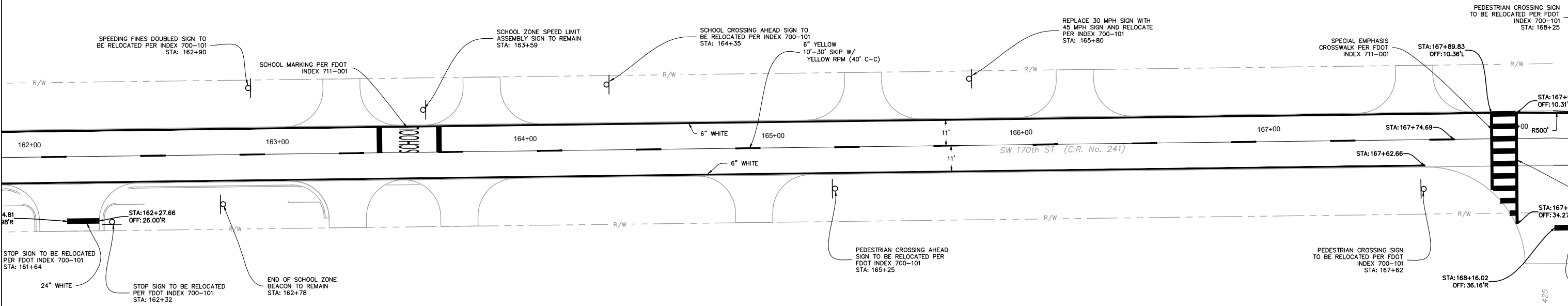
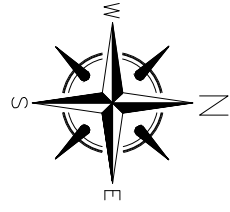

SW 143rd AVE  
25' R/W PER OR 3483, PAGE 425

- SIGNING AND STRIPING NOTES:
- 1) ALL STRIPING TO BE INSTALLED PER FDOT DESIGN STANDARD FY 2019-2020.
  - 2) ALL SIGNAGE TO REMAIN UNLESS OTHERWISE NOTED.
  - 3) ALL MAILBOXES THAT REQUIRE RELOCATION DUE TO CONSTRUCTION SHALL BE RELOCATED PER INDEX 110-200.

VALID ONLY WITH EMBOSSED SEAL

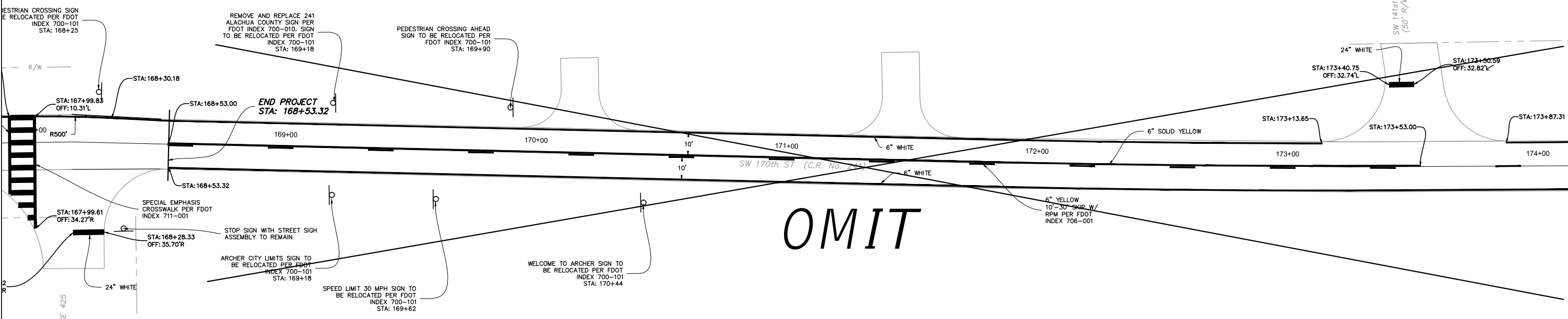
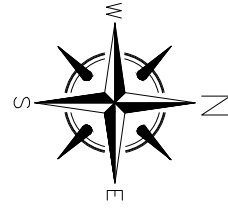

OMIT

- SIGNING AND STRIPING NOTES:
- 1) ALL STRIPING TO BE INSTALLED PER FDOT DESIGN STANDARD FY 2019-2020.
  - 2) ALL SIGNAGE TO REMAIN UNLESS OTHERWISE NOTED.
  - 3) ALL MAILBOXES THAT REQUIRE RELOCATION DUE TO CONSTRUCTION SHALL BE RELOCATED PER INDEX 110-200.

<b>ALACHUA COUNTY PUBLIC WORKS ENGINEERING</b> <small>PHONE: 352-374-5245 - FAX: 352-337-8243 MAILING ADDRESS: 5620 NW 120TH LANE, GAINESVILLE, FL 32653</small>	<b>SW 170th STREET</b>	PROJECT 917-7912
DATE: AUGUST 2019 SCALE: AS SHOWN DRAWN BY: M. ROBINSON DESIGNED BY: T. STROM REVIEWED BY: J.A. FLEGERT	VALID ONLY WITH EMBOSSED SEAL	
ENGINEER'S SEAL RAMON D. GAVARRETE, P.E. FLORIDA REG. NO. 51372 M.A.B. 917-7912 SW 170th ST STRIPING 08/01/20 1338	SIGNING AND PAVEMENT MARKING PLAN	
		38