

LEGEND

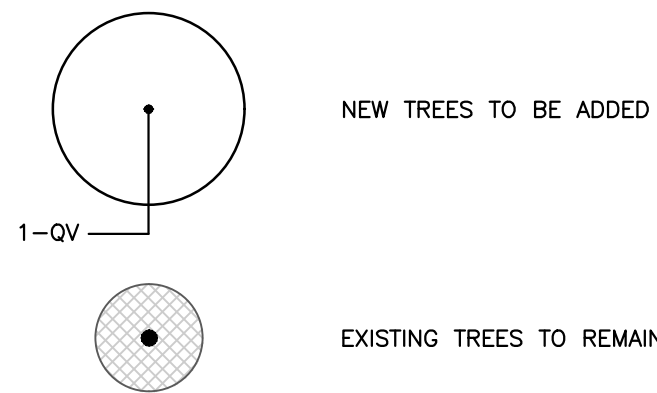

PLANT SCHEDULE

TREES	QTY	BOTANICAL NAME	COMMON NAME	SIZE
IAE	3	ILEX X ATTENUATA 'EAST PALATKA'	EAST PALATKA HOLLY	30 GAL, 7' HT, 3' SPR, 2" CAL
LIM	1	LAGERSTROEMIA INDICA 'MUSKOGEE'	MUSKOGEE CRAPE MYRTLE	30 GAL, 10' HT, 4' SPR, 2" CAL
UA	1	ULMUS ALATA	WINGED ELM	30 GAL, 10' HT, 4' SPR, 2" CAL
SOD/SEED		BOTANICAL NAME	COMMON NAME	SIZE
SOD		PASPALUM NOTATUM 'ARGENTINE'	BAHIA GRASS	WEED FREE AND SAND GROWN SOD

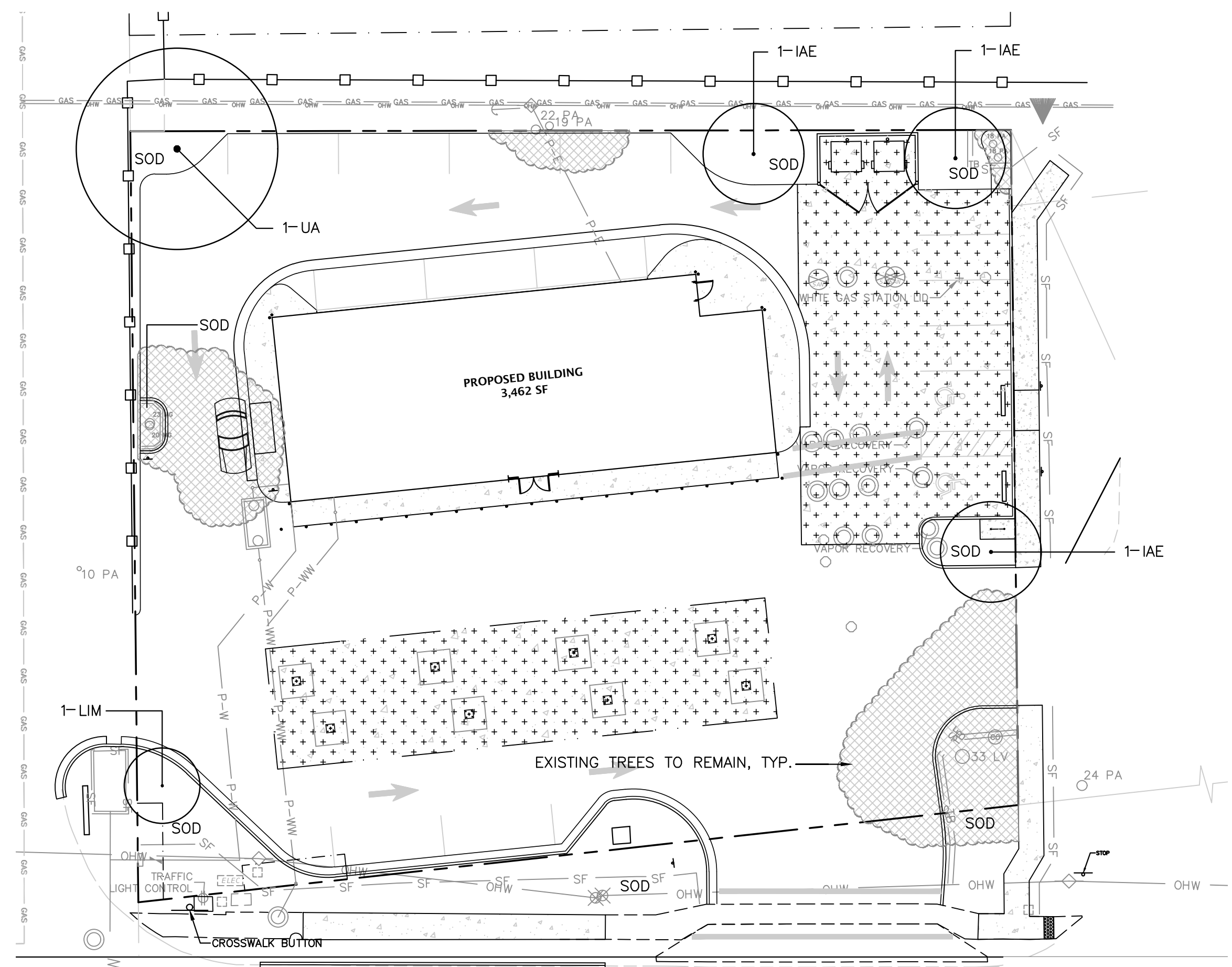
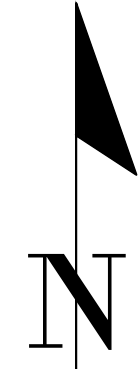

STATE ROAD NO. 26
A.K.A. NEWBERRY ROAD

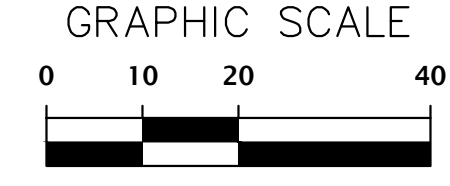

FINAL DEVELOPMENT REVIEW CHECKLIST

- XIII. LANDSCAPE PLAN, NOTES & CALCULATIONS
 - TREE PLANTING DETAIL
 - TREE PROTECTION DETAIL
 - LEGEND
 - GENERAL NOTES, MATERIAL, GRASSED AREAS, IRRIGATION
 - TREE CANOPY DATA & CALCULATIONS, INCLUDING:
 - 20% RETENTION OF THE EXISTING TREE CANOPY (ULDC 406.12 (a) 3)
 - 50% OF PARKING AREAS UNDER CANOPY @ 20 YRS (ULDC 407.43 (d) 3 h.)
 - 30% OF THE SITE UNDER CANOPY WITHIN 20 YEARS (ULDC 406.12 (a) 3)
 - (NOTE: TREES WITHIN LOTS OR BUILDING FOOTPRINTS NOT INCLUDED IN CANOPY CALCULATIONS)
 - PLANT SCHEDULE
 - TABULAR LIST OF ALL REGULATED TREES INDICATING THE SPECIES OF TREE, THE DIAMETER AT BREAST HEIGHT, AND IF THE TREE WILL BE KEPT IN PLACE, RELOCATED, REMOVED, OR MITIGATED (ULDC 406.12 (c)2a) - (SUBMITTED AS "TREE AND NATIVE VEGETATION REPORT")
 - PROPOSED MITIGATION PLAN (SEE "TREE MITIGATION")
 - DEVELOPMENT PLAN SHEET REFERENCE MAP, IF APPLICABLE
- XIV. DETAILED LANDSCAPE PLAN (MAXIMUM SCALE 1"=50')
 - EXISTING TREE SIZE AND TYPE
 - LOCATION AND FIELD TAG NUMBER FOR EACH REGULATED TREE TO REMAIN UNDISTURBED DURING CONSTRUCTION (ULDC 406.12 (c) 2 d)
 - LOCATION OF TREES TO BE REMOVED
 - PROPOSED TREES AND SHRUBS: LOCATION, TYPE AND NUMBER
 - STORMWATER FACILITIES COMPLY WITH ULDC & MTPD DESIGN AND LANDSCAPE REQUIREMENTS
 - BUFFERS & SCREENING MEET LANDSCAPE REQUIREMENTS OF PD, ACTIVITY CENTER, MASTER PLAN AND ULDC (ULDC 407.43)
 - SILT FENCE AND TREE BARRIER LOCATION (ULDC 406.12 (d))
 - SHOW PROPOSED FINAL GRADE & CONTOURS
 - SHOW LIGHTING AND UTILITIES TO IDENTIFY POTENTIAL CONFLICTS
 - LANDSCAPE TO BE PROVIDED FOR DRIVEWAY CONNECTIONS, OFFSITE
 - ROADWAY IMPROVEMENTS AND UTILITY EXTENSIONS

GENERAL NOTES

ALL ASPHALT, LIMESTONE, AND CONSTRUCTION DEBRIS SHALL BE REMOVED FROM PLANTING BEDS AND SOD AREAS PRIOR TO LANDSCAPE INSTALLATION. IF ENCOUNTERED DURING CONSTRUCTION OR INSTALLATION, THESE SHALL BE EXCAVATED AND REMOVED FROM THE SITE. PLANTING DEPTH OF SOIL IN SUCH AREAS SHOULD BE AT LEAST 3". IF FILL MUST BE ADDED, IT MUST BE FLORIDA CLEAN DEEP FILL (FREE OF WEED SEEDS) WITH pH 6.0 - 7.5.

ALL LANDSCAPED AREAS SHALL BE MULCHED WITH 3" THICKNESS OF MULCH. PINE BARK MULCH SHALL BE USED IN ALL AREAS.

NEW TREES OUTSIDE OF MULCHED LANDSCAPED BEDS WILL BE PROTECTED FROM MOWER AND STRING TRIMMER DAMAGE WITH 10" OF PLASTIC DRAIN TUBING.

LEADER SHOOTS AND MAIN STRUCTURAL LIMBS OF TREES SHALL NOT BE TOPPED OR PRUNED. TREES WILL BE STAKED AS NEEDED. GUYLINES WILL BE OF NON-SYNTHETIC BIODEGRADABLE MATERIAL.

AN INSPECTION OF TREES AND TREE BARRICADES IS REQUIRED BY ALACHUA COUNTY FORESTER/LANDSCAPING INSPECTOR PRIOR TO COMMENCEMENT OF CONSTRUCTION. CONTACT ARBORIST STAFF AT 352-374-5243 EXT. 3503. REFER TO CIVIL PLANS FOR TREE BARRICADE DETAILS AND INFORMATION.

NO CERTIFICATE OF OCCUPANCY WILL BE ISSUED UNTIL THE COUNTY HAS GRANTED FINAL APPROVAL AND ACCEPTANCE OF THE INSTALLED LANDSCAPING AS WELL AS THE PROTECTION OF EXISTING NATIVE VEGETATION SHOWN TO REMAIN ON THE DRG APPROVED PLAN. FINAL APPROVAL SHALL INCLUDE AN AS-BUILT LANDSCAPE PLAN CERTIFICATION FROM A REGISTERED LANDSCAPE ARCHITECT CERTIFYING THAT THE LANDSCAPE IS INSTALLED AND FUNCTIONING AS INTENDED AND THAT DISCOURAGED NON-NATIVE VEGETATION HAS BEEN REMOVED.

INVASIVE EXOTIC PLANT MATERIAL
ALL INVASIVE PLANT SPECIES TO BE REMOVED FROM SITE PRIOR TO ISSUANCE OF THE CERTIFICATE OF OCCUPANCY.

PLANT MATERIAL
ALL PLANT MATERIAL TO BE FLORIDA NO.1 OR BETTER, GRADED IN ACCORDANCE WITH THE STATE OF FLORIDA DEPARTMENT OF AGRICULTURE, DIVISION OF PLANT INDUSTRY'S 'GRADES AND STANDARDS FOR NURSERY PLANTS', CURRENT EDITION AT THE TIME PLANS ARE ISSUED.

PLANT QUANTITIES SHOWN ARE FOR PERMITTING PURPOSES ONLY. IT IS THE RESPONSIBILITY OF THE CONTRACTOR TO CONFIRM ALL QUANTITIES SHOWN ON THE PLAN.

GRASSING
ALL DISTURBED AND UNPAVED AREAS, INCLUDING THE ADJACENT RIGHT OF WAY, TO BE GRASSED WITH SOD FREE OF NOXIOUS WEEDS AND TROPICAL SODA APPLE OR SEEDED AND MULCHED, UNLESS OTHERWISE NOTED. SEE CIVIL SITE PLANS FOR ADDITIONAL RELATED INFORMATION.

IRRIGATION NOTES
A TEMPORARY OR PERMANENT AUTOMATIC IRRIGATION SYSTEM IS REQUIRED FOR ALL NEW REQUIRED LANDSCAPING INSTALLED [407.46(A)]. TEMPORARY IRRIGATION SYSTEMS MUST BE REMOVED ONCE THE PLANTS ARE ESTABLISHED OR WITHIN ONE YEAR, WHICHEVER OCCURS FIRST. PRIOR TO THE INSTALLATION OF A NEW PERMANENT IRRIGATION SYSTEM OR SUBSTANTIAL MODIFICATION TO AN EXISTING SYSTEM, AN IRRIGATION PLAN MUST BE SUBMITTED TO AND APPROVED BY THE ALACHUA COUNTY ENVIRONMENTAL PROTECTION DEPARTMENT THROUGH CITIZENSERVE. THE IRRIGATION SYSTEM SHALL COMPLY WITH THE LANDSCAPE IRRIGATION DESIGN AND MAINTENANCE STANDARDS FOUND IN ARTICLE VI OF PART II, TITLE 7, CHAPTER 77 OF THE ALACHUA COUNTY CODE, WHICH, AMONG ADDITIONAL DESIGN STANDARDS, LIMIT IRRIGATION TO 50% OF THE PERMEABLE AREA. FOR MORE INFORMATION, VISIT THE IRRIGATION DESIGN STANDARDS WEBSITE OR CONTACT THE ALACHUA COUNTY ENVIRONMENTAL PROTECTION DEPARTMENT AT 352-264-6800.

ALL NEWLY PLANTED TREES SHALL HAVE INDIVIDUAL LOW FLOW OR MICRO-IRRIGATION SUPPLIES [407.46(A)3]. ALL IRRIGATION SYSTEMS ARE REQUIRED TO HAVE A FUNCTIONING RAINFALL SHUTOFF DEVICE SET TO ACTIVE EVEN DURING ESTABLISHMENT, PER [407.46(a)4].

INITIAL CANOPY LOSS (ULDC 406.12 (a) 3)

SEE SHEET C0.31, TREE CANOPY RETENTION PLAN
ALL TREES ARE PROPOSED TO REMAIN.

SITE TREE CALCULATIONS (ULDC 406.12 (a) 3)

SITE TREE CANOPY COVERAGE REQUIREMENTS ARE NOT REQUIRED FOR THIS PROJECT AS ALL EXISTING TREES ARE PROPOSED TO REMAIN AND THIS PROJECT IS EXEMPT FROM THE LANDSCAPE REQUIREMENTS LISTED IN SECTION 407.40

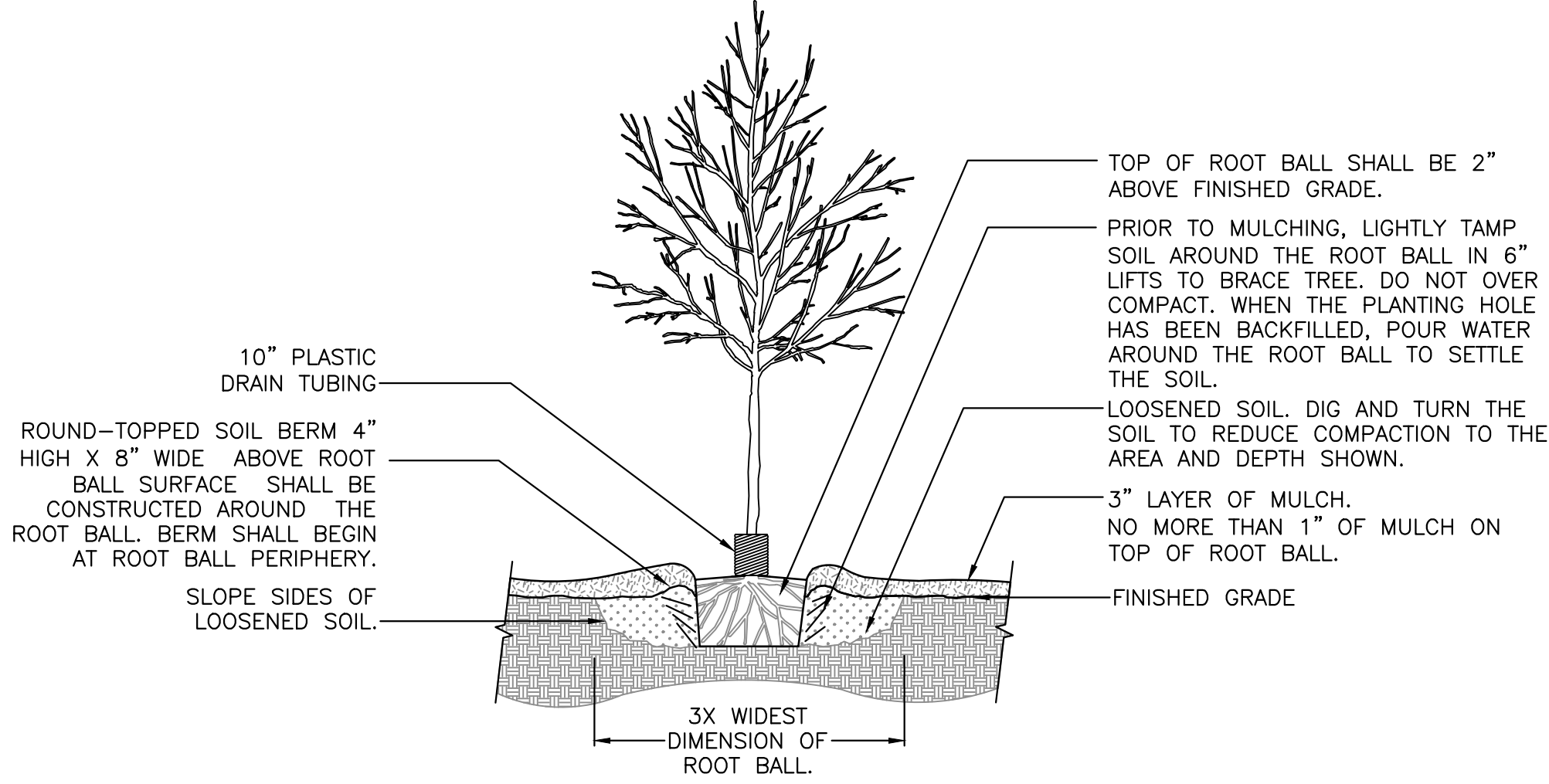

1 TREE PLANTING DETAIL
SCALE: N.T.S.

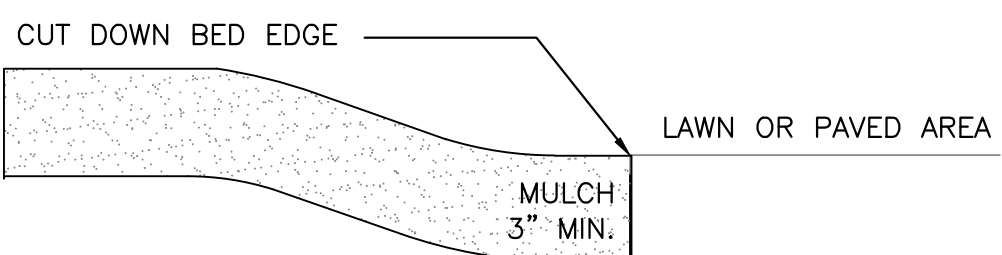

2 MULCH DETAIL
SCALE: N.T.S.

811 KNOW WHATS BELOW ALWAYS CALL 811 BEFORE YOU DIG
It's fast, it's free, it's the law.
Call 811 two business days before digging

11801 Research Drive
Alachua, Florida 32615
(352) 331-1976
www.chw-inc.com
est. 1988
FLORIDA
LA000683

CHW
Professional Consultants

SCALE: 1"=20'
REVISED SCALE ON ORIGINAL DRAWING
0 MINUS SIGN MEANS THIS SHEET ADJUST SCALES ACCORDINGLY.

CONSTRUCTION/REV. REVISIONS

DATE: 07/31/23
SUBMITTED: 08/14/23
SUBMITTAL: 09/05/23
ALACHUA COUNTY: 01/02/24

CLIENT: SEMOJ D, LLC
PROJECT: NEWBERRY CHEVRON
SHEET TITLE: LANDSCAPE PLAN AND DETAILS

DESIGNER: CAP
CAP
JMS
PROJECT NUMBER: 22-0279

REGISTERED LANDSCAPE ARCHITECT
LOW MICHAEL SIMSON
LA6667436
STATE OF FLORIDA

SHEET NO.: LS-1