





Proposed Escheated Property
Transfer to City of Alachua
Parcel 03950-005-001

Legend

-  Escheated Parcel
-  Road Maintenance
-  Other
-  Parcel

ALACHUA COUNTY
PUBLIC WORKS

PHONE: 352-374-5245
FAX: 352-337-6243
MAILING ADDRESS:
5620 NW 120TH LANE
GAINESVILLE, FL 32653

Date: February 26, 2024
Prepared by: PW GIS

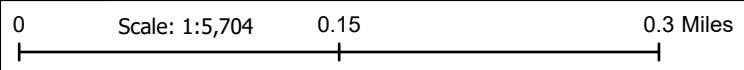
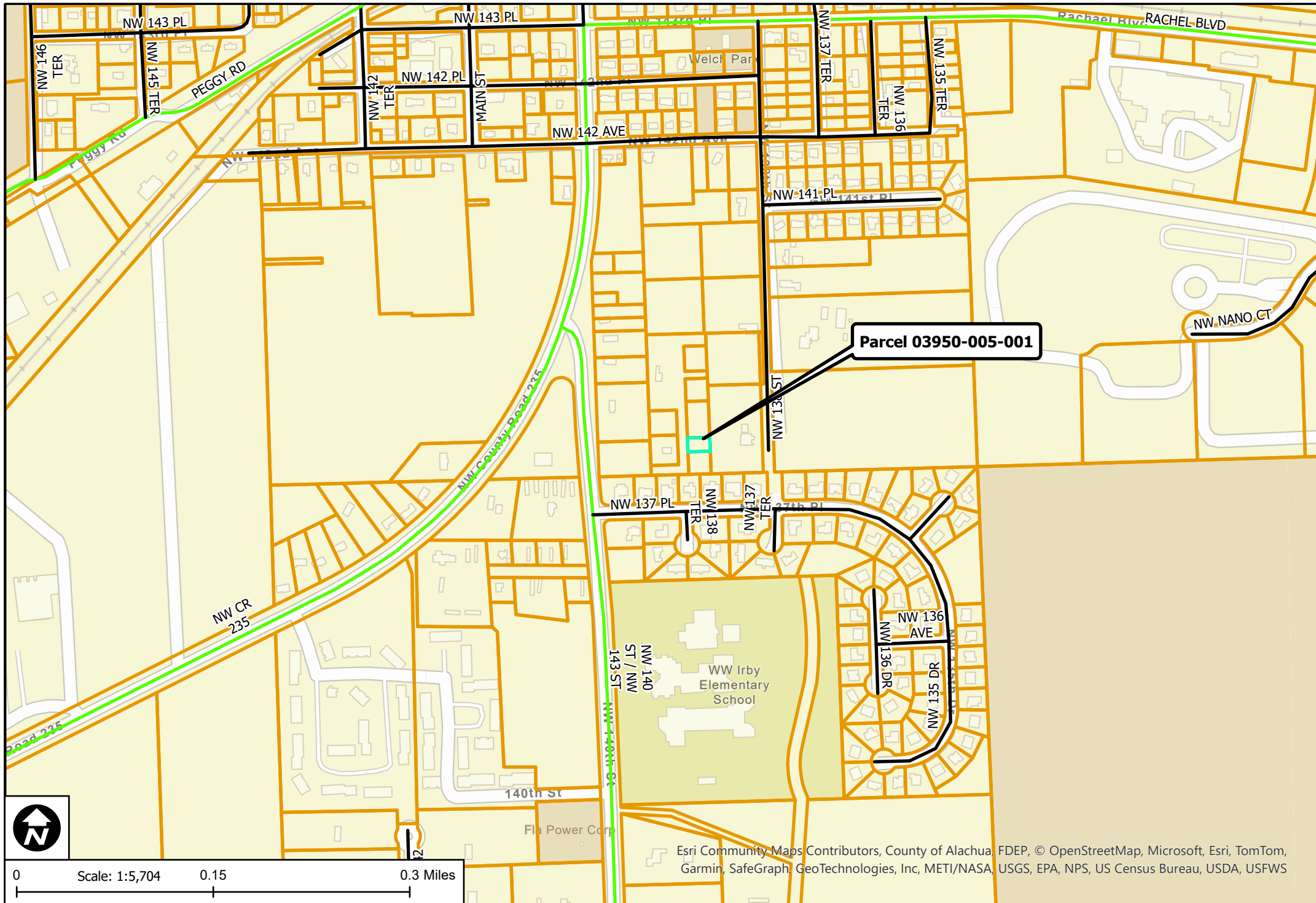

Esri Community Maps Contributors, County of Alachua, FDEP, © OpenStreetMap, Microsoft, Esri, TomTom, Garmin, SafeGraph, GeoTechnologies, Inc, METI/NASA, USGS, EPA, NPS, US Census Bureau, USDA, USFWS